



STANDARD SEAL PROFILES

- ROD WIPERS ■
- ROD SEALS ■
- ROD/PISTON BEARING RINGS ■
- PISTON SEALS ■
- O 'RINGS/BACK UP RINGS/GASKETS ■
- ROTARY SEALS ■





In July 2015, **Abbey Seals** installed a state of the art CNC lathe, for express manufacturing of seals, o-rings, gaskets and a wide range of other profiles and products.

We have over 140 pre-set profiles, the ability to create new profiles and machine parts up to 400mm OD. This gives us huge scope to satisfy an enormous spectrum of seal and gasket applications. We can produce one off prototypes through to hundreds and thousands for your production. Quality materials such as FDA Compliant Polyurethane, NBR, FDA Approved Viton®, FDA Approved Silicone, FDA Approved EPDM, Bronze Filled PTFE, Virgin PTFE, Acetal and many more.

Based in our manufacturing hub in Little Island, Cork, we ship same day countrywide and internationally.

Please contact our sales offices in either Dublin or Cork for any enquiries you may have.



MATERIALS

POLYURETHANE/PU

- PU • HPU • HPU 55 D
- C-HPU • C-HPU 57 D • C-HPU 72 D
- HT-PU • LT-PU • LT-PU +
- SL-PU



PTFE

- PTFE (virgin) • PTFE 1 • PTFE 2
- PTFE Carbon • PTFE Graphite
- PTFE PEEK • PTFE D05 • PTFE D08
- PTFE D46 • PTFE 25 % Glass

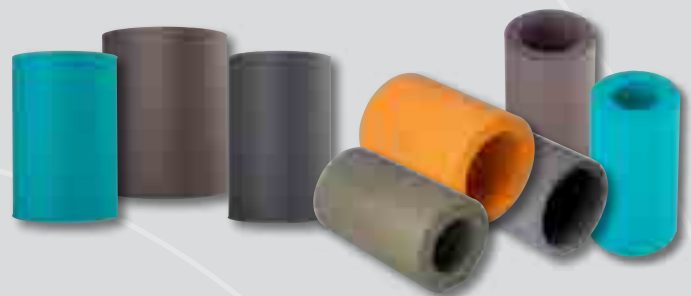

NITRILE BUTADIENE RUBBER

- NBR (black) • T-NBR
- H-NBR • H-NBR 90
- H-NBR ED
- NBR (white) • NBR 73



VITON® / FPM

- FPM (brown)
- FPM FDA Brown
- FPM ED



ETHYLENE PROPYLENE DIENE RUBBER

- EPDM (black) • EPDM FDA & KTW
- EPDM FDA • EPDM (white)



SILICON®

- MVQ FDA



ENGINEERING PLASTICS

- POM
- PA
- UHMW-PE





DA101



DA102



DA103



DA104 (pneumatic)



DA105 (pneumatic)



DA106 (pneumatic)



DA107



DA108



DA109



DA111



DA112



DA113



DA114



DA115



DA116



DA117



DA118



DA119



DA211



DA212



DA213

ROD/PISTON BEARING RINGS



DF101



DF102

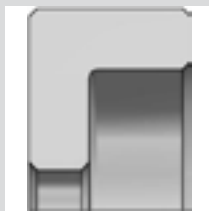

DF103



DF104



DF105



DF106



DF107



DF108



DFB102



DS101



DS102



DS102R



DS103



DS104



DS104R



DS105 (pneumatic)



DS106



DS107



DS108



DS109



DS110-112



DS116



DS117



DS117R



DS118



DS119



DS120



DS121



DS124



DS125



DS126-128



DS129



DS130



DS131



DS138



DS139



DS141



DS142



DS199



DS205



DS216



DS238



DS154



DS251



DS151



DK101



DK102



DK102R



DK103



DK104



DK104R

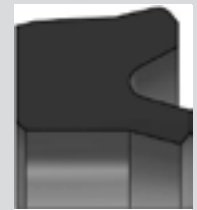

DK105 (pneumatic)



DK106



DK107



DK108

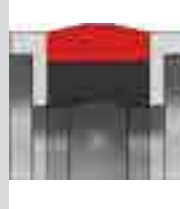

DK109



DK109D

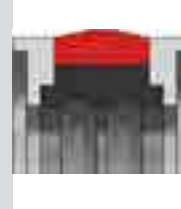

DK109H



DK109N



DK110-112



DK116



DK117



DK118



DK119



DK120



DK122



DK123



DK123D

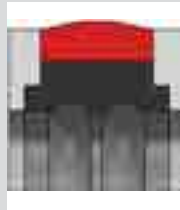

DK123H



DK123N



DK124



DK125



DK126



DK127



DK138



DK139



DK140



DK141



DK142

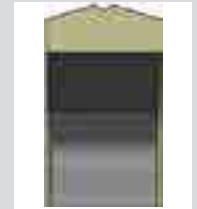

DK143



DK144



DK145



DK199



DK205



DK216

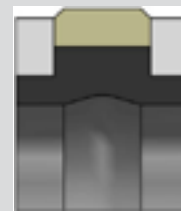

DK222



DK238



DK150



DK151



DK153



DK154



DK250



DK251

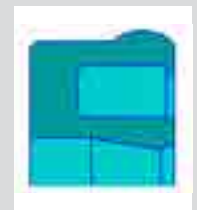

DK219

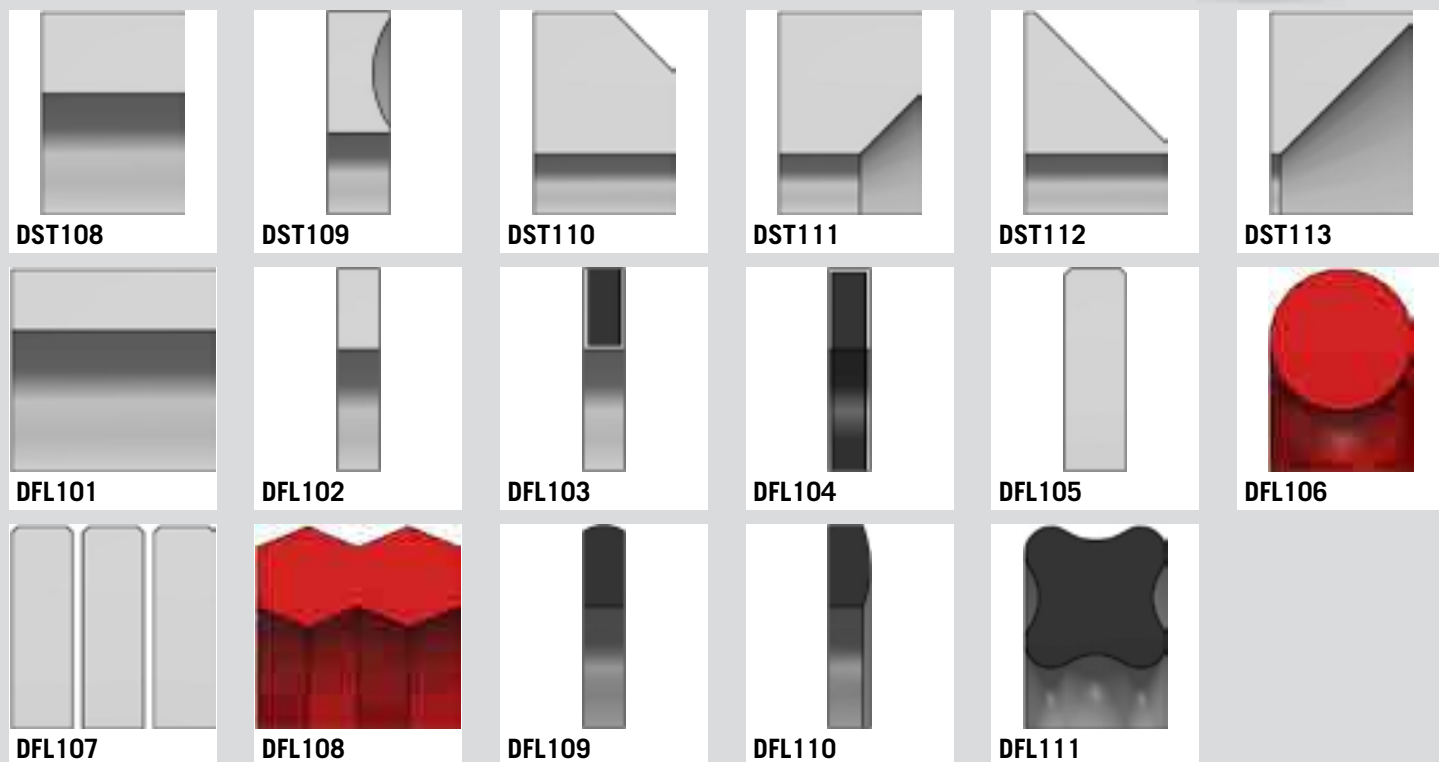

ROTARY SEALS

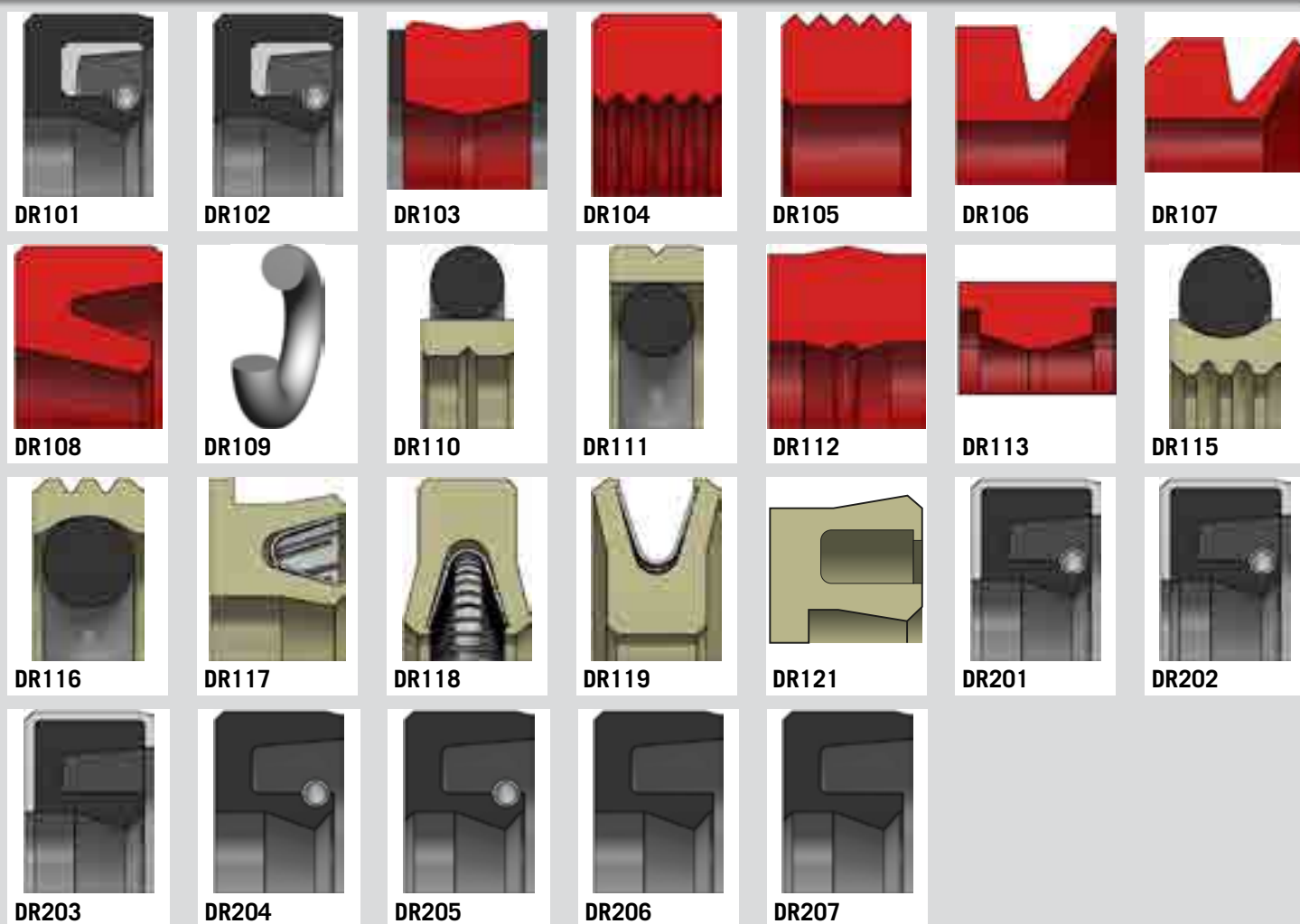

■ **DUBLIN**

John F. Kennedy Rd
John F. Kennedy Ind Est
Dublin D12 PD36
Ireland

T: +353 (0)1 427 7900
F: +353 (0)1 450 8181
E: dublin@abbeyseals.ie
W: www.abbeyseals.ie

■ **CORK**

31b Euro Business Park
Little Island
Cork T45 X310
Ireland

T: +353 (0)21 500 3555
F: +353 (0)21 500 3554
E: cork@abbeyseals.ie
W: www.abbeyseals.ie