

10.2" or 17" Widescreen Flipdown with WiFi Streaming

FEATURES

- Built in Wireless Wifi HD receiver
- Built in SD card player
- Audio Video inputs
- Wireless IR headphone transmitter
- Wireless FM transmitter
- Led Dome lights
- IR Remote control

Device is optimized for the
iPhone 5 and later.



Wirelessly Stream !
1080 HD Content from your smartphone



Streaming Information

There are two different ways to send media wirelessly. The first is Miracast or screen mirroring, which allows the user to send whatever is on the screen of a device to the screen of the flip down monitor.(iPhones can't mirror) So, whatever is displayed on the screen of a mirror compatible phone, tablet, or pc will also display on the flip down monitor. This technology is capable of streaming live information and media from Netflix, YouTube, Hulu, and etc. Then there is DLNA which stands for Digital Living Network Alliance. (Both iPhones [AirPlay] and Android can use DLNA) This media sharing technology allows the user to stream any media that is on a device's hard drive or storage. For instance, if there are movies saved on the device's storage then DLNA can be used. However, you are not able to use live streaming or applications such as Netflix, YouTube, Hulu, and etc. with DLNA. DLNA does allow you to use the device while it is streaming. So, if there is a phone call, need to use navigation, send a text, email, etc. these functions will not interrupt what is streaming to the flip down monitor. On the other hand Miracast will show whatever is on the screen on the device including any phone calls, navigation, texts, emails, and etc.

iPhone Streaming Instructions

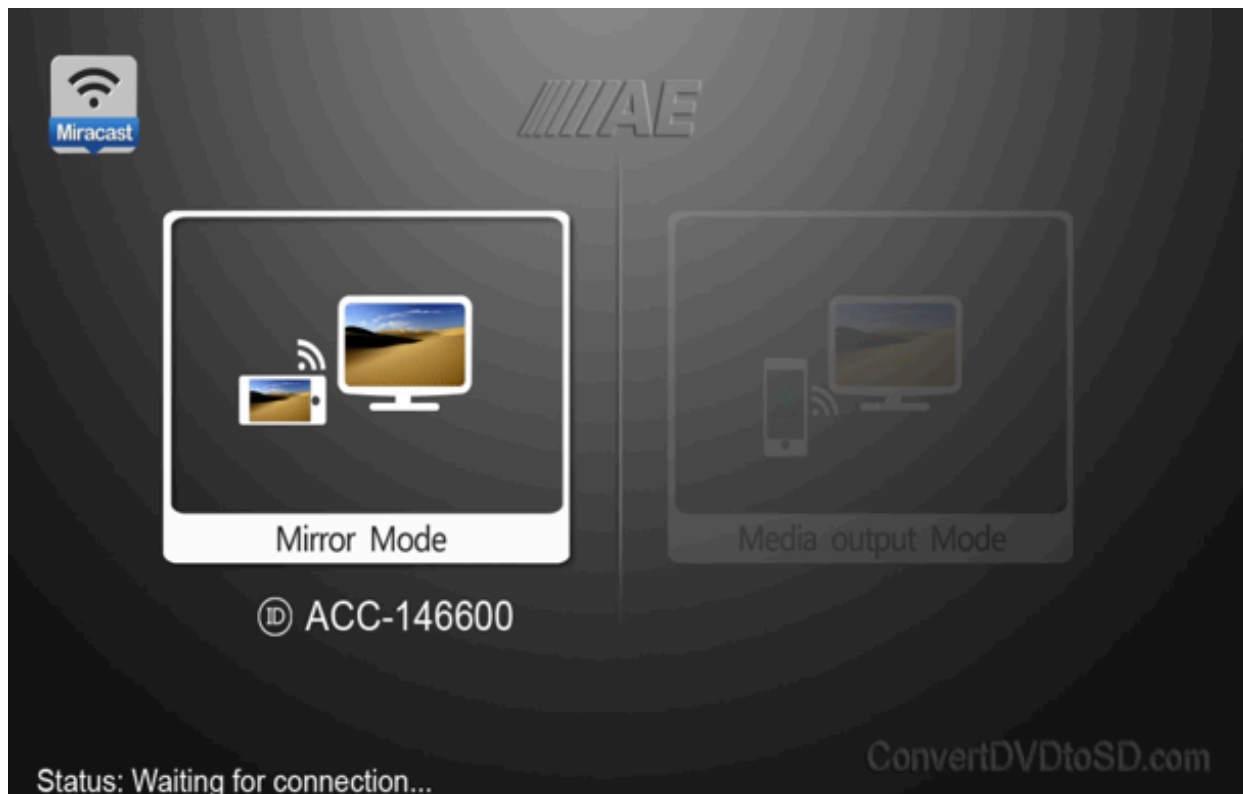

Once this screen comes up press this button on the flip down so the DNLA screen will pop up allowing you to use Apple's Airplay:



Once you press the button the screen should change to and highlight DNLA/Media output mode:

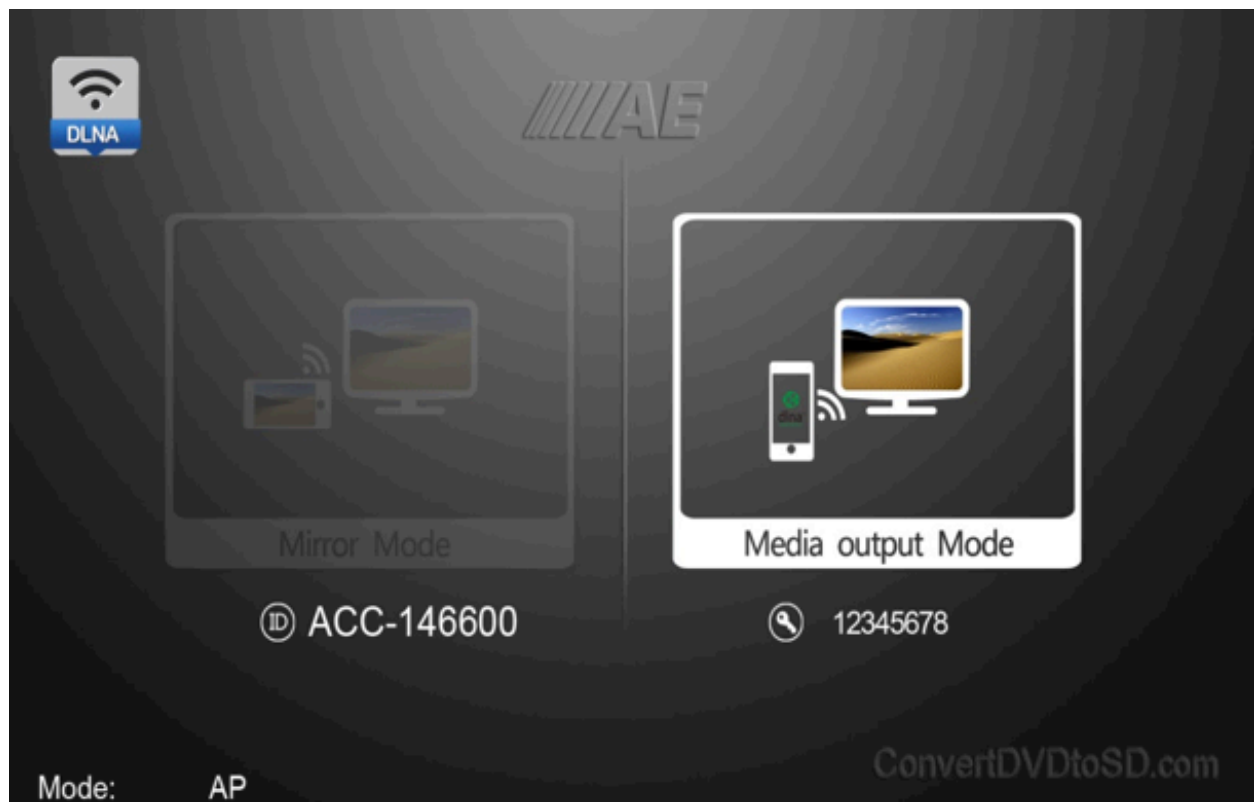

Next you will go to your iPhone, turn on your Wifi, and log onto the wireless ID that looks something like ACC-123456 and the passcode is 12345678:

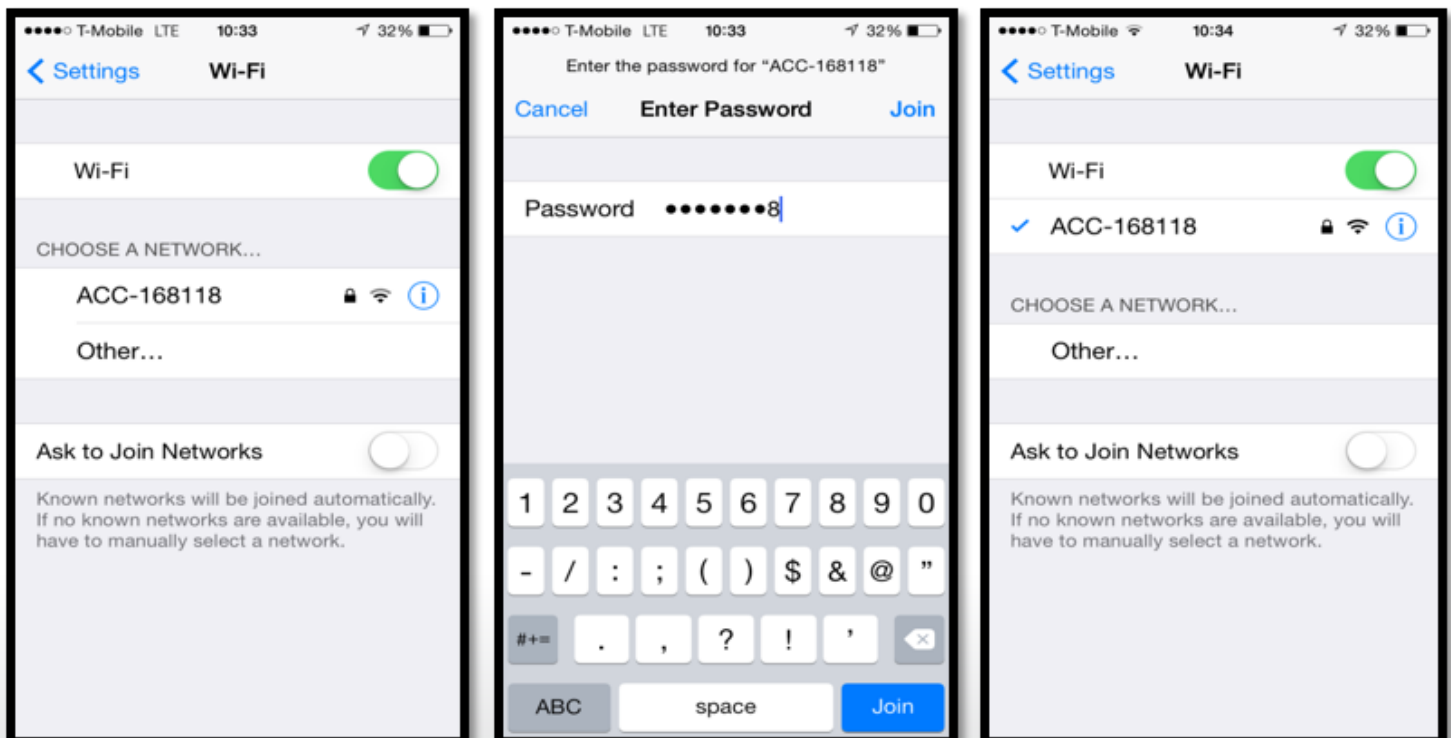

Next slide up from the bottom of the screen towards the top (to access the control center) from your iPhone and select Airplay. Once you select Airplay a screen will come up with of choice of either iPhone or the ID of the device you are streaming to for example, ACC-123456-ITV. Select the device ID. You will see in the control center AirDrop and the device ID:

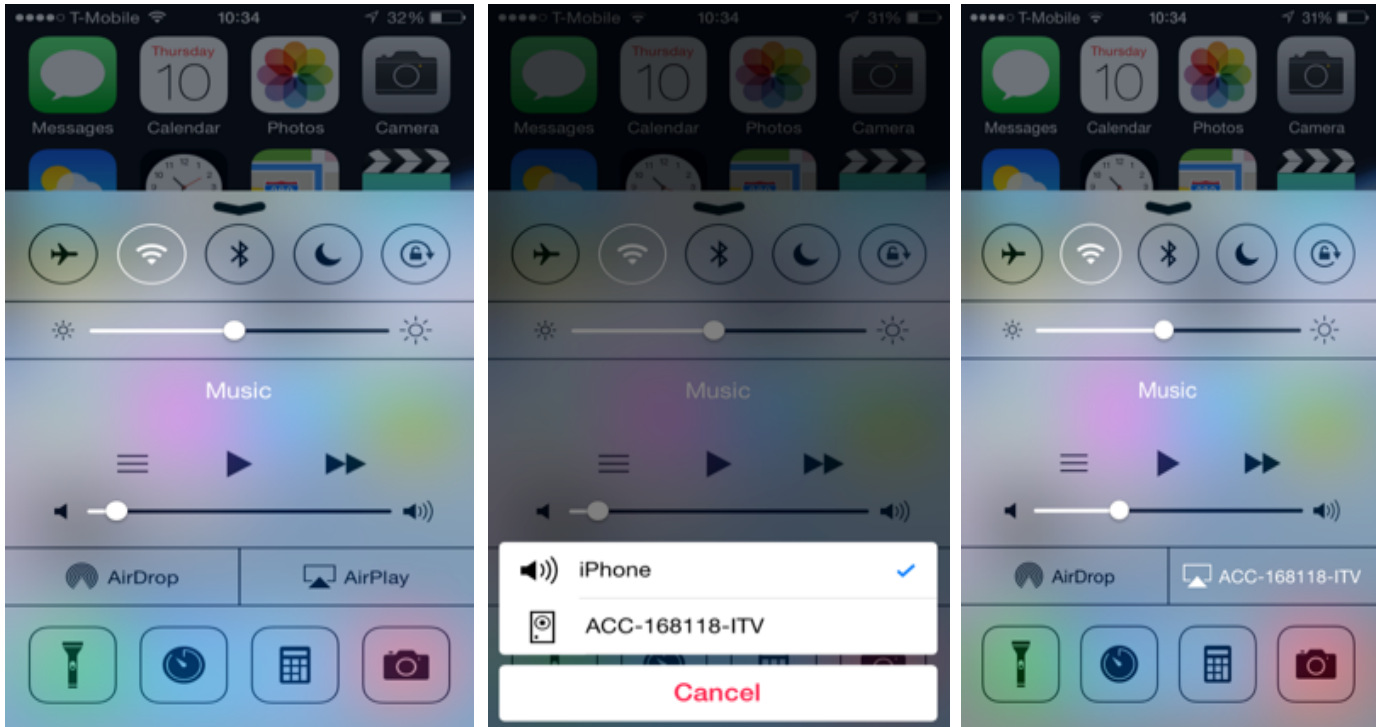

The iPhone is now ready to stream. You will now go into your video folder and pick a movie to stream and you will see screens like these:

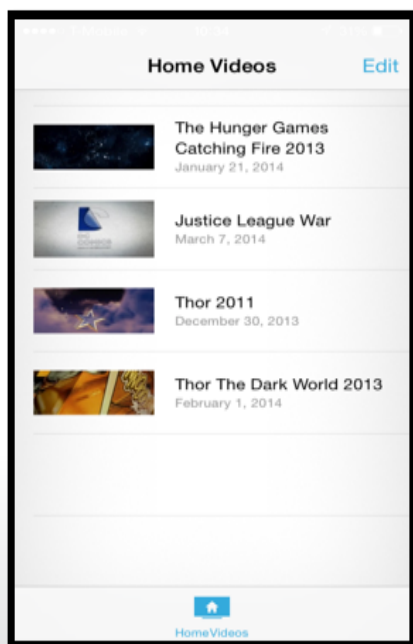

Andriod Streaming Instructions

In order to stream from any Android device you must make sure you are running Android OS 4.2 or higher. With an Android device running an OS of 4.2 and higher you are able to do screen mirroring and DLNA functionality. DLNA/Media output mode only works with media that is directly on your phone and not streaming such as Netflix and YouTube. First turn on the flip down monitor and switch the input to HD Video and you will see this screen:

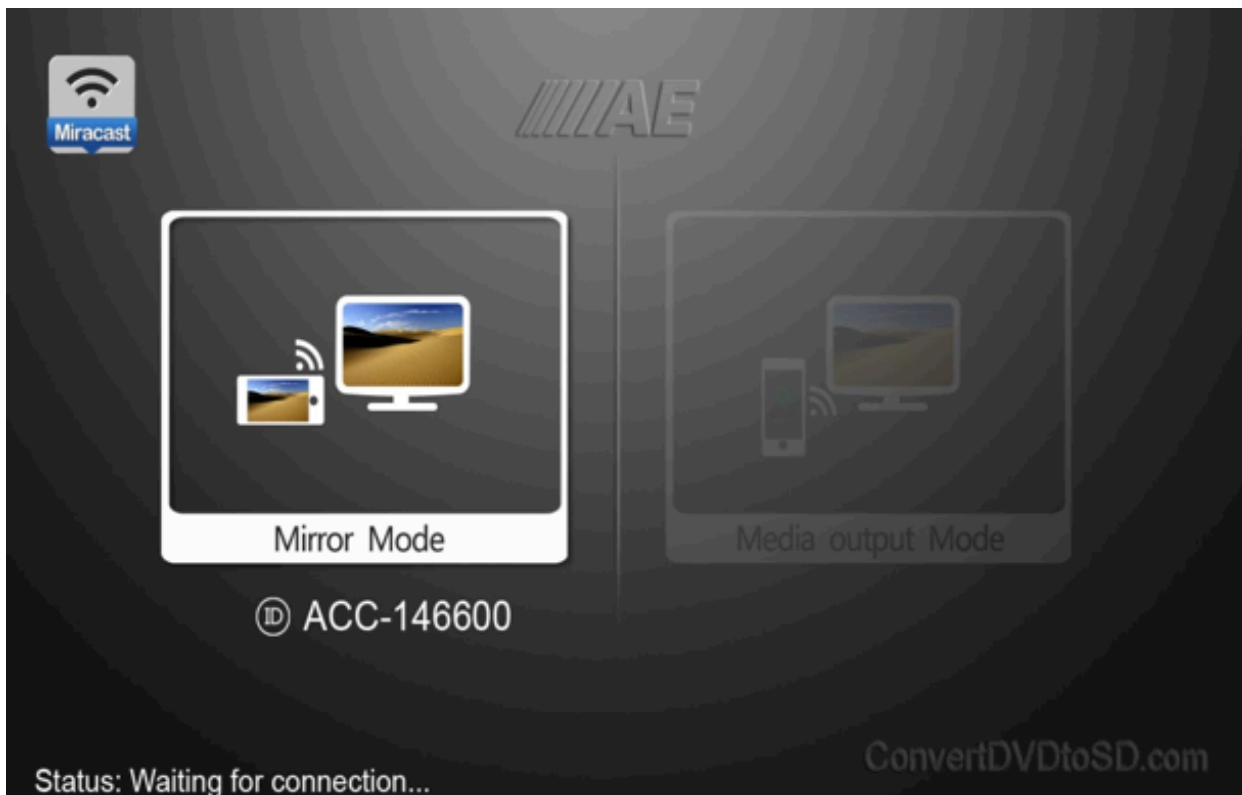

Once this screen comes up press this button on the flip down monitor so the DNLA screen will pop up allowing you to use DNLA/Media output mode:



Once you press the button the screen should change to and highlight DNLA/Media output mode:



Next you will go to your Android Device, turn on your Wifi, and log onto the wireless ID that looks something like ACC-123456 and the passcode is 12345678:

Next got to your app tray and select the video player that came with your phone. Make sure that it is the player that came with your phone and not a third party application.

Screen images are Samsung S4 devices will vary

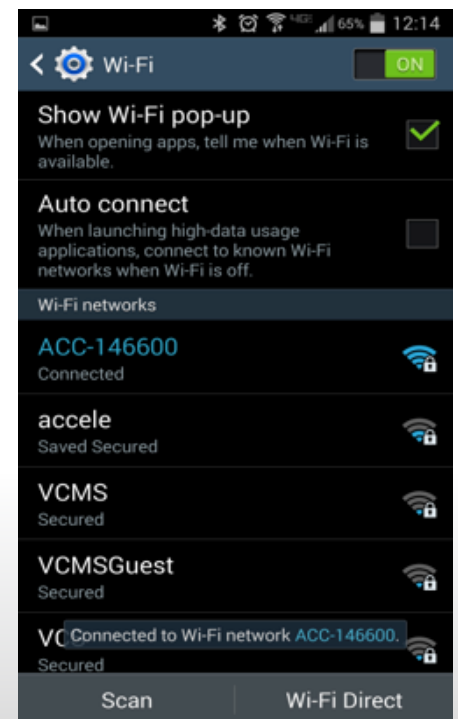
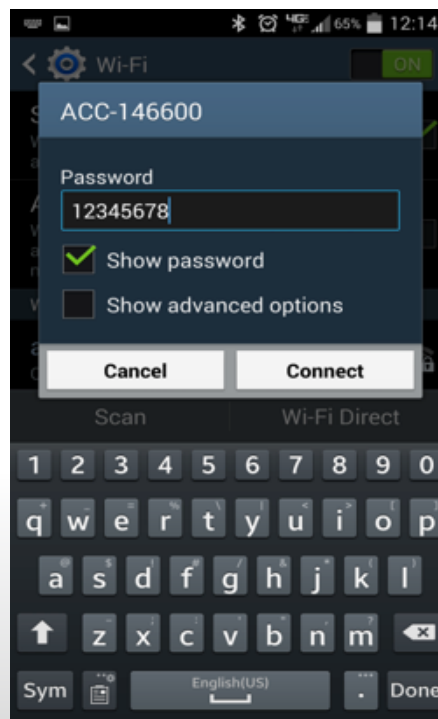
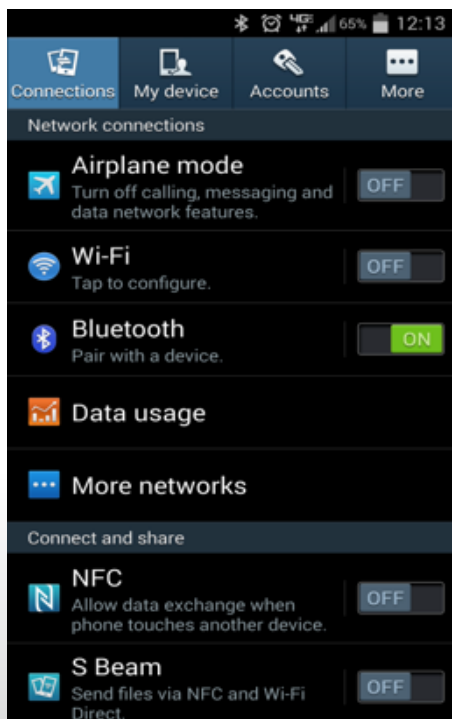

Now you will select a video and play it. At the top corner you should see a symbol that will allow you to send that video to the monitor:

The symbol you need to tap to send the video to the monitor. This symbol will vary depending on the brand of your phone. Top is Samsung and the bottom is Motorola.

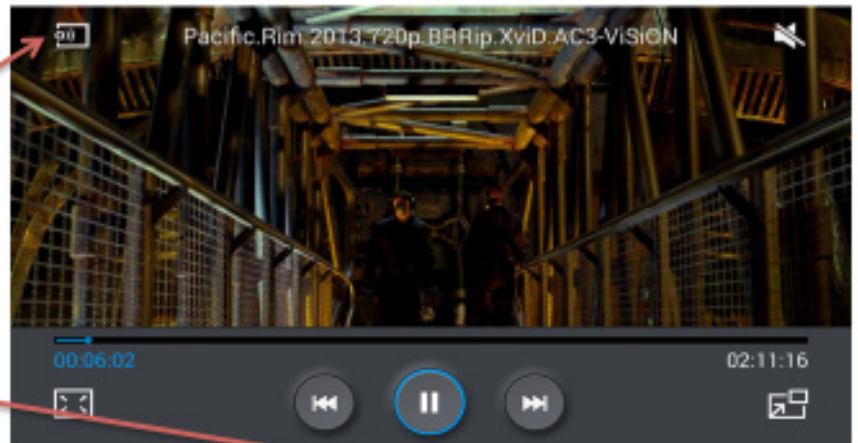

Once the symbol is tapped a menu will pop up and have you select any available devices. Select the device that starts with ACC:

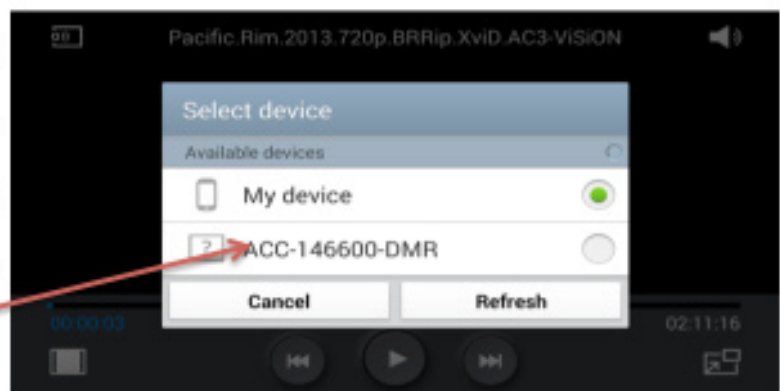

Your Android device is now ready to stream. You will see screens like these:

Connected to monitor

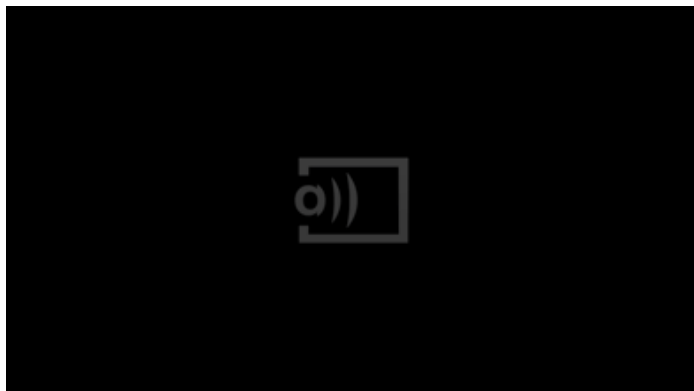
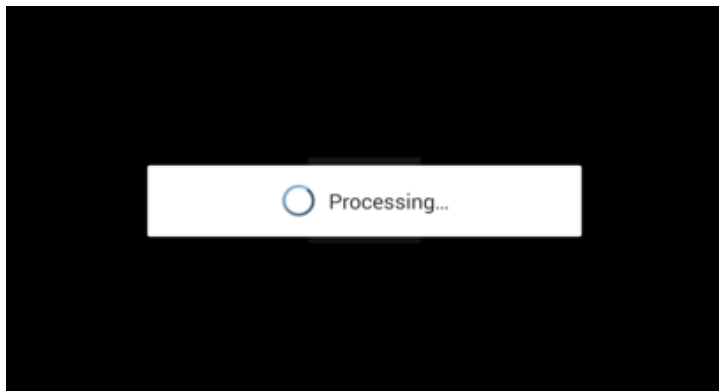

Miracast

Miracast is a streaming technology that allows you to mirror the screen on your phone. This allows you to stream media from apps like Netflix, YouTube, Hulu, and etc. Each Android device is different so the set up will vary. This is a guideline to help generalize the connection for Miracast. The Android device needs Android OS of 4.2 or higher. Make sure the screen on the flip down monitor looks like this:

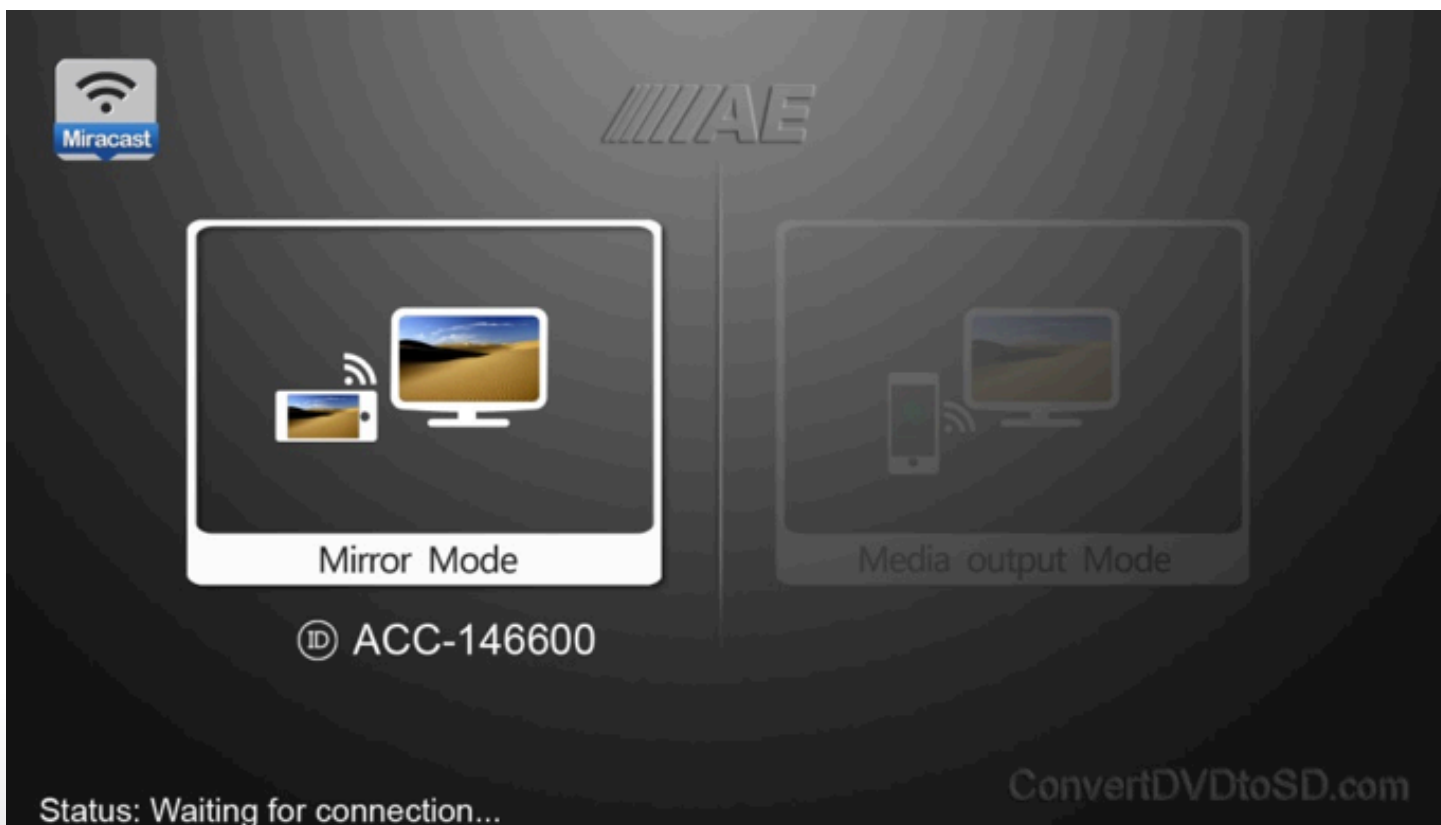

Once you have done this you will go to your Android device's settings menu and look for screen mirroring, miracast, or media output (depending on your device).

Sony Xperia Z1S

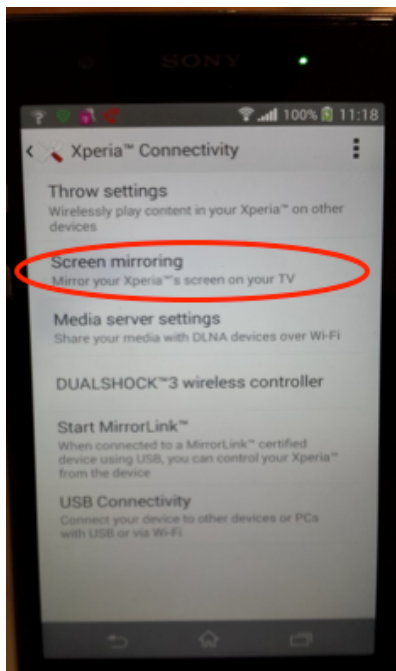

Motorola

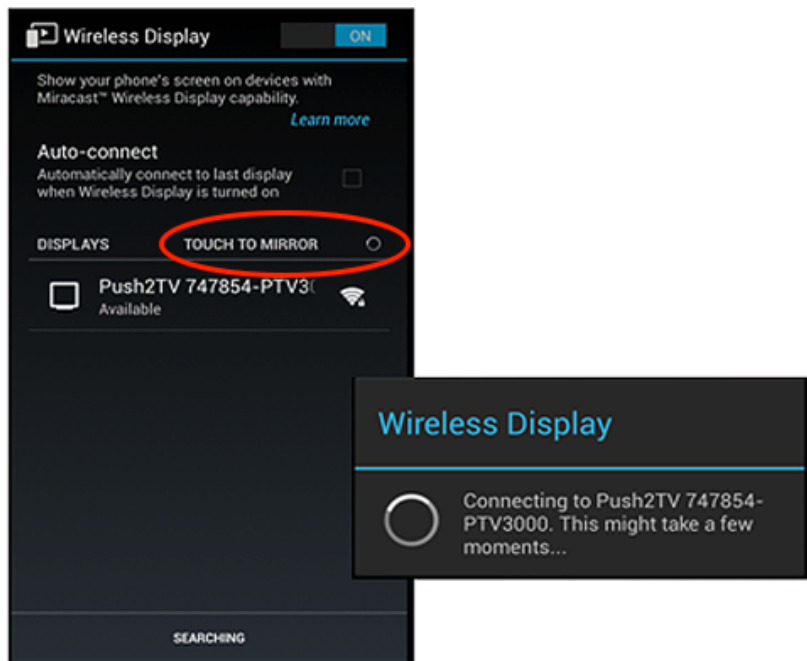

LG G2

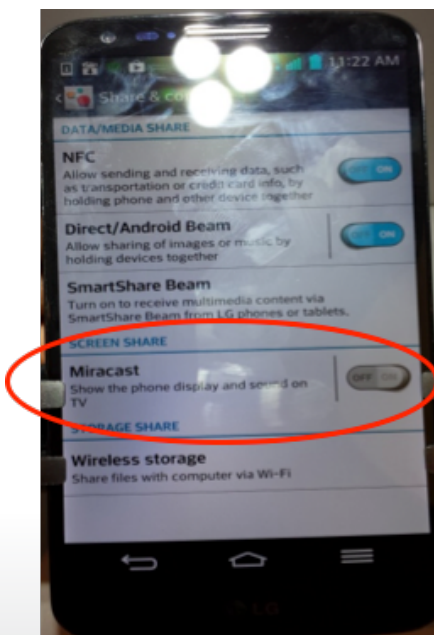

HTC One M8

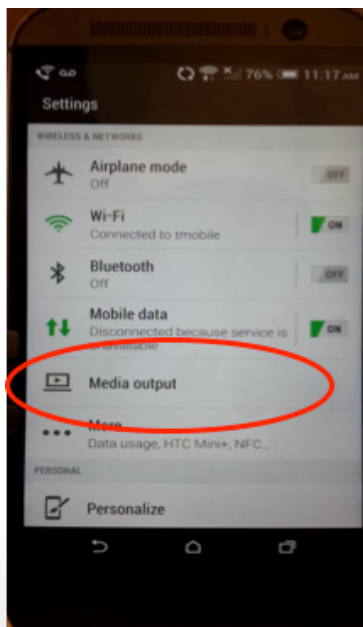

Samsung Galaxy S4

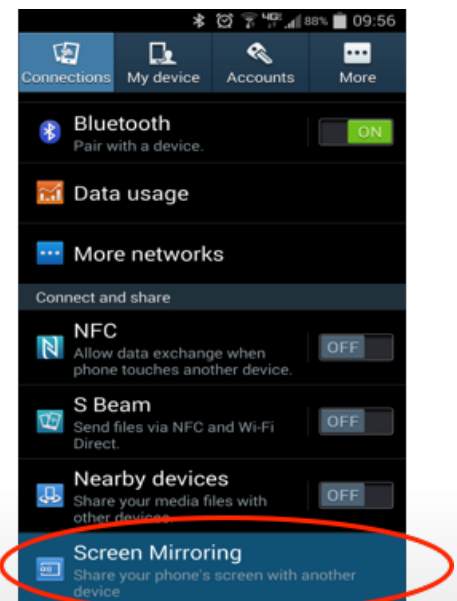

Then you will press the corresponding button for the mirroring function and there will be a screen similar to this so you can connect to the flip down monitor:

Samsung S4

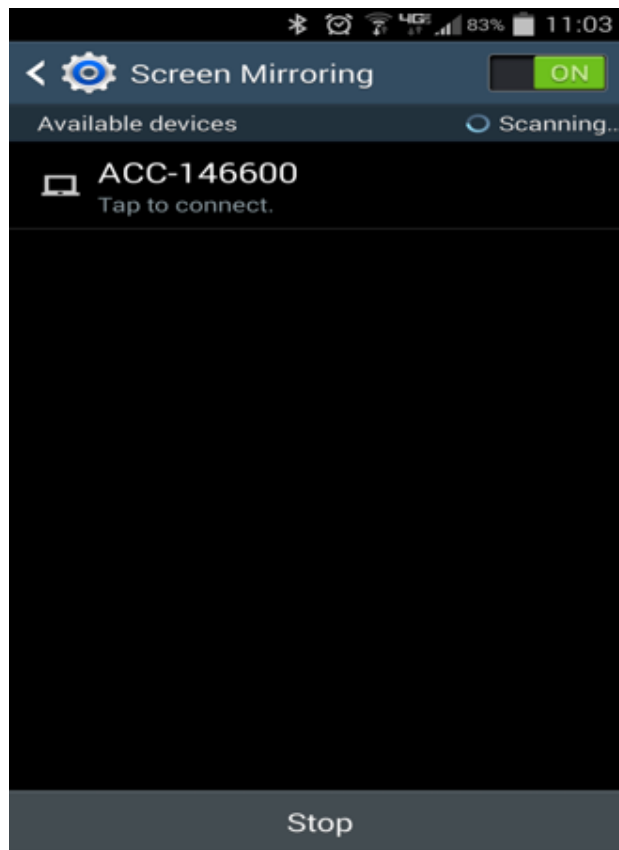

When you tap to connect to the flip down monitor, which will start with ACC followed by 6 digits you are done. The flip down monitor will connect and you are not mirroring to the unit.