

## New Product

**SURFACE MOUNT  
SHIELDED POWER INDUCTOR  
SERIES SHC1308**

### FEATURES

- RoHS Compliant
- A great replacement for those bulky “through-hole” power inductors
- Well suited for use in ruggedized computers, high power appliances and digital lighting systems

### SPECIFICATIONS

#### ELECTRICAL SPECIFICATIONS

- Inductance range    0.15uH to 0.44uH
- Test condition        0.1Vrms @ 200kHz
- Test equipment        Quadtech 1750 LCR meter

Part Number	L(uH)	Tol % ±	DCR (ohms) max	Rated Current (A) (Note 1)	Saturation Current (A) (Note 2)
SHC1308-R15Y	0.15	30	0.0006	50	55
SHC1308-R21M	0.21	20	0.0006	45	50
SHC1308-R26M	0.26	20	0.0006	40	45
SHC1308-R32M	0.32	20	0.0006	40	41
SHC1308-R44M	0.44	20	0.0006	28	30

#### PHYSICAL SPECIFICATIONS

- Operating temp.        -55°C to +125°C
- Core                      Ferrite
- Packaging                T & R    400 pieces per reel
- Tape & reel spec.      Tape     24 mm embossed carrier
- Reel     330 mm dia

### Dimensions in millimeters

- Length A                    13.46 max
- Width B                    12.95 max
- Height C                   8.0 max
- Terminal length D        2.54 ± 0.50
- Terminal width E         5.0 ± 0.5

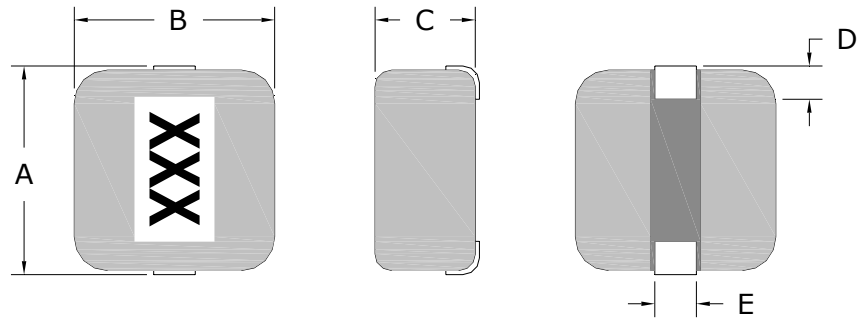

### Suggested PCB layout

- G = 7.1 max
- H = 7.6 max
- L = 13.8 max

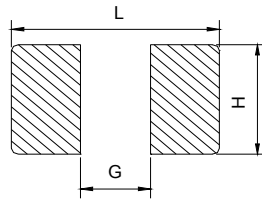

1. Based on ΔT approximately 40°C.
2. Based on ΔL of 20% typical

All test data based on 25°C ambient. Part temperature (ambient+temp rise) must not exceed 125°C under worst case operating conditions. Circuit design, components, PCB trace size and thickness, airflow and other cooling provisions all effect the part temperature.