

**SURFACE MOUNT
WIDE BAND CHOKE
SERIES SK5B**

FEATURES

Designed to replace all existing leaded wide band chokes
 Small, compact, and surface mountable
 High current handling capacity
 Available on tape and reel

SPECIFICATIONS

Part Number	Typical Z @ 25 MHz (Ω)	Z @ 100 MHz (Ω)	DCR Max (Ω)	Rated current (A)	Figure Number
SK5B-2.5T-450	250 ± 25%	450 ± 25%	0.055	2	1
SK5B-2.5T-600	350 ± 25%	600 ± 25%	0.040	2	2
SK5B-2X1.5T-150	65 ± 25%	150 ± 25%	0.008	2	3
SK5B-2X1.5T-220	110 ± 25%	220 ± 25%	0.006	2	4

Test equipment Impedance Analyzer HP-4291A
 Construction Wound ferrite bead with tinned copper wire terminal
 Solder heat resistance 215°C for 5 seconds. Good for soldering with soldering iron
 Operating temp. -25°C to +105°C
 Marking None
 Tape & Reel Embossed carrier tape with 3M paper or plastic reel
 Packaging 1000 pieces per reel

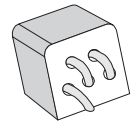
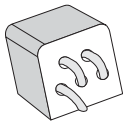

Figure 1

DIMENSIONS IN MILLIMETERS



SK5B-2.5T-450

Total Length A 7.50 mm max
 Height B 5.00 mm max
 Width C 5.25 mm max
 Lead length 2.00 mm min
 Wire gauge 24 AWG TCW

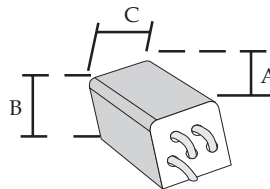

SK5B-2.5T-600

Total Length A 11.0 mm max
 Height B 5.00 mm max
 Width C 5.25 mm max
 Lead length 2.00 mm min
 Wire gauge 24 AWG/TCW

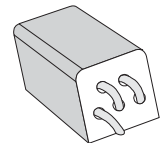

Figure 2

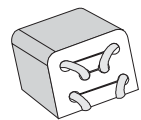
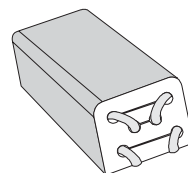

Figure 3



SK5B-2X1.5T-150

Total length A 8.5 mm max
 Height B 4.5 mm max
 Width C 6.9 mm max
 Lead length 2.0 mm min
 Wire gauge 24 AWG TCW



SK5B-2X1.5T-220

Total length A 11.5 mm max
 Height B 4.50 mm max
 Width C 6.90 mm max
 Lead length 2.00 mm min
 Wire gauge 24 AWG TCW

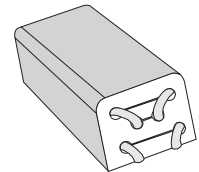

Figure 4