

## New Product

**SURFACE MOUNT  
SHIELDED POWER INDUCTOR  
SERIES STS702**

### FEATURES

- RoHS Compliant
- High current handling capacity
- Low profile
- Low noise, due to composite construction
- High Frequency up to 5MHz

### ELECTRICAL SPECIFICATIONS

- Inductance range    0.33uH to 4.7uH
- Test condition       1Vrms @ 100kHz
- Test equipment       Quadtech 1750 LCR Meter

### PHYSICAL SPECIFICATIONS

- Operating temp.       -55°C to +125°C
- Shielding               Mixed Material
- Core & base            Mixed Material
- Packaging               T & R    1500 pieces per reel
- Tape & reel spec.     Tape    16 mm embossed carrier
- Reel    330 mm paper reel

### SPECIFICATIONS

Part Number	L(uH)	Tol % ±	DCR (ohms) max	Rated Current (A) (Note 1)	Saturation Current (A) (Note 2)
STS702-R33M	0.33	20	0.0070	12	16
STS702-R47M	0.47	20	0.0093	11	12
STS702-R68M	0.68	20	0.014	9	11
STS702-1R5M	1.5	20	0.034	4	7
STS702-2R2M	2.2	20	0.046	5	5
STS702-4R7M	4.7	20	0.078	3	3

### Dimensions in millimeters

Length A	7.8 max
Width B	7.0 max
Height C	2.0 max
Terminal length D	1.6 ± 0.5
Terminal width E	2.1 ± 0.5
Footprint length F	7.4 ref
Pad spacing G	3.7 ref
Pad width H	3.4 ref

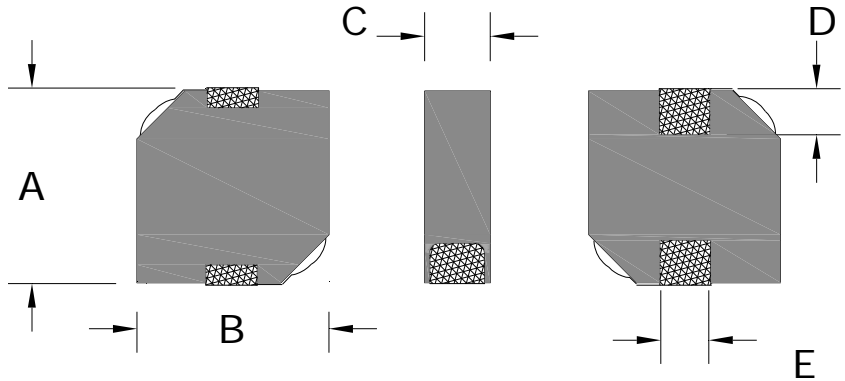

### Suggested PCB layout

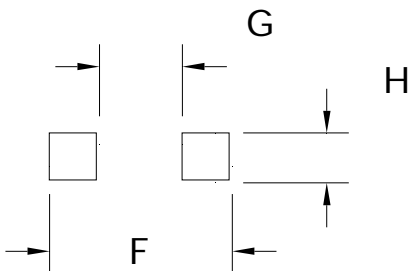

### Suggested Reflow Profile

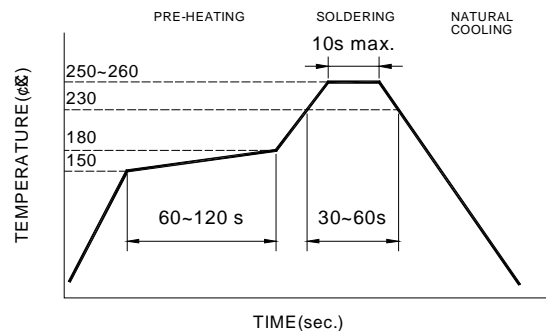

**Notes:**

1. Based on  $\Delta T$  approximately 40°C
2. Based on  $\Delta L$  of 20% typical

All test data based on 25°C ambient. Part temperature (ambient + temp rise) must not exceed 125°C under worst case operating conditions. Circuit design, components, PCB trace size, airflow and other cooling provisions all effect the part temperature.

STS702-R33M

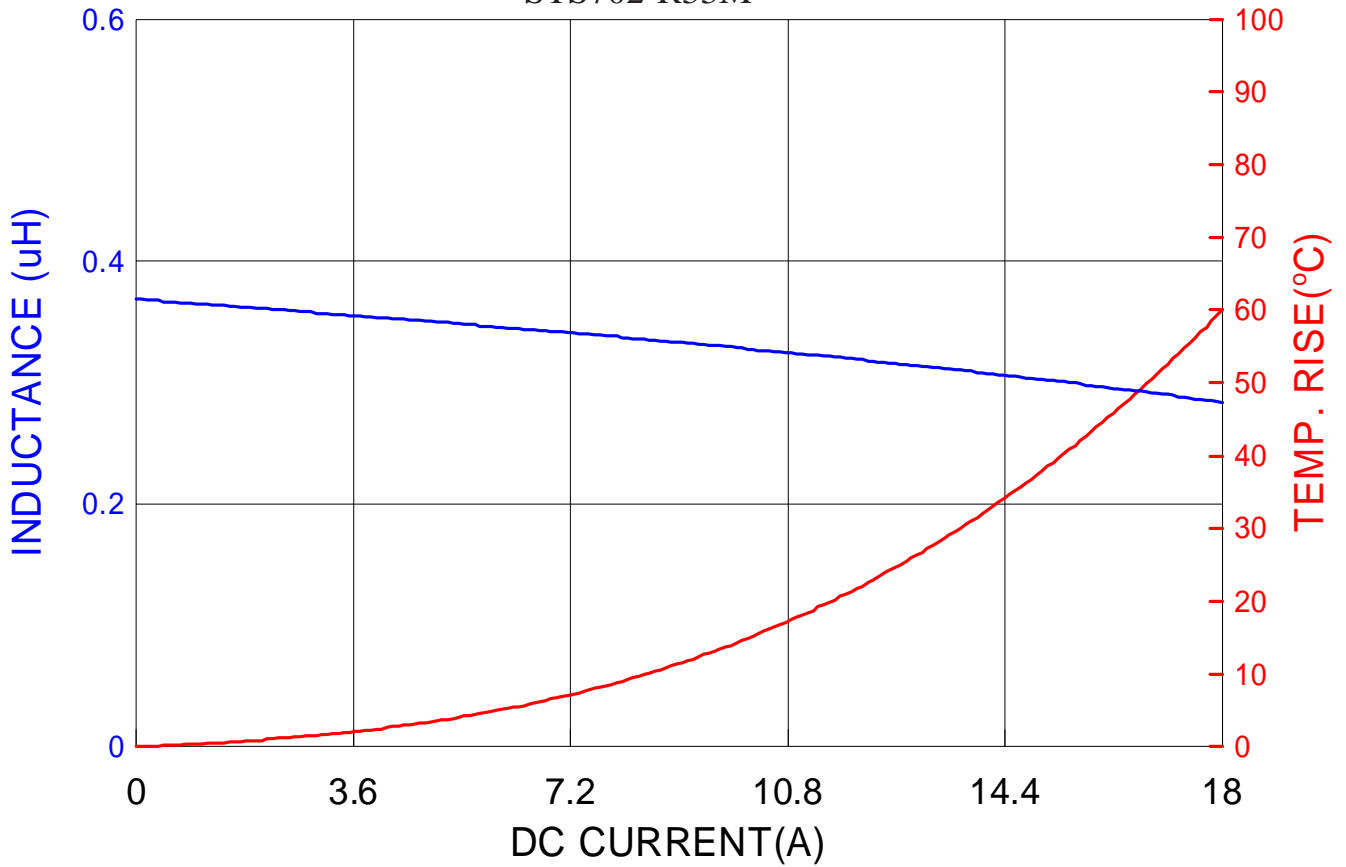

STS702-R47M

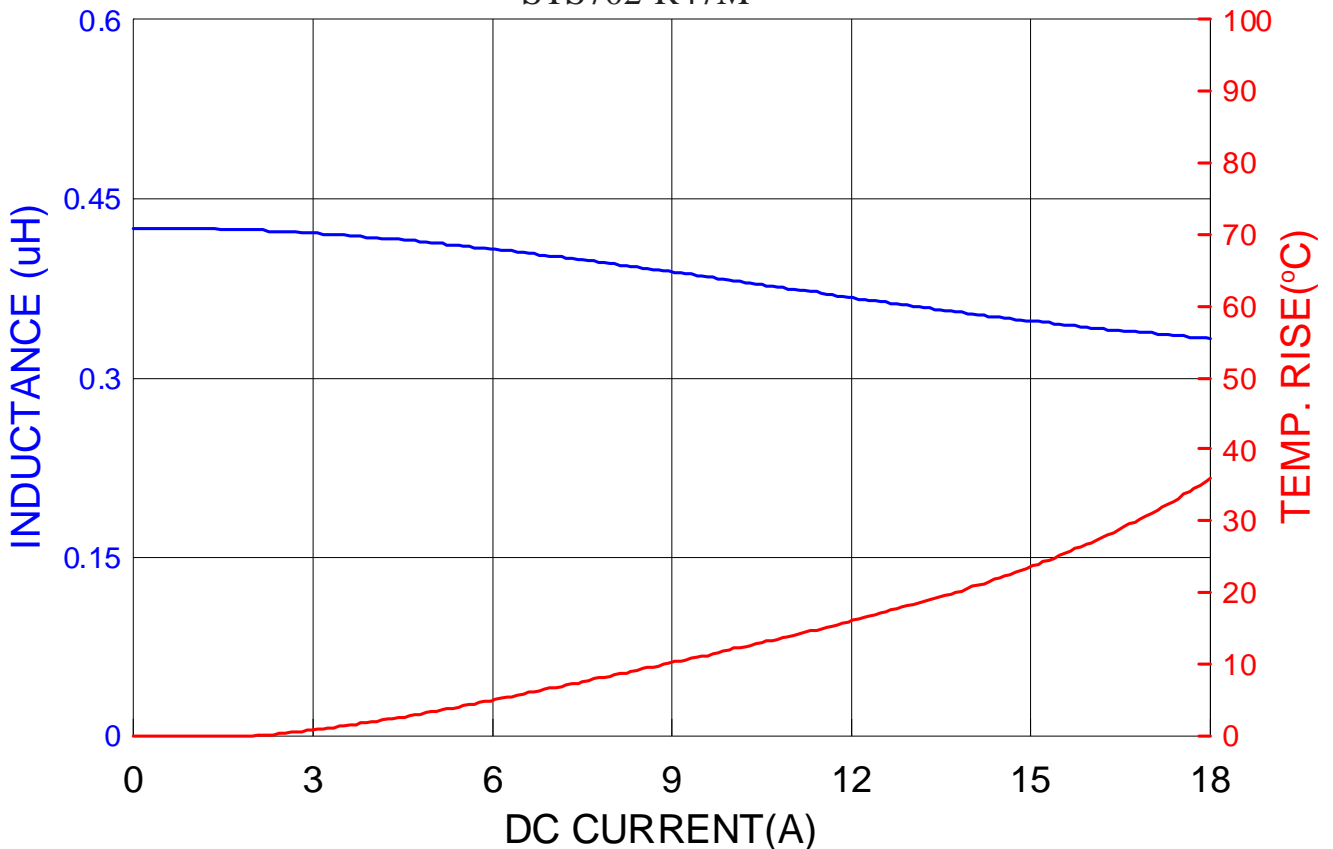

CONFIDENTIAL AND PROPRIETARY INFORMATION  
© 2007 Associated Components Technology, Inc. (Unpublished)  
All Rights Reserved

This document contains confidential and proprietary information of Associated Components Technology, Inc. and is protected by copyright, trade secret and other state and federal laws. Its receipt or possession does not convey any rights to reproduce, disclose its contents, or to manufacture, use or sell anything it may describe. Reproduction, disclosure or use without specific written authorization of Associated Components Technology, Inc is strictly forbidden. Date of Disclosure is Mar 20, 2007.

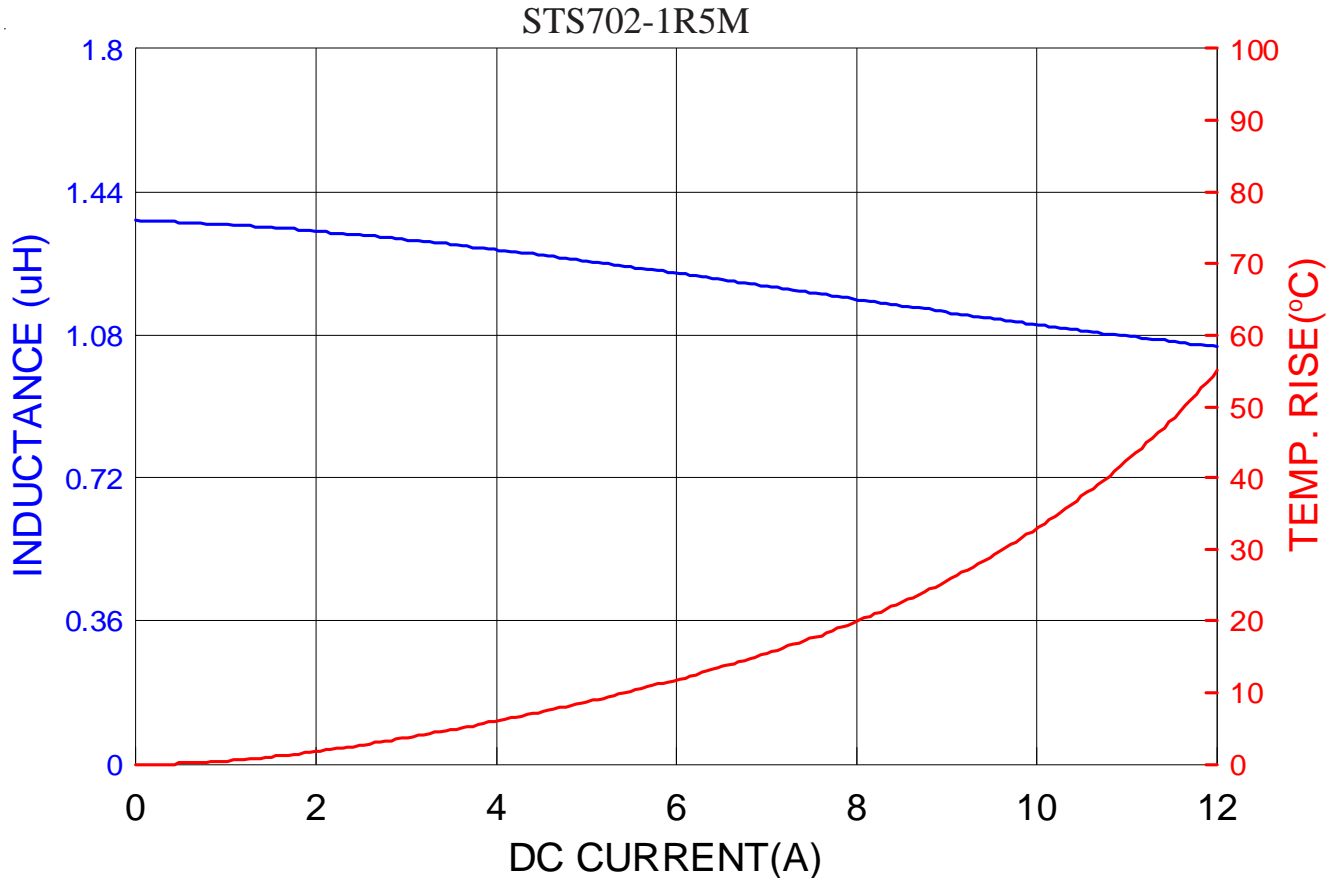
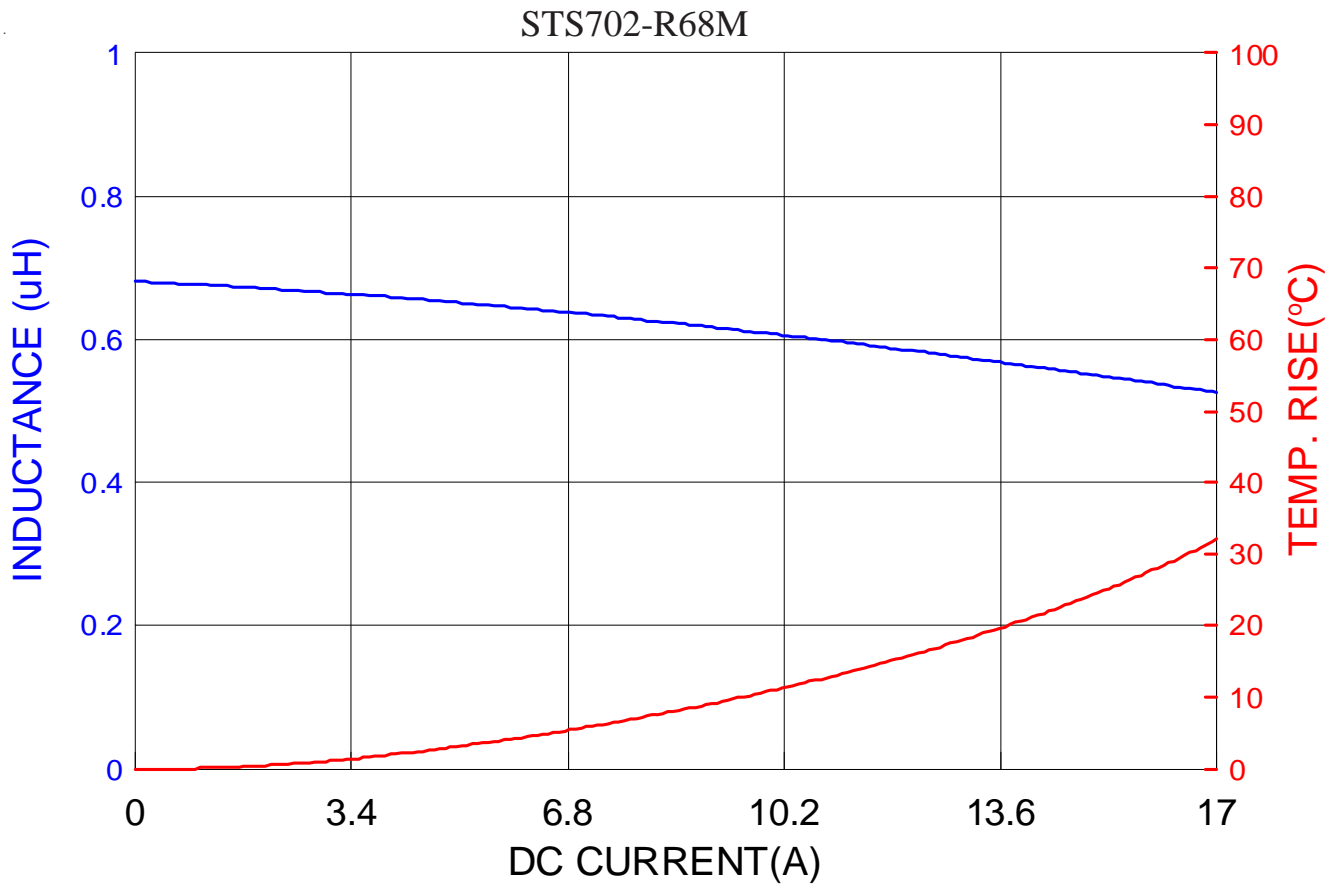

CONFIDENTIAL AND PROPRIETARY INFORMATION  
 © 2007 Associated Components Technology, Inc. (Unpublished)  
 All Rights Reserved

This document contains confidential and proprietary information of Associated Components Technology, Inc. and is protected by copyright, trade secret and other state and federal laws. Its receipt or possession does not convey any rights to reproduce, disclose its contents, or to manufacture, use or sell anything it may describe. Reproduction, disclosure or use without specific written authorization of Associated Components Technology, Inc is strictly forbidden. Date of Disclosure is Mar 20, 2007.

STS702-2R2M

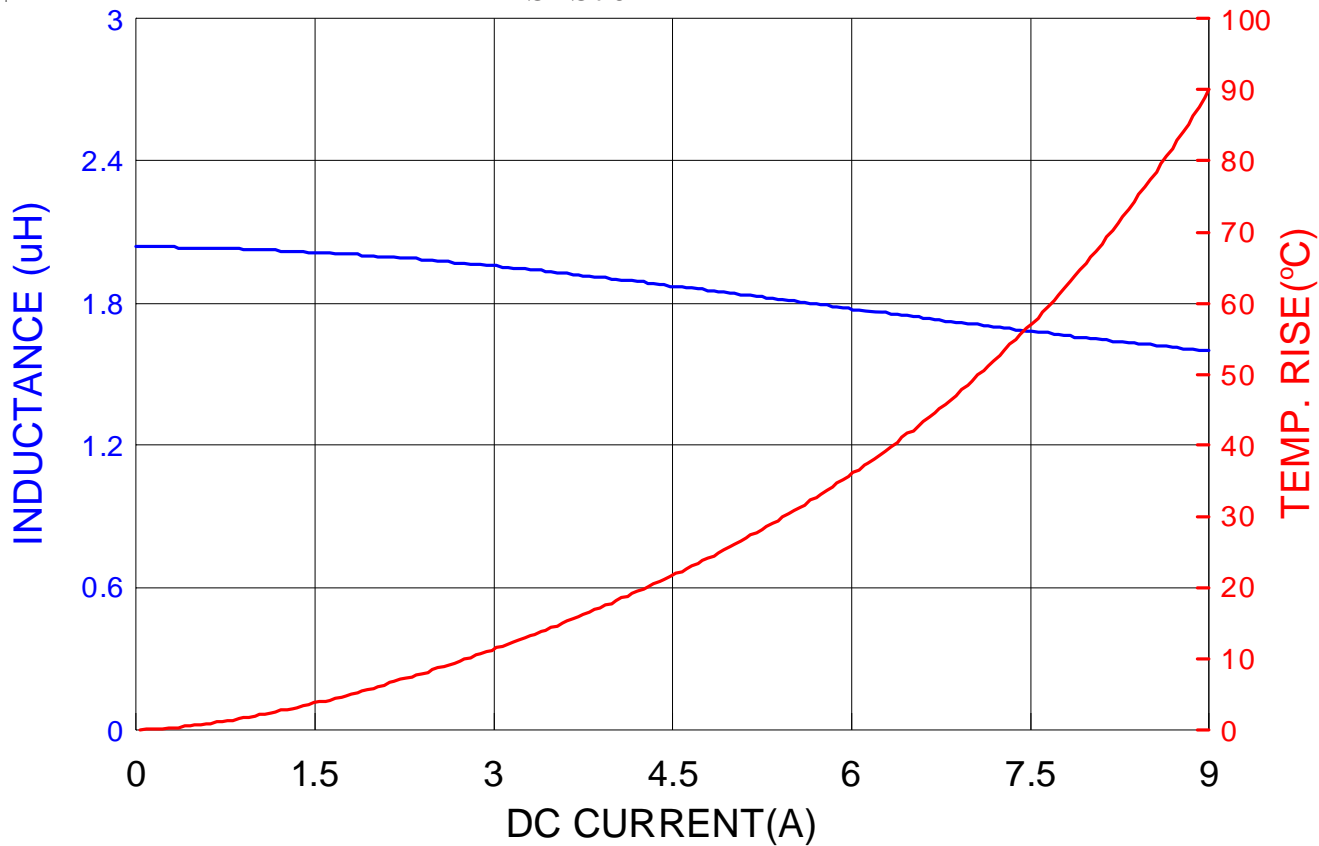

STS702-4R7M

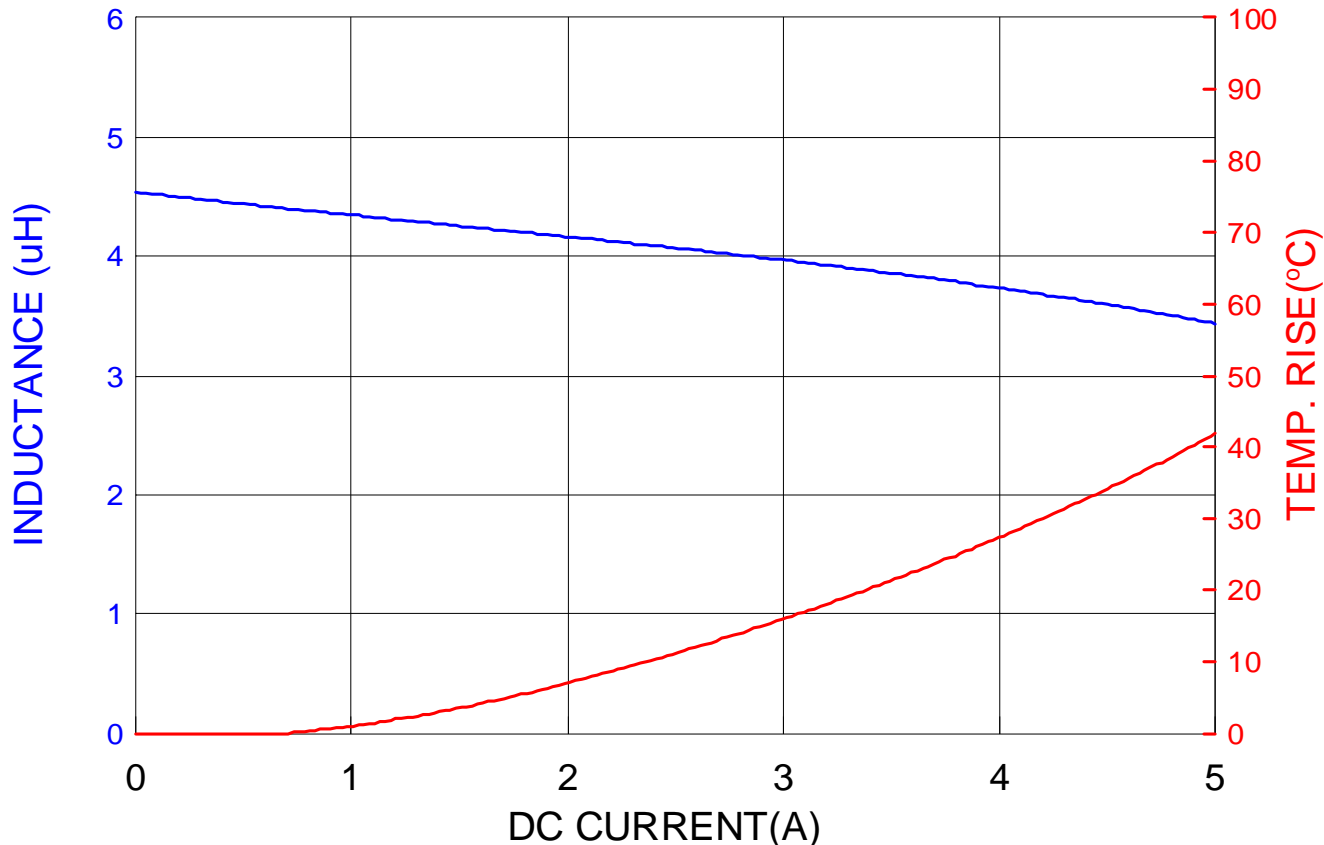

CONFIDENTIAL AND PROPRIETARY INFORMATION  
 © 2007 Associated Components Technology, Inc. (Unpublished)  
 All Rights Reserved

This document contains confidential and proprietary information of Associated Components Technology, Inc. and is protected by copyright, trade secret and other state and federal laws. Its receipt or possession does not convey any rights to reproduce, disclose its contents, or to manufacture, use or sell anything it may describe. Reproduction, disclosure or use without specific written authorization of Associated Components Technology, Inc is strictly forbidden. Date of Disclosure is Mar 20, 2007.