

New Product

**SURFACE MOUNT
SHIELDED POWER INDUCTOR
SERIES STS1305**

FEATURES

- RoHS Compliant
- High current handling capacity
- Low profile
- Low noise, due to composite construction
- High frequency up to 5MHz

ELECTRICAL SPECIFICATIONS

- Inductance range 0.47uH to 10.0uH
- Test condition 1Vrms @ 100kHz
- Test equipment Quadtech 1750 LCR Meter

PHYSICAL SPECIFICATIONS

- Operating temp. -55°C to +125°C
- Core Mixed material
- Packaging T & R 500 pieces per reel
- Tape & reel spec. Tape 24 mm embossed carrier
- Reel 330 mm paper reel

SPECIFICATIONS

Part Number	L(uH)	Tol % ±	DCR (ohms) max	Rated Current (A) (Note 1)	Saturation Current (A) (Note 2)
STS1305-R47M	0.47	20	0.0013	38	45
STS1305-R68M	0.68	20	0.0017	34	39
STS1305-1R0M	1.0	20	0.0025	29	35
STS1305-1R5M	1.5	20	0.0041	23	29
STS1305-2R2M	2.2	20	0.0055	20	27
STS1305-3R3M	3.3	20	0.0092	15	19
STS1305-4R7M	4.7	20	0.0150	12	11
STS1305-6R8M	6.8	20	0.0185	11	11
STS1305-100M	10	20	0.0255	9	12

Dimensions in millimeters

- Length A 13.9 max
- Width B 13.5 max
- Height C 5.2 max
- Terminal length D 2.5 ± 0.5
- Terminal width E 3.0 ± 0.5
- Footprint length F 15 ref
- Pad spacing G 7 ref
- Pad width H 4.5 ref

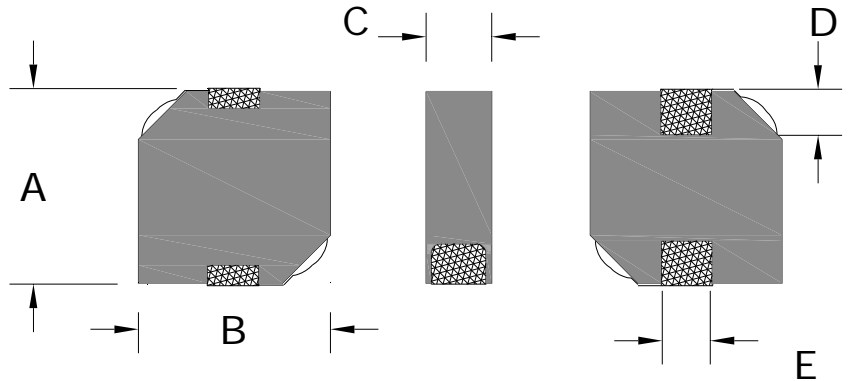

Suggested PCB layout

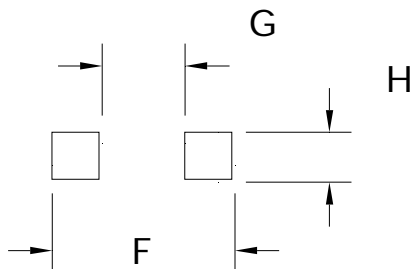

Suggested Reflow Profile

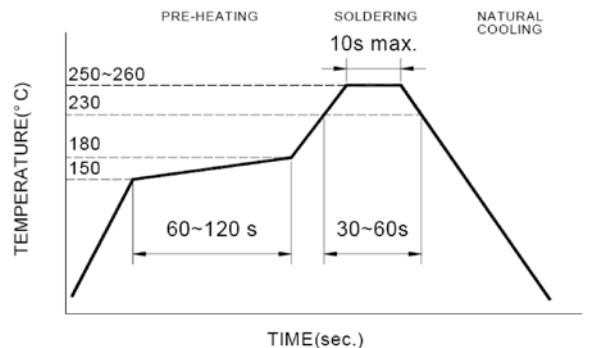

Notes:

1. Based on ΔT approximately 40°C
2. L drops 20% typical

All test data based on 25°C ambient
 Part temperature (ambient + temp rise) must not exceed 125°C under worst case operating conditions.
 Circuit design, components, PCB trace size, airflow and other cooling provisions all effect the part temperature.

STS1305-R47M

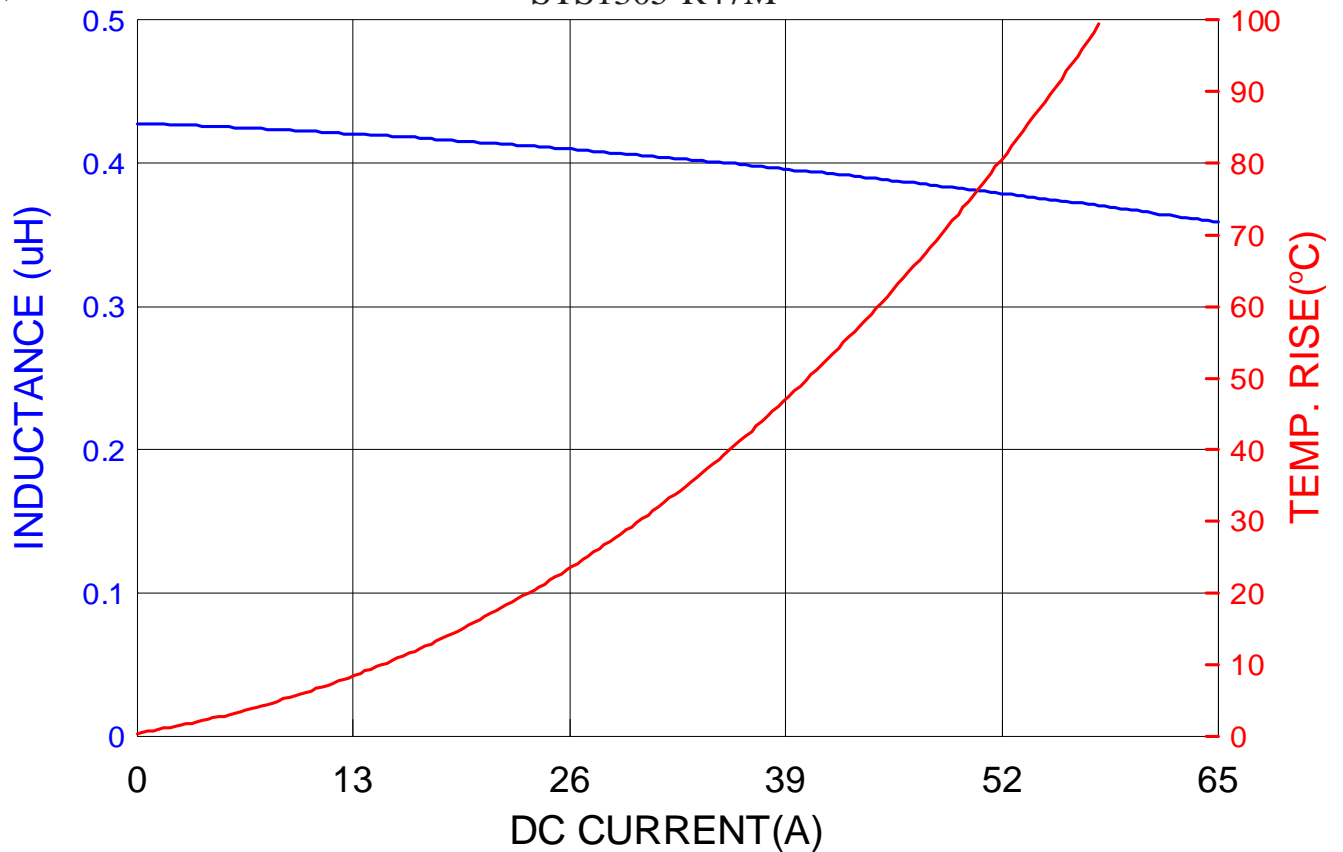

CONFIDENTIAL AND PROPRIETARY INFORMATION
© 2007 Associated Components Technology, Inc. (Unpublished)
All Rights Reserved

This document contains confidential and proprietary information of Associated Components Technology, Inc. and is protected by copyright, trade secret and other state and federal laws. Its receipt or possession does not convey any rights to reproduce, disclose its contents, or to manufacture, use or sell anything it may describe. Reproduction, disclosure or use without specific written authorization of Associated Components Technology, Inc is strictly forbidden. Date of Disclosure is Mar 20, 2007.

STS1305-R68M

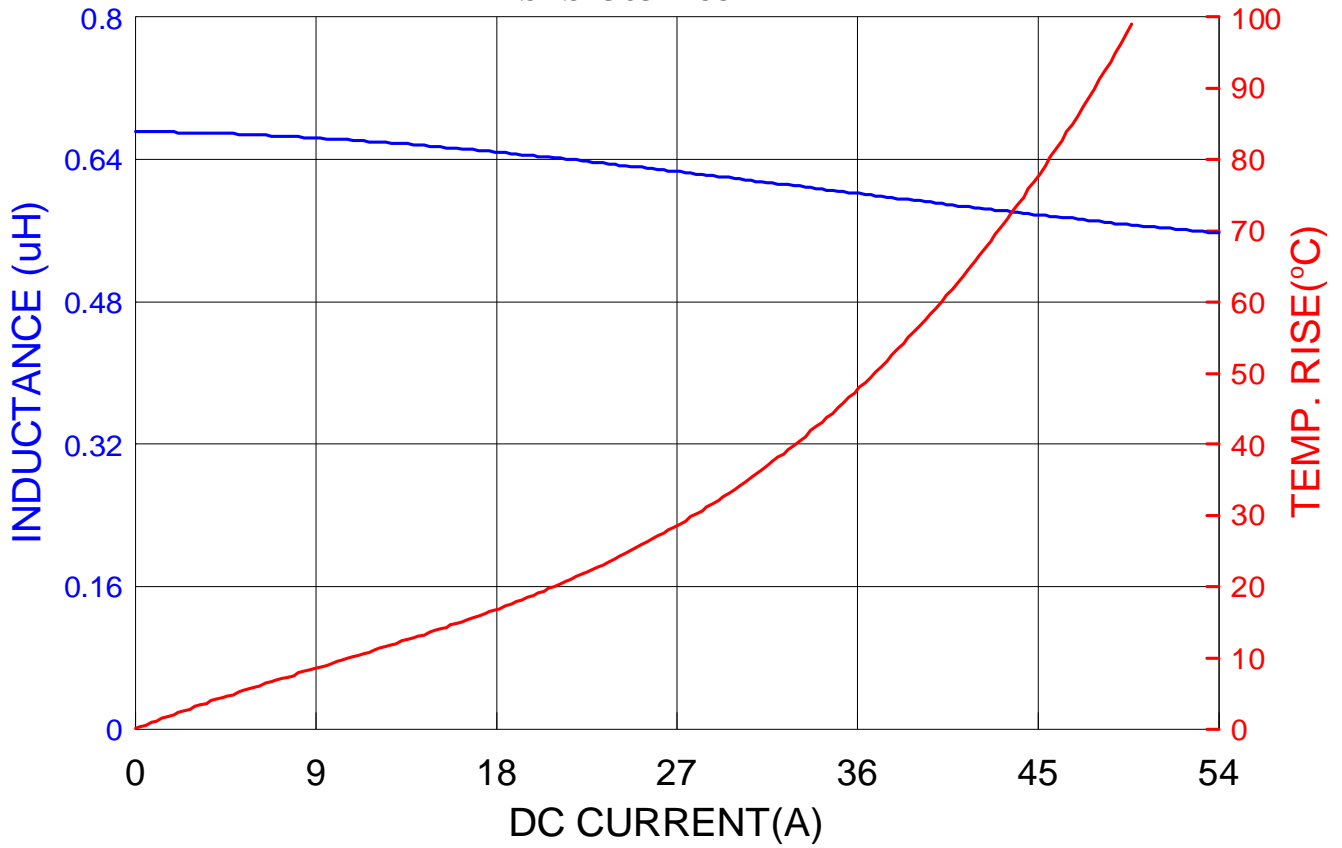

STS1305-1R0M

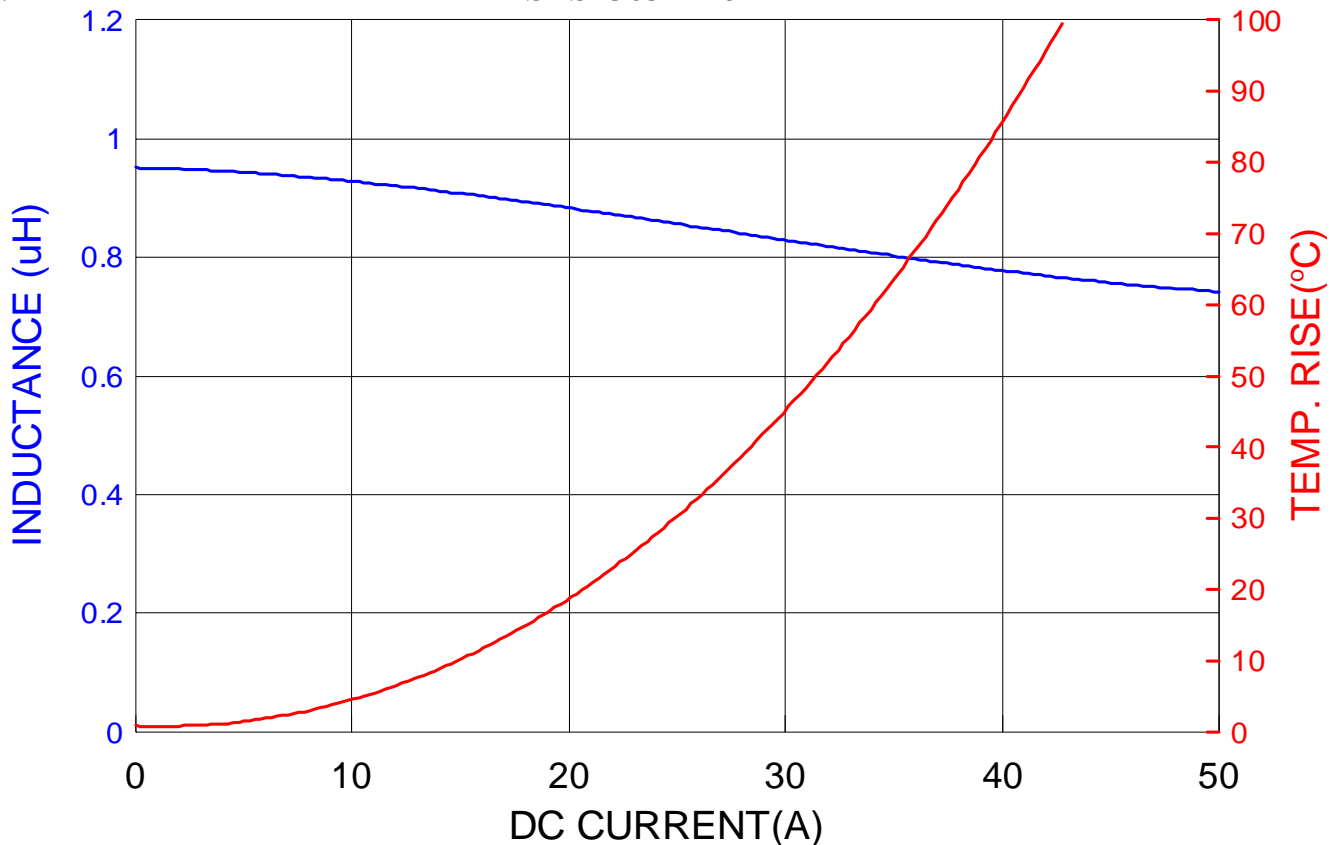

CONFIDENTIAL AND PROPRIETARY INFORMATION
 © 2007 Associated Components Technology, Inc. (Unpublished)
 All Rights Reserved

This document contains confidential and proprietary information of Associated Components Technology, Inc. and is protected by copyright, trade secret and other state and federal laws. Its receipt or possession does not convey any rights to reproduce, disclose its contents, or to manufacture, use or sell anything it may describe. Reproduction, disclosure or use without specific written authorization of Associated Components Technology, Inc is strictly forbidden. Date of Disclosure is Mar 20, 2007.

STS1305-1R5M

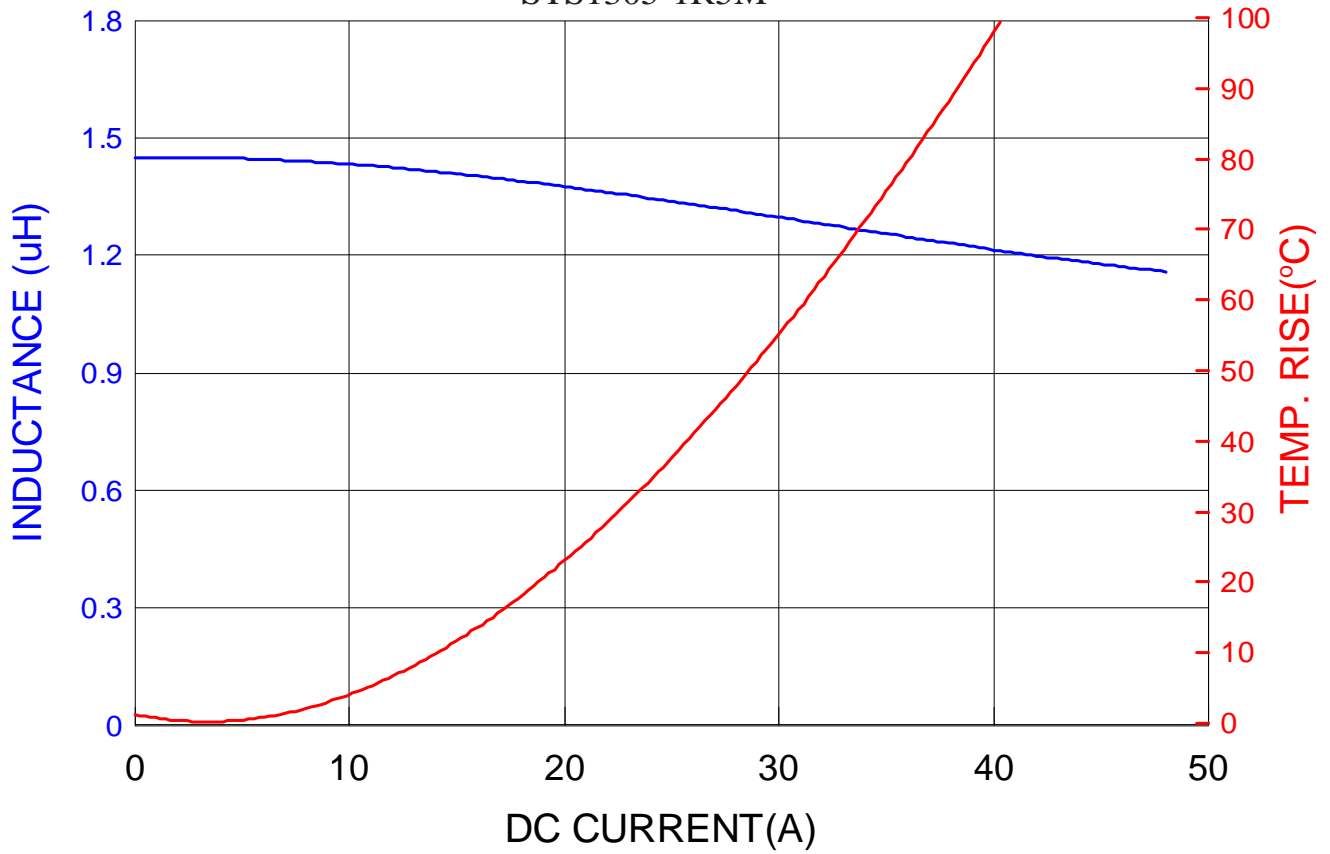

STS1305-2R2M

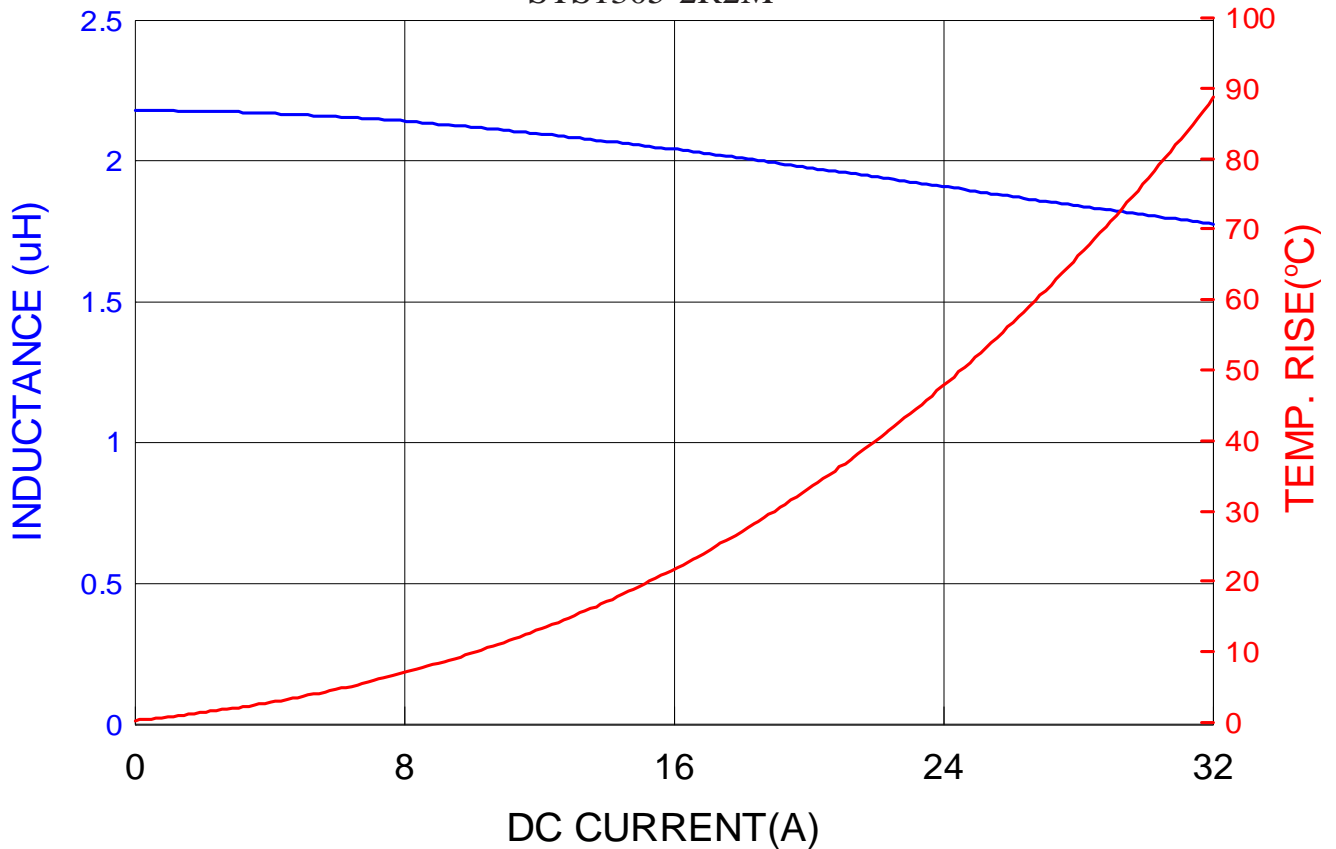

CONFIDENTIAL AND PROPRIETARY INFORMATION
 © 2007 Associated Components Technology, Inc. (Unpublished)
 All Rights Reserved

This document contains confidential and proprietary information of Associated Components Technology, Inc. and is protected by copyright, trade secret and other state and federal laws. Its receipt or possession does not convey any rights to reproduce, disclose its contents, or to manufacture, use or sell anything it may describe. Reproduction, disclosure or use without specific written authorization of Associated Components Technology, Inc is strictly forbidden. Date of Disclosure is Mar 20, 2007.

STS1305-3R3M

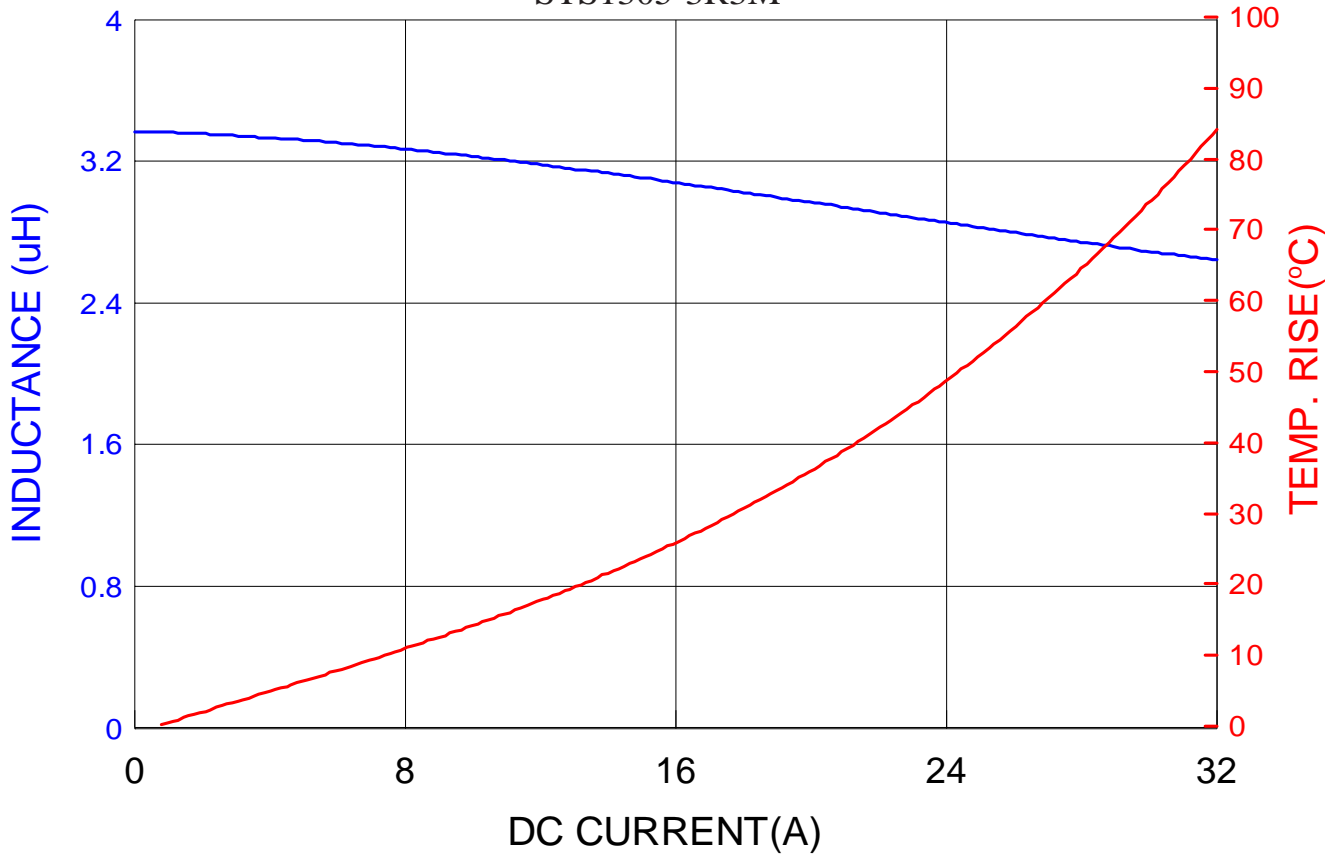

STS1305-4R7M

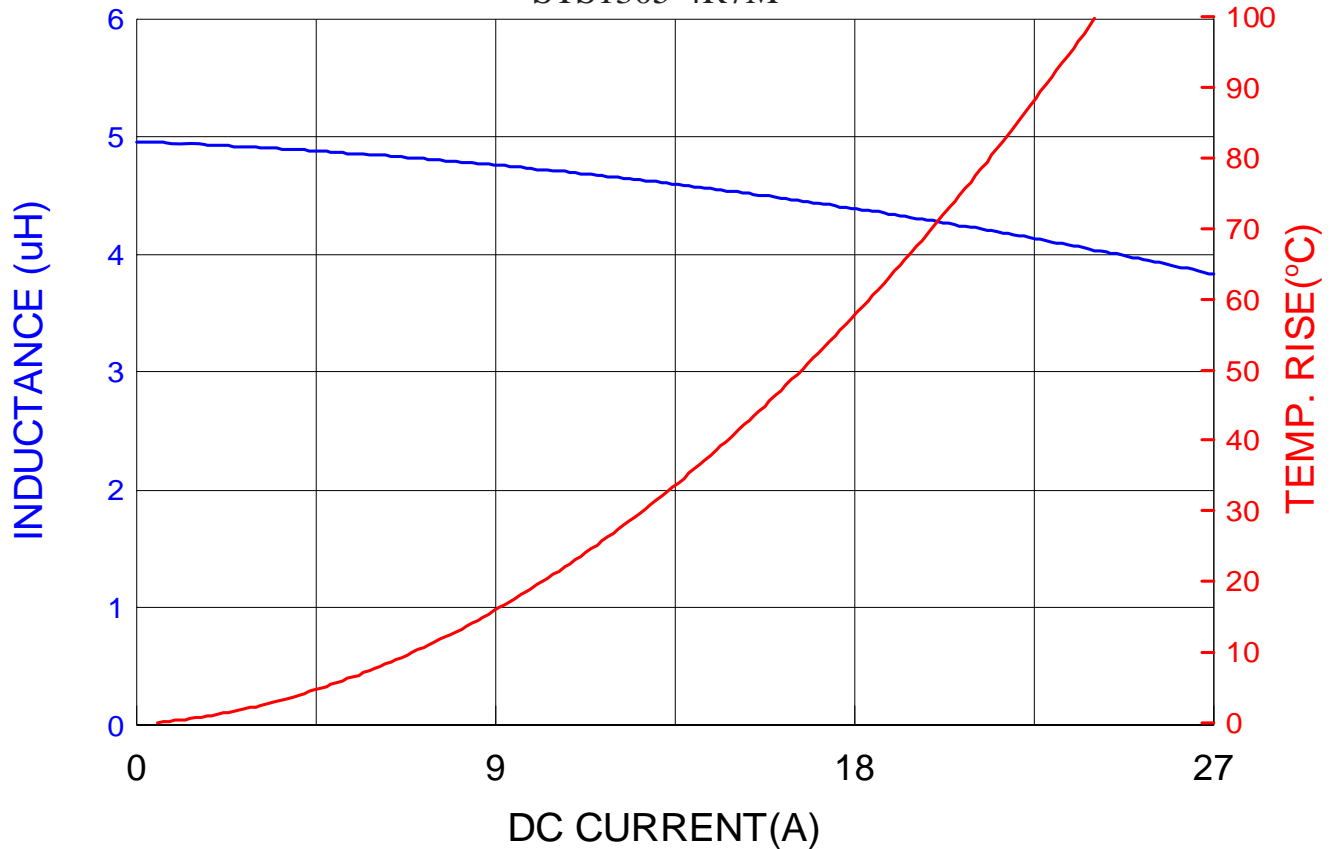

CONFIDENTIAL AND PROPRIETARY INFORMATION
 ©2007 Associated Components Technology, Inc. (Unpublished)
 All Rights Reserved

This document contains confidential and proprietary information of Associated Components Technology, Inc. and is protected by copyright, trade secret and other state and federal laws. Its receipt or possession does not convey any rights to reproduce, disclose its contents, or to manufacture, use or sell anything it may describe. Reproduction, disclosure or use without specific written authorization of Associated Components Technology, Inc is strictly forbidden. Date of Disclosure is Mar 20, 2007.

STS1305-6R8M

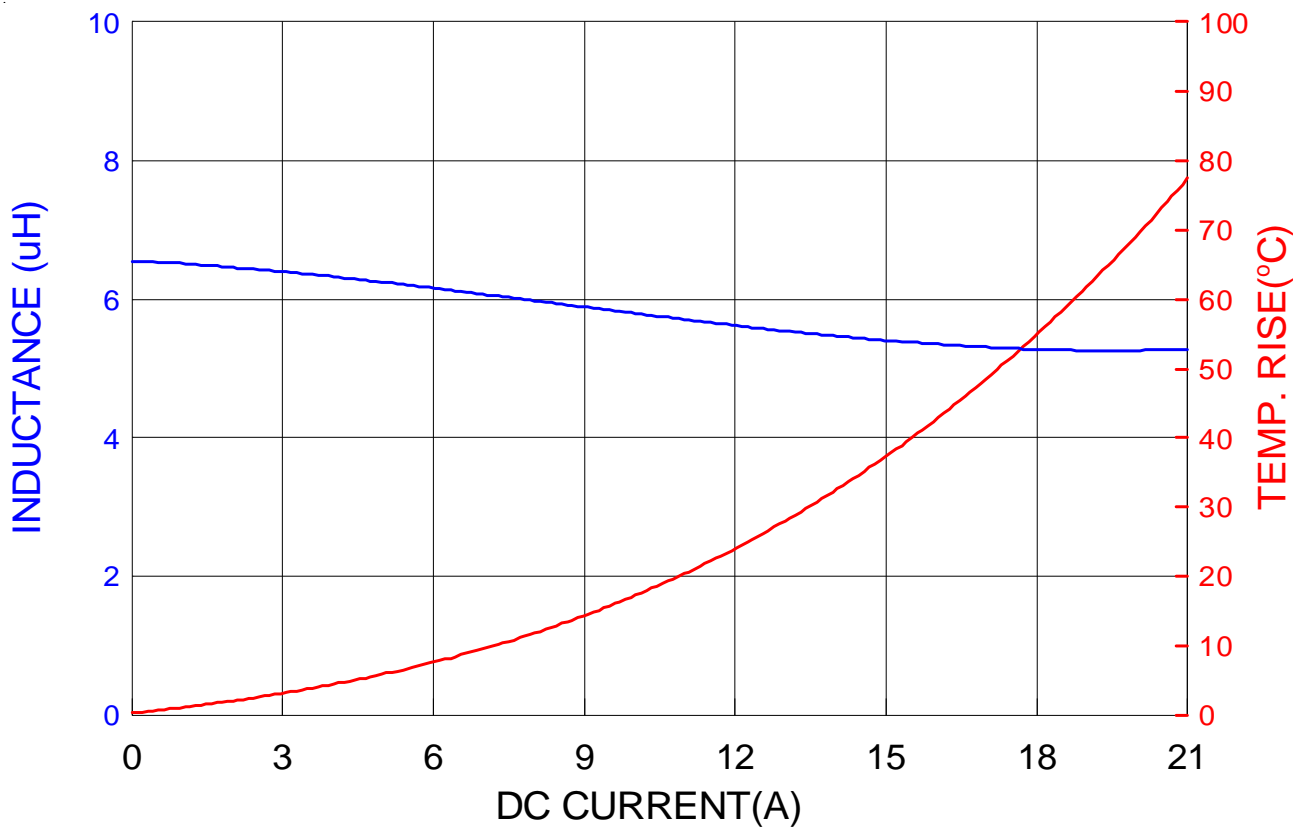

STS1305-100M

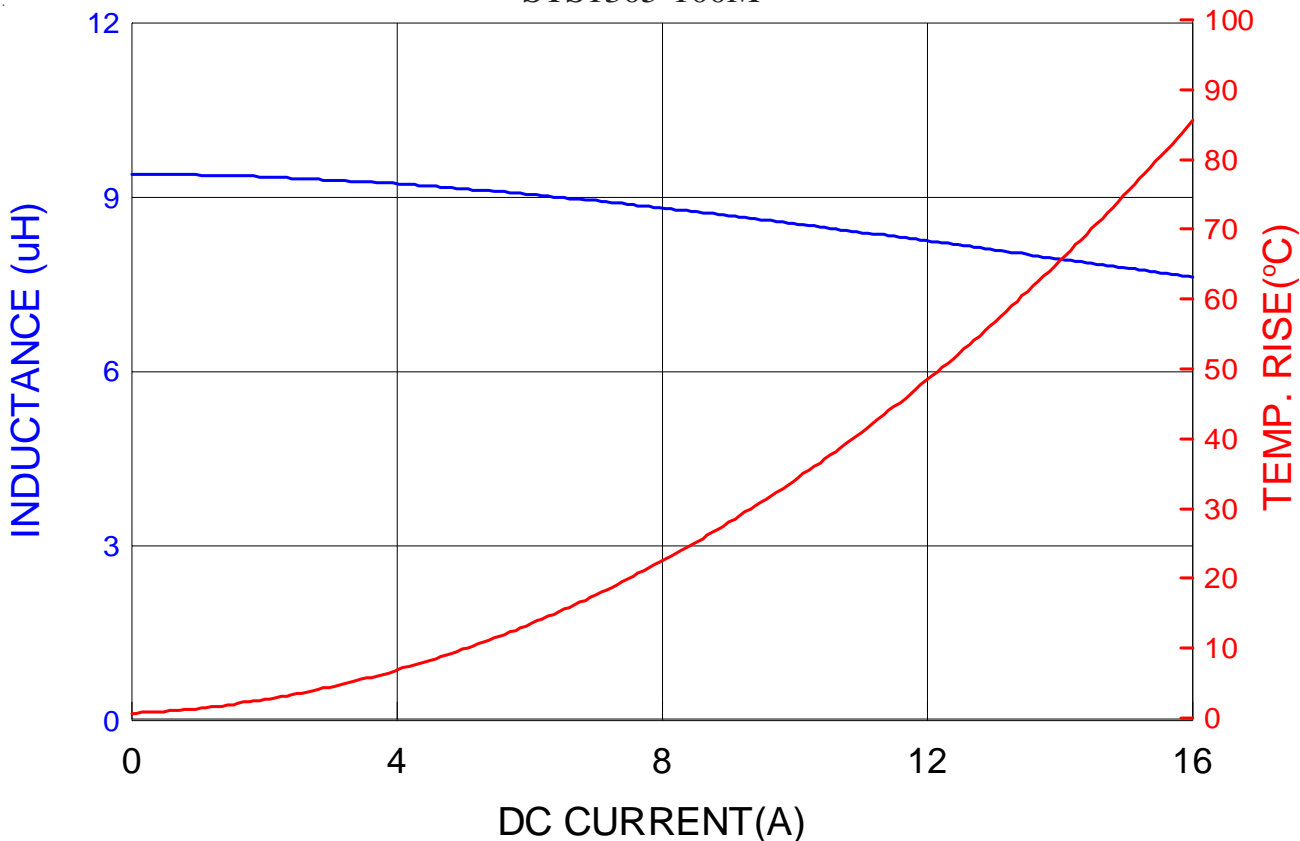

CONFIDENTIAL AND PROPRIETARY INFORMATION
 © 2007 Associated Components Technology, Inc. (Unpublished)
 All Rights Reserved

This document contains confidential and proprietary information of Associated Components Technology, Inc. and is protected by copyright, trade secret and other state and federal laws. Its receipt or possession does not convey any rights to reproduce, disclose its contents, or to manufacture, use or sell anything it may describe. Reproduction, disclosure or use without specific written authorization of Associated Components Technology, Inc is strictly forbidden. Date of Disclosure is Mar 20, 2007.