

## New Product

### WIREWOUND SHIELDED HIGH CURRENT POWER INDUCTOR SERIES HCPI1410

#### FEATURES

- RoHS Compliant
- High current handling capacity
- Extra-robust construction for extreme applications
- No noise under heavy load

#### ELECTRICAL SPECIFICATIONS

- Inductance range 0.6uH to 1.2uH
- Test condition 1Vrms @ 100kHz
- Test equipment Quadtech 1750 LCR Meter

#### PHYSICAL SPECIFICATIONS

- Operating temp. -55°C to +125°C
- Core Composite material
- Packaging Bulk packed, 180 pcs/tray

#### Dimensions in millimeters

- Length A 14.0 max
- Width B 14.0 max
- Height C 11.0 max
- Terminal pitch D 11.5 ref
- Terminal pitch E 5.5 ref
- Terminal hole width F 2.8 min
- Terminal hole length G 1.4 min
- Terminal thickness T 1.3 ref
- Terminal width W 2.5 ref

#### Suggested PCB layout

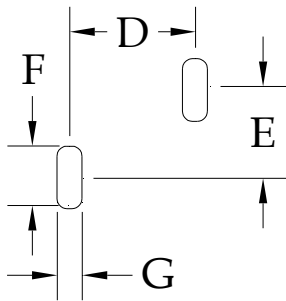

#### Notes:

1. Based on  $\Delta T$  of approximately 40°C
2. Based on  $\Delta L$  of approximately -20%

All data based on 25°C ambient

Part temperature (ambient + temp rise) must not exceed 125°C under worst case operating conditions.

#### SPECIFICATIONS

Part Number	L(uH) $\pm 20\%$	DCR (ohms) max	Rated Current (A) (Note 1)	Saturation Current (A) (Note 2)
HCPI1410-R60M	0.60	0.0011	42	50
HCPI1410-R80M	0.80	0.0011	40	50
HCPI1410-1R2M	1.20	0.0018	25	40

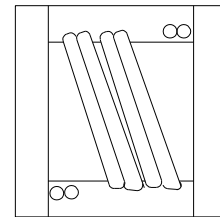
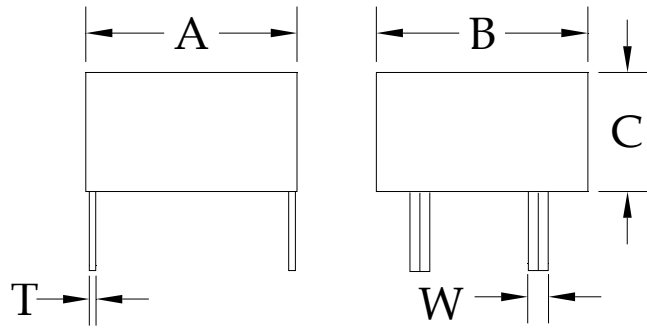

#### Suggested Reflow Profile

