

TSC Series

Screw Cover Terminal Enclosure

Adalet's Screw Cover Terminal Enclosures are available in stainless Steel 304 & 316L. Silicone gasket, slotted captive cover bolts, box and cover ground studs including an external earthing stud, and universal rail mounting system are included as standard (except 050503, mtg pan used).

STANDARD FEATURES

- 18 standard sizes available
- Stainless steel captive hex head, slotted cover screws
- Continuous one-piece water tight silicone gasket
- Internal rail mounting system (except 050503)
- Ground stud on box and cover
- External ground stud
- Wall mounting flange with .31" clearance holes

DESIGN OPTIONS

- Gland plates (6" deep or greater) can be supplied pre-drilled or blank for field drilling
- Drilled entries and cut-outs
- Hinged cover
- Breather / drain, stopping plugs, cable glands and conduit fittings
- Terminal block assemblies
- Stainless steel or painted steel mounting panels
- Internal earth bar
- Custom sizes
- Cable glands

MATERIAL

- Type 304 or 316L Stainless Steel
- Enclosure and cover constructed from 14 gauge (.075) stainless steel with #3/4 brush finish
- Gland plates constructed from 10 gauge (.1345) stainless steel with a #3/4 brush finish
- Silicone gasket constructed from 1/4" Bisco silicone with acrylic PSA
- Gland plate gasket constructed from 1/8" Bisco silicone with acrylic PSA

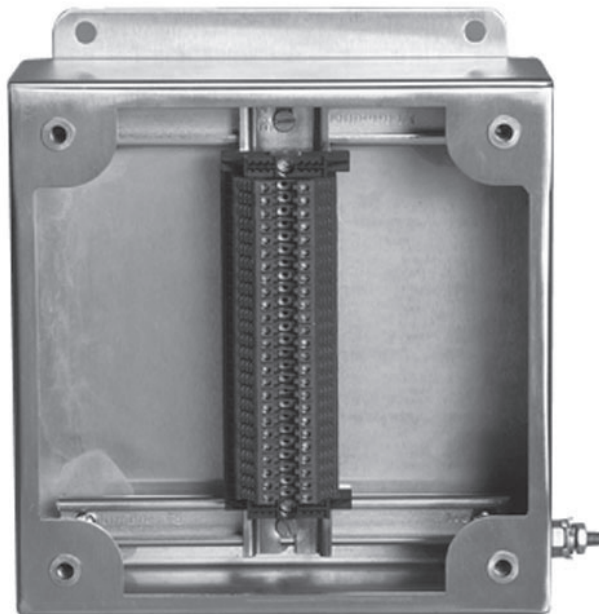

CERTIFICATIONS

POPULATED ENCLOSURE

Class I, Division 2, Groups A, B, C, D
 Class II, Division 2, Groups F, G
 Class I, Zone 1, AEx e II (T5: Ta < +55 °C) (T4: Ta < +70 °C)
 Ex e II T6 (T5: Ta < +55 °C) (T4: Ta < +70 °C)
 NEMA Type 4X, 12, 13
 CE 0539 II 2 G Ex e II T6 (T5: Ta < +55 °C) (T4: Ta < +70 °C)
 CE 0539 II 2 D Ex tD A21 IP66 T200 °C
 IECEx UL 09.0017X
 Ex e II T6 (T5: Ta < +55 °C) (T4: Ta < +70 °C)
 Ex tD A21 IP66 T200 °C

EMPTY ENCLOSURE

Class II, Division 2
 Class I, Zone 1, AEx e II
 Ex e II
 NEMA Type 4X, 12, 13
 DEMKO 01 ATEX 0113363U
 CE 0539 II 2 GD
 Ex tD A21 IP66



MAXIMUM TERMINAL BLOCK CONTENT												
CAT. NUMBER	2.5mm		4mm		6mm		10mm		16mm		35mm	
	# ROWS	QTY.	# ROWS	QTY.	# ROWS	QTY.	# ROWS	QTY.	# ROWS	QTY.	# ROWS	QTY.
TSC4X6-050503	1	6	1	6	1	5	0	0	0	0	0	0
TSC4X6-060604	1	13	1	13	1	8	0	0	0	0	0	0
TSC4X6-070704	1	18	1	18	1	11	1	9	0	0	0	0
TSC4X6-080804	1	23	1	23	1	14	1	11	0	0	0	0
TSC4X6-101006	2	66	2	66	2	42	1	17	1	14	0	0
TSC4X6-101008	2	66	2	66	2	42	1	17	1	14	0	0
TSC4X6-120604	1	43	1	43	1	27	0	0	0	0	0	0
TSC4X6-120605	1	43	1	43	1	27	0	0	0	0	0	0
TSC4X6-120805	1	43	1	43	1	27	1	22	0	0	0	0
TSC4X6-120806	1	43	1	43	1	27	1	22	0	0	0	0
TSC4X6-121206	2	86	2	86	2	54	2	44	1	18	0	0
TSC4X6-121208	2	86	2	86	2	54	2	44	1	18	0	0
TSC4X6-151506	3	177	3	177	3	111	2	58	2	48	1	18
TSC4X6-151508	3	177	3	177	3	111	2	58	2	48	1	18
TSC4X6-161206	2	128	2	128	2	80	2	64	1	266	0	0
TSC4X6-161208	2	128	2	128	2	80	2	64	1	26	0	0
TSC4X6-161606	3	192	3	192	3	120	3	96	2	52	1	20
TSC4X6-161608	3	192	3	192	3	120	3	96	2	52	1	20

NOTES

1. The TSC4 Series is available either in SS316L (TSC4X6) or SS304 (TSC4X).
2. Refer to enclosure catalog page for dimensional information.
3. The maximum terminal block content is based on the following maximum permitted continuous current and minimum conductor size (See chart right).
4. For higher ampacities refer to enclosure catalog page.
5. The maximum terminal block content is based on vertical rail installation. For horizontal installations, consult factory.
6. For applications requiring multiple terminal block configurations and ampacities, consult factory.
7. For applications requiring larger terminal blocks or custom enclosure sizes, consult factory.

MAX CURRENT	MIN CONDUCTOR SIZE
10 AMPS	1.5mm ² (16 AWG)
16 AMPS	2.5 mm ² (14 AWG)
20 AMPS	4 mm ² (12 AWG)
25 AMPS	6 mm ² (10 AWG)
35 AMPS	10 mm ² (8 AWG)
63 AMPS	16 mm ² (6 AWG)

INCREASED SAFETY

TERMINAL ENCLOSURES

INCREASED SAFETY ENCLOSURES

TSC Series 5" x 5" x 3" Enclosure

STAINLESS STEEL 304

ENCLOSURE WITH TERMINALS

CAT. NUMBER	GLAND PLATE
TSC4X-050503	None

STAINLESS STEEL 316L

ENCLOSURE WITH TERMINALS

CAT. NUMBER	GLAND PLATE
TSC4X6-050503	None

MAXIMUM NUMBER OF CABLE/CONDUIT ENTRIES

SIZE		WITHOUT GLAND PLATES	
NPT	Metric	Sides A & B	Sides C & D
1/2	M16	2	2
3/4	M20	2	2
1	M25	1	1
1 1/4	M32	-	-
1 1/2	M40	-	-
2	M50	-	-
2 1/2	M63	-	-

MAXIMUM TERMINAL BLOCK CONTENT

MIN CONDUCTOR SIZE	.5mm ²	1.5mm ²	2.5mm ²	4mm ²	6mm ²	10mm ²	16mm ²	35mm ²
MIN CONDUCTOR SIZE AWG	22	16	14	12	10	8	6	2
MAXIMUM AMPERAGE	3	8 10	16 20	25 35	50 63	80 100		
1.5mm ²	← 6 →		x	x	x	x	x	x
2.5mm ²	6			x	x	x	x	x
4mm ²	← 6 →				x	x	x	x
6mm ²	5					x	x	x
10mm ²	x	x	x	x	x	x	x	x
16mm ²	x	x	x	x	x	x	x	x
35mm ²	x	x	x	x	x	x	x	x

- NOTES**
- The maximum terminal block content is based on vertical rail installation. For horizontal installations, consult factory.
 - For applications requiring multiple terminal block configurations and ampacities, consult factory.
 - For applications requiring larger terminal blocks or custom enclosure sizes, consult factory.
 - For conduit/cable spacings, wire bending and wire conversion guidelines, refer to the inside back cover of this catalog.

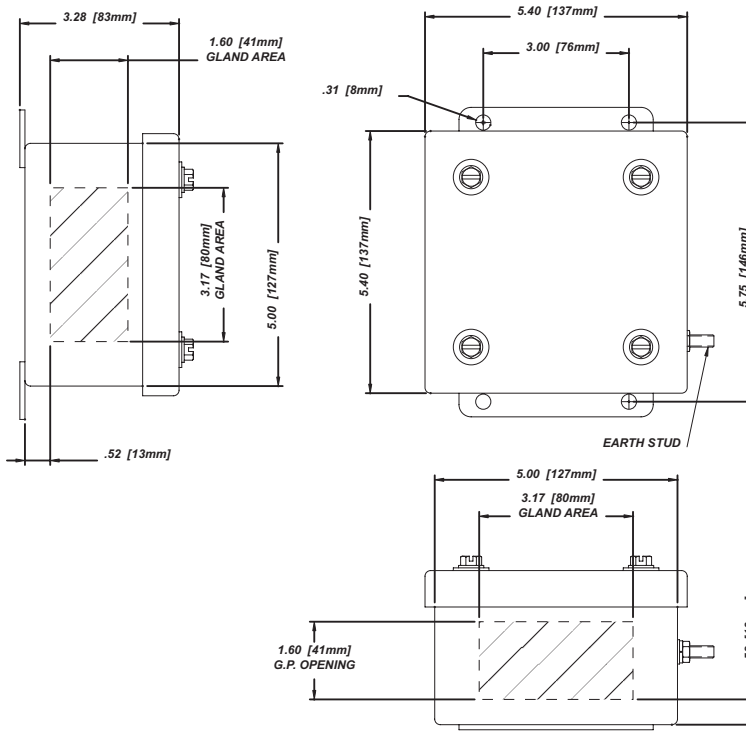

TERMINAL ENCLOSURES

INCREASED SAFETY ENCLOSURES

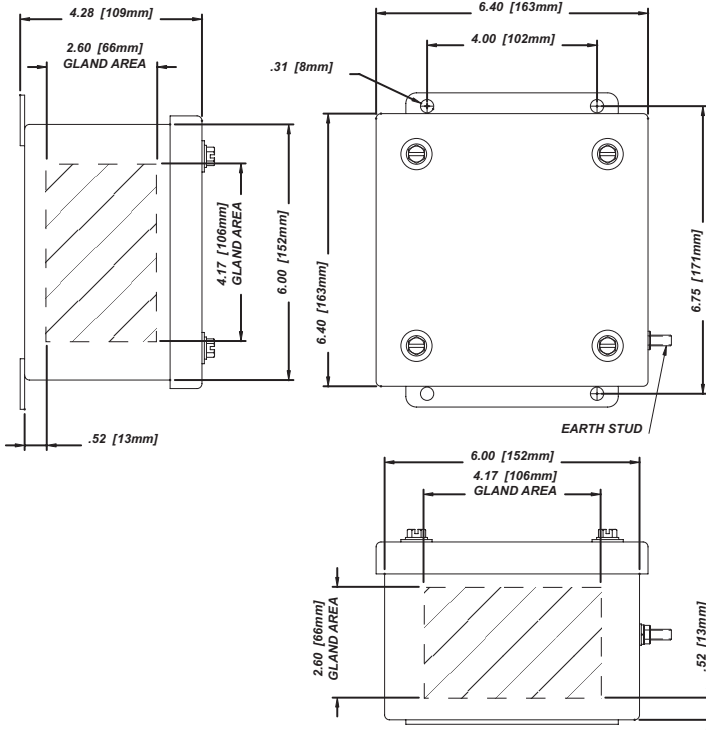

TSC Series 6" x 6" x 4" Enclosure

STAINLESS STEEL 304

ENCLOSURE WITH TERMINALS

CAT. NUMBER	GLAND PLATE
TSC4X-060604	None

STAINLESS STEEL 316L

ENCLOSURE WITH TERMINALS

CAT. NUMBER	GLAND PLATE
TSC4X6-060604	None

MAXIMUM NUMBER OF CABLE/CONDUIT ENTRIES

SIZE		WITHOUT GLAND PLATES	
NPT	Metric	Sides A & B	Sides C & D
1/2	M16	6	6
3/4	M20	3	3
1	M25	2	2
1 1/4	M32	2	2
1 1/2	M40	1	1
2	M50	-	-
2 1/2	M63	-	-

MAXIMUM TERMINAL BLOCK CONTENT

MIN CONDUCTOR SIZE		.5mm ²	1.5mm ²		2.5mm ²		4mm ²	6mm ²	10mm ²	16mm ²	35mm ²	
MIN CONDUCTOR SIZE AWG		22	16		14		12	10	8	6	2	
MAXIMUM AMPERAGE		3	8	10	16	20	25	35	50	63	80	100
Terminal Block Size	1.5mm ²	← 13 →			x	x	x	x	x	x	x	x
	2.5mm ²	← 13 →				9	x	x	x	x	x	x
	4mm ²	← 13 →					10	x	x	x	x	x
	6mm ²	← 8 →							x	x	x	x
	10mm ²	x	x	x	x	x	x	x	x	x	x	x
	16mm ²	x	x	x	x	x	x	x	x	x	x	x
	35mm ²	x	x	x	x	x	x	x	x	x	x	x

- NOTES**
1. The maximum terminal block content is based on vertical rail installation. For horizontal installations, consult factory.
 2. For applications requiring multiple terminal block configurations and ampacities, consult factory.
 3. For applications requiring larger terminal blocks or custom enclosure sizes, consult factory.
 4. For conduit/cable spacings, wire bending and wire conversion guidelines, refer to the inside back cover of this catalog.

INCREASED SAFETY

TERMINAL ENCLOSURES

INCREASED SAFETY ENCLOSURES

TSC Series 7" x 7" x 4" Enclosure

STAINLESS STEEL 304

ENCLOSURE WITH TERMINALS

CAT. NUMBER	GLAND PLATE
TSC4X-070704	None

STAINLESS STEEL 316L

ENCLOSURE WITH TERMINALS

CAT. NUMBER	GLAND PLATE
TSC4X6-070704	None

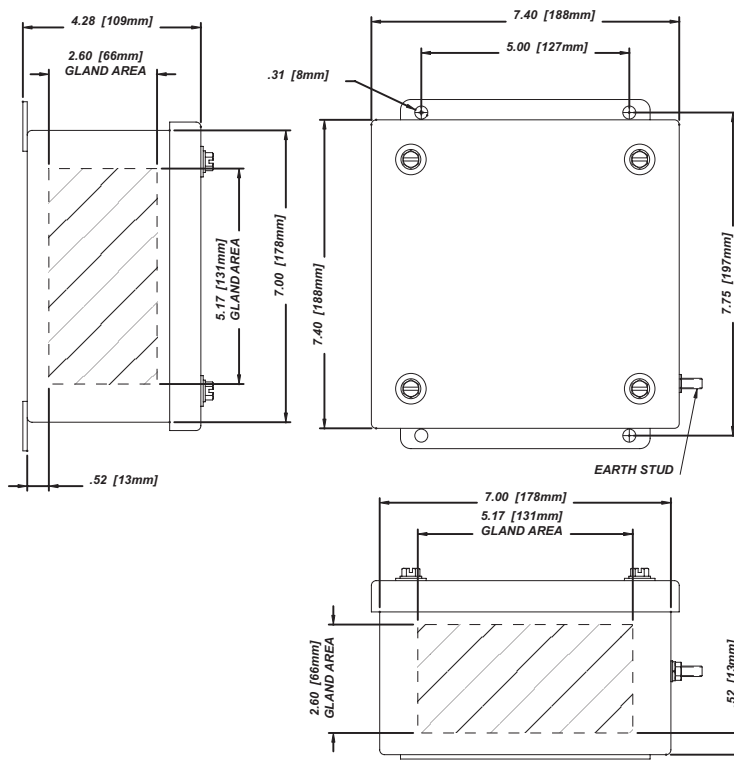

MAXIMUM NUMBER OF CABLE/CONDUIT ENTRIES

SIZE		WITHOUT GLAND PLATES	
NPT	Metric	Sides A & B	Sides C & D
1/2	M16	8	8
3/4	M20	3	3
1	M25	3	3
1 1/4	M32	2	2
1 1/2	M40	2	2
2	M50	-	-
2 1/2	M63	-	-

MAXIMUM TERMINAL BLOCK CONTENT

MIN CONDUCTOR SIZE		.5mm ²	1.5mm ²	2.5mm ²	4mm ²	6mm ²	10mm ²	16mm ²	35mm ²			
MIN CONDUCTOR SIZE AWG		22	16	14	12	10	8	6	2			
MAXIMUM AMPERAGE		3	8	10	16	20	25	35	50	63	80	100
Terminal Block Size	1.5mm ²	← 18 →		x	x	x	x	x	x	x	x	
	2.5mm ²	← 18 →			10	x	x	x	x	x	x	
	4mm ²	← 18 →				11	x	x	x	x		
	6mm ²	← 11 →					8	x	x	x	x	
	10mm ²	← 9 →						7	x	x	x	
	16mm ²	x	x	x	x	x	x	x	x	x	x	
	35mm ²	x	x	x	x	x	x	x	x	x	x	

- NOTES**
- The maximum terminal block content is based on vertical rail installation. For horizontal installations, consult factory.
 - For applications requiring multiple terminal block configurations and ampacities, consult factory.
 - For applications requiring larger terminal blocks or custom enclosure sizes, consult factory.
 - For conduit/cable spacings, wire bending and wire conversion guidelines, refer to the inside back cover of this catalog.

TERMINAL ENCLOSURES

INCREASED SAFETY ENCLOSURES

TSC Series 8" x 8" x 4" Enclosure

STAINLESS STEEL 304

ENCLOSURE WITH TERMINALS

CAT. NUMBER	GLAND PLATE
TSC4X-080804	None

STAINLESS STEEL 316L

ENCLOSURE WITH TERMINALS

CAT. NUMBER	GLAND PLATE
TSC4X6-080804	None

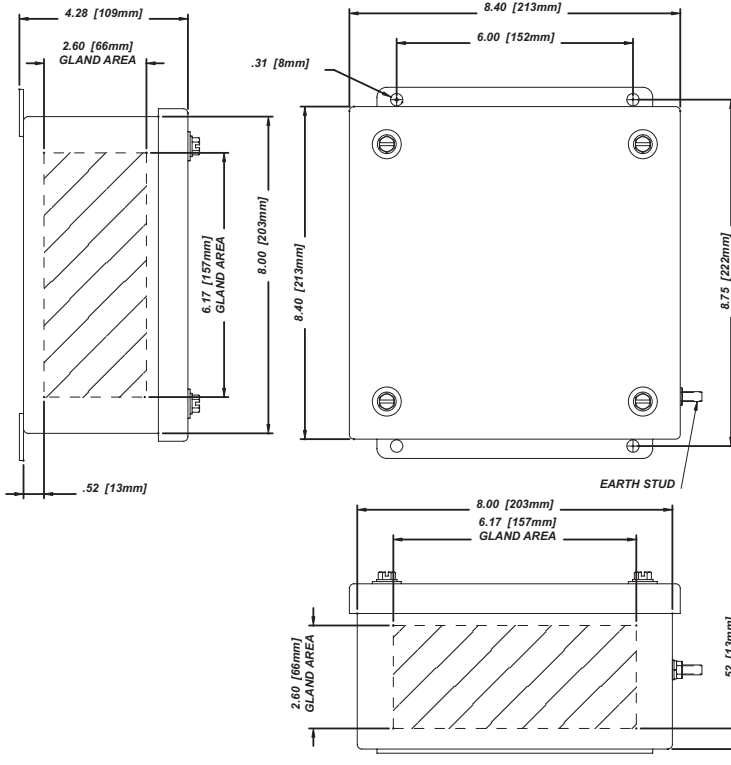

MAXIMUM NUMBER OF CABLE/CONDUIT ENTRIES

SIZE		WITHOUT GLAND PLATES	
NPT	Metric	Sides A & B	Sides C & D
1/2	M16	10	10
3/4	M20	4	4
1	M25	3	3
1 1/4	M32	2	2
1 1/2	M40	2	2
2	M50	-	-
2 1/2	M63	-	-

MAXIMUM TERMINAL BLOCK CONTENT

MIN CONDUCTOR SIZE	.5mm ²	1.5mm ²	2.5mm ²	4mm ²	6mm ²	10mm ²	16mm ²	35mm ²			
MIN CONDUCTOR SIZE AWG	22	16	14	12	10	8	6	2			
MAXIMUM AMPERAGE	3	8	10	16	20	25	35	50	63	80	100
Terminal Block Size	1.5mm ²	← 23 →		x	x	x	x	x	x	x	x
	2.5mm ²	← 23 →		19	11	x	x	x	x	x	x
	4mm ²	← 23 →		21	12	x	x	x	x	x	x
	6mm ²	← 14 →				9	x	x	x	x	x
	10mm ²	← 11 →					7	x	x	x	x
	16mm ²	x	x	x	x	x	x	x	x	x	x
	35mm ²	x	x	x	x	x	x	x	x	x	x

- NOTES**
- The maximum terminal block content is based on vertical rail installation. For horizontal installations, consult factory.
 - For applications requiring multiple terminal block configurations and ampacities, consult factory.
 - For applications requiring larger terminal blocks or custom enclosure sizes, consult factory.
 - For conduit/cable spacings, wire bending and wire conversion guidelines, refer to the inside back cover of this catalog.

TERMINAL ENCLOSURES

INCREASED SAFETY ENCLOSURES

TSC Series 10" x 10" x 6" Enclosure

STAINLESS STEEL 304

ENCLOSURES WITH TERMINALS

Catalog Number	Gland Plate
TSC4X-101006	None
TSC4X-101006-B	Side B
TSC4X-101006-AB	Sides A & B
TSC4X-101006-BCD	Sides B, C & D
TSC4X-101006-ABCD	Sides A, B, C & D

STAINLESS STEEL 316L

ENCLOSURES WITH TERMINALS

Catalog Number	Gland Plate
TSC4X6-101006	None
TSC4X6-101006-B	Side B
TSC4X6-101006-AB	Sides A & B
TSC4X6-101006-BCD	Sides B, C & D
TSC4X6-101006-ABCD	Sides A, B, C & D

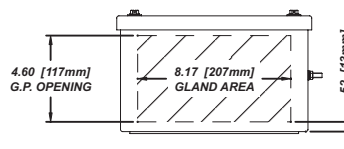
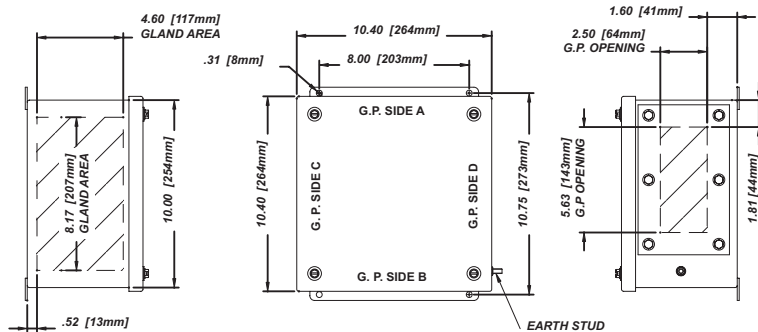
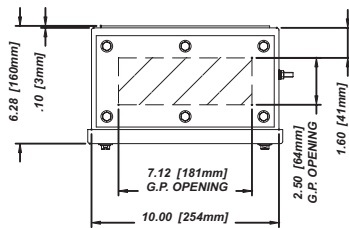

MAXIMUM NUMBER OF CABLE/CONDUIT ENTRIES

SIZE		WITHOUT GLAND PLATES		WITH GLAND PLATES	
NPT	Metric	Sides A & B	Sides C & D	Sides A & B	Sides C & D
1/2	M16	18	18	10	8
3/4	M20	15	15	5	4
1	M25	8	8	4	3
1 1/4	M32	6	6	3	2
1 1/2	M40	4	4	2	2
2	M50	2	2	2	1
2 1/2	M63	2	2	-	-

MAXIMUM TERMINAL BLOCK CONTENT

MIN CONDUCTOR SIZE		.5mm ²	1.5mm ²	2.5mm ²	4mm ²	6mm ²	10mm ²	16mm ²	35mm ²			
MIN CONDUCTOR SIZE AWG		22	16	14	12	10	8	6	2			
MAXIMUM AMPERAGE		3	8	10	16	20	25	35	50	63	80	100
Terminal Block Size	1.5mm ²	← 66 →		39	x	x	x	x	x	x	x	
	2.5mm ²	← 66 →			26	15	x	x	x	x	x	
	4mm ²	← 66 →				29	16	x	x	x	x	
	6mm ²	← 42 →					32	12	x	x	x	
	10mm ²	← 17 →						16	10	x	x	
	16mm ²	← 14 →							12	x	x	
	35mm ²	x	x	x	x	x	x	x	x	x	x	

- NOTES**
- The maximum terminal block content is based on vertical rail installation. For horizontal installations, consult factory.
 - For applications requiring multiple terminal block configurations and ampacities, consult factory.
 - For applications requiring larger terminal blocks or custom enclosure sizes, consult factory.
 - For conduit/cable spacings, wire bending and wire conversion guidelines, refer to the inside back cover of this catalog.

TERMINAL ENCLOSURES

TSC Series 10" x 10" x 8" Enclosure

INCREASED SAFETY
ENCLOSURES

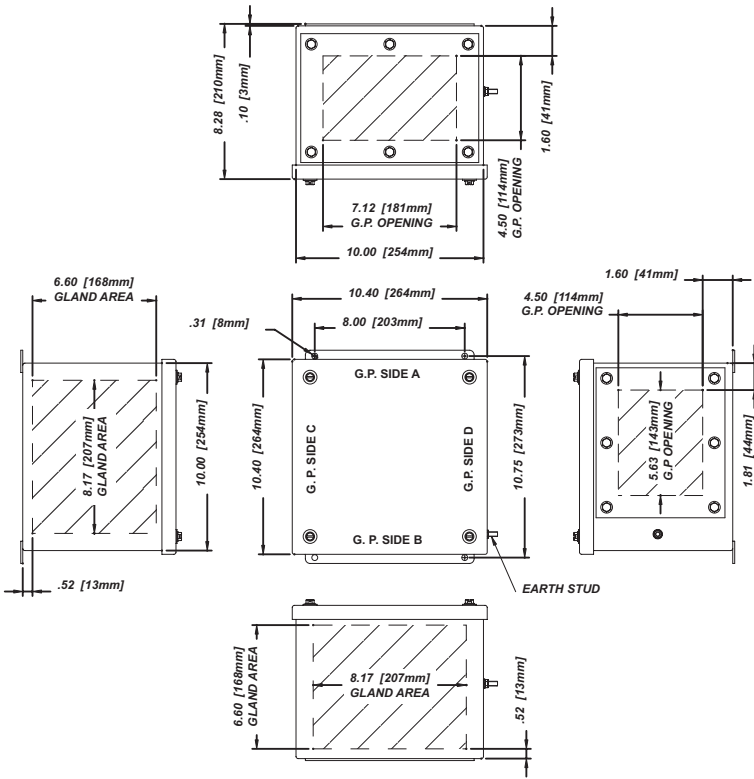

STAINLESS STEEL 304

ENCLOSURES WITH TERMINALS

Catalog Number	Gland Plate
TSC4X-101008	None
TSC4X-101008-B	Side B
TSC4X-101008-AB	Sides A & B
TSC4X-101008-BCD	Sides B, C & D
TSC4X-101008-ABCD	Sides A, B, C & D

STAINLESS STEEL 316L

ENCLOSURES WITH TERMINALS

Catalog Number	Gland Plate
TSC4X6-101008	None
TSC4X6-101008-B	Side B
TSC4X6-101008-AB	Sides A & B
TSC4X6-101008-BCD	Sides B, C & D
TSC4X6-101008-ABCD	Sides A, B, C & D

MAXIMUM NUMBER OF CABLE/CONDUIT ENTRIES

SIZE		WITHOUT GLAND PLATES		WITH GLAND PLATES	
NPT	Metric	Sides A & B	Sides C & D	Sides A & B	Sides C & D
1/2	M16	30	30	15	12
3/4	M20	20	20	15	12
1	M25	12	12	8	6
1 1/4	M32	6	6	6	4
1 1/2	M40	6	6	2	2
2	M50	4	4	2	1
2 1/2	M63	2	2	2	1

MAXIMUM TERMINAL BLOCK CONTENT

MIN CONDUCTOR SIZE		.5mm ²	1.5mm ²	2.5mm ²	4mm ²	6mm ²	10mm ²	16mm ²	35mm ²			
MIN CONDUCTOR SIZE AWG		22	16	14	12	10	8	6	2			
MAXIMUM AMPERAGE		3	8	10	16	20	25	35	50	63	80	100
Terminal Block Size	1.5mm ²	← 66 →		47	x	x	x	x	x	x	x	
	2.5mm ²	← 66 →			31	18	x	x	x	x	x	
	4mm ²	← 66 →				35	20	x	x	x	x	
	6mm ²	← 42 →					38	15	x	x	x	
	10mm ²	← 17 →						12	x	x	x	
	16mm ²	← 14 →							x	x		
	35mm ²	x	x	x	x	x	x	x	x	x	x	

- NOTES**
1. The maximum terminal block content is based on vertical rail installation. For horizontal installations, consult factory.
 2. For applications requiring multiple terminal block configurations and ampacities, consult factory.
 3. For applications requiring larger terminal blocks or custom enclosure sizes, consult factory.
 4. For conduit/cable spacings, wire bending and wire conversion guidelines, refer to the inside back cover of this catalog.

SEND ORDERS TO ORDERS@ADALET.COM

T: 216.267.9000 | F: 216.267.1681 | info@adalet.com

©Adalet

INCREASED SAFETY

TERMINAL ENCLOSURES

INCREASED SAFETY ENCLOSURES

TSC Series 12" x 6" x 4" Enclosure

STAINLESS STEEL 304

ENCLOSURE WITH TERMINALS

CAT. NUMBER	GLAND PLATE
TSC4X-120604	None

STAINLESS STEEL 316L

ENCLOSURE WITH TERMINALS

CAT. NUMBER	GLAND PLATE
TSC4X6-120604	None

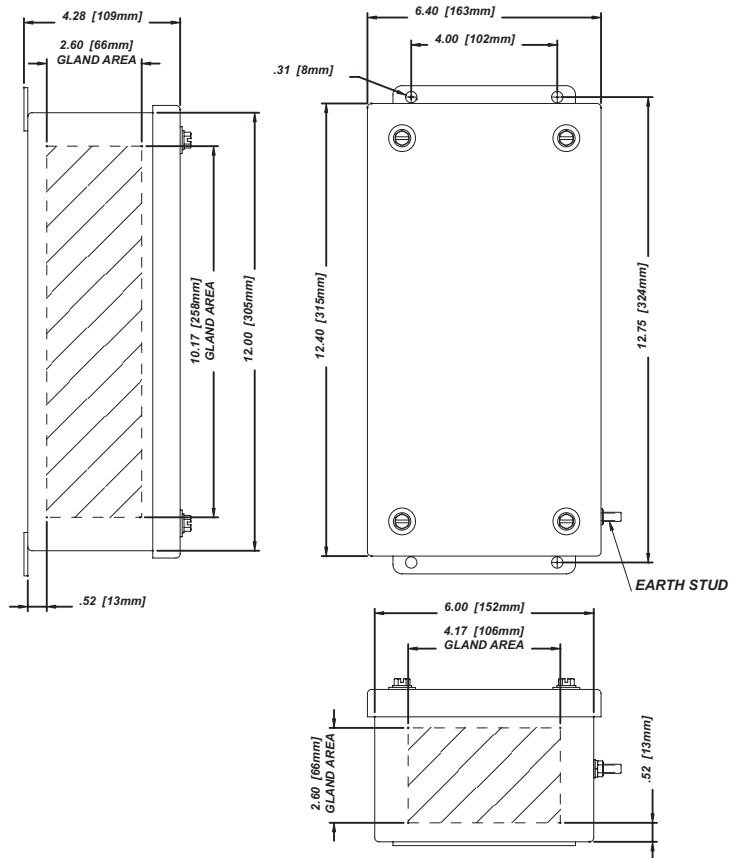

MAXIMUM NUMBER OF CABLE/CONDUIT ENTRIES

SIZE		WITHOUT GLAND PLATES	
NPT	Metric	Sides A & B	Sides C & D
1/2	M16	6	16
3/4	M20	3	7
1	M25	2	5
1 1/4	M32	2	4
1 1/2	M40	1	4
2	M50	-	-
2 1/2	M63	-	-

MAXIMUM TERMINAL BLOCK CONTENT

MIN CONDUCTOR SIZE		.5mm ²	1.5mm ²	2.5mm ²	4mm ²	6mm ²	10mm ²	16mm ²	35mm ²			
MIN CONDUCTOR SIZE AWG		22	16	14	12	10	8	6	2			
MAXIMUM AMPERAGE		3	8	10	16	20	25	35	50	63	80	100
Terminal Block Size	1.5mm ²	← 43 →		27	x	x	x	x	x	x	x	
	2.5mm ²	← 43 →			18	10	x	x	x	x	x	
	4mm ²	← 43 →				20	11	x	x	x	x	
	6mm ²	← 27 →					22	8	x	x	x	
	10mm ²	x	x	x	x	x	x	x	x	x	x	
	16mm ²	x	x	x	x	x	x	x	x	x	x	
	35mm ²	x	x	x	x	x	x	x	x	x	x	

- NOTES**
- The maximum terminal block content is based on vertical rail installation. For horizontal installations, consult factory.
 - For applications requiring multiple terminal block configurations and ampacities, consult factory.
 - For applications requiring larger terminal blocks or custom enclosure sizes, consult factory.
 - For conduit/cable spacings, wire bending and wire conversion guidelines, refer to the inside back cover of this catalog.

TERMINAL ENCLOSURES

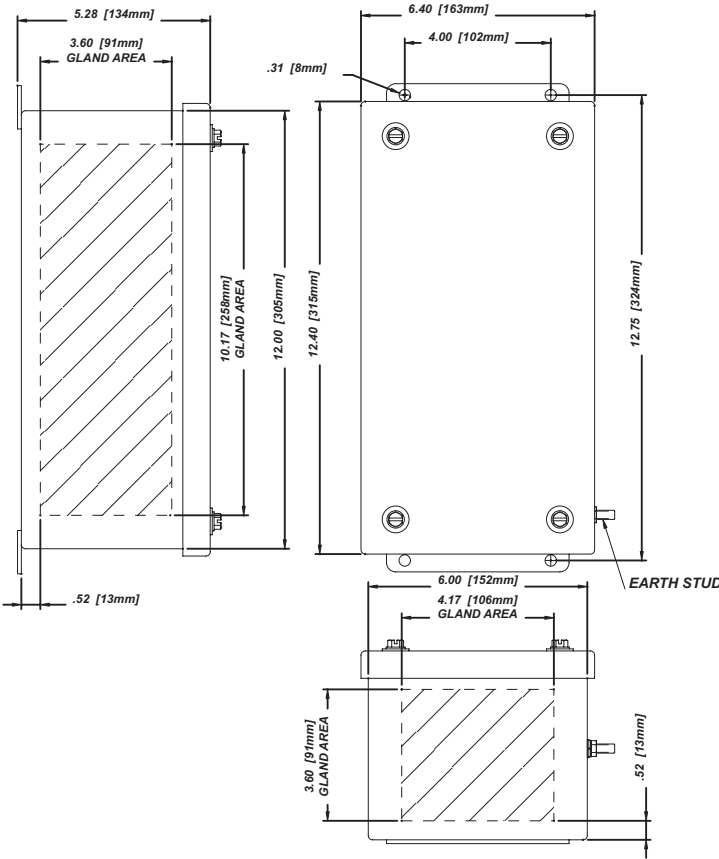

TSC Series 12" x 6" x 5" Enclosure

INCREASED SAFETY ENCLOSURES

STAINLESS STEEL 304 ENCL

ENCLOSURE WITH TERMINALS

CAT. NUMBER	GLAND PLATE
TSC4X-120605	None

STAINLESS STEEL 316L

ENCLOSURE WITH TERMINALS

CAT. NUMBER	GLAND PLATE
TSC4X6-120605	None

MAXIMUM NUMBER OF CABLE/CONDUIT ENTRIES

SIZE		WITHOUT GLAND PLATES	
NPT	Metric	Sides A & B	Sides C & D
1/2	M16	6	16
3/4	M20	6	14
1	M25	4	10
1 1/4	M32	2	4
1 1/2	M40	1	4
2	M50	1	3
2 1/2	M63	1	2

MAXIMUM TERMINAL BLOCK CONTENT

MIN CONDUCTOR SIZE		.5mm ²	1.5mm ²	2.5mm ²	4mm ²	6mm ²	10mm ²	16mm ²	35mm ²			
MIN CONDUCTOR SIZE AWG		22	16	14	12	10	8	6	2			
MAXIMUM AMPERAGE		3	8	10	16	20	25	35	50	63	80	100
Terminal Block Size	1.5mm ²	← 43 →		30	x	x	x	x	x	x	x	
	2.5mm ²	← 43 →			20	12	x	x	x	x	x	
	4mm ²	← 43 →				23	13	x	x	x	x	
	6mm ²	← 27 →					25	9	x	x	x	
	10mm ²	x	x	x	x	x	x	x	x	x	x	
	16mm ²	x	x	x	x	x	x	x	x	x	x	
	35mm ²	x	x	x	x	x	x	x	x	x	x	

- NOTES**
- The maximum terminal block content is based on vertical rail installation. For horizontal installations, consult factory.
 - For applications requiring multiple terminal block configurations and ampacities, consult factory.
 - For applications requiring larger terminal blocks or custom enclosure sizes, consult factory.
 - For conduit/cable spacings, wire bending and wire conversion guidelines, refer to the inside back cover of this catalog.

INCREASED SAFETY

TERMINAL ENCLOSURES

INCREASED SAFETY ENCLOSURES

TSC Series 12" x 8" x 5" Enclosure

STAINLESS STEEL 304

ENCLOSURE WITH TERMINALS

CAT. NUMBER	GLAND PLATE
TSC4X-120805	None

STAINLESS STEEL 316L

ENCLOSURE WITH TERMINALS

CAT. NUMBER	GLAND PLATE
TSC4X6-120805	None

MAXIMUM NUMBER OF CABLE/CONDUIT ENTRIES

SIZE		WITHOUT GLAND PLATES	
NPT	Metric	Sides A & B	Sides C & D
1/2	M16	10	16
3/4	M20	8	14
1	M25	6	10
1 1/4	M32	2	4
1 1/2	M40	2	4
2	M50	2	3
2 1/2	M63	1	2

MAXIMUM TERMINAL BLOCK CONTENT

MIN CONDUCTOR SIZE		.5mm ²	1.5mm ²	2.5mm ²	4mm ²	6mm ²	10mm ²	16mm ²	35mm ²			
MIN CONDUCTOR SIZE AWG		22	16	14	12	10	8	6	2			
MAXIMUM AMPERAGE		3	8	10	16	20	25	35	50	63	80	100
Terminal Block Size	1.5mm ²	← 43 →		30	x	x	x	x	x	x	x	
	2.5mm ²	← 43 →			20	12	x	x	x	x	x	
	4mm ²	← 43 →			23	13	x	x	x	x	x	
	6mm ²	← 27 →				25	9	x	x	x	x	
	10mm ²	← 22 →						8	x	x	x	
	16mm ²	x	x	x	x	x	x	x	x	x	x	
35mm ²	x	x	x	x	x	x	x	x	x	x		

- NOTES**
- The maximum terminal block content is based on vertical rail installation. For horizontal installations, consult factory.
 - For applications requiring multiple terminal block configurations and ampacities, consult factory.
 - For applications requiring larger terminal blocks or custom enclosure sizes, consult factory.
 - For conduit/cable spacings, wire bending and wire conversion guidelines, refer to the inside back cover of this catalog.

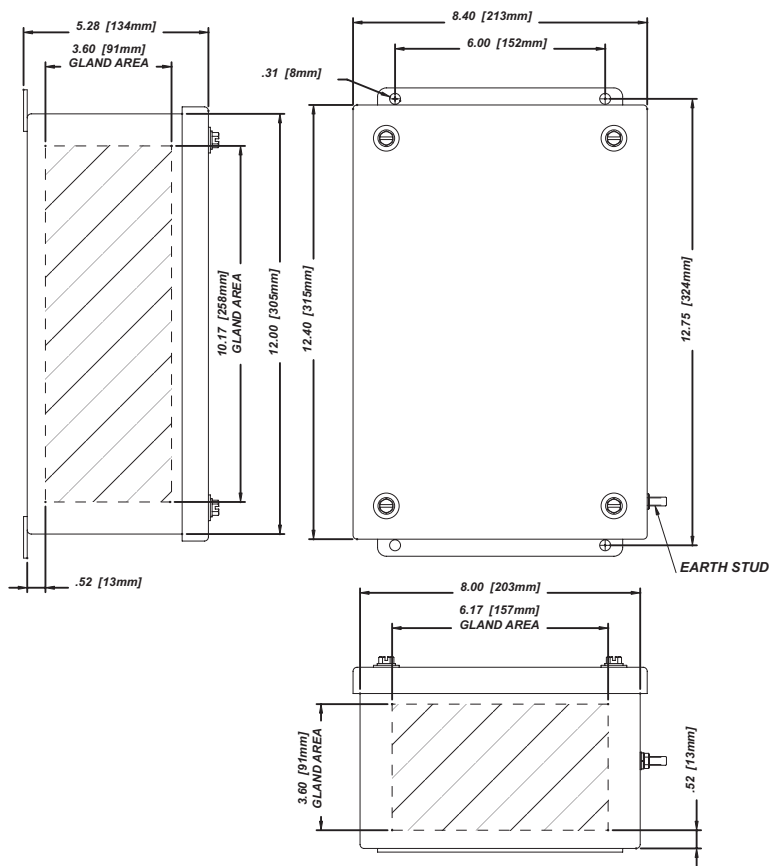

TERMINAL ENCLOSURES

TSC Series 12" x 8" x 6" Enclosure

INCREASED SAFETY ENCLOSURES

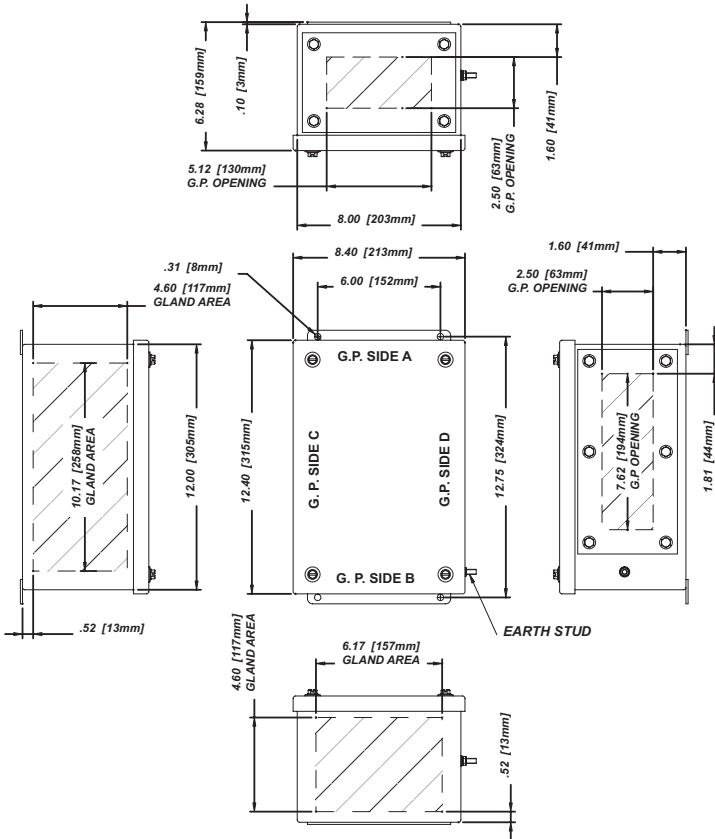

STAINLESS STEEL 304

ENCLOSURES WITH TERMINALS	
Catalog Number	Gland Plate
TSC4X-120806	None
TSC4X-120806-B	Side B
TSC4X-120806-AB	Sides A & B
TSC4X-120806-BCD	Sides B, C & D
TSC4X-120806-ABCD	Sides A, B, C & D

STAINLESS STEEL 316L

ENCLOSURES WITH TERMINALS	
Catalog Number	Gland Plate
TSC4X6-120806	None
TSC4X6-120806-B	Side B
TSC4X6-120806-AB	Sides A & B
TSC4X6-120806-BCD	Sides B, C & D
TSC4X6-120806-ABCD	Sides A, B, C & D

MAXIMUM NUMBER OF CABLE/CONDUIT ENTRIES

SIZE		WITHOUT GLAND PLATES		WITH GLAND PLATES	
NPT	Metric	Sides A & B	Sides C & D	Sides A & B	Sides C & D
1/2	M16	15	24	8	12
3/4	M20	12	21	3	5
1	M25	6	10	3	4
1 1/4	M32	4	8	2	3
1 1/2	M40	2	4	2	3
2	M50	2	3	1	2
2 1/2	M63	1	2	-	-

MAXIMUM TERMINAL BLOCK CONTENT

MIN CONDUCTOR SIZE	.5mm ²	1.5mm ²	2.5mm ²	4mm ²	6mm ²	10mm ²	16mm ²	35mm ²			
MIN CONDUCTOR SIZE AWG	22	16	14	12	10	8	6	2			
MAXIMUM AMPERAGE	3	8	10	16	20	25	35	50	63	80	100
Terminal Block Size	1.5mm ²	← 43 →	34	x	x	x	x	x	x	x	x
	2.5mm ²	← 43 →	22	13	x	x	x	x	x	x	x
	4mm ²	← 43 →	25	14	x	x	x	x	x	x	x
	6mm ²	← 27 →	11	x	x	x	x	x	x	x	x
	10mm ²	← 22 →	8	x	x	x	x	x	x	x	x
	16mm ²	x	x	x	x	x	x	x	x	x	x
35mm ²	x	x	x	x	x	x	x	x	x	x	

- NOTES**
- The maximum terminal block content is based on vertical rail installation. For horizontal installations, consult factory.
 - For applications requiring multiple terminal block configurations and ampacities, consult factory.
 - For applications requiring larger terminal blocks or custom enclosure sizes, consult factory.
 - For conduit/cable spacings, wire bending and wire conversion guidelines, refer to the inside back cover of this catalog.

SEND ORDERS TO ORDERS@ADALET.COM

T: 216.267.9000 | F: 216.267.1681 | info@adalet.com

©Adalet

INCREASED SAFETY

TERMINAL ENCLOSURES

INCREASED SAFETY ENCLOSURES

TSC Series 12" x 12" x 6" Enclosure

STAINLESS STEEL 304

ENCLOSURES WITH TERMINALS

Catalog Number	Gland Plate
TSC4X-121206	None
TSC4X-121206-B	Side B
TSC4X-121206-AB	Sides A & B
TSC4X-121206-BCD	Sides B, C & D
TSC4X-121206-ABCD	Sides A, B, C & D

STAINLESS STEEL 316L

ENCLOSURES WITH TERMINALS

Catalog Number	Gland Plate
TSC4X6-121206	None
TSC4X6-121206-B	Side B
TSC4X6-121206-AB	Sides A & B
TSC4X6-121206-BCD	Sides B, C & D
TSC4X6-121206-ABCD	Sides A, B, C & D

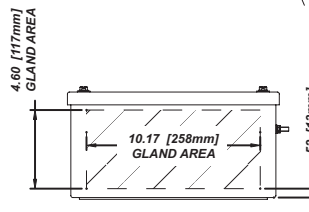
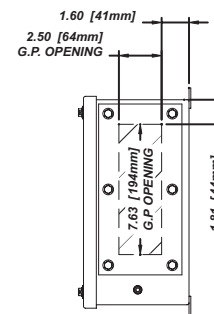
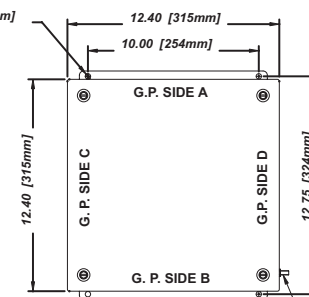
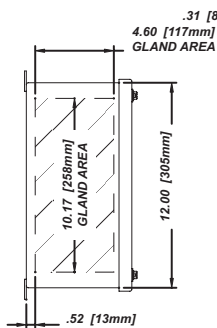
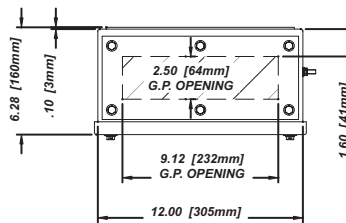

EARTH STUD

MAXIMUM NUMBER OF CABLE/CONDUIT ENTRIES

SIZE		WITHOUT GLAND PLATES		WITH GLAND PLATES	
NPT	Metric	Sides A & B	Sides C & D	Sides A & B	Sides C & D
1/2	M16	24	24	14	12
3/4	M20	21	21	6	5
1	M25	10	10	5	4
1 1/4	M32	8	8	4	3
1 1/2	M40	4	4	3	3
2	M50	3	3	3	2
2 1/2	M63	2	2	-	-

MAXIMUM TERMINAL BLOCK CONTENT

MIN CONDUCTOR SIZE		.5mm ²	1.5mm ²	2.5mm ²	4mm ²	6mm ²	10mm ²	16mm ²	35mm ²			
MIN CONDUCTOR SIZE AWG		22	16	14	12	10	8	6	2			
MAXIMUM AMPERAGE		3	8	10	16	20	25	35	50	63	80	100
Terminal Block Size	1.5mm ²	← 86 →		43	x	x	x	x	x	x	x	x
	2.5mm ²	← 86 →			28	16	x	x	x	x	x	x
	4mm ²	← 86 →				32	18	x	x	x	x	x
	6mm ²	← 54 →					35	13	x	x	x	x
	10mm ²	← 44 →						34	11	x	x	x
	16mm ²	← 18 →							13	x	x	
35mm ²	x	x	x	x	x	x	x	x	x	x	x	

- NOTES**
- The maximum terminal block content is based on vertical rail installation. For horizontal installations, consult factory.
 - For applications requiring multiple terminal block configurations and ampacities, consult factory.
 - For applications requiring larger terminal blocks or custom enclosure sizes, consult factory.
 - For conduit/cable spacings, wire bending and wire conversion guidelines, refer to the inside back cover of this catalog.

TERMINAL ENCLOSURES

TSC Series 12" x 12" x 8" Enclosure

INCREASED SAFETY ENCLOSURES

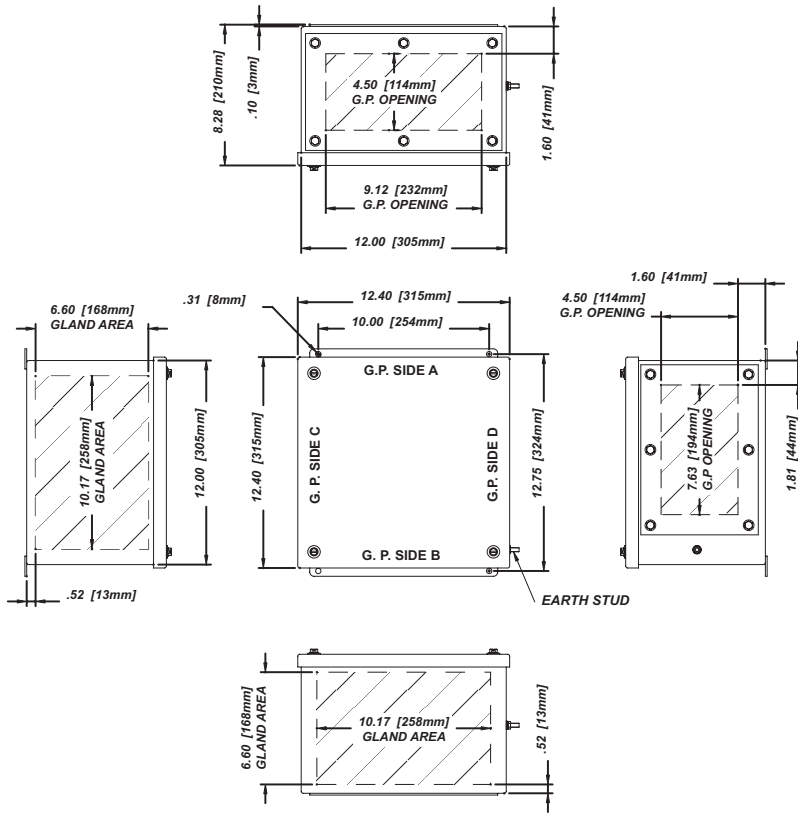

STAINLESS STEEL 304

ENCLOSURES WITH TERMINALS

Catalog Number	Gland Plate
TSC4X-121208	None
TSC4X-121208-B	Side B
TSC4X-121208-AB	Sides A & B
TSC4X-121208-BCD	Sides B, C & D
TSC4X-121208-ABCD	Sides A, B, C & D

STAINLESS STEEL 316L

ENCLOSURES WITH TERMINALS

Catalog Number	Gland Plate
TSC4X6-121208	None
TSC4X6-121208-B	Side B
TSC4X6-121208-AB	Sides A & B
TSC4X6-121208-BCD	Sides B, C & D
TSC4X6-121208-ABCD	Sides A, B, C & D

MAXIMUM NUMBER OF CABLE/CONDUIT ENTRIES

SIZE		WITHOUT GLAND PLATES		WITH GLAND PLATES	
NPT	Metric	Sides A & B	Sides C & D	Sides A & B	Sides C & D
1/2	M16	40	40	21	18
3/4	M20	28	28	18	15
1	M25	15	15	10	8
1 1/4	M32	8	8	8	6
1 1/2	M40	8	8	3	3
2	M50	6	6	3	2
2 1/2	M63	2	2	2	2

MAXIMUM TERMINAL BLOCK CONTENT

MIN CONDUCTOR SIZE		.5mm ²	1.5mm ²	2.5mm ²	4mm ²	6mm ²	10mm ²	16mm ²	35mm ²			
MIN CONDUCTOR SIZE AWG		22	16	14	12	10	8	6	2			
MAXIMUM AMPERAGE		3	8	10	16	20	25	35	50	63	80	100
Terminal Block Size	1.5mm ²	← 86 →		50	x	x	x	x	x	x	x	
	2.5mm ²	← 86 →			33	19	x	x	x	x	x	
	4mm ²	← 86 →				38	21	x	x	x	x	
	6mm ²	← 54 →					41	16	x	x	x	
	10mm ²	← 44 →						40	13	x	x	
	16mm ²	← 18 →							15	x	x	
35mm ²	x	x	x	x	x	x	x	x	x	x		

- NOTES**
1. The maximum terminal block content is based on vertical rail installation. For horizontal installations, consult factory.
 2. For applications requiring multiple terminal block configurations and ampacities, consult factory.
 3. For applications requiring larger terminal blocks or custom enclosure sizes, consult factory.
 4. For conduit/cable spacings, wire bending and wire conversion guidelines, refer to the inside back cover of this catalog.

SEND ORDERS TO ORDERS@ADALET.COM

T: 216.267.9000 | F: 216.267.1681 | info@adalet.com

©Adalet

INCREASED SAFETY

TERMINAL ENCLOSURES

INCREASED SAFETY ENCLOSURES

TSC Series 15" x 15" x 6" Enclosure

STAINLESS STEEL 304

ENCLOSURES WITH TERMINALS

Catalog Number	Gland Plate
TSC4X-151506	None
TSC4X-151506-B	Side B
TSC4X-151506-AB	Sides A & B
TSC4X-151506-BCD	Sides B, C & D
TSC4X-151506-ABCD	Sides A, B, C & D

STAINLESS STEEL 316L

ENCLOSURES WITH TERMINALS

Catalog Number	Gland Plate
TSC4X6-151506	None
TSC4X6-151506-B	Side B
TSC4X6-151506-AB	Sides A & B
TSC4X6-151506-BCD	Sides B, C & D
TSC4X6-151506-ABCD	Sides A, B, C & D

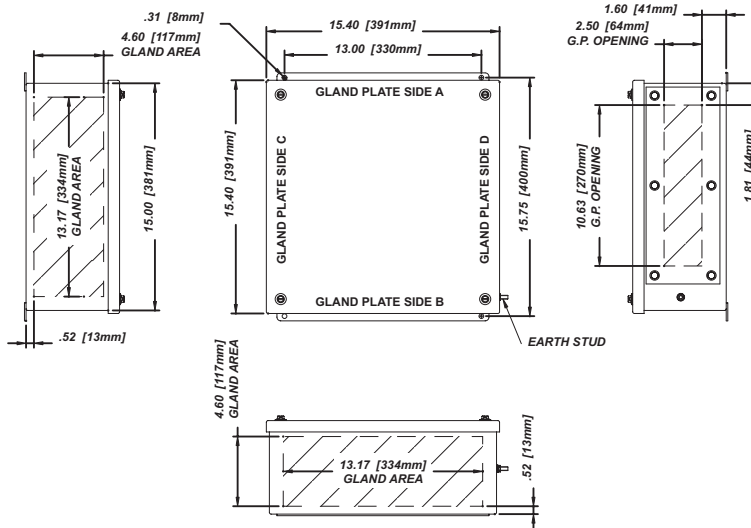
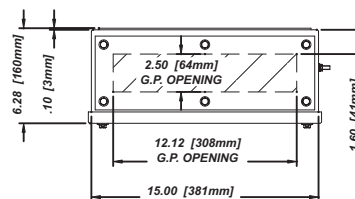

MAXIMUM NUMBER OF CABLE/CONDUIT ENTRIES

SIZE		WITHOUT GLAND PLATES		WITH GLAND PLATES	
NPT	Metric	Sides A & B	Sides C & D	Sides A & B	Sides C & D
1/2	M16	30	30	18	16
3/4	M20	27	27	8	7
1	M25	14	14	6	5
1 1/4	M32	10	10	5	4
1 1/2	M40	5	5	4	4
2	M50	4	4	3	3
2 1/2	M63	3	3	-	-

MAXIMUM TERMINAL BLOCK CONTENT

MIN CONDUCTOR SIZE		.5mm ²	1.5mm ²	2.5mm ²	4mm ²	6mm ²	10mm ²	16mm ²	35mm ²			
MIN CONDUCTOR SIZE AWG		22	16	14	12	10	8	6	2			
MAXIMUM AMPERAGE		3	8	10	16	20	25	35	50	63	80	100
Terminal Block Size	1.5mm ²	←100→		48	x	x	x	x	x	x	x	x
	2.5mm ²	←177→		32	19	x	x	x	x	x	x	x
	4mm ²	←177→		126	36	20	x	x	x	x	x	x
	6mm ²	←111→			40	15	x	x	x	x	x	x
	10mm ²	←58→				38	12	x	x	x	x	x
	16mm ²	←48→					32	15	x	x	x	x
35mm ²	←18→								15			

- NOTES**
- The maximum terminal block content is based on vertical rail installation. For horizontal installations, consult factory.
 - For applications requiring multiple terminal block configurations and ampacities, consult factory.
 - For applications requiring larger terminal blocks or custom enclosure sizes, consult factory.
 - For conduit/cable spacings, wire bending and wire conversion guidelines, refer to the inside back cover of this catalog.

TERMINAL ENCLOSURES

TSC Series 15" x 15" x 8" Enclosure

INCREASED SAFETY
ENCLOSURES

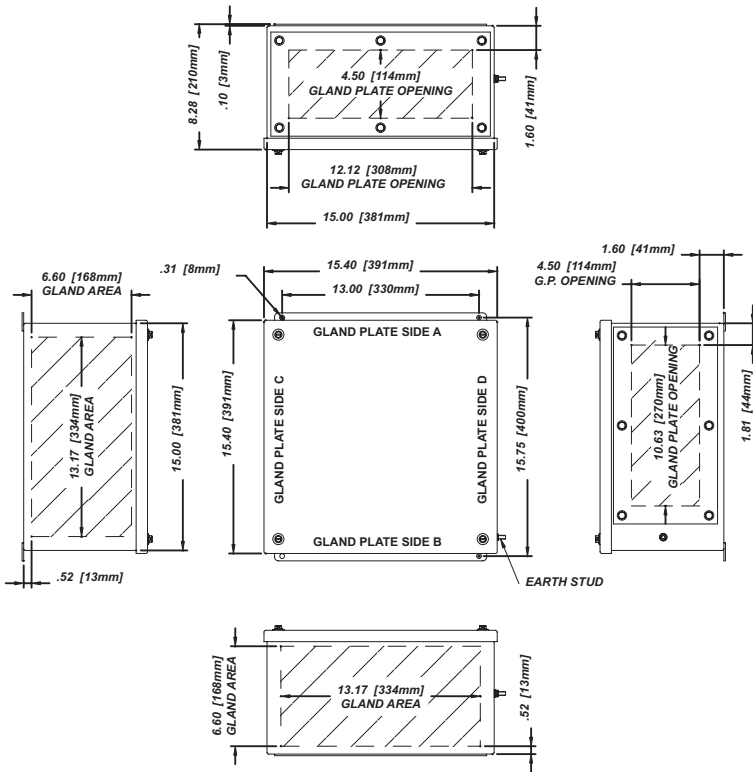

STAINLESS STEEL 304

ENCLOSURES WITH TERMINALS

Catalog Number	Gland Plate
TSC4X-151508	None
TSC4X-151508-B	Side B
TSC4X-151508-AB	Sides A & B
TSC4X-151508-BCD	Sides B, C & D
TSC4X-151508-ABCD	Sides A, B, C & D

STAINLESS STEEL 316L

ENCLOSURES WITH TERMINALS

Catalog Number	Gland Plate
TSC4X6-151508	None
TSC4X6-151508-B	Side B
TSC4X6-151508-AB	Sides A & B
TSC4X6-151508-BCD	Sides B, C & D
TSC4X6-151508-ABCD	Sides A, B, C & D

MAXIMUM NUMBER OF CABLE/CONDUIT ENTRIES

SIZE		WITHOUT GLAND PLATES		WITH GLAND PLATES	
NPT	Metric	Sides A & B	Sides C & D	Sides A & B	Sides C & D
1/2	M16	50	50	27	24
3/4	M20	36	36	24	21
1	M25	21	21	12	10
1 1/4	M32	10	10	10	8
1 1/2	M40	10	10	4	4
2	M50	8	8	3	3
2 1/2	M63	3	3	3	3

MAXIMUM TERMINAL BLOCK CONTENT

MIN CONDUCTOR SIZE	.5mm ²	1.5mm ²	2.5mm ²	4mm ²	6mm ²	10mm ²	16mm ²	35mm ²			
MIN CONDUCTOR SIZE AWG	22	16	14	12	10	8	6	2			
MAXIMUM AMPERAGE	3	8	10	16	20	25	35	50	63	80	100
Terminal Block Size	1.5mm ²	← 115 →	56	x	x	x	x	x	x	x	x
	2.5mm ²	← 177 →		37	21	x	x	x	x	x	x
	4mm ²	← 177 →		144	42	23	x	x	x	x	x
	6mm ²		← 111 →			45	18	x	x	x	x
	10mm ²			← 58 →			44	14	x	x	x
	16mm ²				← 48 →			37	17	x	x
35mm ²								← 18 →			

- NOTES**
1. The maximum terminal block content is based on vertical rail installation. For horizontal installations, consult factory.
 2. For applications requiring multiple terminal block configurations and ampacities, consult factory.
 3. For applications requiring larger terminal blocks or custom enclosure sizes, consult factory.
 4. For conduit/cable spacings, wire bending and wire conversion guidelines, refer to the inside back cover of this catalog.

SEND ORDERS TO ORDERS@ADALET.COM

T: 216.267.9000 | F: 216.267.1681 | info@adalet.com

©Adalet

INCREASED SAFETY

TERMINAL ENCLOSURES

INCREASED SAFETY ENCLOSURES

TSC Series 16" x 12" x 6" Enclosure

STAINLESS STEEL 304

ENCLOSURES WITH TERMINALS

Catalog Number	Gland Plate
TSC4X-161206	None
TSC4X-161206-B	Side B
TSC4X-161206-AB	Sides A & B
TSC4X-161206-BCD	Sides B, C & D
TSC4X-161206-ABCD	Sides A, B, C & D

STAINLESS STEEL 316L

ENCLOSURES WITH TERMINALS

Catalog Number	Gland Plate
TSC4X6-161206	None
TSC4X6-161206-B	Side B
TSC4X6-161206-AB	Sides A & B
TSC4X6-161206-BCD	Sides B, C & D
TSC4X6-161206-ABCD	Sides A, B, C & D

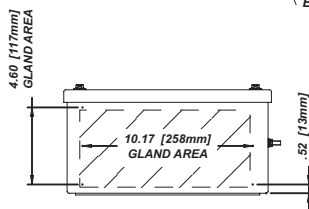
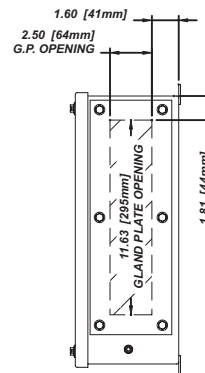
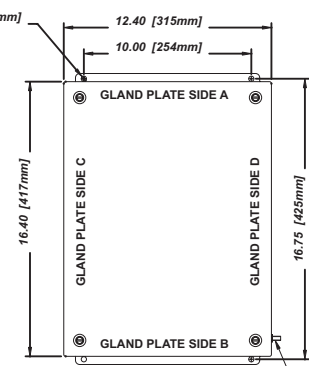
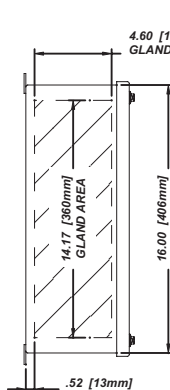
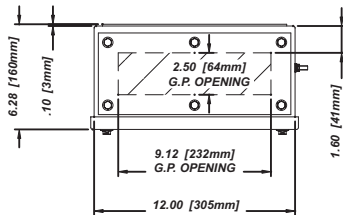

MAXIMUM NUMBER OF CABLE/CONDUIT ENTRIES

SIZE		WITHOUT GLAND PLATES		WITH GLAND PLATES	
NPT	Metric	Sides A & B	Sides C & D	Sides A & B	Sides C & D
1/2	M16	24	33	14	18
3/4	M20	21	27	6	8
1	M25	10	14	5	6
1 1/4	M32	8	12	4	5
1 1/2	M40	4	5	3	4
2	M50	3	4	3	3
2 1/2	M63	2	3	-	-

MAXIMUM TERMINAL BLOCK CONTENT

MIN CONDUCTOR SIZE		.5mm ²	1.5mm ²	2.5mm ²	4mm ²	6mm ²	10mm ²	16mm ²	35mm ²			
MIN CONDUCTOR SIZE AWG		22	16	14	12	10	8	6	2			
MAXIMUM AMPERAGE		3	8	10	16	20	25	35	50	63	80	100
Terminal Block Size	1.5mm ²	← 94 →		46	x	x	x	x	x	x	x	x
	2.5mm ²	← 128 →			30	17	x	x	x	x	x	x
	4mm ²	← 28 →		118	34	19	x	x	x	x	x	
	6mm ²	← 80 →				37	14	x	x	x	x	
	10mm ²	← 64 →					36	12	x	x	x	
	16mm ²	← 26 →							14	x	x	
	35mm ²	x	x	x	x	x	x	x	x	x	x	

- NOTES**
- The maximum terminal block content is based on vertical rail installation. For horizontal installations, consult factory.
 - For applications requiring multiple terminal block configurations and ampacities, consult factory.
 - For applications requiring larger terminal blocks or custom enclosure sizes, consult factory.
 - For conduit/cable spacings, wire bending and wire conversion guidelines, refer to the inside back cover of this catalog.

TERMINAL ENCLOSURES

TSC Series 16" x 12" x 8" Enclosure

INCREASED SAFETY ENCLOSURES

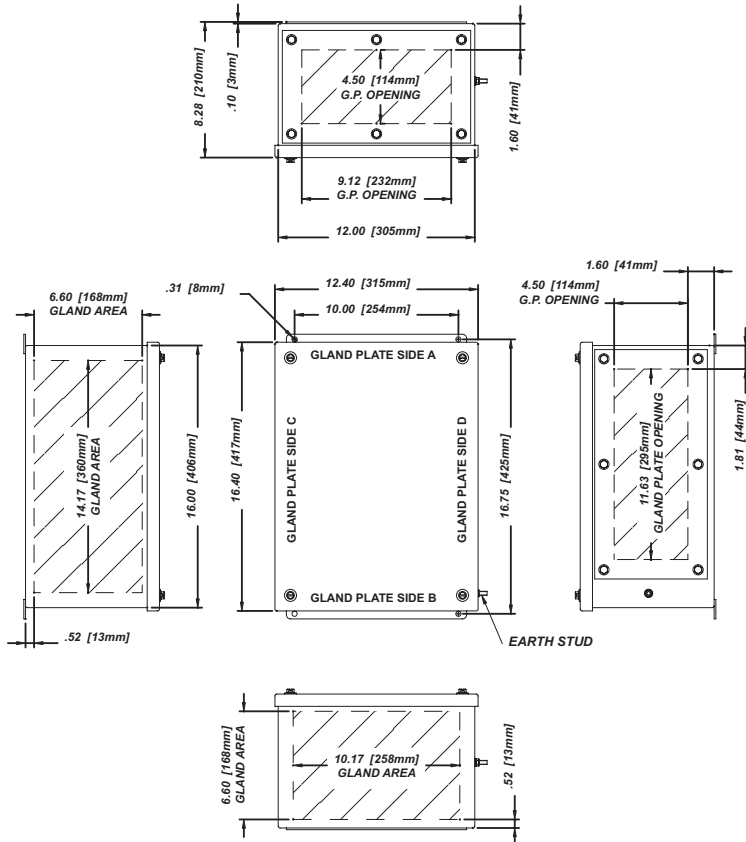

STAINLESS STEEL 304

ENCLOSURES WITH TERMINALS	
Catalog Number	Gland Plate
TSC4X-161208	None
TSC4X-161208-B	Side B
TSC4X-161208-AB	Sides A & B
TSC4X-161208-BCD	Sides B, C & D
TSC4X-161208-ABCD	Sides A, B, C & D

STAINLESS STEEL 316L

ENCLOSURES WITH TERMINALS	
Catalog Number	Gland Plate
TSC4X6-161208	None
TSC4X6-161208-B	Side B
TSC4X6-161208-AB	Sides A & B
TSC4X6-161208-BCD	Sides B, C & D
TSC4X6-161208-ABCD	Sides A, B, C & D

MAXIMUM NUMBER OF CABLE/CONDUIT ENTRIES

SIZE		WITHOUT GLAND PLATES		WITH GLAND PLATES	
NPT	Metric	Sides A & B	Sides C & D	Sides A & B	Sides C & D
1/2	M16	40	55	21	27
3/4	M20	28	36	18	24
1	M25	15	21	10	12
1 1/4	M32	8	12	8	10
1 1/2	M40	8	10	3	4
2	M50	6	8	3	3
2 1/2	M63	2	3	2	3

MAXIMUM TERMINAL BLOCK CONTENT

MIN CONDUCTOR SIZE	.5mm ²	1.5mm ²	2.5mm ²	4mm ²	6mm ²	10mm ²	16mm ²	35mm ²			
MIN CONDUCTOR SIZE AWG	22	16	14	12	10	8	6	2			
MAXIMUM AMPERAGE	3	8	10	16	20	25	35	50	63	80	100
Terminal Block Size	1.5mm ²	← 109 →	53	x	x	x	x	x	x	x	x
	2.5mm ²	← 128 →		35	20	x	x	x	x	x	x
	4mm ²	← 128 →			40	27	x	x	x	x	x
	6mm ²	← 80 →				43	17	x	x	x	x
	10mm ²	← 64 →					42	13	x	x	x
	16mm ²				← 26 →				18	x	x
35mm ²	x	x	x	x	x	x	x	x	x	x	

- NOTES**
1. The maximum terminal block content is based on vertical rail installation. For horizontal installations, consult factory.
 2. For applications requiring multiple terminal block configurations and ampacities, consult factory.
 3. For applications requiring larger terminal blocks or custom enclosure sizes, consult factory.
 4. For conduit/cable spacings, wire bending and wire conversion guidelines, refer to the inside back cover of this catalog.

SEND ORDERS TO ORDERS@ADALET.COM

T: 216.267.9000 | F: 216.267.1681 | info@adalet.com

©Adalet

INCREASED SAFETY

TERMINAL ENCLOSURES

INCREASED SAFETY ENCLOSURES

TSC Series 16" x 16" x 6" Enclosure

STAINLESS STEEL 304

ENCLOSURES WITH TERMINALS

Catalog Number	Gland Plate
TSC4X-161606	None
TSC4X-161606-B	Side B
TSC4X-161606-AB	Sides A & B
TSC4X-161606-BCD	Sides B, C & D
TSC4X-161606-ABCD	Sides A, B, C & D

STAINLESS STEEL 316L

ENCLOSURES WITH TERMINALS

Catalog Number	Gland Plate
TSC4X6-161606	None
TSC4X6-161606-B	Side B
TSC4X6-161606-AB	Sides A & B
TSC4X6-161606-BCD	Sides B, C & D
TSC4X6-161606-ABCD	Sides A, B, C & D

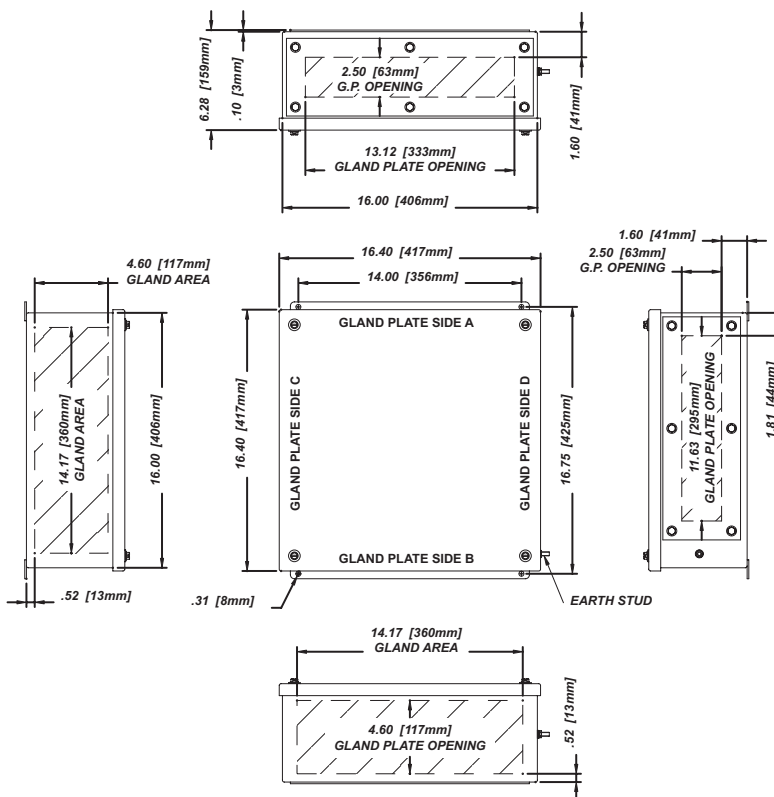

MAXIMUM NUMBER OF CABLE/CONDUIT ENTRIES

SIZE		WITHOUT GLAND PLATES		WITH GLAND PLATES	
NPT	Metric	Sides A & B	Sides C & D	Sides A & B	Sides C & D
1/2	M16	33	33	20	18
3/4	M20	27	27	9	8
1	M25	14	14	7	6
1 1/4	M32	12	12	5	5
1 1/2	M40	5	5	5	4
2	M50	4	4	4	3
2 1/2	M63	3	3	-	-

MAXIMUM TERMINAL BLOCK CONTENT

MIN CONDUCTOR SIZE		.5mm ²	1.5mm ²	2.5mm ²	4mm ²	6mm ²	10mm ²	16mm ²	35mm ²			
MIN CONDUCTOR SIZE AWG		22	16	14	12	10	8	6	2			
MAXIMUM AMPERAGE		3	8	10	16	20	25	35	50	63	80	100
Terminal Block Size	1.5mm ²	← 104 →		50	x	x	x	x	x	x	x	x
	2.5mm ²	← 192 →		33	19	x	x	x	x	x	x	x
	4mm ²	← 192 →		130	38	21	x	x	x	x	x	x
	6mm ²	← 120 →				41	16	x	x	x	x	x
	10mm ²	← 96 →					40	13	x	x	x	x
	16mm ²	← 52 →						33	15	x	x	x
	35mm ²	← 20 →								16		

- NOTES**
- The maximum terminal block content is based on vertical rail installation. For horizontal installations, consult factory.
 - For applications requiring multiple terminal block configurations and ampacities, consult factory.
 - For applications requiring larger terminal blocks or custom enclosure sizes, consult factory.
 - For conduit/cable spacings, wire bending and wire conversion guidelines, refer to the inside back cover of this catalog.

