

Z-Manipulators DN40CF: 621-ZLT-C40-xxx

(New versions from 6.2015)

Z-manipulators with a travel from 50mm to 600mm are offered from Allectra. Various options allow the use in many applications.

	50mm	100mm	150mm	200mm	300mm	500mm
Top flange	DN40CF metric tapped optional: DN40CF with through holes (+25mm)					
Base flange	DN40CF with through holes					
Vacuum	UHV Leak rate $<1 \times 10^{-10}$ mbar l/s					
Max. Bakeout	230°C					
Bellow ID	39mm					
Readout	10 μ m					
A min (mm)	75	90	105	120	150	115
B (mm)	221	286	351	416	546	821
C (mm)	104			109		
D (mm)	103			110		
Options:	Permeability < 1.01					
	Top flange with through holes					
	Hand wheel on side					
	Integrated X-Table					
	Other travels: 75mm / 250mm / 350mm / 400mm / 600mm and on request					
	Integrated port aligner					
	Stepper motor drive / limit switches					
	2 stage / 3 stage pneumatic drive					

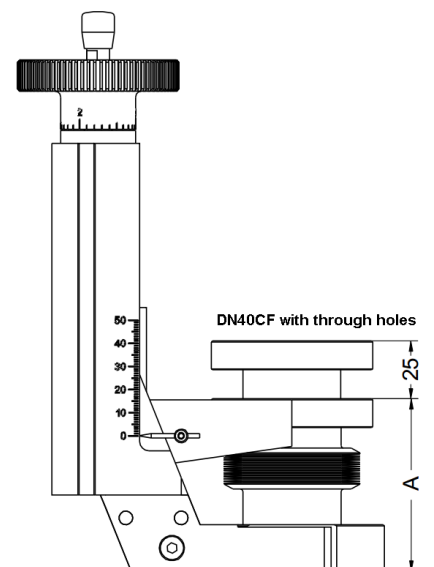
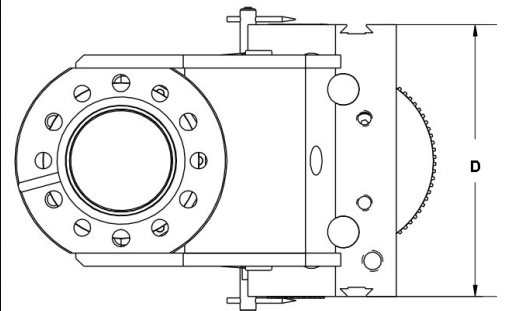
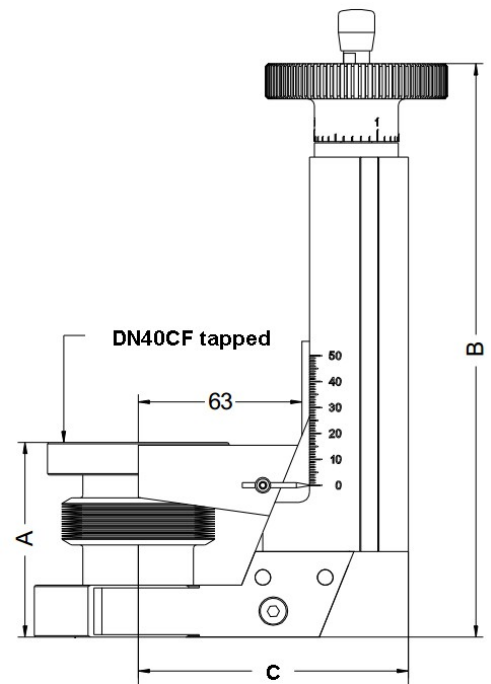

- The optional X-drive offers a movement of +/-6.5mm, a locking screw is included in the design
- The optional port aligner allows a travel or tilt of up to 10mm, the top flange has through holes



Version with optional port aligner

50mm travel manipulator with through hole option

File: 621-ZLT-C40-xxx Last revised 2015-06-04

All data given in this sheet are carefully checked but subject to change at any time.

Prices:

Type	Euro
621-ZLT-C40-50	1990.--
621-ZLT-C40-100	2375.--
621-ZLT-C40-150	2760.--
621-ZLT-C40-200	3145.--
621-ZLT-C40-300	3915.--
621-ZLT-C40-500	5460.--
Options:	
Top flange DN40CF with though holes	60.--
Permeability <1.01	645.--
Hand wheel on side	330.--
Integrated X-Table +/-6.5mm	790.--
Integrated port aligner (up to 250mm)	445.--
Stepper motor drive	650.--
limit switch (1x)	60.--
limit switch, bakeable (1x)	115.--
2 stage / 3 stage pneumatic drive	POA

Please ask for a quote to get the right part code for your desired assembly.
Not all options can be combined.