

Stamped Standard Heat Sinks

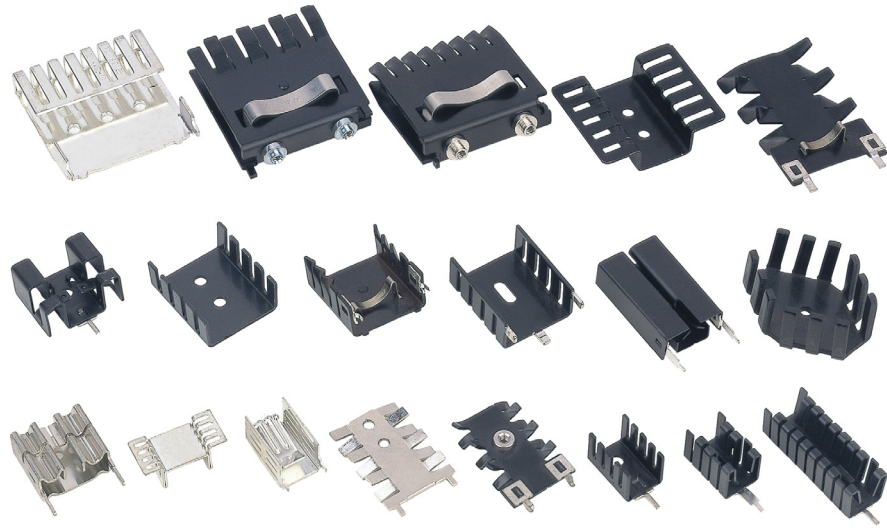

PC Board Level Standard Heat Sinks
Standard For TO-220s, TO-3s, TO-5s, TO-126s , TO-127s, TO-202s, TO-218s etc.
Aluminum Anodized or Degreased Material With Solderable Tabs
Clips, Nuts, or Thermal Pads Optional

baknor

5225 Orbitor Drive Suite #2
Mississauga, Ontario
Canada L4W 4Y8
Phone: 905-624-1800
www.baknorthermal.com
sales@baknor.com

Stamped Standard Heat Sinks

Page 1

BTM-1-A631001

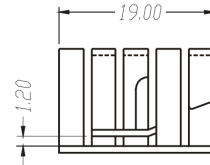
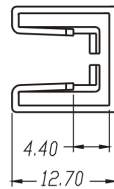
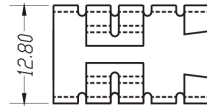

BTM-1-A631002

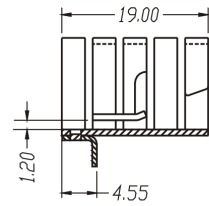
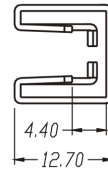
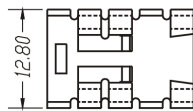

BTM-1-A631003

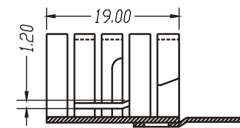
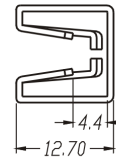
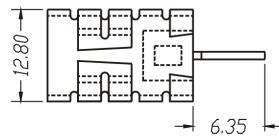

BTM-1-A631004

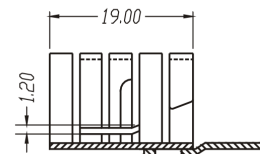
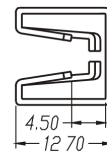
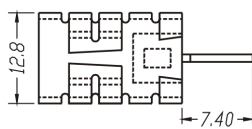
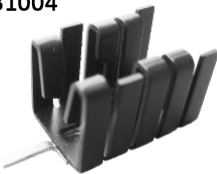

BTM-1-A631005

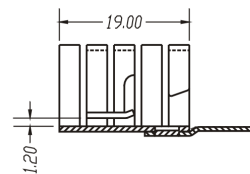
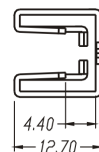
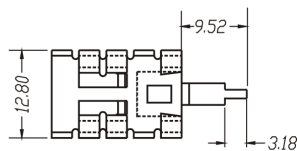

Stamped Standard Heat Sinks

BTM-1-A631006

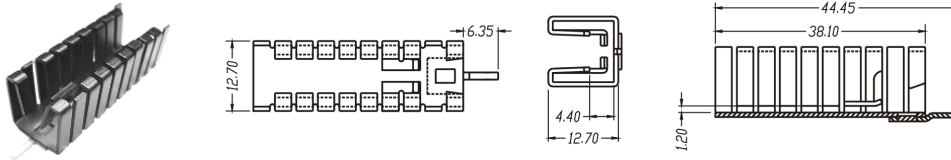

BTM-1-A631007

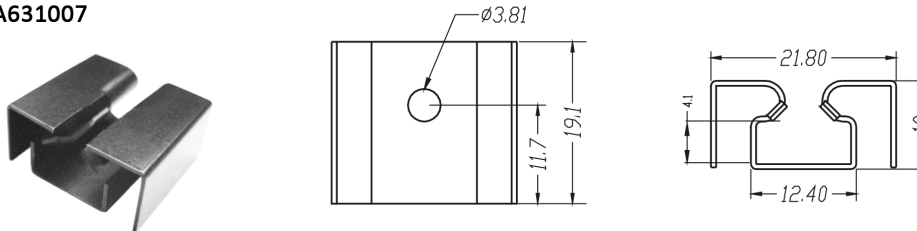

BTM-1-A631008

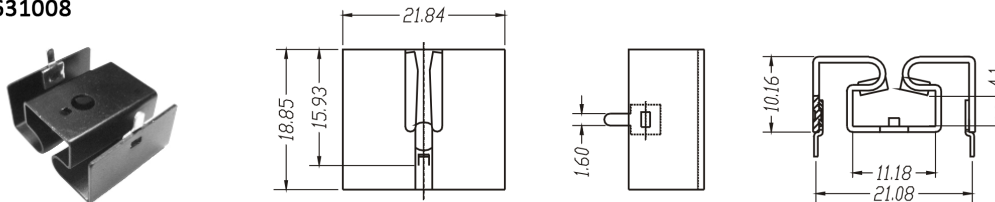

BTM-1-A631009

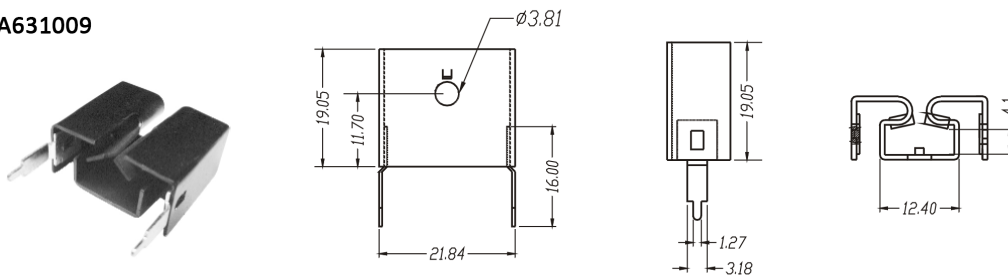

BTM-1-A631010

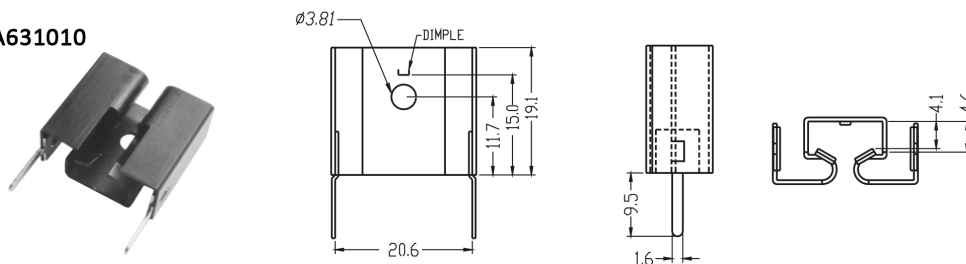

Stamped Standard Heat Sinks

BTM-1-A631011

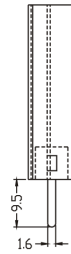
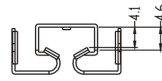
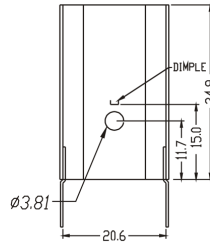

BTM-1-A631012

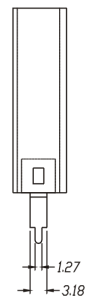
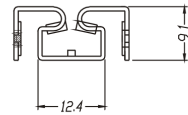
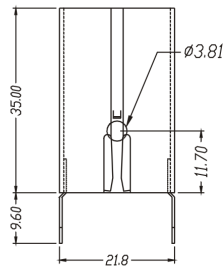

BTM-1-A631013

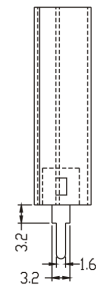
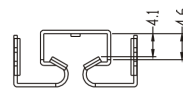
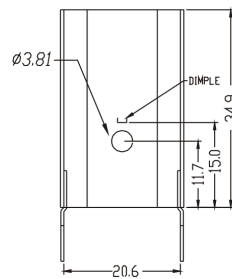

BTM-1-A631014

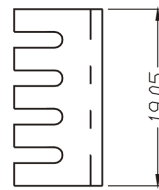
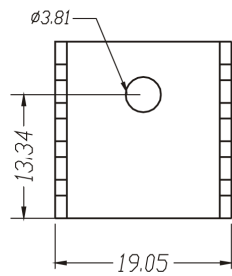
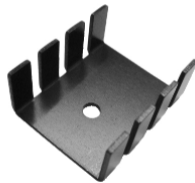

BTM-1-A631015

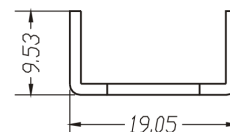
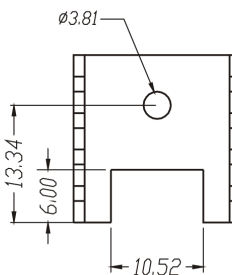

Stamped Standard Heat Sinks



Page 4

BTM-1-A631016

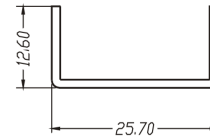
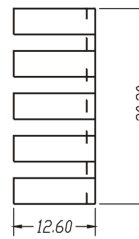
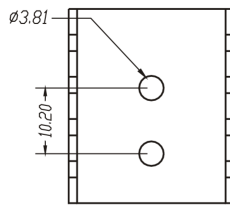

BTM-1-A631017

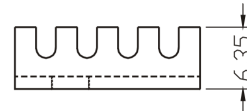
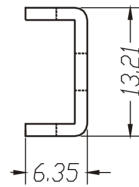
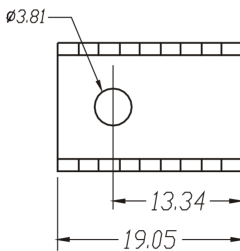
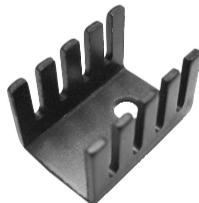

BTM-1-A631018

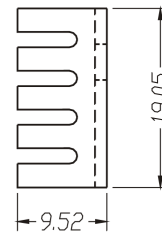
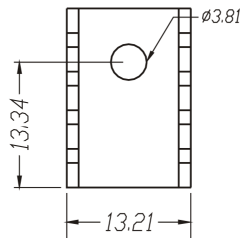

BTM-1-A631019

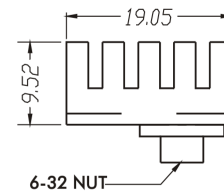
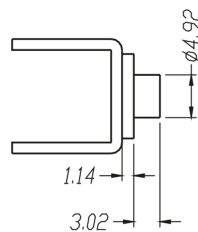
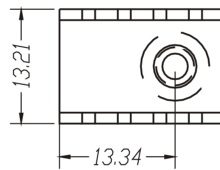
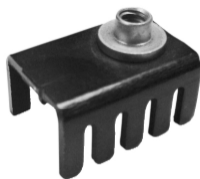

BTM-1-A631020

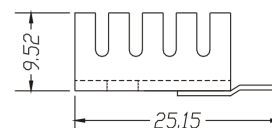
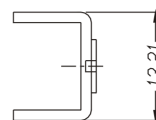
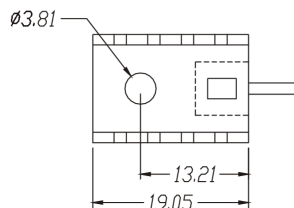

Stamped Standard Heat Sinks



BTM-1-A631021

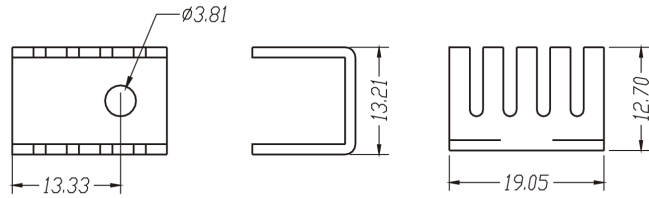

BTM-1-A631022

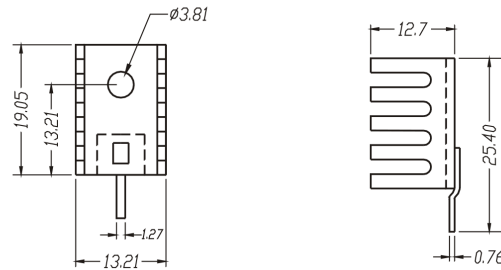

BTM-1-A631023

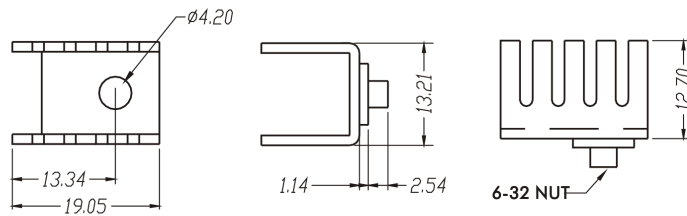
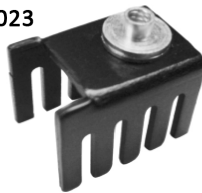

BTM-1-A631024

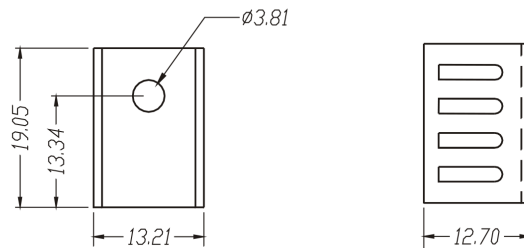

BTM-1-A631025

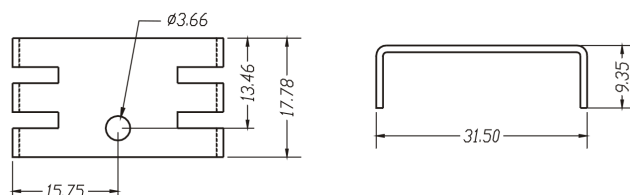
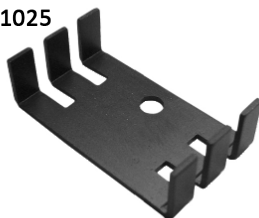

Stamped Standard Heat Sinks



Page 6

BTM-1-A631026

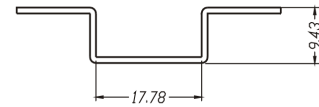
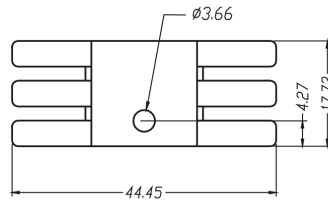
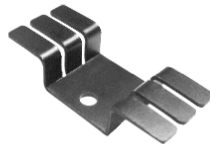

BTM-1-A631027

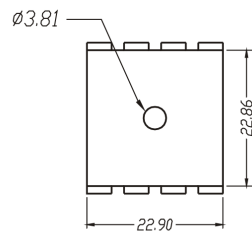
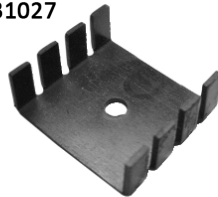

BTM-1-A631028

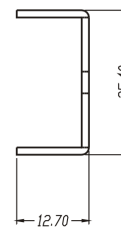
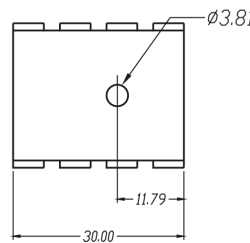
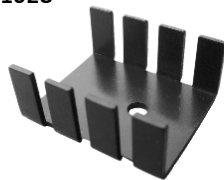

BTM-1-A631029

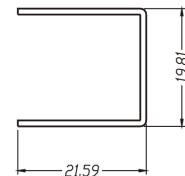
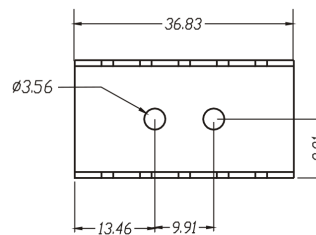

BTM-1-A631030

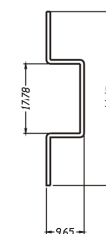
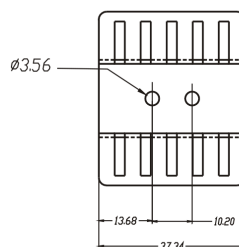
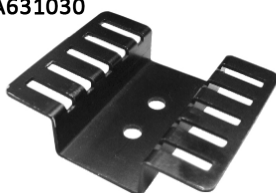

Stamped Standard Heat Sinks

BTM-1-A631031

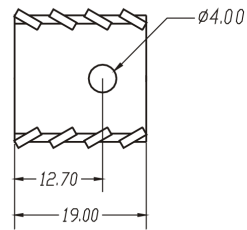
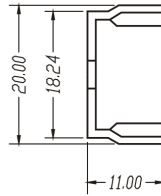
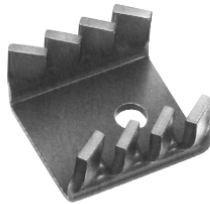

BTM-1-A631032

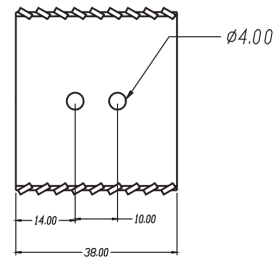
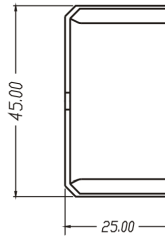
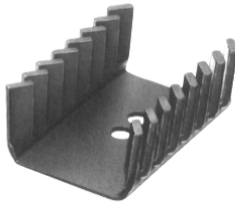

BTM-1-A631033

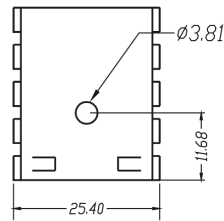
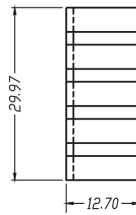

BTM-1-A631034

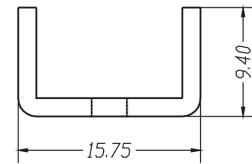
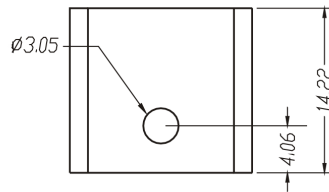

BTM-1-A631035

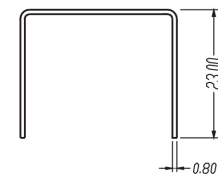
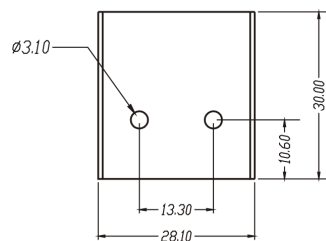
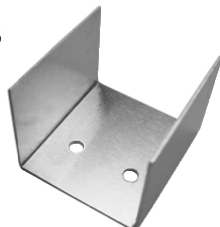

Stamped Standard Heat Sinks

BTM-1-A631036

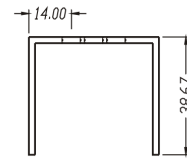
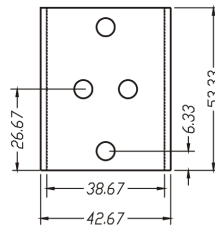

BTM-1-A631037

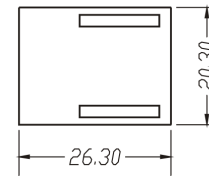
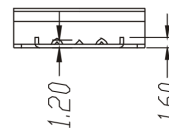
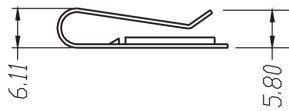
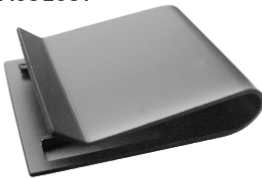

BTM-1-A631038

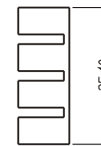
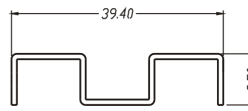
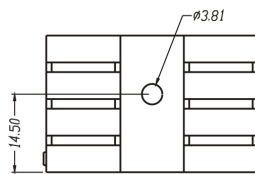
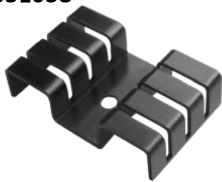

BTM-1-A631039

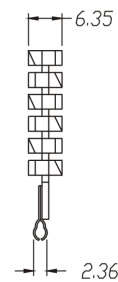
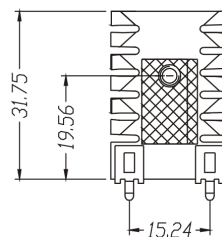
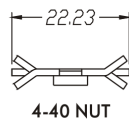
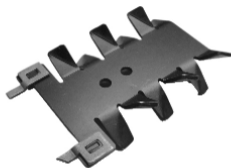

BTM-1-A631040

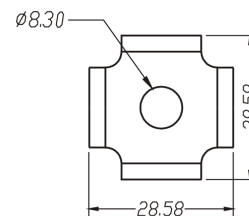
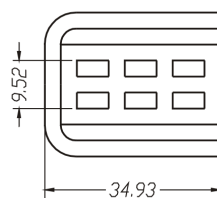

Stamped Standard Heat Sinks

BTM-1-A631041

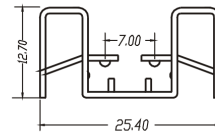
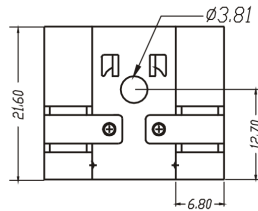
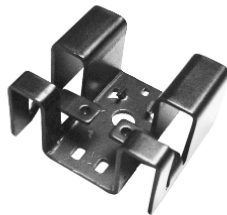

BTM-1-A631042

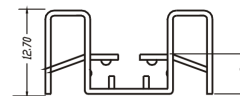
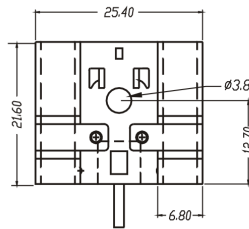
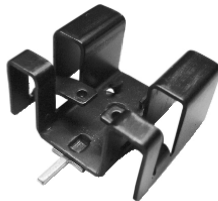

BTM-1-A631043

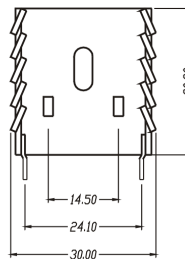

BTM-1-A631044

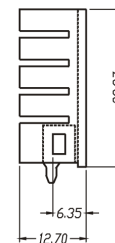
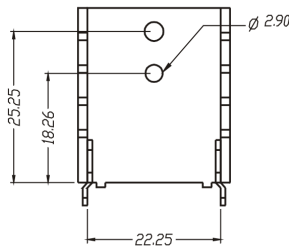
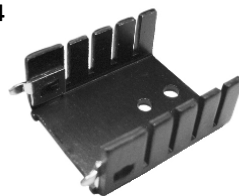

BTM-1-A631045

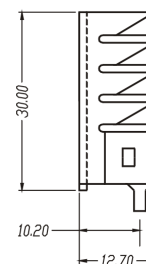
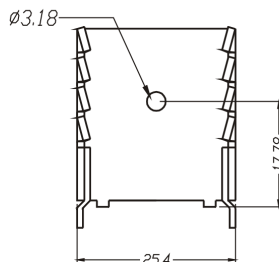

Stamped Standard Heat Sinks

BTM-1-A631046

AL Material E-coated
with Solderable pins

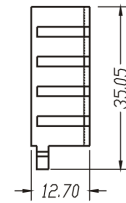
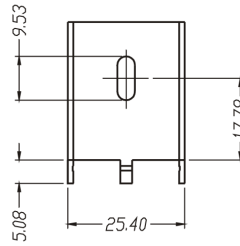
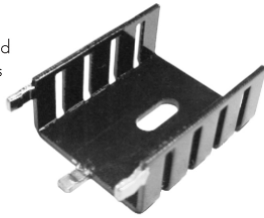

BTM-1-A631047

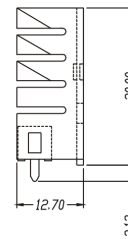
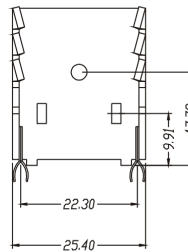
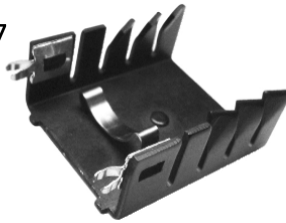

BTM-1-A631048

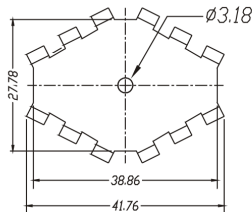

BTM-1-A631049

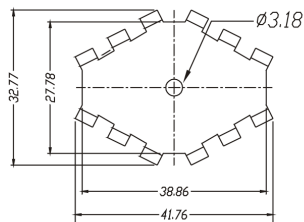
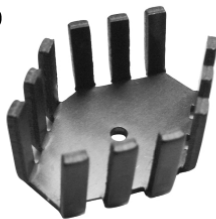

BTM-1-A631050

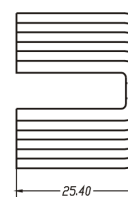
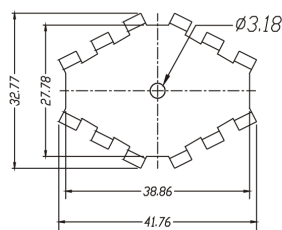
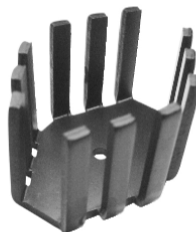

Stamped Standard Heat Sinks

BTM-1-A631051

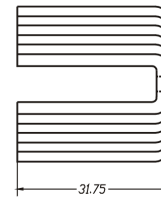
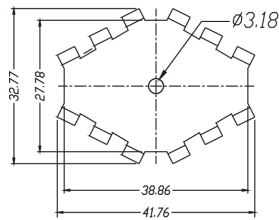

BTM-1-A631052

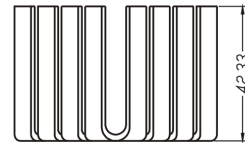
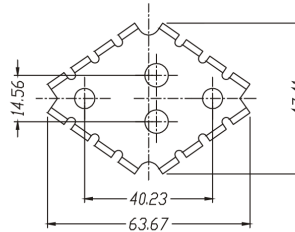

BTM-1-A631053

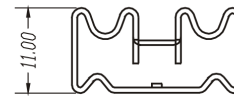
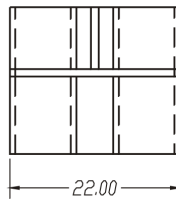

BTM-1-A631054

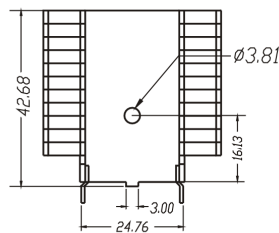
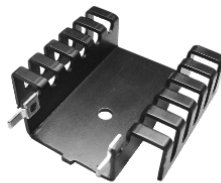

BTM-1-A631055

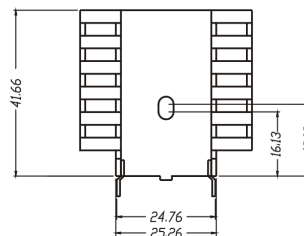

Stamped Standard Heat Sinks

BTM-1-A631056

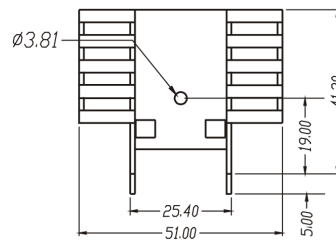
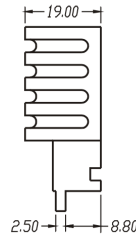
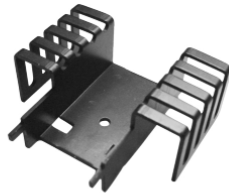

BTM-1-A631057

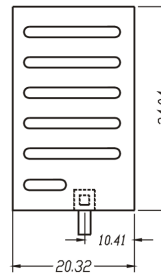
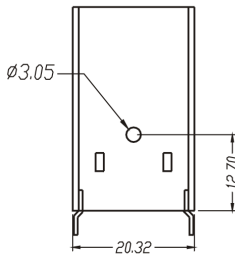

BTM-1-A631058

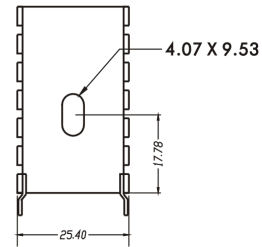
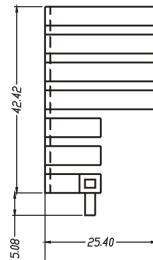
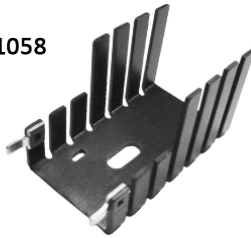

BTM-1-A631059

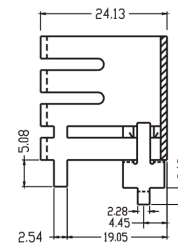
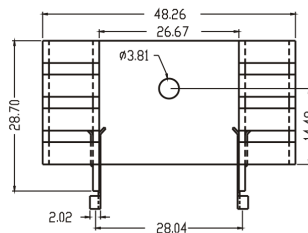

BTM-1-A631060

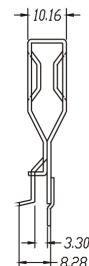
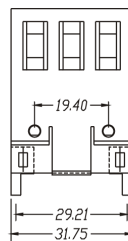

Stamped Standard Heat Sinks

BTM-1-P632001

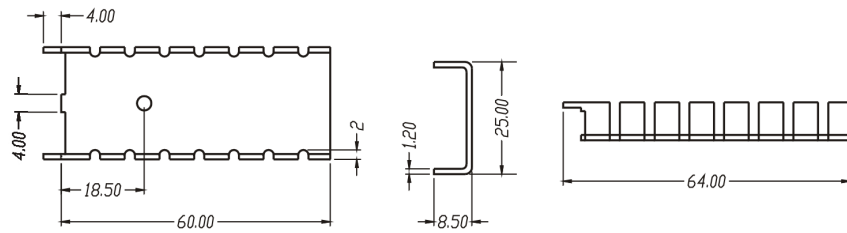
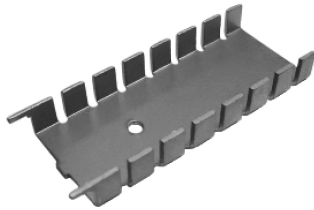

BTM-1-P632002

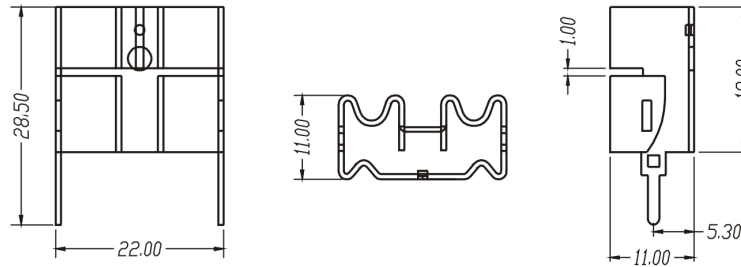

BTM-1-P632003

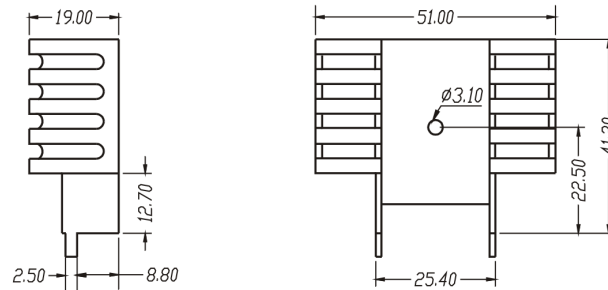

BTM-1-P632004

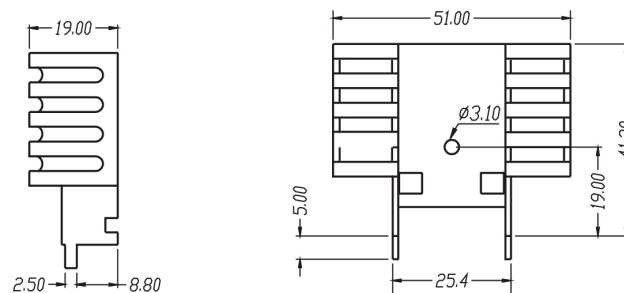
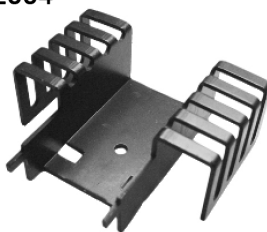

Stamped Standard Heat Sinks

BTM-1-P633001

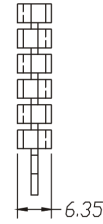
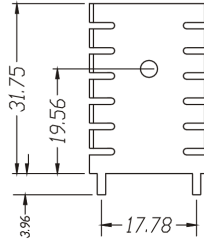
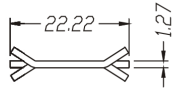

BTM-1-P633002

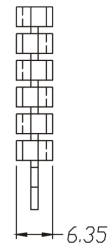
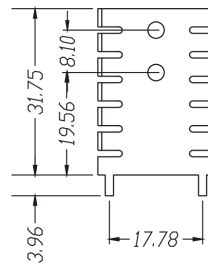
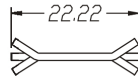

BTM-1-P633003

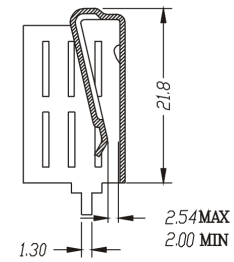
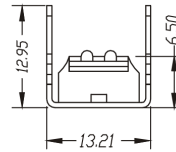
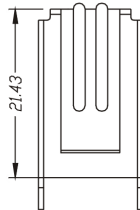

BTM-1-P633004

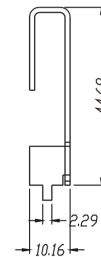
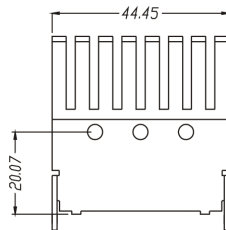
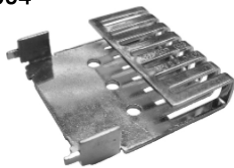

BTM-1-P633005

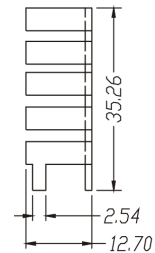
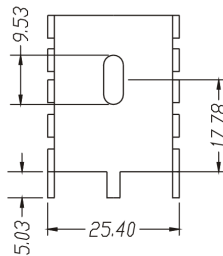
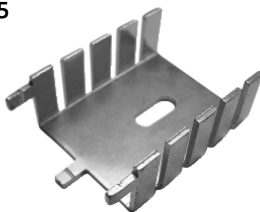

Stamped Standard Heat Sinks

BTM-1-P633006

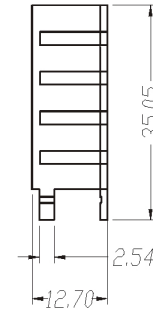
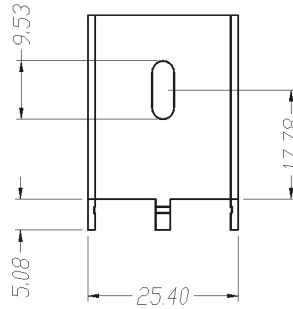
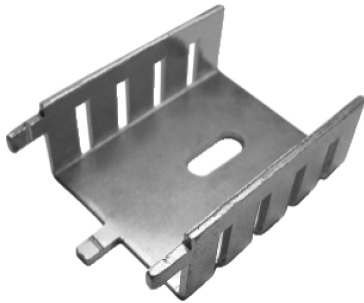

BTM-1-P633007

◆ Reel & tape carrier for SMT package available

