

## Pressure-independent 6-way zone valve.

The electronic pressure-independent 6-way zone valve from the Belimo ZoneTight™ product family combines the benefits of two tried and tested Belimo valves. The good planning reliability and efficiency of the electronic pressure-independent valve (EPIV) and the ease of installation of the 6-way characterised control valve. You also benefit from other outstanding properties:

- Time-saving and safe valve selection in accordance with maximum volumetric flow for each sequence
- Automatic, permanent hydraulic balancing through the valve
- Securing the correct amount of water with differential pressure changes and with partial loads
- Maximum plant safety through integrated pressure relief function (patent pending)
- Numerous control options, simple commissioning and checks via Near Field Communication (NFC)

BELIMO  
**ZoneTight™**

In limited-space installation situations, the zero-leaking valves from the Belimo ZoneTight™ product family are the ideal solution for energy-saving smooth room and zone control.

**BELIMO®**

# Pressure-independent 6-way zone valve. Functional, easy to install, versatile.

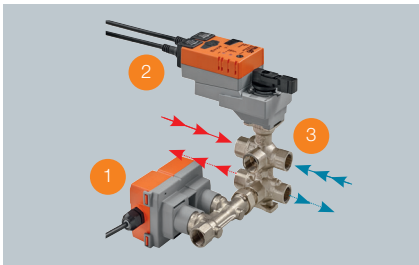

## Functional principle

- Takes over the function of four 2 port valves
- With integrated flow measurement (1) and electronic flow control (2)
- Quick to configure as the  $k_{vs}$  value does not have to be calculated
- The characterised control valve seals completely (3)

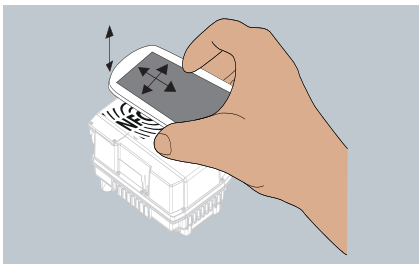

## Sequences for cooling and heating

- Different max. flow rates can be set for cooling and heating
- Assurance of the desired flow for full and partial load
- Smartphone-based commissioning and checks – even without power supply
- Can be controlled by Belimo MP-Bus®, BACnet MS/TP, Modbus or conventional control signals

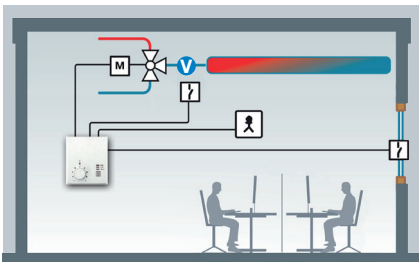

## Typical application with room temperature controller CRK24-B1

- Rapid commissioning as a result of flexible installation
- Optimises control of the 6-way zone valve
- Energy-efficient through intelligent override function

## Electronic pressure-independent 6-way zone valve: EP015R-R6+BAC (DN 15) and EP020R-R6+BAC (DN 20)

Type	Nominal diameter DN	$\dot{V}_{nom}$		Adjustable maximum flow rate $\dot{V}_{max}$ [m³/h]
		l/s	l/min	
EP015R-R6+BAC	15	0.35	21	0.063 ... 1.26
EP020R-R6+BAC	20	0.65	39	0.117 ... 2.34

Medium temperature: +6 ... +80°C, system pressure (ps): 1600 kPa

Belimo worldwide: [www.belimo.com](http://www.belimo.com)



5-year  
warranty



On site  
around the  
globe



Complete  
product range



Tested quality



Short delivery  
times



Comprehensive  
support

**BELIMO Automation AG**, Brunnenbachstrasse 1, CH-8340 Hinwil, Switzerland  
Tel. +41 43 843 61 11, Fax +41 43 843 62 68, [info@belimo.ch](mailto:info@belimo.ch)

