

# Subminiatur

## 微型连接器



## 微型插入锁紧IP67 Snap-in IP67 Subminiature

### 电缆连接器

- 插入锁紧连接器
- 3 - 8 芯
- 防护等级 IP67
- 焊接接线
- 带电缆或不带电缆
- 电缆出口直径 11.5 mm
- 带色码

### 电缆连接器

- 插入锁紧连接器
- 3 - 8 芯
- 防护等级 IP67
- 焊接/浸焊接线
- 电缆出口直径 11.5 mm
- 带色码

### Cable Connectors

- Snap-in locking system
- 3 – 8 contacts
- Degree of protection IP67
- Solder termination
- Moulded versions
- Diameter 11.5 mm
- Coloured versions

### Panel Mount Connectors

- Snap-in locking system
- 3 – 8 contacts
- Degree of protection IP67
- Solder/dip solder termination
- Diameter 11.5 mm
- Coloured versions

<sup>1)</sup>Erläuterung der Schutzarten siehe technische Informationen./ <sup>1)</sup>Explanation of protection standards see technical information.

电缆连接器，针  
Male cable connector

电缆连接器，针  
Male cable connector

图例 / Figure



尺寸图 / Drawing

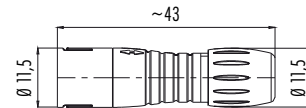
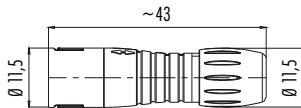

订货信息 / Order Data

芯数 Contacts	电缆出口直径 Max. cable outlet	订货号 Ordering-No.
3	3-5 mm	99 9205 00 03
4	3-5 mm	99 9209 00 04
5	3-5 mm	99 9213 00 05
8	3-5 mm	99 9225 00 08

芯数 Contacts	电缆出口直径 Max. cable outlet	订货号 Ordering-No.
3	3-5 mm	99 9205 050 03
4	3-5 mm	99 9209 050 04
5	3-5 mm	99 9213 050 05
8	3-5 mm	99 9225 050 08

技术参数 / Specifications

芯数	3	4	5	8	Number of contacts
锁紧方式	卡扣式 / snap-in				Connector locking system
接线方式	焊接 / solder				Termination
导线截面	max. 0.25 mm <sup>2</sup> (max. AWG 24)				Wire gauge
电缆出口直径	3-5 mm				Cable outlet
防护等级	IP67				Degree of protection
插拔周期	>500插拔周期 / > 500 mating cycles				Mechanical operation
最高工作温度	+ 85 °C				Upper temperature
最低工作温度	- 40 °C				Lower temperature
额定电压	125 V			63 V	Rated voltage
额定冲击电压	1500 V			800 V	Rated impulse voltage
污染等级	2				Pollution degree
过电压等级	II				Overvoltage categorie
绝缘等级	II				Material group
额定电流 (40°C)	3 A	2,5 A	2 A	1 A	Rated current (40 °C)
触点电阻	≤ 3 mΩ				Contact resistance
插针材料	CuZn (黄铜 / brass)				Material of contact
插针表面材料	Au (金 / gold)				Contact plating
插头主体材料	PA				Material of contact body
外壳材料	PA				Material of housing

电缆连接器，针  
Male cable connector

图例 / Figure



电缆连接器，针  
Male cable connector



尺寸图 / Drawing

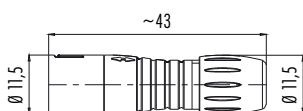

订货信息 / Order Data

芯数 Contacts	电缆出口直径 Max. cable outlet	订货号 Ordering-No.
3	3–5 mm	99 9205 060 03
4	3–5 mm	99 9209 060 04
5	3–5 mm	99 9213 060 05
8	3–5 mm	99 9225 060 08

芯数 Contacts	电缆出口直径 Max. cable outlet	订货号 Ordering-No.
3	3–5 mm	99 9205 070 03
4	3–5 mm	99 9209 070 04
5	3–5 mm	99 9213 070 05
8	3–5 mm	99 9225 070 08

技术参数 / Specifications

芯数	3	4	5	8	Number of contacts
锁紧方式	卡扣式 / snap-in				Connector locking system
接线方式	焊接 / solder				Termination
导线截面	max. 0,25 mm <sup>2</sup> (max. AWG 24)				Wire gauge
电缆出口直径	3–5 mm				Cable outlet
防护等级	IP67				Degree of protection
插拔周期	>500 插拔周期 / > 500 mating cycles				Mechanical operation
最高工作温度	+ 85 °C				Upper temperature
最低工作温度	– 40 °C				Lower temperature
额定电压	125 V			63 V	Rated voltage
额定冲击电压	1500 V			800 V	Rated impulse voltage
污染等级	2				Pollution degree
过电压等级	II				Overvoltage categorie
绝缘等级	II				Material group
额定电流 (40°C)	3 A	2,5 A	2 A	1 A	Rated current (40 °C)
触点电阻	≤ 3 mΩ				Contact resistance
插针材料	CuZn(黄铜 / brass)				Material of contact
插针表面材料	Au(金 / gold)				Contact plating
插头主体材料	PA				Material of contact body
外壳材料	PA				Material of housing

电缆连接器，孔  
Female cable connector

电缆连接器，孔  
Female cable connector

图例 / Figure



尺寸图 / Drawing

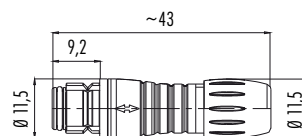
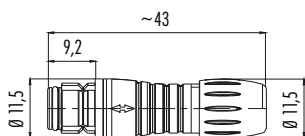

订货信息 / Order Data

芯数 Contacts	电缆出口直径 Max. cable outlet	订货号 Ordering-No.
3	3-5 mm	99 9206 00 03
4	3-5 mm	99 9210 00 04
5	3-5 mm	99 9214 00 05
8	3-5 mm	99 9226 00 08

芯数 Contacts	电缆出口直径 Max. cable outlet	订货号 Ordering-No.
3	3-5 mm	99 9206 050 03
4	3-5 mm	99 9210 050 04
5	3-5 mm	99 9214 050 05
8	3-5 mm	99 9226 050 08

技术参数 / Specifications

芯数	3	4	5	8	Number of contacts
锁紧方式	卡扣式 / snap-in				Connector locking system
接线方式	焊接 / solder				Termination
导线截面	max. 0.25 mm <sup>2</sup> (max. AWG 24)				Wire gauge
电缆出口直径	3-5 mm				Cable outlet
防护等级	IP67				Degree of protection
插拔周期	>500 插拔周期 / > 500 mating cycles				Mechanical operation
最高工作温度	+ 85 °C				Upper temperature
最低工作温度	- 40 °C				Lower temperature
额定电压	125 V			63 V	Rated voltage
额定冲击电压	1500 V			800 V	Rated impulse voltage
污染等级	2				Pollution degree
过电压等级	II				Overvoltage categorie
绝缘等级	II				Material group
额定电流 (40°C)	3 A	2,5 A	2 A	1 A	Rated current (40 °C)
触点电阻	≤ 3 mΩ				Contact resistance
插针材料	CuSn (青铜 / bronze)				Material of contact
插针表面材料	Au (金 / gold)				Contact plating
插头主体材料	PA				Material of contact body
外壳材料	PA				Material of housing

电缆连接器，孔  
Female cable connector

图例 / Figure



电缆连接器，孔  
Female cable connector



尺寸图 / Drawing

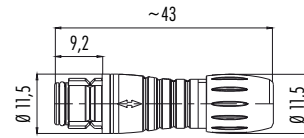
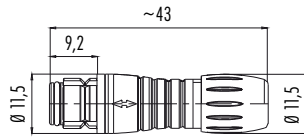

订货信息 / Order Data

芯数 Contacts	电缆出口直径 Max. cable outlet	订货号 Ordering-No.
3	3–5 mm	99 9206 060 03
4	3–5 mm	99 9210 060 04
5	3–5 mm	99 9214 060 05
8	3–5 mm	99 9226 060 08

芯数 Contacts	电缆出口直径 Max. cable outlet	订货号 Ordering-No.
3	3–5 mm	99 9206 070 03
4	3–5 mm	99 9210 070 04
5	3–5 mm	99 9214 070 05
8	3–5 mm	99 9226 070 08

技术参数 / Specifications

芯数	3	4	5	8	Number of contacts
锁紧方式	卡扣式 / snap-in				Connector locking system
接线方式	焊接 / solder				Termination
导线截面	max. 0,25 mm <sup>2</sup> (max. AWG 24)				Wire gauge
电缆出口直径	3–5 mm				Cable outlet
防护等级	IP67				Degree of protection
插拔周期	>500 插拔周期 / > 500 mating cycles				Mechanical operation
最高工作温度	+ 85 °C				Upper temperature
最低工作温度	– 40 °C				Lower temperature
额定电压	125 V			63 V	Rated voltage
额定冲击电压	1500 V			800 V	Rated impulse voltage
污染等级	2				Pollution degree
过电压等级	II				Overvoltage categorie
绝缘等级	II				Material group
额定电流 (40°C)	3 A	2,5 A	2 A	1 A	Rated current (40 °C)
触点电阻	≤ 3 mΩ				Contact resistance
插针材料	CuSn(青铜 / bronze)				Material of contact
插针表面材料	Au(金 / gold)				Contact plating
插头主体材料	PA				Material of contact body
外壳材料	PA				Material of housing

### 部件图

### Component part drawing

### 电缆连接器

### Cable connectors

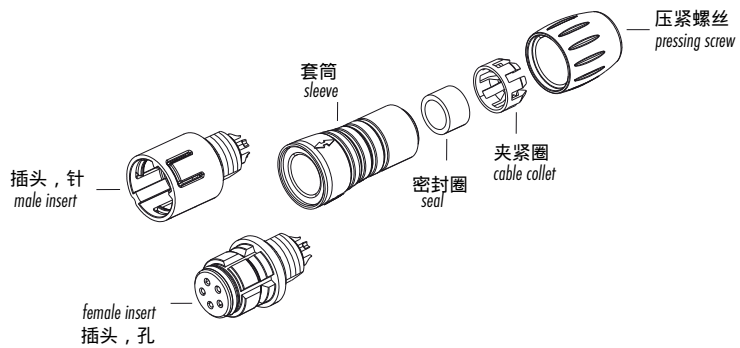



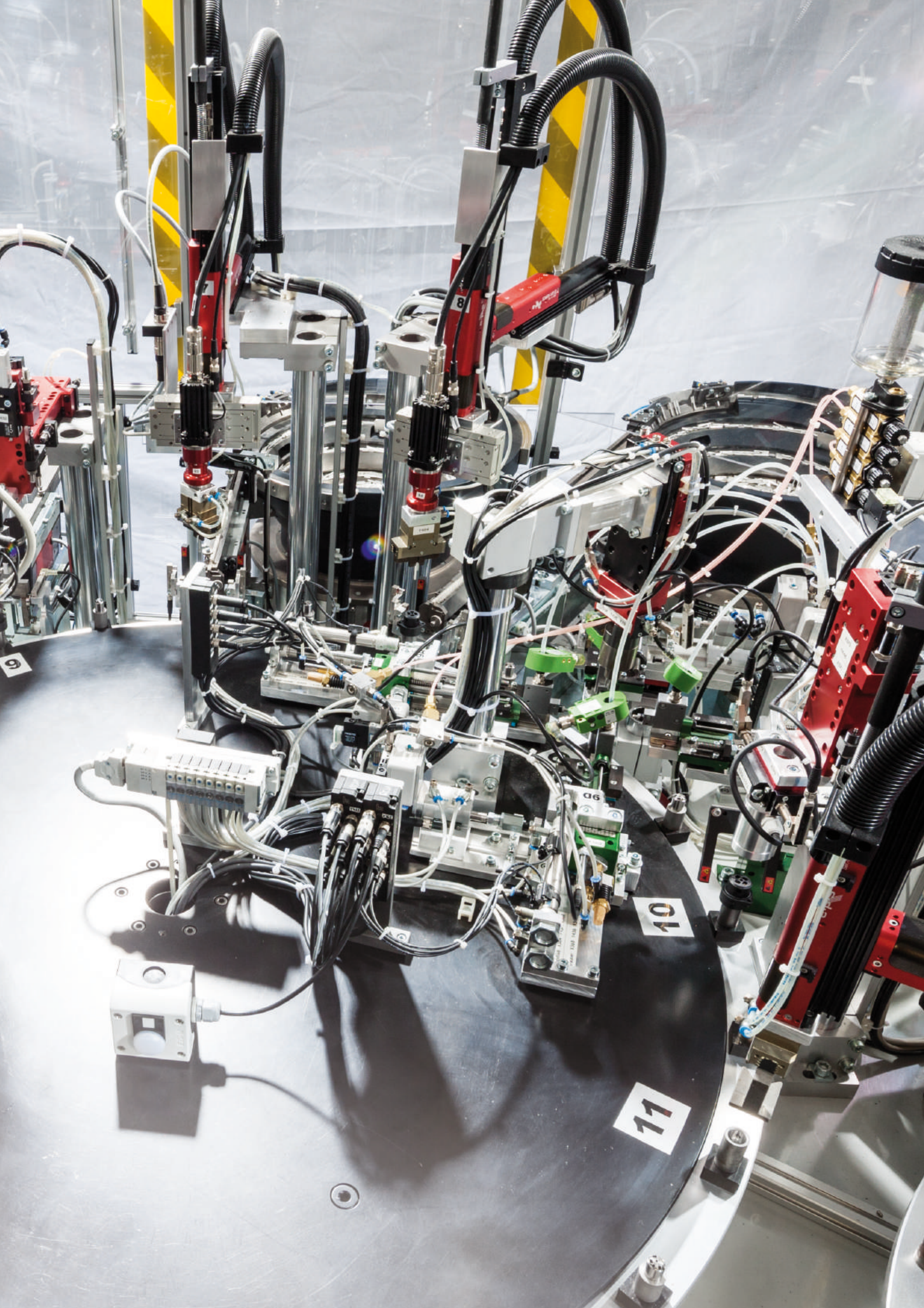



电缆连接器，针  
Male cable connector

电缆连接器，孔  
Female cable connector

图例 / Figure



尺寸图 / Drawing

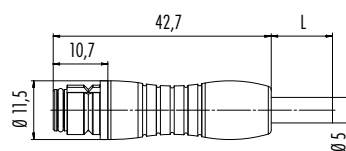
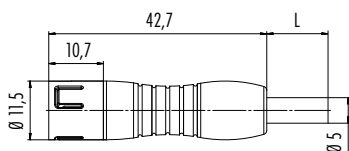

订货信息 / Order Data

芯数 Contacts	电缆长度 Cable length	订货号 Ordering-No.
3	2 m	79 9237 020 03
4	2 m	79 9241 020 04
5	2 m	79 9245 020 05
8	2 m	79 9257 020 08

芯数 Contacts	电缆长度 Cable length	订货号 Ordering-No.
3	2 m	79 9238 020 03
4	2 m	79 9242 020 04
5	2 m	79 9246 020 05
8	2 m	79 9258 020 08

技术参数 / Specifications

芯数	3	4	5	8	Number of contacts
锁紧方式	卡扣式 / snap-in				Connector locking system
接线方式	浇铸电缆 / moulded				Termination
导线截面	0,25 mm <sup>2</sup> (AWG 24)				Wire gauge
电缆出口直径	—				Cable outlet
防护等级	IP67				Degree of protection
插拔周期	>500插拔周期 / > 500 mating cycles				Mechanical operation
最高工作温度	+ 70 °C				Upper temperature
最低工作温度	- 40 °C				Lower temperature
额定电压	125 V			63 V	Rated voltage
额定冲击电压	1500 V			800 V	Rated impulse voltage
污染等级	2				Pollution degree
过电压等级	II				Overvoltage categorie
绝缘等级	II				Material group
额定电流 (40°C)	3 A	2,5 A	2 A	1 A	Rated current (40 °C)
触点电阻	≤ 3 mΩ				Contact resistance
插针材料	针 / pin CuZn (黄铜 / brass), 孔 / socket CuSn (青铜 / bronze)				Material of contact
插针表面材料	Au (金 / gold)				Contact plating
插头主体材料	PA				Material of contact body
外壳材料	PUR				Material of housing

### 电缆技术参数

#### Specifications of cable

芯数	3	4	5	8	Number of contacts
导线截面 (平方毫米)	3 x 0,25 mm <sup>2</sup> (AWG 24)	4 x 0,25 mm <sup>2</sup> (AWG 24)	5 x 0,25 mm <sup>2</sup> (AWG 24)	8 x 0,25 mm <sup>2</sup> (AWG 24)	Wire gauge mm <sup>2</sup> <sup>1)</sup>
外壳材料	PVC				Material jacket
导线绝缘层	PVC				Insulation wire
导线规格 (mm)	32 x 0,1				Design of wire (mm)
电缆外壳	4,5 <sup>+0,2</sup>		5 <sup>+0,2</sup>	5,7 <sup>+0,2</sup>	Cable jacket (mm)
导线绝缘层电阻	72 Ω/Km (20 °C)				Resistance of wire
工作温度范围 (移动电缆)	- 5 °C /+ 70 °C				Temperature range (cable in move)
工作温度范围 (禁止电缆)	- 40 °C /+ 70 °C				Temperature range (cable not in move)
弯曲半径 (移动电缆)	45 mm		50 mm	57 mm	Bending radius (cable in move)
弯曲半径 (禁止电缆)	22 mm		25 mm	28 mm	Bending radius (cable not in move)
认证	—				Approval

<sup>1)</sup> 与 AWG 的兼容性参见技术信息

<sup>1)</sup> Comparable AWG conductors see technical information.

面板安装连接器，针  
Male panel mount connector

面板安装连接器，针  
Male panel mount connector

图例 / Figure



尺寸图 / Drawing

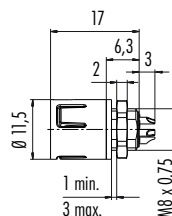
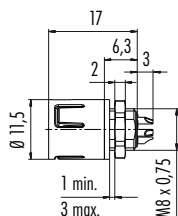

订货信息 / Order Data

芯数 Contacts	订货号 Ordering-No.
3	99 9207 00 03
4	99 9211 00 04
5	99 9215 00 05
8	99 9227 00 08

芯数 Contacts	订货号 Ordering-No.
3	99 9207 050 03
4	99 9211 050 04
5	99 9215 050 05
8	99 9227 050 08

技术参数 / Specifications

芯数	3	4	5	8	Number of contacts
锁紧方式	卡扣式 / snap-in				Connector locking system
接线方式	焊接 / solder				Termination
导线截面	max. 0.25 mm <sup>2</sup> (max. AWG 24)				Wire gauge
电缆出口直径	—				Cable outlet
防护等级	IP67				Degree of protection
插拔周期	>500 插拔周期 / > 500 mating cycles				Mechanical operation
最高工作温度	+ 85 °C				Upper temperature
最低工作温度	- 25 °C				Lower temperature
额定电压	125 V			63 V	Rated voltage
额定冲击电压	1500 V			800 V	Rated impulse voltage
污染等级	2				Pollution degree
过电压等级	II				Overvoltage categorie
绝缘等级	II				Material group
额定电流 (40°C)	3 A	2,5 A	2 A	1 A	Rated current (40 °C)
触点电阻	≤ 3 mΩ				Contact resistance
插针材料	CuZn (黄铜 / brass)				Material of contact
插针表面材料	Au (金 / gold)				Contact plating
插头主体材料	PA				Material of contact body
外壳材料	PA				Material of housing

面板安装连接器，针  
Male panel mount connector

面板安装连接器，针  
Male panel mount connector

图例 / Figure



尺寸图 / Drawing

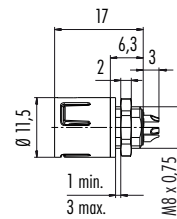
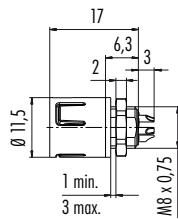

订货信息 / Order Data

芯数 Contacts	订货号 Ordering-No.
3	99 9207 060 03
4	99 9211 060 04
5	99 9215 060 05
8	99 9227 060 08

芯数 Contacts	订货号 Ordering-No.
3	99 9207 070 03
4	99 9211 070 04
5	99 9215 070 05
8	99 9227 070 08

技术参数 / Specifications

芯数	3	4	5	8	Number of contacts
锁紧方式	卡扣式 / snap-in				Connector locking system
接线方式	焊接 / solder				Termination
导线截面	max. 0,25 mm <sup>2</sup> (max. AWG 24)				Wire gauge
电缆出口直径	—				Cable outlet
防护等级	IP67				Degree of protection
插拔周期	>500 插拔周期 / > 500 mating cycles				Mechanical operation
最高工作温度	+ 85 °C				Upper temperature
最低工作温度	- 25 °C				Lower temperature
额定电压	125 V			63 V	Rated voltage
额定冲击电压	1500 V			800 V	Rated impulse voltage
污染等级	2				Pollution degree
过电压等级	II				Overvoltage categorie
绝缘等级	II				Material group
额定电流 (40°C)	3 A	2,5 A	2 A	1 A	Rated current (40 °C)
触点电阻	≤ 3 mΩ				Contact resistance
插针材料	CuZn (黄铜 / brass)				Material of contact
插针表面材料	Au (金 / gold)				Contact plating
插头主体材料	PA				Material of contact body
外壳材料	PA				Material of housing

# 微型连接器 ,620系列

Subminiature 620 Series

## Snap-in IP67

面板安装连接器，针

Male panel mount connector, dip solder

图例 / Figure



尺寸图 / Drawing

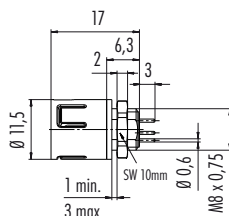

订货信息 / Order Data

芯数 Contacts	订货号 Ordering-No.
3	99 9207 090 03
4	99 9211 090 04
5	99 9215 090 05
8	99 9227 090 08

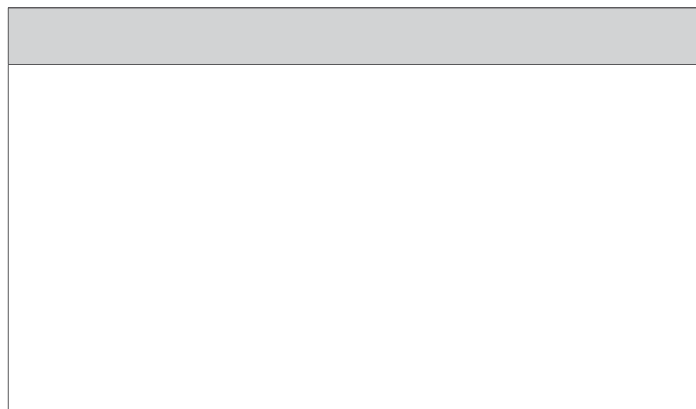

技术参数 / Specifications

芯数	3	4	5	8	Number of contacts
锁紧方式	卡扣式 / snap-in				Connector locking system
接线方式	焊接 / dip solder				Termination
导线截面	—				Wire gauge
电缆出口直径	—				Cable outlet
防护等级	IP67				Degree of protection
插拔周期	>500 插拔周期 / > 500 mating cycles				Mechanical operation
最高工作温度	+ 85 °C				Upper temperature
最低工作温度	- 25 °C				Lower temperature
额定电压	125 V			63 V	Rated voltage
额定冲击电压	1500 V			800 V	Rated impulse voltage
污染等级	2				Pollution degree
过电压等级	II				Overvoltage categorie
绝缘等级	II				Material group
额定电流 (40°C)	3 A	2,5 A	2 A	1 A	Rated current (40 °C)
触点电阻	≤ 3 mΩ				Contact resistance
插针材料	CuZn (黄铜 / brass)				Material of contact
插针表面材料	Au (金 / gold)				Contact plating
插头主体材料	PA				Material of contact body
外壳材料	PA				Material of housing



### 面板安装连接器，孔 Female panel mount connector

图例 / Figure



### 面板安装连接器，孔 Female panel mount connector



尺寸图 / Drawing

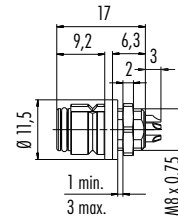
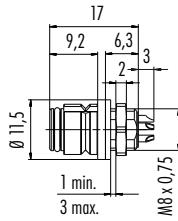

### 订货信息 / Order Data

芯数 Contacts	订货号 Ordering-No.
3	99 9208 00 03
4	99 9212 00 04
5	99 9216 00 05
8	99 9228 00 08

芯数 Contacts	订货号 Ordering-No.
3	99 9208 050 03
4	99 9212 050 04
5	99 9216 050 05
8	99 9228 050 08

### 技术参数 / Specifications

芯数	3	4	5	8	Number of contacts
锁紧方式	卡扣式 / snap-in				Connector locking system
接线方式	焊接 / solder				Termination
导线截面	max. 0.25 mm <sup>2</sup> (max. AWG 24)				Wire gauge
电缆出口直径	—				Cable outlet
防护等级	IP67				Degree of protection
插拔周期	>500 插拔周期 / > 500 mating cycles				Mechanical operation
最高工作温度	+ 85 °C				Upper temperature
最低工作温度	- 25 °C				Lower temperature
额定电压	125 V			63 V	Rated voltage
额定冲击电压	1500 V			800 V	Rated impulse voltage
污染等级	2				Pollution degree
过电压等级	II				Overvoltage categorie
绝缘等级	II				Material group
额定电流 (40 °C)	3 A	2,5 A	2 A	1 A	Rated current (40 °C)
触点电阻	≤ 3 mΩ				Contact resistance
插针材料	CuSn(青铜 / bronze)				Material of contact
插针表面材料	Au (金 / gold)				Contact plating
插头主体材料	PA				Material of contact body
外壳材料	PA				Material of housing

面板安装连接器，孔  
Female panel mount connector

面板安装连接器，孔  
Female panel mount connector

图例 / Figure



尺寸图 / Drawing

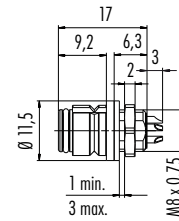
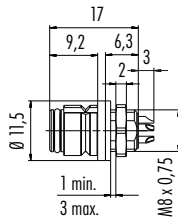

订货信息 / Order Data

芯数 Contacts	订货号 Ordering-No.
3	99 9208 060 03
4	99 9212 060 04
5	99 9216 060 05
8	99 9228 060 08

芯数 Contacts	订货号 Ordering-No.
3	99 9208 070 03
4	99 9212 070 04
5	99 9216 070 05
8	99 9228 070 08

技术参数 / Specifications

芯数	3	4	5	8	Number of contacts
锁紧方式	卡扣式 / snap-in				Connector locking system
接线方式	焊接 / solder				Termination
导线截面	max. 0.25 mm <sup>2</sup> (max. AWG 24)				Wire gauge
电缆出口直径	—				Cable outlet
防护等级	IP67				Degree of protection
插拔周期	>500 插拔周期 / > 500 mating cycles				Mechanical operation
最高工作温度	+ 85 °C				Upper temperature
最低工作温度	- 25 °C				Lower temperature
额定电压	125 V			63 V	Rated voltage
额定冲击电压	1500 V			800 V	Rated impulse voltage
污染等级	2				Pollution degree
过电压等级	II				Overvoltage categorie
绝缘等级	II				Material group
额定电流 (40 °C)	3 A	2,5 A	2 A	1 A	Rated current (40 °C)
触点电阻	≤ 3 mΩ				Contact resistance
插针材料	CuSn (青铜 / bronze)				Material of contact
插针表面材料	Au (金 / gold)				Contact plating
插头主体材料	PA				Material of contact body
外壳材料	PA				Material of housing

面板安装连接器，孔

Female panel mount connector, dip solder

图例 / Figure



尺寸图 / Drawing

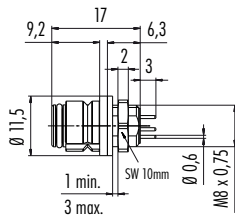

订货信息 / Order Data

芯数 Contacts	订货号 Ordering-No.
3	99 9208 090 03
4	99 9212 090 04
5	99 9216 090 05
8	99 9228 090 08

技术参数 / Specifications

芯数	3	4	5	8	Number of contacts
锁紧方式	卡扣式 / snap-in				Connector locking system
接线方式	焊接 / dip solder				Termination
导线截面	—				Wire gauge
电缆出口直径	—				Cable outlet
防护等级	IP67				Degree of protection
插拔周期	>500 插拔周期 / > 500 mating cycles				Mechanical operation
最高工作温度	+ 85 °C				Upper temperature
最低工作温度	- 25 °C				Lower temperature
额定电压	125 V			63 V	Rated voltage
额定冲击电压	1500 V			800 V	Rated impulse voltage
污染等级	2				Pollution degree
过电压等级	II				Overvoltage categorie
绝缘等级	II				Material group
额定电流(40 °C)	3 A	2,5 A	2 A	1 A	Rated current (40 °C)
触点电阻	≤ 3 mΩ				Contact resistance
插针材料	CuSn (青铜 / bronze)				Material of contact
插针表面材料	Au (金 / gold)				Contact plating
插头主体材料	PA				Material of contact body
外壳材料	PA				Material of housing

### 面板安装转换器

Adapter for panel mount connectors

图例 / Figure



### 面板安装转换器，板前固定

Adapter for panel mount connectors, front fastened



### 尺寸图 / Drawing

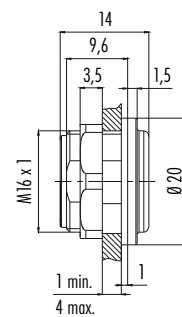
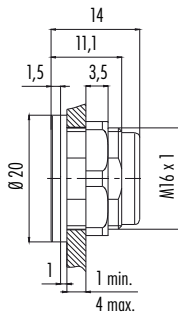

### 订货信息 / Order Data

订货号 Ordering-No.
08 2636 000 001

订货号 Ordering-No.
08 2629 000 001

### 技术参数 / Specifications

芯数		Number of contacts
锁紧方式	—	Connector locking system
接线方式	—	Termination
导线截面	—	Wire gauge
电缆出口直径	—	Cable outlet
防护等级	—	Degree of protection
插拔周期	—	Mechanical operation
最高工作温度	—	Upper temperature
最低工作温度	—	Lower temperature
额定电压	—	Rated voltage
额定冲击电压	—	Rated impulse voltage
污染等级	—	Pollution degree
过电压等级	—	Overvoltage categorie
绝缘等级	—	Material group
额定电流(40 °C)	—	Rated current (40 °C)
触点电阻	—	Contact resistance
插针材料	—	Material of contact
插针表面材料	—	Contact plating
插头主体材料	—	Material of contact body
外壳材料	PA	Material of housing

部件图

Component part drawing

面板安装连接器

Panel mount connectors

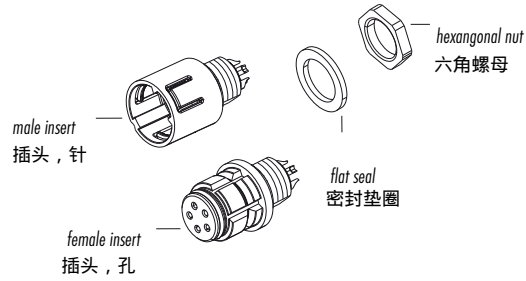

转换器组装

Assembly of adapter

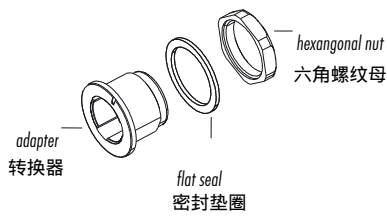

转换器组装, 板前固定

Assembly of adapter, front fastened

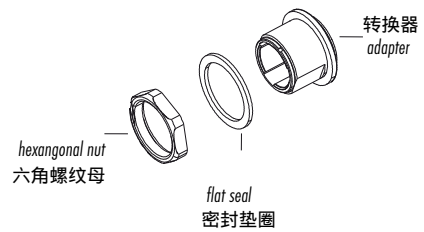

转换器

Adapter

插头必须对应转换器上的标记插入螺母中

The marking of the adapter must be conform with the coding nut of the insert

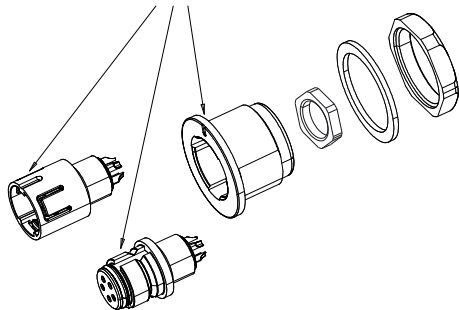

Inserts have to be ordered separately  
插头需要单独订购

转换器, 板前固定

Adapter, front fastened

插头必须对应转换器上的标记插入螺母中

The marking of the adapter must be conform with the coding nut of the insert

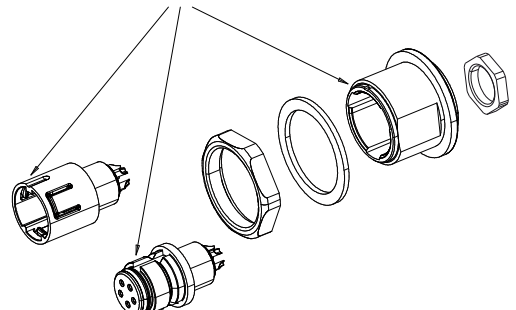

Inserts have to be ordered separately  
插头需要单独订购



### 针位图 Contact arrangements

### 插孔，针（接触面） Male insert (mating side)

### 插孔，孔（接触面） Female insert (mating side)

#### 3 芯 3 contacts

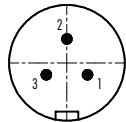

	X	Y
1	1,82	-1,05
2	0,00	2,10
3	-1,82	-1,05

- 1 棕 / brown
- 2 蓝 / blue
- 3 黑 / black

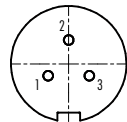

	X	Y
1	-1,82	-1,05
2	0,00	2,10
3	1,82	-1,05

- 1 棕 / brown
- 2 蓝 / blue
- 3 黑 / black

#### 4 芯 4 contacts

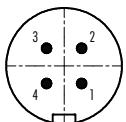

	X	Y
1	1,55	-1,55
2	1,55	1,55
3	-1,55	1,55
4	-1,55	-1,55

- 1 棕 / brown
- 2 白 / white
- 3 蓝 / blue
- 4 黑 / black

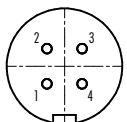

	X	Y
1	-1,55	-1,55
2	-1,55	1,55
3	1,55	1,55
4	1,55	-1,55

- 1 棕 / brown
- 2 白 / white
- 3 蓝 / blue
- 4 黑 / black

#### 5 芯 5 contacts

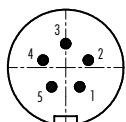

	X	Y
1	1,23	-1,70
2	2,00	0,65
3	0,00	2,10
4	-2,00	0,65
5	-1,23	-1,70

- 1 棕 / brown
- 2 白 / white
- 3 蓝 / blue
- 4 黑 / black
- 5 灰 / grey

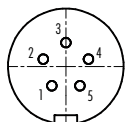

	X	Y
1	-1,23	-1,70
2	-2,00	0,65
3	0,00	2,10
4	2,00	0,65
5	1,23	-1,70

- 1 棕 / brown
- 2 白 / white
- 3 蓝 / blue
- 4 黑 / black
- 5 灰 / grey

#### 8 芯 8 contacts

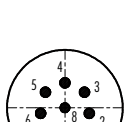

	X	Y
1	0,96	-1,98
2	2,15	-0,49
3	1,72	1,37
4	0,00	2,20
5	-1,72	1,37
6	-2,15	-0,49
7	-0,96	-1,98
8	0,00	0,00

- 1 白 / white
- 2 棕 / brown
- 3 绿 / green
- 4 黄 / yellow
- 5 灰 / grey
- 6 粉 / pink
- 7 蓝 / blue
- 8 红 / red

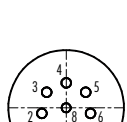

	X	Y
1	-0,96	-1,98
2	-2,15	-0,49
3	-1,72	1,37
4	0,00	2,20
5	1,72	1,37
6	2,15	-0,49
7	0,96	-1,98
8	0,00	0,00

- 1 白 / white
- 2 棕 / brown
- 3 绿 / green
- 4 黄 / yellow
- 5 灰 / grey
- 6 粉 / pink
- 7 蓝 / blue
- 8 红 / red

### 安装截面 Panel cut out

#### 法兰座连接器 Socket connectors

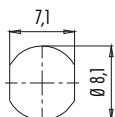

#### 转换器 Adapter

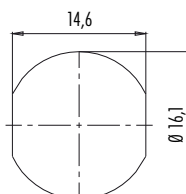

部件图

耦合件

耦合件，面板前固定

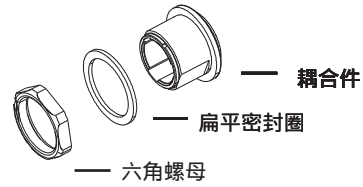

针位图，针头部件（插入端）



针位图，孔头部件（插入端）



安装步骤

面板安装连接器

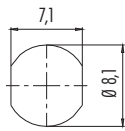

耦合件

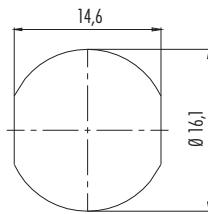

带电缆连接器导线色号

- 1 白色
- 2 棕色
- 3 绿色
- 4 黄色
- 5 灰色
- 6 粉色
- 7 兰色
- 8 红色

图例

尺寸图

订货号

针头连接器防尘帽

08 2813 000 000

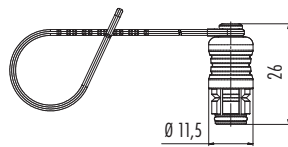

孔头连接器防尘帽

08 2823 000 000

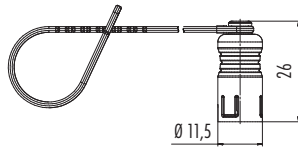

针头面板安装连接器防尘帽

08 2839 000 000

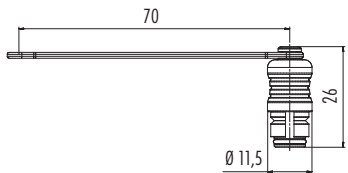

孔头面板安装连接器防尘帽

08 2831 000 000

