

Standard



Automatisierungstechnik Verbindungsleitungen

Automation Technology Connecting Cables

Verbindungsleitungen

- Schraubverriegelung nach DIN EN 61076-2
- Schutzart IP67/IP68 ¹⁾
- Am Kabel angespritzte Ausführungen

Duoverteiler

- Duostecker, umspritzt am Kabel, M8 x 1 und M12 x 1
- Zweifachverteiler

Connecting cables

- Screw locking according to DIN EN 61076-2
- Degree of protection IP67/IP68 ¹⁾
- Moulded versions

Duo distributors

- Male duo connectors, moulded, M8 x 1 and M12 x 1
- Twin distributors

¹⁾ Erläuterung der Schutzarten siehe technische Informationen. / ¹⁾ Explanation of protection standards see technical information.

电缆连接器，针，M8x1-电缆连接器，孔，卡扣系列，M8x1
Male cable connector M8 x 1 – female cable connector snap-in version M8 x 1

电缆连接器，针，M8x1-弯角电缆连接器，孔，卡扣系列，M8x1
Male cable connector M8 x 1 – female angled connector snap-in version M8 x 1

图例 / Figure



尺寸图 / Drawing

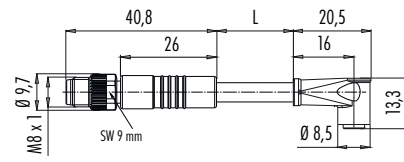
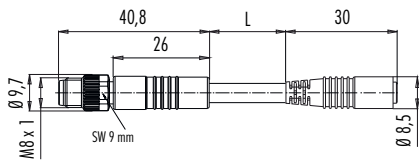

订货号 / Order Data

芯数 Contacts	电缆护套 Cable jacket	电缆长度 Cable length	订货号 ¹⁾ Ordering-No. ¹⁾
3	PUR	1 m	79 5060 10 03
		2 m	79 5060 20 03
4	PUR	1 m	79 5061 10 04
		2 m	79 5061 20 04

芯数 Contacts	电缆护套 Cable jacket	电缆长度 Cable length	订货号 ¹⁾ Ordering-No. ¹⁾
3	PUR	1 m	79 5062 10 03
		2 m	79 5062 20 03
4	PUR	1 m	79 5063 10 04
		2 m	79 5063 20 04

技术参数 / Specifications

芯数	3	4	Number of contacts
锁紧方式	卡扣 / M8螺母锁紧 / screw, snap-in		Connector locking system
接线方式	压接, 压铸电缆 / crimp, moulded		Termination
导线截面	0,25 mm ² (AWG 24)		Wire gauge
电缆出口直径	—		Cable outlet
防护等级	IP65 卡扣 / snap-in, IP67 螺纹 / screw		Degree of protection
插拔周期	螺纹 / screw > 100 插拔周期 / > 100 mating cycles 卡扣 / snap-in > 50 插拔周期 / > 50 mating cycles		Mechanical operation
最高工作温度	螺纹 / screw + 70 °C, 卡扣 / snap-in + 70 °C		Upper temperature
最低工作温度	- 25 °C		Lower temperature
额定电压	60 V	30 V	Rated voltage
额定冲击电压	1500 V	800 V	Rated impulse voltage
污染等级	3		Pollution degree
过电压等级	II		Overvoltage categorie
绝缘等级	II		Material group
额定电流 (40 °C)	4 A		Rated current (40 °C)
触点电阻	≤ 3 mΩ		Contact resistance
插针材料	针 / pin CuZn (黄铜 / brass)	孔 / socket CuSn (青铜 / bronze)	Material of contact
插针表面材料	Au (金 / gold)		Contact plating
插头主体材料	PUR		Material of contact body
外壳材料	PUR		Material of housing

电缆连接器，针，M8x1-电缆连接器，孔，M8x1
Male cable connector M8 x 1 – female cable connector M8 x 1

电缆连接器，针，M8x1-弯角电缆连接器，孔，M8x1
Male cable connector M8 x 1 – female angled connector M8 x 1

图例 / Figure



尺寸图 / Drawing

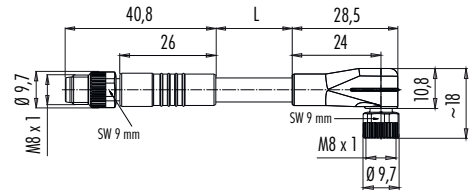
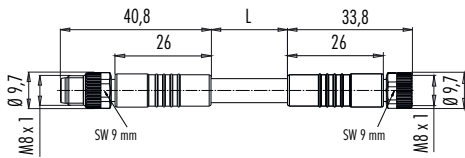

订货号 / Order Data

芯数 Contacts	电缆护套 Cable jacket	电缆长度 Cable length	订货号 ¹⁾ Ordering-No. ¹⁾
3	PUR	1 m	79 5032 10 03
		2 m	79 5032 20 03
4	PUR	1 m	79 5033 10 04
		2 m	79 5033 20 04

芯数 Contacts	电缆护套 Cable jacket	电缆长度 Cable length	订货号 ¹⁾ Ordering-No. ¹⁾
3	PUR	1 m	79 5050 10 03
		2 m	79 5050 20 03
4	PUR	1 m	79 5037 10 04
		2 m	79 5037 20 04

技术参数 / Specifications

芯数	3	4	Number of contacts
锁紧方式	M8螺母锁紧 / screw		Connector locking system
接线方式	压接，浇铸电缆 / crimp, moulded		Termination
导线截面	0,25 mm ² (AWG 24)		Wire gauge
电缆出口直径	—		Cable outlet
防护等级	IP67		Degree of protection
插拔周期	>100插拔周期 / > 100 mating cycles		Mechanical operation
最高工作温度	+ 85 °C		Upper temperature
最低工作温度	- 25 °C		Lower temperature
额定电压	60 V	30 V	Rated voltage
额定冲击电压	1500 V	800 V	Rated impulse voltage
污染等级	3		Pollution degree
过电压等级	II		Overvoltage categorie
绝缘等级	II		Material group
额定电流 (40 °C)	4 A		Rated current (40 °C)
触点电阻	≤ 3 mΩ		Contact resistance
插针材料	针 / pin CuZn (黄铜 / brass)	孔 / socket CuSn (青铜 / bronze)	Material of contact
插针表面材料	Au (金 / gold)		Contact plating
插头主体材料	PUR		Material of contact body
外壳材料	PUR		Material of housing

¹⁾ 标准电缆长度1m/2m，其他长度可以订制。¹⁾ Standard cable length is 1 m/2 m. Other length upon request.

电缆连接器，针，M8x1-弯角电缆连接器，孔，M8x1，带LED,PNP
Male cable connector M8 x 1 – female angled connector M8 x 1 with LED, PNP

双电缆连接器，针，M8x1-2只电缆连接器，孔，M8x1
Male duo connector M8 x 1 – 2 female cable connectors M8 x 1

图例 / Figure



配线图见第530页 No.1
Wiring see page 530, No. 1



配线图见第530页 No.3
Wiring see page 530, No. 3

尺寸图 / Drawing

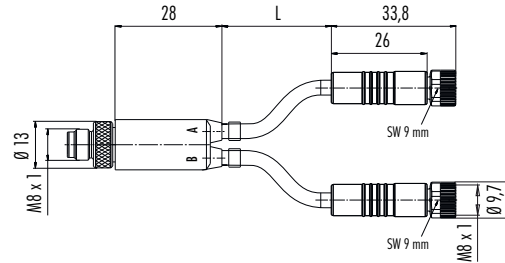
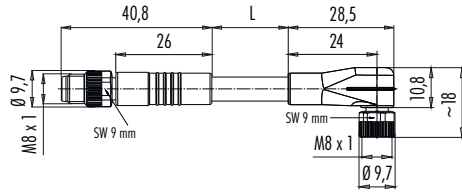

订货号 / Order Data

芯数 Contacts	电缆护套 Cable jacket	电缆长度 Cable length	订货号 ¹⁾ Ordering-No. ¹⁾
3	PUR	1 m	79 5056 10 03
		2 m	79 5056 20 03

芯数 Contacts	电缆护套 Cable jacket	电缆长度 Cable length	订货号 ¹⁾ Ordering-No. ¹⁾
4/3	PUR	0,3 m	79 5203 03 04
		0,6 m	79 5203 09 04
		1 m	79 5203 10 04

技术参数 / Specifications

芯数	3	4/3	Number of contacts
锁紧方式	M8螺母锁紧，卡扣 / screw, snap-in		Connector locking system
接线方式	压接，浇铸电缆 / crimp, moulded		Termination
导线截面	0,25 mm ² (AWG 24)		Wire gauge
电缆出口直径	—		Cable outlet
防护等级	IP67		Degree of protection
插拔周期	>100插拔周期 / > 100 mating cycles		Mechanical operation
最高工作温度	+ 85 °C		Upper temperature
最低工作温度	- 25 °C		Lower temperature
额定电压	60 V, 10–30 V 带LED/with LED	30 V	Rated voltage
额定冲击电压	1500 V, 500 V 带LED/ with LED	800 V	Rated impulse voltage
污染等级	3		Pollution degree
过电压等级	II		Overvoltage categorie
绝缘等级	II		Material group
额定电流 (40 °C)	4 A		Rated current (40 °C)
触点电阻	≤ 3 mΩ		Contact resistance
插针材料	针 / pin CuZn (黄铜 / brass)	孔 / socket CuSn(青铜 / bronze)	Material of contact
插针表面材料	Au(金 / gold)		Contact plating
插头主体材料	PUR		Material of contact body
外壳材料	PUR		Material of housing

电缆连接器，针，M8x1-电缆连接器，孔，M12x1
Male cable connector M8 x 1 – female cable connector M12 x 1

电缆连接器，针，M8x1-弯角电缆连接器，孔，M12x1
Male cable connector M8 x 1 – female angled connector M12 x 1

图例 / Figure



尺寸图 / Drawing

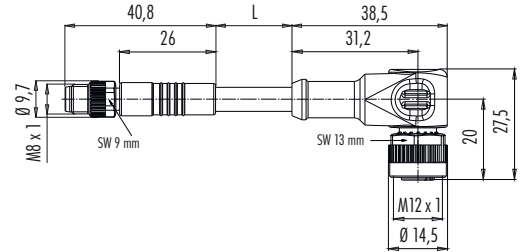
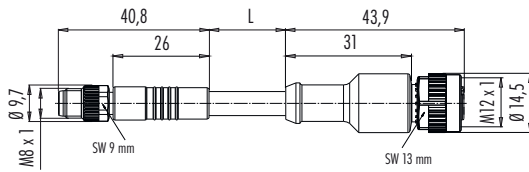

订货号 / Order Data

芯数 Contacts	电缆护套 Cable jacket	电缆长度 Cable length	订货号 ¹⁾ Ordering-No. ¹⁾
3	PUR	1 m	79 5072 10 03
		2 m	79 5072 20 03
4	PUR	1 m	79 5073 10 04
		2 m	79 5073 20 04

芯数 Contacts	电缆护套 Cable jacket	电缆长度 Cable length	订货号 ¹⁾ Ordering-No. ¹⁾
3	PUR	1 m	79 5076 10 03
		2 m	79 5076 20 03
4	PUR	1 m	79 5077 10 04
		2 m	79 5077 20 04

技术参数 / Specifications

芯数	3	4	Number of contacts
锁紧方式	M8/M12螺母锁紧 / screw		Connector locking system
接线方式	压接，浇铸电缆 / crimp, moulded		Termination
导线截面	0,25 mm ² (AWG 24)		Wire gauge
电缆出口直径	—		Cable outlet
防护等级	IP67		Degree of protection
插拔周期	>100插拔周期 / > 100 mating cycles		Mechanical operation
最高工作温度	+ 85 °C		Upper temperature
最低工作温度	- 25 °C		Lower temperature
额定电压	60 V	30 V	Rated voltage
额定冲击电压	1500 V	800 V	Rated impulse voltage
污染等级	3		Pollution degree
过电压等级	II		Overvoltage categorie
绝缘等级	II		Material group
额定电流 (40 °C)	4 A		Rated current (40 °C)
触点电阻	≤ 3 mΩ		Contact resistance
插针材料	针 / pin CuZn (黄铜 / brass)	孔 / socket CuSn (青铜 / bronze)	Material of contact
插针表面材料	Au (金 / gold)		Contact plating
插头主体材料	PUR		Material of contact body
外壳材料	PUR		Material of housing

¹⁾ 标准电缆长度1m/2m，其他长度可以订制。¹⁾ Standard cable length is 1 m/2 m. Other length upon request.

电缆连接器，针，M8x1-弯角电缆连接器，孔，M12x1，带LED,PNP
Male cable connector M8 x 1 – female angled connector M12 x 1 with LED, PNP

图例 / Figure



配线图见第530页 No.1,2
Wiring see page 530, No. 1, 2

尺寸图 / Drawing

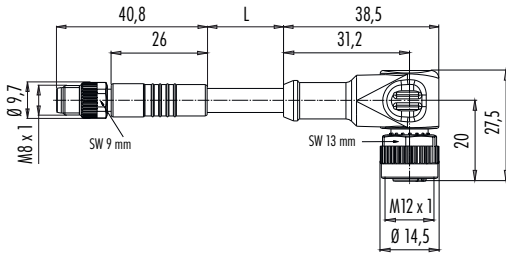

订货号 / Order Data

芯数 Contacts	电缆护套 Cable jacket	电缆长度 Cable length	订货号 ¹⁾ Ordering-No. ¹⁾
3	PUR	1 m	79 5104 10 03
		2 m	79 5104 20 03
4	PUR	1 m	79 5105 10 04
		2 m	79 5105 20 04

--

技术参数 / Specifications

芯数	3	4	Number of contacts
锁紧方式	M8/M12 螺母锁紧 /screw		Connector locking system
接线方式	压接，浇铸电缆 / crimp, moulded		Termination
导线截面	0,25 mm ² (AWG 24)		Wire gauge
电缆出口直径	—		Cable outlet
防护等级	IP67		Degree of protection
插拔周期	>100插拔周期 / > 100 mating cycles		Mechanical operation
最高工作温度	+ 85 °C		Upper temperature
最低工作温度	- 25 °C		Lower temperature
额定电压	60 V, 10–30 V 带LED/with LED	30 V	Rated voltage
额定冲击电压	1500 V, 500 V 带LED/ with LED	800 V	Rated impulse voltage
污染等级	3		Pollution degree
过电压等级	II		Overvoltage categorie
绝缘等级	II		Material group
额定电流 (40 °C)	4 A		Rated current (40 °C)
触点电阻	≤ 3 mΩ		Contact resistance
插针材料	针 / pin CuZn (黄铜 / brass) 孔 / socket CuSn(青铜 / bronze)		Material of contact
插针表面材料	Au(金 / gold)		Contact plating
插头主体材料	PUR		Material of contact body
外壳材料	PUR		Material of housing

电缆连接器，针，M12x1-电缆连接器，孔，M8x1
Male cable connector M12 x 1 – female cable connector M8 x 1

电缆连接器，针，M12x1-弯角电缆连接器，孔，M8x1
Male cable connector M12 x 1 – female angled connector M8 x 1

图例 / Figure



尺寸图 / Drawing

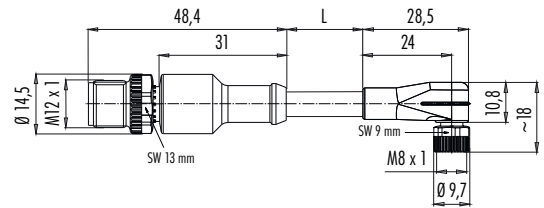
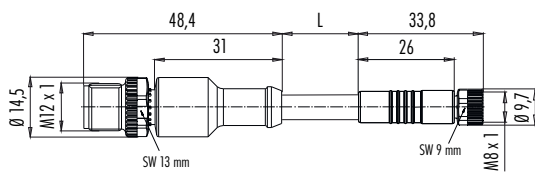

订货号 / Order Data

芯数 Contacts	电缆护套 Cable jacket	电缆长度 Cable length	订货号 ¹⁾ Ordering-No. ¹⁾
3	PUR	1 m	79 5008 10 03
		2 m	79 5008 20 03
4	PUR	1 m	79 5009 10 04
		2 m	79 5009 20 04

芯数 Contacts	电缆护套 Cable jacket	电缆长度 Cable length	订货号 ¹⁾ Ordering-No. ¹⁾
3	PUR	1 m	79 5100 10 03
		2 m	79 5100 20 03
4	PUR	1 m	79 5101 10 04
		2 m	79 5101 20 04

技术参数 / Specifications

芯数	3	4	Number of contacts
锁紧方式	M8/M12螺母锁紧 / screw		Connector locking system
接线方式	压接，浇铸电缆 / crimp, moulded		Termination
导线截面	0,25 mm ² (AWG 24)		Wire gauge
电缆出口直径	—		Cable outlet
防护等级	IP67		Degree of protection
插拔周期	>100插拔周期 / > 100 mating cycles		Mechanical operation
最高工作温度	+ 85 °C		Upper temperature
最低工作温度	- 25 °C		Lower temperature
额定电压	60 V	30 V	Rated voltage
额定冲击电压	1500 V	800 V	Rated impulse voltage
污染等级	3		Pollution degree
过电压等级	II		Overvoltage categorie
绝缘等级	II		Material group
额定电流 (40 °C)	4 A		Rated current (40 °C)
触点电阻	≤ 3 mΩ		Contact resistance
插针材料	针 / pin CuZn (黄铜 / brass)	孔 / socket CuSn (青铜 / bronze)	Material of contact
插针表面材料	Au (金 / gold)		Contact plating
插头主体材料	PUR		Material of contact body
外壳材料	PUR		Material of housing

¹⁾ 标准电缆长度1m/2m，其他长度可以订制。¹⁾ Standard cable length is 1 m/2 m. Other length upon request.

电缆连接器，针，M12x1-弯角电缆连接器，孔，M8x1，带LED, PNP
Male cable connector M12 x 1 – female angled connector M8 x 1 with LED, PNP

双电缆连接器，针，M12x1-2只电缆连接器，孔，M8x1
Male duo connector M12 x 1 – 2 female cable connectors M8 x 1

图例 / Figure



配线图见第530页 No.1
Wiring see page 530, No. 1



配线图见第530页 No.4
Wiring see page 530, No. 4

尺寸图 / Drawing

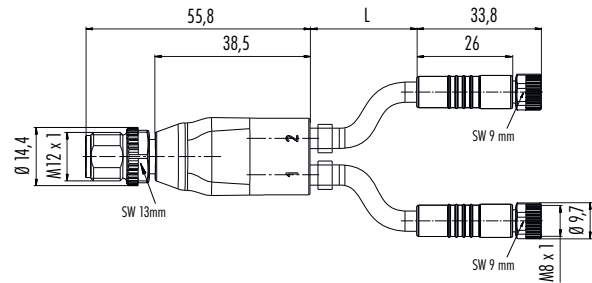
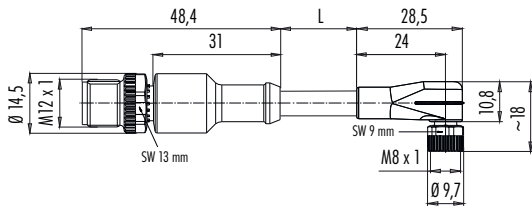

订货号 / Order Data

芯数 Contacts	电缆护套 Cable jacket	电缆长度 Cable length	订货号 ¹⁾ Ordering-No. ¹⁾
3	PUR	1 m	79 5011 10 03
		2 m	79 5011 20 03

芯数 Contacts	电缆护套 Cable jacket	电缆长度 Cable length	订货号 ¹⁾ Ordering-No. ¹⁾
4/3	PUR	1 m	79 5204 10 04
		2 m	79 5204 20 04

技术参数 / Specifications

芯数	3	4/3	Number of contacts
锁紧方式	M8/M12 螺母锁紧 / screw		Connector locking system
接线方式	压接，浇铸电缆 / crimp, moulded		Termination
导线截面	0,34 mm ² (AWG 22)		Wire gauge
电缆出口直径	—		Cable outlet
防护等级	IP67		Degree of protection
插拔周期	>100插拔周期 / > 100 mating cycles		Mechanical operation
最高工作温度	+ 85 °C		Upper temperature
最低工作温度	- 25 °C		Lower temperature
额定电压	60 V, 10–30 V 带LED/with LED	30 V	Rated voltage
额定冲击电压	1500 V, 500 V 带LED/ with LED	800 V	Rated impulse voltage
污染等级	3		Pollution degree
过电压等级	II		Overvoltage categorie
绝缘等级	II		Material group
额定电流 (40 °C)	4 A		Rated current (40 °C)
触点电阻	≤ 3 mΩ		Contact resistance
插针材料	针 / pin CuZn (黄铜 / brass) 孔 / socket CuSn(青铜 / bronze)		Material of contact
插针表面材料	Au(金 / gold)		Contact plating
插头主体材料	PUR		Material of contact body
外壳材料	PUR		Material of housing

双电缆连接器，针，M12x1-2只弯角电缆连接器，孔，M8x1
Male duo connector M12 x 1 – 2 female angled connectors M8 x 1

电缆连接器，针，M12x1-2只弯角电缆连接器，孔，M8x1，带LED, PNP
Male cable connector M12 x 1 – 2 female angled connectors M8 x 1 with LED, PNP

图例 / Figure



配线图见第530页 No.4
Wiring see page 530, No. 4



配线图见第530页 No.4
Wiring see page 530, No. 4

尺寸图 / Drawing

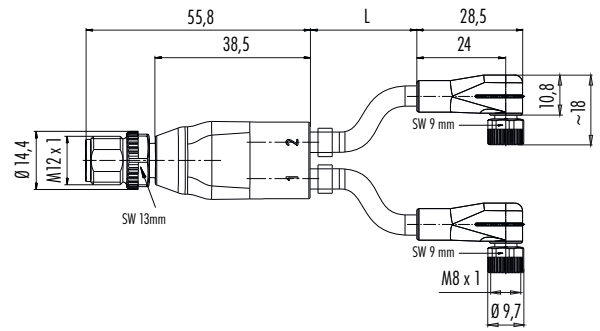
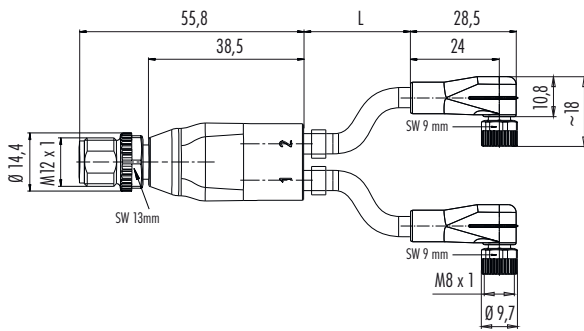

订货号 / Order Data

芯数 Contacts	电缆护套 Cable jacket	电缆长度 Cable length	订货号 ¹⁾ Ordering-No. ¹⁾
4/3	PUR	1 m	79 5205 10 04
		2 m	79 5205 20 04

芯数 Contacts	电缆护套 Cable jacket	电缆长度 Cable length	订货号 ¹⁾ Ordering-No. ¹⁾
4/3	PUR	1 m	79 5206 10 04
		2 m	79 5206 20 04

技术参数 / Specifications

芯数	4/3	Number of contacts
锁紧方式	M8/M12螺母锁紧 / screw	Connector locking system
接线方式	压接，浇铸电缆 / crimp, moulded	Termination
导线截面	0,34 mm ² (AWG 22)	Wire gauge
电缆出口直径	—	Cable outlet
防护等级	IP67	Degree of protection
插拔周期	>100插拔周期 / > 100 mating cycles	Mechanical operation
最高工作温度	+ 85 °C	Upper temperature
最低工作温度	- 25 °C	Lower temperature
额定电压	60 V, 10–30 V 带LED / with LED	Rated voltage
额定冲击电压	1500 V, 500 V 带LED / with LED	Rated impulse voltage
污染等级	3	Pollution degree
过电压等级	II	Overvoltage categorie
绝缘等级	II	Material group
额定电流 (40 °C)	4 A	Rated current (40 °C)
触点电阻	≤ 3 mΩ	Contact resistance
插针材料	针 / pin CuZn (黄铜 / brass) 孔 / socket CuSn (青铜 / bronze)	Material of contact
插针表面材料	Au (金 / gold)	Contact plating
插头主体材料	PUR	Material of contact body
外壳材料	PUR	Material of housing

¹⁾ 标准电缆长度1m/2m，其他长度可以订制。¹⁾ Standard cable length is 1 m/2 m. Other length upon request.

双弯角电缆连接器，针，M12x1-2只电缆连接器，孔，M8x1
Male angled duo connector M12 x 1 – 2 female cable connectors M8 x 1

图例 / Figure



配线图见第530页 No.4
Wiring see page 530, No. 4

尺寸图 / Drawing

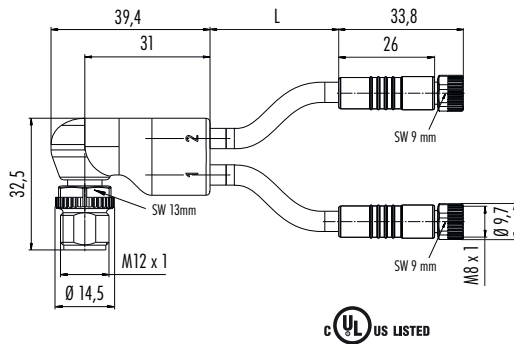

订货号 / Order Data

芯数 Contacts	电缆护套 Cable jacket	电缆长度 Cable length	订货号 ¹⁾ Ordering-No. ¹⁾
4/3	PUR	1 m	77 9827 3406 50003-0100
		2 m	77 9827 3406 50003-0200

--

技术参数 / Specifications

芯数	4/3	Number of contacts
锁紧方式	M8/M12 螺母锁紧 / screw	Connector locking system
接线方式	压接，浇铸电缆 / crimp, moulded	Termination
导线截面	0,34 mm ² (AWG 22)	Wire gauge
电缆出口直径	—	Cable outlet
防护等级	IP67	Degree of protection
插拔周期	>100插拔周期 / > 100 mating cycles	Mechanical operation
最高工作温度	+ 85 °C	Upper temperature
最低工作温度	- 25 °C	Lower temperature
额定电压	30 V	Rated voltage
额定冲击电压	800 V	Rated impulse voltage
污染等级	3	Pollution degree
过电压等级	II	Overvoltage categorie
绝缘等级	II	Material group
额定电流 (40 °C)	4 A	Rated current (40 °C)
触点电阻	≤ 3 mΩ	Contact resistance
插针材料	针 / pin CuZn (黄铜 / brass) 孔 / socket CuSn(青铜 / bronze)	Material of contact
插针表面材料	Au(金 / gold)	Contact plating
插头主体材料	PUR	Material of contact body
外壳材料	PUR	Material of housing

电缆连接器，针，M12x1-电缆连接器，孔，M12x1
Male cable connector M12 x 1 – female cable connector M12 x 1

电缆连接器，针，M12x1-弯角电缆连接器，孔，M12x1
Male cable connector M12 x 1 – female angled connector M12 x 1

图例 / Figure



尺寸图 / Drawing

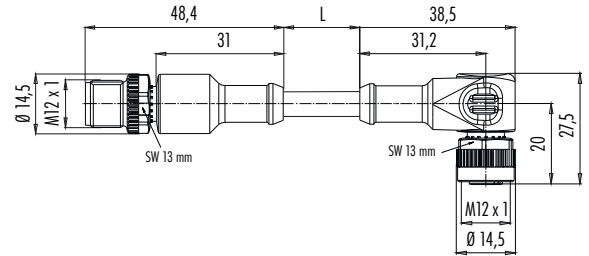
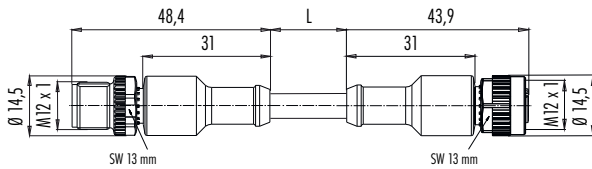

订货号 / Order Data

芯数 Contacts	电缆护套 Cable jacket	电缆长度 Cable length	订货号 ¹⁾ Ordering-No. ¹⁾
3	PUR	1 m	79 5000 10 04
		2 m	79 5000 20 04
4	PUR	1 m	79 5001 10 04
		2 m	79 5001 20 04
5	PUR	1 m	79 5002 10 05
		2 m	79 5002 20 05

芯数 Contacts	电缆护套 Cable jacket	电缆长度 Cable length	订货号 ¹⁾ Ordering-No. ¹⁾
3	PUR	1 m	79 5027 10 04
		2 m	79 5027 20 04
4	PUR	1 m	79 5028 10 04
		2 m	79 5028 20 04
5	PUR	1 m	79 5029 10 05
		2 m	79 5029 20 05

技术参数 / Specifications

芯数	3	4	5	Number of contacts
锁紧方式	M12螺母锁紧 / screw			Connector locking system
接线方式	压接，浇铸电缆 / crimp, moulded			Termination
导线截面	0,34 mm ² (AWG 22)		0,25 mm ² (AWG 24)	Wire gauge
电缆出口直径	—			Cable outlet
防护等级	IP68			Degree of protection
插拔周期	>100插拔周期 / > 100 mating cycles			Mechanical operation
最高工作温度	+ 85 °C			Upper temperature
最低工作温度	- 25 °C			Lower temperature
额定电压	250 V		60 V	Rated voltage
额定冲击电压	2500 V		1500 V	Rated impulse voltage
污染等级	3			Pollution degree
过电压等级	II			Overvoltage categorie
绝缘等级	II			Material group
额定电流 (40 °C)	4 A			Rated current (40 °C)
触点电阻	≤ 3 mΩ			Contact resistance
插针材料	针 / pin CuZn (黄铜 / brass)		孔 / socket CuSn (青铜 / bronze)	Material of contact
插针表面材料	Au (金 / gold)			Contact plating
插头主体材料	PUR			Material of contact body
外壳材料	PUR			Material of housing

¹⁾ 标准电缆长度1m/2m，其他长度可以订制。¹⁾ Standard cable length is 1 m/2 m. Other length upon request.

电缆连接器，针，M12x1-弯角电缆连接器，孔，M12x1，带LED，PNP
Male cable connector M12 x 1 – female angled connector M12 x 1 with LED, PNP

双电缆连接器，针，M12x1-2只电缆连接器，孔，M12x1
Male duo connector M12 x 1 – 2 female cable connectors M12 x 1

图例 / Figure



配线图见第530页 No.1,2
Wiring see page 530, No. 1, 2



配线图见第530页 No.4
Wiring see page 530, No. 4

尺寸图 / Drawing

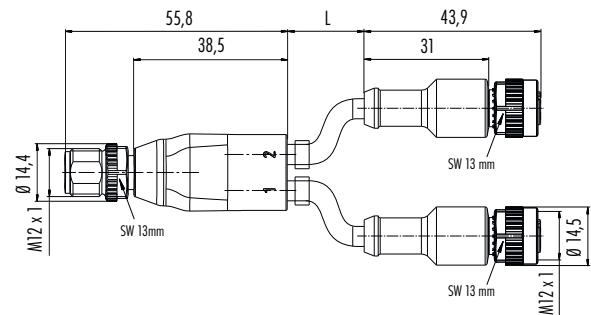
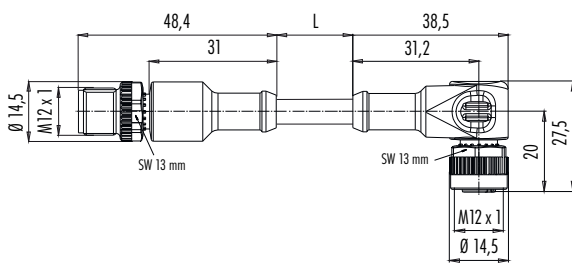

订货号 / Order Data

芯数 Contacts	电缆护套 Cable jacket	电缆长度 Cable length	订货号 ¹⁾ Ordering-No. ¹⁾
3	PUR	1 m	79 5003 10 04
		2 m	79 5003 20 04
4	PUR	1 m	79 5004 10 04
		2 m	79 5004 20 04

芯数 Contacts	电缆护套 Cable jacket	电缆长度 Cable length	订货号 ¹⁾ Ordering-No. ¹⁾
4/3	PUR	1 m	79 5200 10 04
		2 m	79 5200 20 04

技术参数 / Specifications

芯数	3	4/3	Number of contacts
锁紧方式	M12螺母锁紧/screw		Connector locking system
接线方式	压接，浇铸电缆/crimp, moulded		Termination
导线截面	0,34 mm ² (AWG 22)		Wire gauge
电缆出口直径	—		Cable outlet
防护等级	IP68		Degree of protection
插拔周期	>100插拔周期/> 100 mating cycles		Mechanical operation
最高工作温度	+ 85 °C		Upper temperature
最低工作温度	- 25 °C		Lower temperature
额定电压	250 V, 10–30 V mit LED/ with LED	250 V	Rated voltage
额定冲击电压	2500 V, 500 V mit LED/ with LED	2500 V	Rated impulse voltage
污染等级	3		Pollution degree
过电压等级	II		Overvoltage categorie
绝缘等级	II		Material group
额定电流 (40 °C)	4 A		Rated current (40 °C)
触点电阻	≤ 3 mΩ		Contact resistance
插针材料	针/pin CuZn (黄铜/brass) 孔/socket CuSn(青铜/bronze)		Material of contact
插针表面材料	Au(金/gold)		Contact plating
插头主体材料	PUR		Material of contact body
外壳材料	PUR		Material of housing

双电缆连接器，针，M12x1-2只电缆连接器，孔，M12x1
Male duo connector M12 x 1 – 2 female cable connectors M12 x 1, shielded

双电缆连接器，针，M12x1-2只电缆连接器，孔，M12x1 CAN-Bus
Male duo connector M12 x 1 – 2 female cable connectors M12 x 1, CAN-Bus

图例 / Figure



配线图见第530页 No.5
Wiring see page 530, No. 5



配线图见第530页 No.6
Wiring see page 530, No. 6

尺寸图 / Drawing

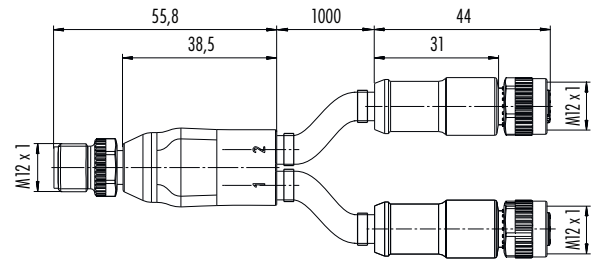
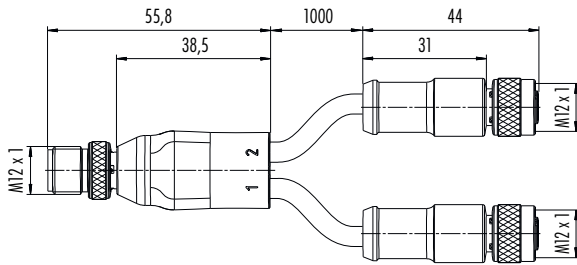

订货号 / Order Data

芯数 Contacts	电缆护套 Cable jacket	电缆长度 Cable length	订货号 ¹⁾ Ordering-No. ¹⁾
4/3	PUR	1 m	79 5234 10 04
		2 m	79 5234 20 04

芯数 Contacts	电缆护套 Cable jacket	电缆长度 Cable length	订货号 ¹⁾ Ordering-No. ¹⁾
5	PUR	1 m	79 5229 10 05
		2 m	79 5229 20 05

技术参数 / Specifications

芯数	4/3	5	Number of contacts
锁紧方式	M12螺母锁紧 / screw		Connector locking system
接线方式	压接，浇铸电缆 / crimp, moulded		Termination
导线截面	0,34 mm ² (AWG 22)	1 x 2 x 0,34 mm ² (1 x 2 x AWG 22), 1 x 2 x 0,25 mm ² (1 x 2 x AWG 24)	Wire gauge
电缆出口直径	—		Cable outlet
防护等级	IP68	IP67	Degree of protection
插拔周期	>100插拔周期 / > 100 mating cycles		Mechanical operation
最高工作温度	+ 85 °C		Upper temperature
最低工作温度	- 25 °C		Lower temperature
额定电压	250 V	60 V	Rated voltage
额定冲击电压	2500 V	1500 V	Rated impulse voltage
污染等级	3		Pollution degree
过电压等级	II		Overvoltage categorie
绝缘等级	II		Material group
额定电流 (40 °C)	4 A		Rated current (40 °C)
触点电阻	≤ 3 mΩ		Contact resistance
插针材料	针 / pin CuZn (黄铜 / brass)	孔 / socket CuSn (青铜 / bronze)	Material of contact
插针表面材料	Au (金 / gold)		Contact plating
插头主体材料	PUR		Material of contact body
外壳材料	PUR		Material of housing

¹⁾ 标准电缆长度1m/2m，其他长度可以订制。¹⁾ Standard cable length is 1 m/2 m. Other length upon request.

双电缆连接器，针，M12x1-2只电缆连接器，孔，M12x1 PROFIBUS
Male duo connector M12 x 1 – 2 female cable connectors M12 x 1, PROFIBUS

双电缆连接器，针，M12x1-2只弯角电缆连接器，孔，M12x1
Male duo connector M12 x 1 – 2 female angled connectors M12 x 1

图例 / Figure



配线图见第530页 No.7
Wiring see page 530, No. 7



配线图见第530页 No.4
Wiring see page 530, No. 4

尺寸图 / Drawing

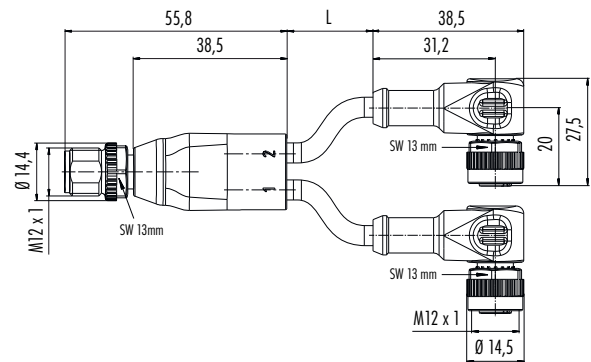
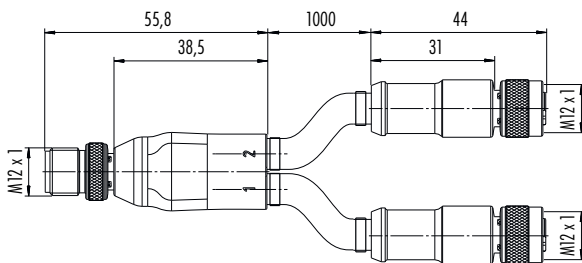

订货号 / Order Data

芯数 Contacts	电缆护套 Cable jacket	电缆长度 Cable length	订货号 ¹⁾ Ordering-No. ¹⁾
2	PUR	1 m	79 5225 10 02
		2 m	79 5225 20 02

芯数 Contacts	电缆护套 Cable jacket	电缆长度 Cable length	订货号 ¹⁾ Ordering-No. ¹⁾
4/3	PUR	1 m	79 5201 10 04
		2 m	79 5201 20 04

技术参数 / Specifications

芯数	2	4/3	Number of contacts
锁紧方式	M12螺母锁紧/screw		Connector locking system
接线方式	压接，浇铸电缆/crimp, moulded		Termination
导线截面	0,25 mm ² (AWG 24)	0,34 mm ² (AWG 22)	Wire gauge
电缆出口直径	—		Cable outlet
防护等级	IP65	IP68	Degree of protection
插拔周期	>100插拔周期/> 100 mating cycles		Mechanical operation
最高工作温度	+ 85 °C		Upper temperature
最低工作温度	- 25 °C		Lower temperature
额定电压	60 V	250 V	Rated voltage
额定冲击电压	1500 V	2500 V	Rated impulse voltage
污染等级	3		Pollution degree
过电压等级	II		Overvoltage categorie
绝缘等级	II		Material group
额定电流 (40 °C)	4 A		Rated current (40 °C)
触点电阻	≤ 3 mΩ		Contact resistance
插针材料	针/pin CuZn (黄铜/brass) 孔/socket CuSn(青铜/bronze)		Material of contact
插针表面材料	Au(金/gold)		Contact plating
插头主体材料	PUR		Material of contact body
外壳材料	PUR		Material of housing

双电缆连接器，针，M12x1-2只弯角电缆连接器，孔，M12x1，带LED，PNP
Male duo connector M12 x 1 – 2 female angled connectors M12 x 1 with LED, PNP

双弯角电缆连接器，针，M12x1-2只电缆连接器，孔，M12x1
Male angled duo connector M12 x 1 – 2 female cable connectors M12 x 1

图例 / Figure



配线图见第530页 No.4
Wiring see page 530, No. 4



配线图见第530页 No.4
Wiring see page 530, No. 4

尺寸图 / Drawing

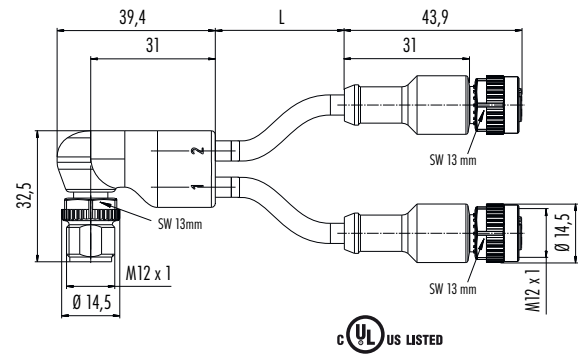
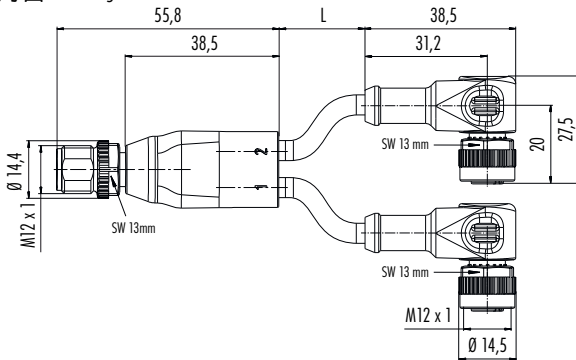

订货号 / Order Data

芯数 Contacts	电缆护套 Cable jacket	电缆长度 Cable length	订货号 ¹⁾ Ordering-No. ¹⁾
4/3	PUR	1 m	79 5202 10 04
		2 m	79 5202 20 04

芯数 Contacts	电缆护套 Cable jacket	电缆长度 Cable length	订货号 ¹⁾ Ordering-No. ¹⁾
4/3	PUR	1 m	77 9827 3430 50003-0100
		2 m	77 9827 3430 50003-0200

技术参数 / Specifications

芯数	4/3	Number of contacts
锁紧方式	M12螺母锁紧 / screw	Connector locking system
接线方式	压接，浇铸电缆 / crimp, moulded	Termination
导线截面	0,34 mm ² (AWG 22)	Wire gauge
电缆出口直径	—	Cable outlet
防护等级	IP68	Degree of protection
插拔周期	>100插拔周期 / > 100 mating cycles	Mechanical operation
最高工作温度	+ 85 °C	Upper temperature
最低工作温度	- 25 °C	Lower temperature
额定电压	250 V, 10–30 V mit LED/ with LED	Rated voltage
额定冲击电压	2500 V, 500 V mit LED/ with LED	Rated impulse voltage
污染等级	3	Pollution degree
过电压等级	II	Overvoltage categorie
绝缘等级	II	Material group
额定电流 (40 °C)	4 A	Rated current (40 °C)
触点电阻	≤ 3 mΩ	Contact resistance
插针材料	针 / pin CuZn (黄铜 / brass) 孔 / socket CuSn (青铜 / bronze)	Material of contact
插针表面材料	Au (金 / gold)	Contact plating
插头主体材料	PUR	Material of contact body
外壳材料	PUR	Material of housing

¹⁾ 标准电缆长度1m/2m，其他长度可以订制。¹⁾ Standard cable length is 1 m/2 m. Other length upon request.

两相分配器，连接器，针，M8x1-连接器，孔x2，M8x1
Twin distributor, male connector M8 x 1 – 2 female connectors M8 x 1

两相分配器，连接器，针，M8x1-连接器，孔x2，M8x1
Twin distributor, male connector M8 x 1 – 2 female connectors M8 x 1

图例 / Figure



配线图见第531页 No.11
Wiring see page 531, No. 11

配线图见第531页 No.11
Wiring see page 531, No. 11

尺寸图 / Drawing

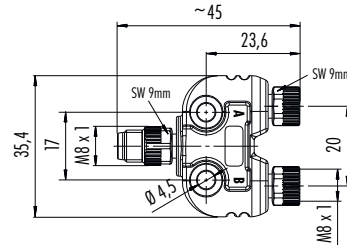
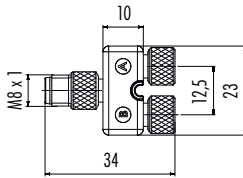

订货号 / Order Data

芯数 Contacts	订货号 Ordering-No.
4/3	79 5280 00 04

芯数 Contacts	订货号 Ordering-No.
4/3	79 5232 70 04

技术参数 / Specifications

芯数	4/3	Number of contacts
锁紧方式	M8螺母锁紧/screw	Connector locking system
接线方式	—	Termination
导线截面	—	Wire gauge
电缆出口直径	—	Cable outlet
防护等级	IP68	Degree of protection
插拔周期	>100插拔周期/> 100 mating cycles	Mechanical operation
最高工作温度	+ 85 °C	Upper temperature
最低工作温度	- 25 °C	Lower temperature
额定电压	60 V	Rated voltage
额定冲击电压	1500 V	Rated impulse voltage
污染等级	3	Pollution degree
过电压等级	II	Overvoltage categorie
绝缘等级	II	Material group
额定电流 (40 °C)	4 A	Rated current (40 °C)
触点电阻	≤ 3 mΩ	Contact resistance
插针材料	针 /pin CuZn (黄铜/brass) 孔/socket CuSn(青铜/bronze)	Material of contact
插针表面材料	Au(金/gold)	Contact plating
插头主体材料	PUR	Material of contact body
外壳材料	PUR	Material of housing

两相分配器, 连接器, 针, M12x1-连接器, 孔x2, M8x1
Twin distributor, male connector M12 x 1 – 2 female connectors M8 x 1

两相分配器, 连接器, 针, M12x1-连接器, 孔x2, M8x1
Twin distributor, male connector M12 x 1 – 2 female connectors M8 x 1

图例 / Figure



配线图见第531页 No.11
Wiring see page 531, No. 11

配线图见第531页 No.11
Wiring see page 531, No. 11

尺寸图 / Drawing

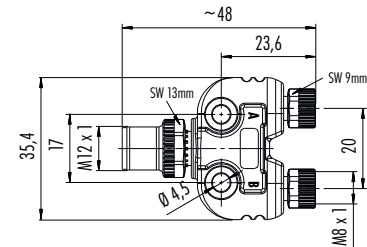
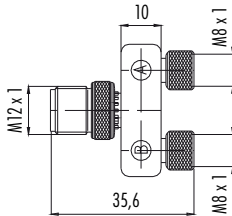

订货号 / Order Data

芯数 Contacts	订货号 Ordering-No.
4/3	79 5204 00 04

芯数 Contacts	订货号 Ordering-No.
4/3	79 5232 90 04

技术参数 / Specifications

芯数	4/3	Number of contacts
锁紧方式	M8/M12螺母锁紧/screw	Connector locking system
接线方式	—	Termination
导线截面	—	Wire gauge
电缆出口直径	—	Cable outlet
防护等级	IP68	Degree of protection
插拔周期	>100插拔周期/> 100 mating cycles	Mechanical operation
最高工作温度	+ 85 °C	Upper temperature
最低工作温度	- 25 °C	Lower temperature
额定电压	60 V	Rated voltage
额定冲击电压	1500 V	Rated impulse voltage
污染等级	3	Pollution degree
过电压等级	II	Overvoltage categorie
绝缘等级	II	Material group
额定电流 (40 °C)	4 A	Rated current (40 °C)
触点电阻	≤ 3 mΩ	Contact resistance
插针材料	针/pin CuZn (黄铜/brass) 孔/socket CuSr(青铜/bronze)	Material of contact
插针表面材料	Au(金/gold)	Contact plating
插头主体材料	PUR	Material of contact body
外壳材料	PUR	Material of housing

两相分配器，连接器，针，M12x1-连接器，孔x2，M8x1
Twin distributor, male connector M12 x 1 – 2 female connectors M8 x 1

图例 / Figure



配线图见第530页 No.8
Wiring see page 530, No. 8

尺寸图 / Drawing

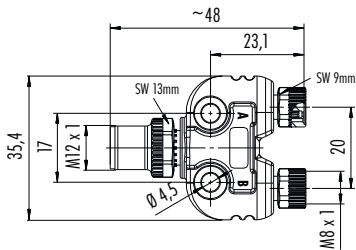

订货号 / Order Data

芯数 Contacts	订货号 Ordering-No.
4/3	79 5232 00 04

--

技术参数 / Specifications

芯数	4/3	Number of contacts
锁紧方式	M8/M12 螺母锁紧 / screw	Connector locking system
接线方式	—	Termination
导线截面	—	Wire gauge
电缆出口直径	—	Cable outlet
防护等级	IP68	Degree of protection
插拔周期	>100插拔周期 / > 100 mating cycles	Mechanical operation
最高工作温度	+ 85 °C	Upper temperature
最低工作温度	- 25 °C	Lower temperature
额定电压	60 V	Rated voltage
额定冲击电压	1500 V	Rated impulse voltage
污染等级	3	Pollution degree
过电压等级	II	Overvoltage categorie
绝缘等级	II	Material group
额定电流 (40 °C)	4 A	Rated current (40 °C)
触点电阻	≤ 3 mΩ	Contact resistance
插针材料	针 / pin CuZn (黄铜 / brass) 孔 / socket CuSn(青铜 / bronze)	Material of contact
插针表面材料	Au(金 / gold)	Contact plating
插头主体材料	PUR	Material of contact body
外壳材料	PUR	Material of housing

两相分配器，连接器，针，M12x1-连接器，孔x2，M12x1
Twin distributor, male connector M12 x 1 – 2 female connectors M12 x 1

两相分配器，1：1触点，连接器，针，M8x1-连接器，孔x2，M12x1
Twin distributor, 1:1 wiring, male connector M12 x 1 – 2 female connectors M12 x 1

图例 / Figure



配线图见第531页 No.16,17,18
Wiring see page 531, No. 16, 17, 18



配线图见第531页 No.13,15
Wiring see page 531, No. 13, 15

尺寸图 / Drawing

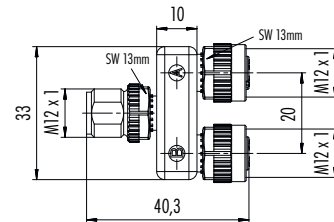
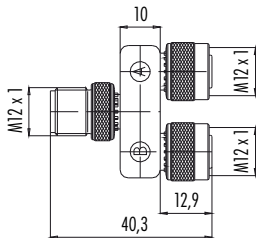

订货号 / Order Data

芯数 Contacts	订货号 Ordering-No.
4	79 5200 00 04
5/4	79 5207 00 05
5	79 5208 00 05

芯数 Contacts	订货号 Ordering-No.
5	79 5210 00 05
8	79 5211 00 08

技术参数 / Specifications

芯数	4	5/4	5	8	Number of contacts
锁紧方式	M12螺母锁紧 /screw				Connector locking system
接线方式	—				Termination
导线截面	—				Wire gauge
电缆出口直径	—				Cable outlet
防护等级	IP68				Degree of protection
插拔周期	>100插拔周期 /> 100 mating cycles				Mechanical operation
最高工作温度	+ 85 °C				Upper temperature
最低工作温度	- 25 °C				Lower temperature
额定电压	250 V		60 V		Rated voltage
额定冲击电压	2500 V		1500 V		Rated impulse voltage
污染等级	3				Pollution degree
过电压等级	II				Overvoltage categorie
绝缘等级	II				Material group
额定电流 (40 °C)	4 A				Rated current (40 °C)
触点电阻	≤ 3 mΩ				Contact resistance
插针材料	针 /pin CuZn (黄铜 /brass) 孔 /socket CuSr(青铜 / bronze)				Material of contact
插针表面材料	Au(金 /gold)				Contact plating
插头主体材料	PUR				Material of contact body
外壳材料	PUR				Material of housing

两相分配器，连接器，针，M12x1-连接器，孔x2，M12x1
Twin distributor, male connector M12 x 1 – 2 female connectors M12 x 1

两相分配器，连接器，针，M12x1-连接器，孔x2，M12x1
Twin distributor, male connector M12 x 1 – 2 female connectors M12 x 1

图例 / Figure



配线图见第531页 No.11,13
Wiring see page 531, No. 11, 13



配线图见第530页 No.8
Wiring see page 530, No. 8

尺寸图 / Drawing

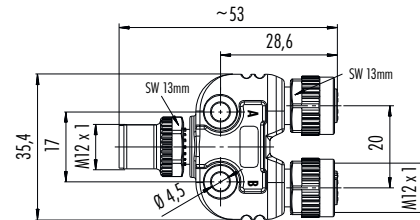
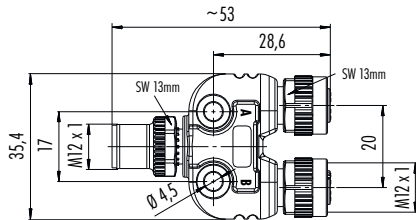

订货号 / Order Data

芯数 Contacts	订货号 Ordering-No.
4/3	79 5236 90 04
5	79 5236 40 05

芯数 Contacts	订货号 Ordering-No.
4/3	79 5236 00 04

技术参数 / Specifications

芯数	4/3	5	Number of contacts
锁紧方式	M12螺母锁紧/screw		Connector locking system
接线方式	—		Termination
导线截面	—		Wire gauge
电缆出口直径	—		Cable outlet
防护等级	IP68		Degree of protection
插拔周期	>100插拔周期/> 100 mating cycles		Mechanical operation
最高工作温度	+ 85 °C		Upper temperature
最低工作温度	- 25 °C		Lower temperature
额定电压	60 V		Rated voltage
额定冲击电压	1500 V		Rated impulse voltage
污染等级	3		Pollution degree
过电压等级	II		Overvoltage categorie
绝缘等级	II		Material group
额定电流 (40 °C)	4 A		Rated current (40 °C)
触点电阻	≤ 3 mΩ		Contact resistance
插针材料	针/pin CuZn (黄铜/brass)	孔/socket CuSn(青铜/bronze)	Material of contact
插针表面材料	Au(金/gold)		Contact plating
插头主体材料	PUR		Material of contact body
外壳材料	PUR		Material of housing

不锈钢两相分配器, 1:1触点, 连接器, 针, M12x1-连接器, 孔x2, M12x1
Stainless steel twin distributor, 1:1 wiring, male connector M12 x 1 – 2 female connectors M12 x 1

T型头, 连接器, 针, M12x1-连接器, 孔x2, M12x1
T-Piece, male connector M12 x 1 – 2 female connectors M12 x 1

图例 / Figure



配线图见第531页 No.13
Wiring see page 531, No. 13



配线图见第531页 No.13
Wiring see page 531, No. 13

尺寸图 / Drawing

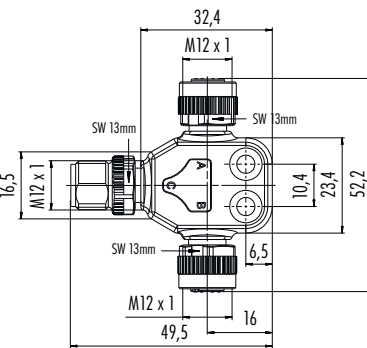
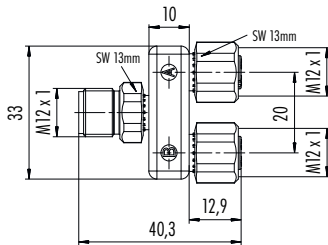

订货号 / Order Data

芯数 Contacts	订货号 Ordering-No.
5	79 5210 17 05

芯数 Contacts	订货号 Ordering-No.
5	79 5256 100 05

技术参数 / Specifications

芯数	5	Number of contacts
锁紧方式	M12螺母锁紧 / screw	Connector locking system
接线方式	—	Termination
导线截面	—	Wire gauge
电缆出口直径	—	Cable outlet
防护等级	IP68	Degree of protection
插拔周期	>100插拔周期 / > 100 mating cycles	Mechanical operation
最高工作温度	+ 85 °C	Upper temperature
最低工作温度	- 25 °C	Lower temperature
额定电压	60 V	Rated voltage
额定冲击电压	1500 V	Rated impulse voltage
污染等级	3	Pollution degree
过电压等级	II	Overvoltage categorie
绝缘等级	II	Material group
额定电流 (40 °C)	4 A	Rated current (40 °C)
触点电阻	≤ 3 mΩ	Contact resistance
插针材料	针 / pin CuZn (黄铜 / brass) 孔 / socket CuSr (青铜 / bronze)	Material of contact
插针表面材料	Au (金 / gold)	Contact plating
插头主体材料	PUR	Material of contact body
外壳材料	PUR	Material of housing

两相分配器, 1:1触点, 连接器, 孔, M12x1-连接器, 针/孔, M12x1
Twin distributor, 1:1 wiring, female connector M12 x 1 – male/female connector M12 x 1

两相分配器, 连接器, 孔, M12x1-连接器, 针/孔, M12x1
Twin distributor, female connector M12 x 1 – male/female connector M12 x 1

图例 / Figure



配线图见第531页 No.14
Wiring see page 531, No. 14



配线图见第531页 No.12
Wiring see page 531, No. 12

尺寸图 / Drawing

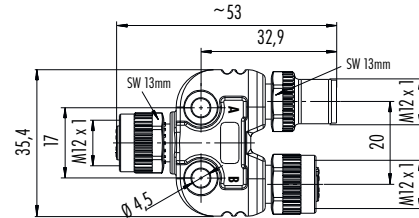
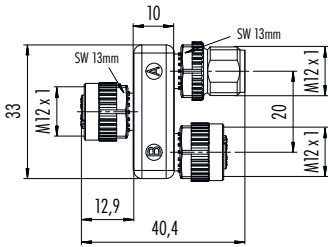

订货号 / Order Data

芯数 Contacts	订货号 Ordering-No.
5	79 5212 00 05

芯数 Contacts	订货号 Ordering-No.
4	79 5238 00 04

技术参数 / Specifications

芯数	4	5	Number of contacts
锁紧方式	M12螺母锁紧/screw		Connector locking system
接线方式	—		Termination
导线截面	—		Wire gauge
电缆出口直径	—		Cable outlet
防护等级	IP68		Degree of protection
插拔周期	>100插拔周期/> 100 mating cycles		Mechanical operation
最高工作温度	+ 85 °C		Upper temperature
最低工作温度	- 25 °C		Lower temperature
额定电压	250 V	60 V	Rated voltage
额定冲击电压	2500 V	1500 V	Rated impulse voltage
污染等级	3		Pollution degree
过电压等级	II		Overvoltage categorie
绝缘等级	II		Material group
额定电流 (40 °C)	4 A		Rated current (40 °C)
触点电阻	≤ 3 mΩ		Contact resistance
插针材料	针/pin CuZn (黄铜/brass) 孔/socket CuSn(青铜/bronze)		Material of contact
插针表面材料	Au(金/gold)		Contact plating
插头主体材料	PUR		Material of contact body
外壳材料	PUR		Material of housing

T型头，连接器，孔，M12x1-连接器，针/孔，M12x1
T-Piece, female connector M12 x 1 – male/female connector M12 x 1

图例 / Figure



配线图见第531页 No.12,14
Wiring see page 531, No. 12, 14

尺寸图 / Drawing

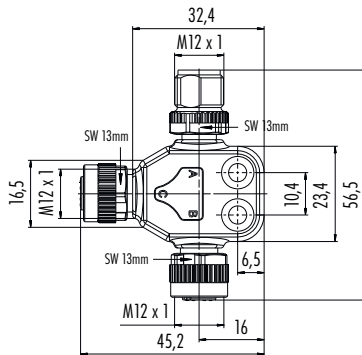

订货号 / Order Data

芯数 Contacts	订货号 Ordering-No.
4	79 5254 100 04
5	79 5255 100 05

--

技术参数 / Specifications

芯数	4	5	Number of contacts
锁紧方式	M12螺母锁紧 / screw		Connector locking system
接线方式	—		Termination
导线截面	—		Wire gauge
电缆出口直径	—		Cable outlet
防护等级	IP68		Degree of protection
插拔周期	>100插拔周期 / > 100 mating cycles		Mechanical operation
最高工作温度	+ 85 °C		Upper temperature
最低工作温度	- 25 °C		Lower temperature
额定电压	250 V		Rated voltage
额定冲击电压	2500 V		Rated impulse voltage
污染等级	3		Pollution degree
过电压等级	II		Overvoltage categorie
绝缘等级	II		Material group
额定电流 (40 °C)	4 A		Rated current (40 °C)
触点电阻	≤ 3 mΩ		Contact resistance
插针材料	针 / pin CuZn (黄铜 / brass) 孔 / socket CuSr (青铜 / bronze)		Material of contact
插针表面材料	Au (金 / gold)		Contact plating
插头主体材料	PUR		Material of contact body
外壳材料	PUR		Material of housing

两相分配器，浇铸电缆-连接器，孔x2，M8x1
Twin distributor, moulded – 2 female connectors M8 x 1

两相分配器，浇铸电缆-连接器，孔x2，M12x1
Twin distributor, moulded – 2 female connectors M12 x 1

图例 / Figure



配线图见第530页 No.9
Wiring see page 530, No. 9



配线图见第530页 No.9
Wiring see page 530, No. 9

尺寸图 / Drawing

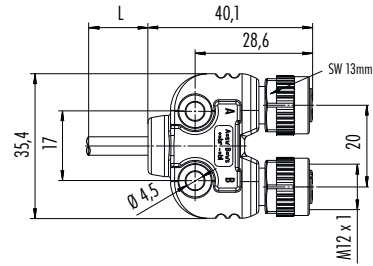
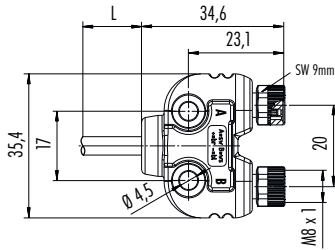

订货号 / Order Data

芯数 Contacts	电缆护套 Cable jacket	电缆长度 Cable length	订货号 ¹⁾ Ordering-No. ¹⁾
3	PUR	2 m	79 5232 33 04

芯数 Contacts	电缆护套 Cable jacket	电缆长度 Cable length	订货号 ¹⁾ Ordering-No. ¹⁾
3	PUR	2 m	79 5236 33 04

技术参数 / Specifications

芯数	3	Number of contacts
锁紧方式	M8/M12螺母锁紧/screw	Connector locking system
接线方式	压接，浇铸电缆 / crimp, moulded	Termination
导线截面	0,25 mm ² (AWG 24)	Wire gauge
电缆出口直径	—	Cable outlet
防护等级	IP68	Degree of protection
插拔周期	>100插拔周期 / > 100 mating cycles	Mechanical operation
最高工作温度	+ 85 °C	Upper temperature
最低工作温度	- 25 °C	Lower temperature
额定电压	30 V	Rated voltage
额定冲击电压	800 V	Rated impulse voltage
污染等级	3	Pollution degree
过电压等级	II	Overvoltage categorie
绝缘等级	II	Material group
额定电流 (40 °C)	4 A	Rated current (40 °C)
触点电阻	≤ 3 mΩ	Contact resistance
插针材料	针 / pin CuZn (黄铜 / brass) 孔 / socket CuSn(青铜 / bronze)	Material of contact
插针表面材料	Au(金 / gold)	Contact plating
插头主体材料	PUR	Material of contact body
外壳材料	PUR	Material of housing

两相分配器，浇铸电缆-连接器，针/孔，M12x1
Twin distributor, moulded – male/female connector M12 x 1

图例 / Figure



配线图见第530页 No.10
Wiring see page 530, No. 10

尺寸图 / Drawing

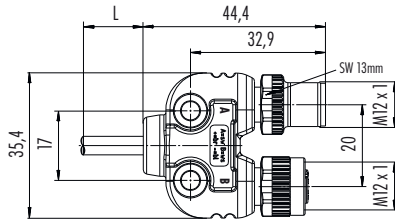

订货号 / Order Data

芯数 Contacts	电缆护套 Cable jacket	电缆长度 Cable length	订货号 ¹⁾ Ordering-No. ¹⁾
4	PUR	1 m	79 5238 10 04
		2 m	79 5238 20 04

技术参数 / Specifications

芯数	4	Number of contacts
锁紧方式	M12螺母锁紧 / screw	Connector locking system
接线方式	压接，浇铸电缆 / crimp, moulded	Termination
导线截面	0,25 mm ² (AWG 24)	Wire gauge
电缆出口直径	—	Cable outlet
防护等级	IP68	Degree of protection
插拔周期	>100插拔周期 / > 100 mating cycles	Mechanical operation
最高工作温度	+ 85 °C	Upper temperature
最低工作温度	- 25 °C	Lower temperature
额定电压	250 V	Rated voltage
额定冲击电压	2500 V	Rated impulse voltage
污染等级	3	Pollution degree
过电压等级	II	Overvoltage categorie
绝缘等级	II	Material group
额定电流 (40 °C)	4 A	Rated current (40 °C)
触点电阻	≤ 3 mΩ	Contact resistance
插针材料	针 / pin CuZn (黄铜 / brass) 孔 / socket CuSn (青铜 / bronze)	Material of contact
插针表面材料	Au (金 / gold)	Contact plating
插头主体材料	PUR	Material of contact body
外壳材料	PUR	Material of housing

¹⁾ 标准电缆长度1m/2m，其他长度可以订制。¹⁾ Standard cable length is 1 m/2 m. Other length upon request.

转换器，连接器，针，M8x1-连接器，孔，M12x1
Adapter, male connector M8 x 1 – female connector M12 x 1

转换器，连接器，孔，M8x1-连接器，针，M12x1
Adapter, female connector M8 x 1 – male connector M12 x 1

图例 / Figure



配线图见第532页 No.19,21
Wiring see page 532, No. 19, 21



配线图见第532页 No.20,22
Wiring see page 532, No. 20, 22

尺寸图 / Drawing

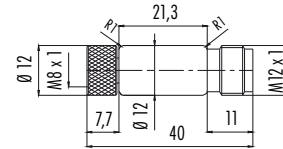
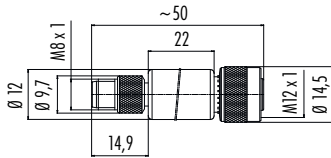

订货号 / Order Data

芯数 Contacts	订货号 Ordering-No.
3	09 5283 00 03
4	09 5284 00 04

芯数 Contacts	订货号 Ordering-No.
3	09 5280 00 03
4	09 5281 00 04

技术参数 / Specifications

芯数	3	4	Number of contacts
锁紧方式	M8/M12螺母锁紧/screw		Connector locking system
接线方式	—		Termination
导线截面	—		Wire gauge
电缆出口直径	—		Cable outlet
防护等级	IP67		Degree of protection
插拔周期	>100插拔周期/> 100 mating cycles		Mechanical operation
最高工作温度	+ 85 °C		Upper temperature
最低工作温度	- 25 °C		Lower temperature
额定电压	60 V	30 V	Rated voltage
额定冲击电压	1500 V	800 V	Rated impulse voltage
污染等级	3		Pollution degree
过电压等级	II		Overvoltage categorie
绝缘等级	II		Material group
额定电流 (40 °C)	4 A		Rated current (40 °C)
触点电阻	≤ 3 mΩ		Contact resistance
插针材料	针 /pin CuZn (黄铜/brass) 孔/socket CuSn(青铜/bronze)		Material of contact
插针表面材料	Au(金/gold)		Contact plating
插头主体材料	PUR		Material of contact body
外壳材料	热熔性材料/hot melt		Material of housing

控制柜内嵌转换器，连接器，针，M8x1-连接器，孔，M8x1，屏蔽
Adapter lead-through for control cabinet, male connector M8 x 1 – female connector M8 x 1, shielded

控制柜内嵌转换器，连接器，针，M12x1-连接器，孔，M12x1，屏蔽
Adapter lead-through for control cabinet, male connector M12 x 1 – female connector M12 x 1, shielded

图例 / Figure



配线图见第532页 No.19,21
Wiring see page 532, No. 19, 21



配线图见第532页 No.21,23,24
Wiring see page 532, No. 21, 23, 24

尺寸图 / Drawing

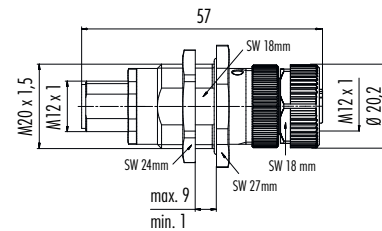
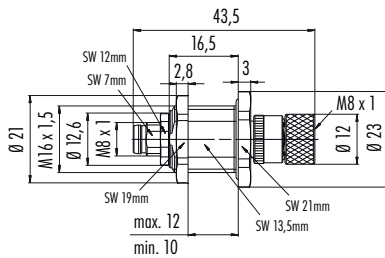

订货号 / Order Data

芯数 Contacts	订货号 Ordering-No.
3	09 5250 00 03
4	09 5251 00 04

芯数 Contacts	订货号 Ordering-No.
4	09 5240 00 04
5	09 5241 00 05
8	09 5244 00 08

技术参数 / Specifications

芯数	3	4	5	8	Number of contacts
锁紧方式	M8/M12螺母锁紧 /screw				Connector locking system
接线方式	—				Termination
导线截面	—				Wire gauge
电缆出口直径	—				Cable outlet
防护等级	IP67				Degree of protection
插拔周期	>100插拔周期 /> 100 mating cycles				Mechanical operation
最高工作温度	+ 85 °C				Upper temperature
最低工作温度	- 25 °C				Lower temperature
额定电压	250 V	60 V		30 V	Rated voltage
额定冲击电压	2500 V	1500 V		800 V	Rated impulse voltage
污染等级	3				Pollution degree
过电压等级	II				Overvoltage categorie
绝缘等级	III				Material group
额定电流 (40 °C)	4 A				Rated current (40 °C)
触点电阻	≤ 3 mΩ				Contact resistance
插针材料	针 /pin CuZn (黄铜 /brass) 孔 /socket CuSn(青铜 / bronze)				Material of contact
插针表面材料	Au(金 / gold)				Contact plating
插头主体材料	PUR				Material of contact body
外壳材料	铸锌镀镍 /zinc diecasting nickel plated, CuZn(黄铜镀镍 / brass, nickel plated)				Material of housing

765

针位图
Contact arrangements

插孔，针（接触面）
Male insert (mating side)

插孔，孔（接触面）
Female insert (mating side)

针位图见M8和M12 A-code
Contact arrangements see M8 and M12 A-coded.

电缆技术参数
Specifications of cable

电缆的技术参数见M8和M12 A-code
Specifications of cable see M8 and M12 A-coded.

安装截面
Panel cut out

控制柜穿孔
Lead-through for control cabinet with bore hole

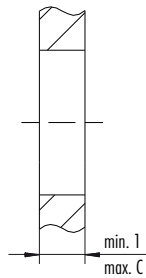
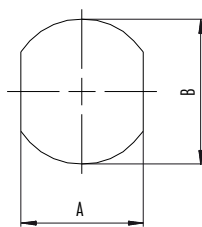

	A	B	C
M8	13,5	16,1	12
M12	18,2	20,1	9

配线图
Wirings

3 芯
3 contacts

带LED连接电缆的配线图
Wiring connecting cables with LED

Nr. 1
No. 1

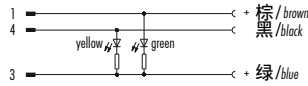

4 芯
4 contacts

带LED连接电缆的配线图
Wiring connecting cables with LED

Nr. 2
No. 2

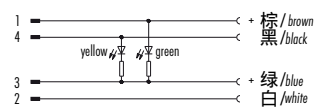

3 芯
3 contacts

M8-M8双连接电缆的配线图
Wiring duo connecting cables M8-M8

Nr. 3
No. 3

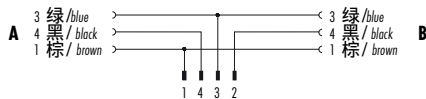

3 芯
3 contacts

M12-M8, M12-M12双电缆连线的配线图
Wiring duo connecting cables M12-M8, M12-M12

Nr. 4
No. 4

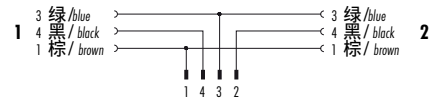

4/3 芯
4/3 contacts

双连接电缆的配线图, A-coded, 屏蔽
Wiring duo connecting cables, A-coded, shielded

Nr. 5
No. 5

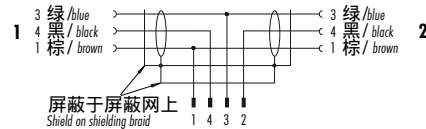

5 芯
5 contacts

双连接电缆的配线图, CAN-bus
Wiring duo connecting cables, CAN-bus

Nr. 6
No. 6

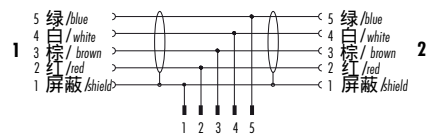

2 芯
2 contacts

双连接电缆的配线图, PROFIBUS
Wiring duo connecting cables, PROFIBUS

Nr. 7
No. 7

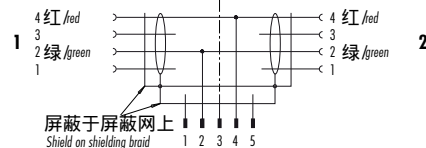

4/3 芯
4/3 contacts

带LED两相分配器的配线图
Wiring twin distributor with LED

Nr. 8
No. 8

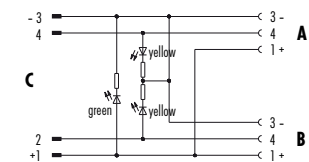

4/3 芯
4/3 contacts

带LED浇筑电缆的两相分配器的配线图
Wiring twin distributor with LED, moulded

Nr. 9
No. 9

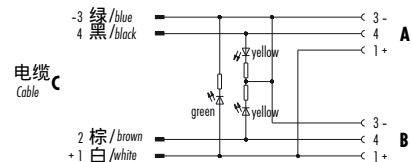

4/3 芯
4/3 contacts

带浇筑电缆两相分配器的配线图
Wiring twin distributor, moulded

Nr. 10
No. 10

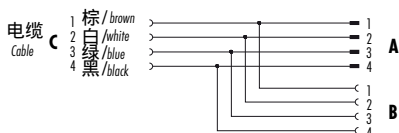

配线图
Wirings

4/3 芯
4/3 contacts

配线图，两相分配器1:1触点，针-孔/孔
Wiring twin distributor 1:1, male – female, female

Nr. 11
No. 11

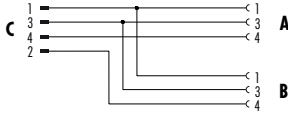

4 芯
4 contacts

配线图，两相分配器1:1触点，针-孔/孔
Wiring twin distributor 1:1, female – male, female

Nr. 12
No. 12

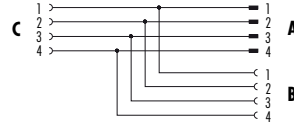

5 芯
5 contacts

配线图，两相分配器1:1触点，针-孔/孔
Wiring twin distributor 1:1, male – female, female

Nr. 13
No. 13

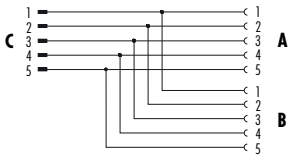

5 芯
5 contacts

配线图，两相分配器1:1触点，针-孔/孔
Wiring twin distributor 1:1, female – male, female

Nr. 14
No. 14

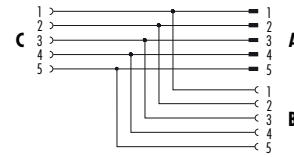

8 芯
8 contacts

配线图，两相分配器1:1触点，针-孔/孔
Wiring twin distributor 1:1, male – female, female

Nr. 15
No. 15

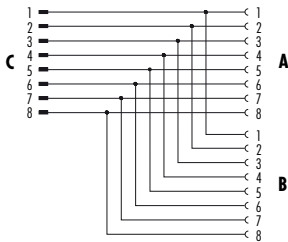

4 芯
4 contacts

配线图，两相分配器，针-孔/孔
Wiring twin distributor, male – female, female

Nr. 16
No. 16

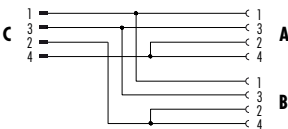

5/4 芯
5/4 contacts

配线图，两相分配器，针-孔/孔
Wiring twin distributor, male – female, female

Nr. 17
No. 17

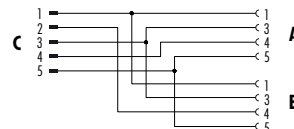

芯

5 芯
5 contacts

配线图，两相分配器，针-孔/孔
Wiring twin distributor, male – female, female

Nr. 18
No. 18

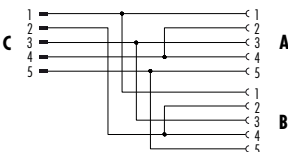

配线图
Wirings

3 芯
3 contacts

配线图，转换器，针-孔
Wiring adapter, male – female

Nr. 19
No. 19

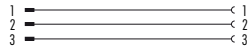

3 芯
3 contacts

配线图，转换器，针-孔
Wiring adapter, female – male

Nr. 20
No. 20

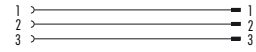

4 芯
4 contacts

配线图，转换器，针-孔
Wiring adapter, male – female

Nr. 21
No. 21

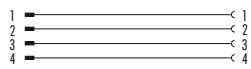

4 芯
4 contacts

配线图，转换器，针-孔
Wiring adapter, female – male

Nr. 22
No. 22

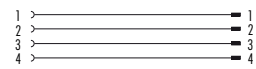

5 芯
5 contacts

配线图，转换器，针-孔
Wiring adapter, male – female

Nr. 23
No. 23

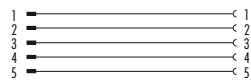

8 芯
8 contacts

配线图，转换器，针-孔
Wiring adapter, male – female

Nr. 24
No. 24

