

# Subminiatur

## 微型连接器



## 微型 M9 螺母锁紧 IP40 M9 IP40 Subminiature

### 电缆连接器

- M9 螺母锁紧
- 2 - 8 芯
- 防护等级 IP40
- 焊接 / 浸焊接线
- 电缆出口直径 11,5 mm

### 面板安装连接器

- M9 螺母锁紧
- 2 - 8 芯
- 防护等级 IP40
- 焊接 / 浸焊接线
- 电缆出口直径 11,5 mm

### Cable Connectors

- Screw termination M9
- 2 – 8 contacts
- Degree of protection IP40 <sup>1)</sup>
- Solder termination
- Diameter 11.5 mm

### Panel Mount Connectors

- Screw termination M9
- 2 – 8 contacts
- Degree of protection IP40 <sup>1)</sup>
- Solder/dip solder termination
- Diameter 11.5 mm

<sup>1)</sup> Erläuterung der Schutzarten siehe technische Informationen. / <sup>1)</sup> Explanation of protection standards see technical information.

电缆连接器，针  
Male cable connector

电缆连接器，孔  
Female cable connector

图例 / Figure



尺寸图 / Drawing

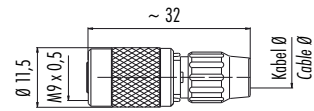
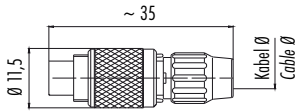

订货信息 / Order Data

芯数 Contacts	电缆直径 3–4 mm Cable outlet 3–4 mm	电缆直径 4–5 mm Cable outlet 4–5 mm
2	99 0071 100 02	99 0071 102 02
3	99 0075 100 03	99 0075 102 03
4	99 0079 100 04	99 0079 102 04
5	99 0095 100 05	99 0095 102 05
7	99 0475 100 07	99 0475 102 07
8	99 0479 100 08	99 0479 102 08

芯数 Contacts	电缆直径 3–4 mm Cable outlet 3–4 mm	电缆直径 4–5 mm Cable outlet 4–5 mm
2	99 0072 100 02	99 0072 102 02
3	99 0076 100 03	99 0076 102 03
4	99 0080 100 04	99 0080 102 04
5	99 0096 100 05	99 0096 102 05
7	99 0476 100 07	99 0476 102 07
8	99 0480 100 08	99 0480 102 08

技术参数 / Specifications

针数	2	3	4	5	7	8	Number of contacts
锁紧方式	M9 螺母锁紧 / screw						Connector locking system
接线方式	焊接 / solder						Termination
导线截面	max. 0,25 mm <sup>2</sup> (max. AWG 24)			max. 0,14 mm <sup>2</sup> (max. AWG 26)			Wire gauge
电缆出口直径	3–4 mm, 4–5 mm						Cable outlet
防护等级	IP40						Degree of protection
插拔周期	> 500 插拔周期 / > 500 mating cycles						Mechanical operation
最高工作温度	+ 85 °C						Upper temperature
最低工作温度	– 40 °C						Lower temperature
额定电压	125 V						Rated voltage
额定冲击电压	1500 V						Rated impulse voltage
污染等级	1						Pollution degree
过电压等级	II						Overvoltage categorie
绝缘等级	III						Material group
额定电流 (40 °C)	4 A		3 A		1 A		Rated current (40 °C)
触点电阻	≤ 3 mΩ						Contact resistance
插针材料	针 / pin CuZn (黄铜 / brass), 孔 / socket CuSn (青铜 / bronze)						Material of contact
插针表面材料	Au (金 / gold)						Contact plating
插头主体材料	PA						Material of contact body
外壳材料	PA						Material of housing

部件图  
Component part drawing

电缆连接器，针  
Male cable connector

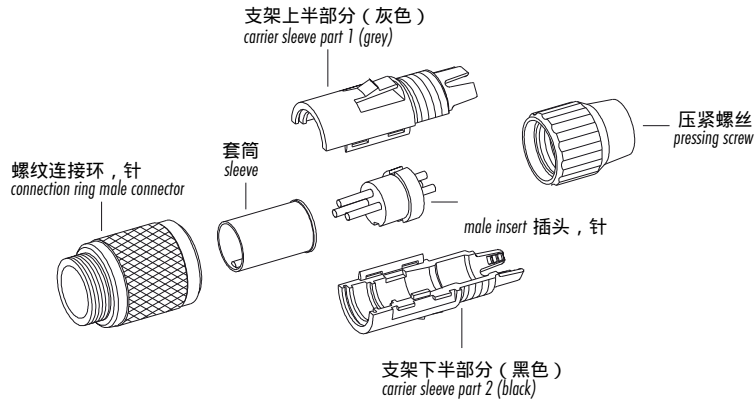

注意： 法兰连接器螺母的最大安装扭矩为: 50cNm(手动调整)  
**Attention:** max. torque of ring nut in socket connector: 50cNm (manual adjustment)

电缆连接器，孔  
Female cable connector

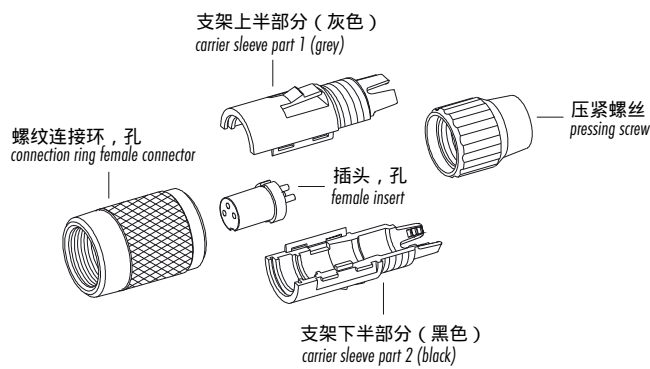

注意： 法兰连接器螺母的最大安装扭矩为: 50cNm(手动调整)  
**Attention:** max. torque of ring nut in socket connector: 50cNm (manual adjustment)

711

面板安装连接器，针，焊接  
Male panel mount connector, solder

面板安装连接器，针，浸焊  
Male panel mount connector, dip solder

图例 / Figure



尺寸图 / Drawing

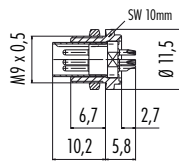

最大外壁厚度: 1,5 mm  
max. wall thickness: 1,5 mm

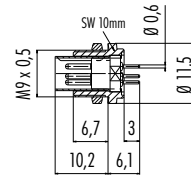

最大外壁厚度: 1,5 mm  
max. wall thickness: 1,5 mm

订货信息 / Order Data

芯数 Contacts	订货号 Ordering-No.
2	09 0073 00 02
3	09 0077 00 03
4	09 0081 00 04
5	09 0097 00 05
7	09 0477 00 07
8	09 0481 00 08

芯数 Contacts	订货号 Ordering-No.
2	09 0073 20 02
3	09 0077 20 03
4	09 0081 20 04
5	09 0097 20 05
7	09 0477 22 07
8	09 0481 22 08

技术参数 / Specifications

针数	2	3	4	5	7	8	Number of contacts
锁紧方式	M9 螺母锁紧 / screw						Connector locking system
接线方式	焊接, 浸焊 / solder, dip solder						Termination
导线截面	max. 0,25 mm <sup>2</sup> (max. AWG 24)/—			max. 0,14 mm <sup>2</sup> (max. AWG 26)/—			Wire gauge
电缆出口直径	—						Cable outlet
防护等级	IP40						Degree of protection
插拔周期	> 500 插拔周期 / > 500 mating cycles						Mechanical operation
最高工作温度	+ 85 °C						Upper temperature
最低工作温度	- 40 °C						Lower temperature
额定电压	125 V						Rated voltage
额定冲击电压	1500 V						Rated impulse voltage
污染等级	1						Pollution degree
过电压等级	II						Overvoltage categorie
绝缘等级	III						Material group
额定电流 (40 °C)	4 A		3 A		1 A		Rated current (40 °C)
触点电阻	≤ 3 mΩ						Contact resistance
插针材料	CuZn (黄铜 / brass)						Material of contact
插针表面材料	Au (金 / gold)						Contact plating
插头主体材料	PA						Material of contact body
外壳材料	CuZn (黄铜镀镍 / brass nickel plated)						Material of housing

面板安装连接器，针，带柔性印刷电路板  
Male panel mount connector with flexible PCB

图例 / Figure



尺寸图 / Drawing

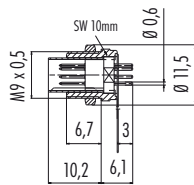

最大外壁厚度 1,5 mm  
max. wall thickness: 1,5 mm

订货信息 / Order Data

芯数 Contacts	订货号 Ordering-No.
2	—
3	—
4	—
5	—
7	09 0477 65 07
8	09 0481 65 08



技术参数 / Specifications

针数	2	3	4	5	7	8	Number of contacts
锁紧方式	M9 螺母锁紧 / screw						Connector locking system
接线方式	浸焊 / dip solder						Termination
导线截面	—						Wire gauge
电缆出口直径	—						Cable outlet
防护等级	IP40						Degree of protection
插拔周期	> 500 插拔周期 / > 500 mating cycles						Mechanical operation
最高工作温度	+ 85 °C						Upper temperature
最低工作温度	- 40 °C						Lower temperature
额定电压	125 V						Rated voltage
额定冲击电压	1500 V						Rated impulse voltage
污染等级	1						Pollution degree
过电压等级	II						Overvoltage categorie
绝缘等级	III						Material group
额定电流 (40 °C)	4 A		3 A		1 A		Rated current (40 °C)
触点电阻	≤ 3 mΩ						Contact resistance
插针材料	CuZn (黄铜 / brass)						Material of contact
插针表面材料	Au (金 / gold)						Contact plating
插头主体材料	PA						Material of contact body
外壳材料	CuZn(黄铜镀镍 / brass nickel plated)						Material of housing

面板安装连接器，孔，焊接  
Female panel mount connector, solder

面板安装连接器，孔，浸焊  
Female panel mount connector, dip solder

图例 / Figure



尺寸图 / Drawing

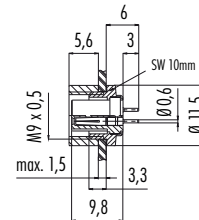
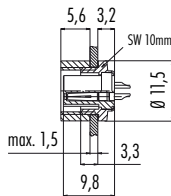

订货信息 / Order Data

芯数 Contacts	订货号 Ordering-No.
2	09 0074 00 02
3	09 0078 00 03
4	09 0082 00 04
5	09 0098 00 05
7	09 0478 00 07
8	09 0482 00 08

芯数 Contacts	订货号 Ordering-No.
2	09 0074 20 02
3	09 0078 20 03
4	09 0082 20 04
5	09 0098 20 05
7	09 0478 22 07
8	09 0482 22 08

技术参数 / Specifications

针数	2	3	4	5	7	8	Number of contacts
锁紧方式	M9螺母锁紧 / screw						Connector locking system
接线方式	焊接, 浸焊 / solder, dip solder						Termination
导线截面	max. 0,25 mm <sup>2</sup> (max. AWG 24)/—			max. 0,14 mm <sup>2</sup> (max. AWG 26)/—			Wire gauge
电缆出口直径	—						Cable outlet
防护等级	IP40						Degree of protection
插拔周期	> 500 插拔周期 / > 500 mating cycles						Mechanical operation
最高工作温度	+ 85 °C						Upper temperature
最低工作温度	- 40 °C						Lower temperature
额定电压	125 V						Rated voltage
额定冲击电压	1500 V						Rated impulse voltage
污染等级	1						Pollution degree
过电压等级	II						Overvoltage categorie
绝缘等级	III						Material group
额定电流 (40 °C)	4 A		3 A		1 A		Rated current (40 °C)
触点电阻	≤ 3 mΩ						Contact resistance
插针材料	CuSn(青铜 / bronze)						Material of contact
插针表面材料	Au(金 / gold)						Contact plating
插头主体材料	PA						Material of contact body
外壳材料	CuZn(黄铜镀镍 / brass nickel plated)						Material of housing

面板安装连接器，孔，弯角，浸焊  
Female angled panel mount connector, dip solder

面板安装连接器，孔，带柔性印刷电路板  
Female panel mount connector with flexible PCB

图例 / Figure



开孔图解见87页  
Drilling schemes see page 87

尺寸图 / Drawing



订货信息 / Order Data

芯数 Contacts	订货号 Ordering-No.
2	—
3	—
4	09 0082 32 04
5	09 0098 72 05
7	—
8	—

芯数 Contacts	订货号 Ordering-No.
2	—
3	—
4	—
5	—
7	09 0478 65 07
8	09 0482 65 08

技术参数 / Specifications

针数	2	3	4	5	7	8	Number of contacts
锁紧方式	M9 螺母锁紧 / screw						Connector locking system
接线方式	焊接 / 浸焊 / solder/dip solder						Termination
导线截面	max. 0,25 mm <sup>2</sup> (max. AWG 24)/—			max. 0,14 mm <sup>2</sup> (max. AWG 26)/—			Wire gauge
电缆出口直径	—						Cable outlet
防护等级	IP40						Degree of protection
插拔周期	> 500 插拔周期 / > 500 mating cycles						Mechanical operation
最高工作温度	+ 85 °C						Upper temperature
最低工作温度	- 40 °C						Lower temperature
额定电压	125 V						Rated voltage
额定冲击电压	1500 V						Rated impulse voltage
污染等级	1						Pollution degree
过电压等级	II						Overvoltage categorie
绝缘等级	III						Material group
额定电流 (40 °C)	4 A		3 A		1 A		Rated current (40 °C)
触点电阻	≤ 3 mΩ						Contact resistance
插针材料	CuSn (青铜 / bronze)						Material of contact
插针表面材料	Au (金 / gold)						Contact plating
插头主体材料	PA						Material of contact body
外壳材料	CuZn (黄铜镀镍 / brass nickel plated)						Material of housing



尺寸图  
Drawings

09 0082 32 04

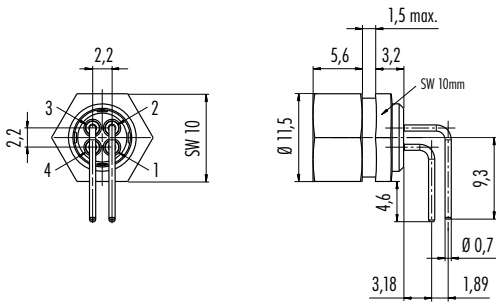

09 0098 72 05

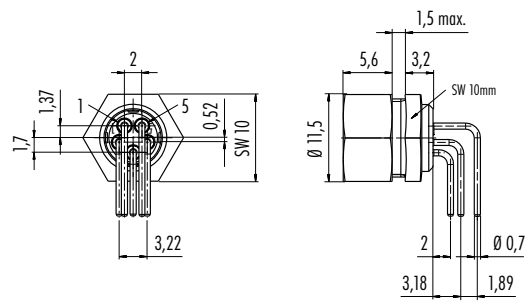

09 0477 65 07

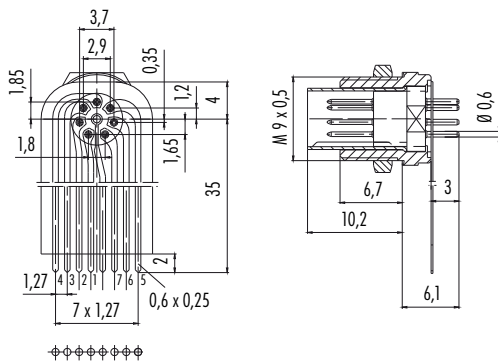

09 0481 65 08

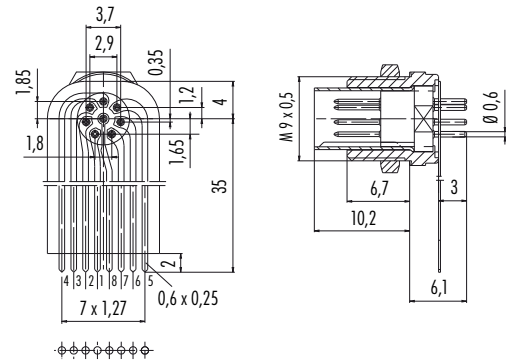

09 0478 65 07

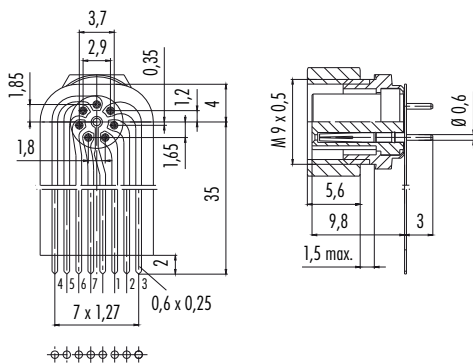

09 0482 65 08

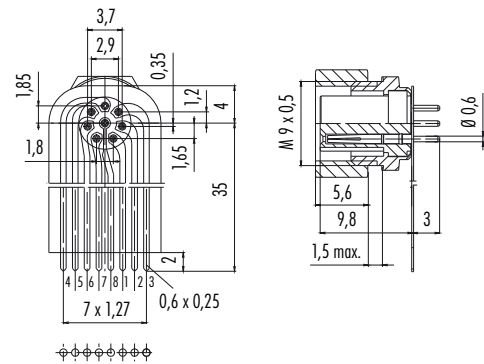

针位图  
Contact arrangements

插孔，针（接触面）  
Male insert (mating side)

插孔，孔（接触面）  
Female insert (mating side)

2 芯  
2 contacts

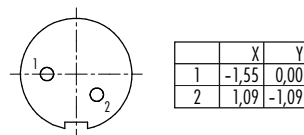
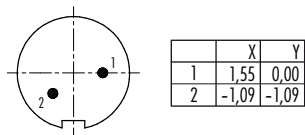

3 芯  
3 contacts

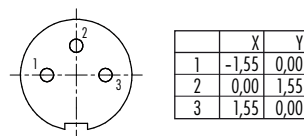
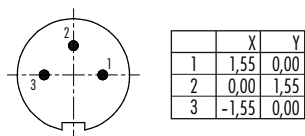

4 芯  
4 contacts

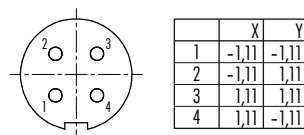
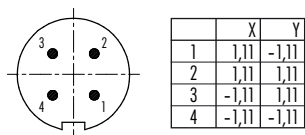

5 芯  
5 contacts

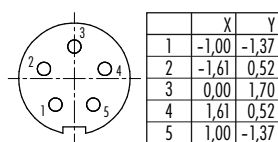
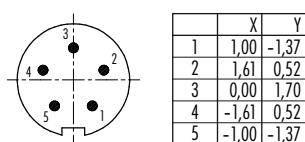

弯角系列  
Angled version

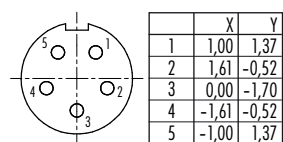

7 芯  
7 contacts

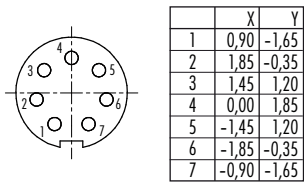
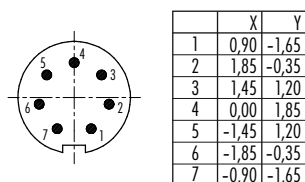

8 芯  
8 contacts

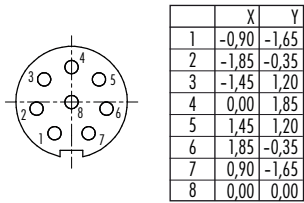
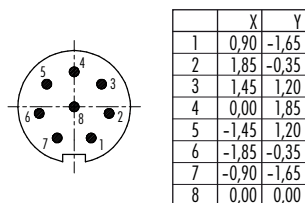

安装截面  
Panel cut out

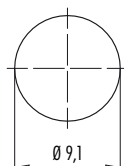

开孔图解，公头 (PCB)  
Drilling schemes male insert (PCB)

开孔图解，母头 (PCB)  
Drilling schemes female insert (PCB)

2 芯  
2 contacts

—

3 芯  
3 contacts

—

4 芯  
4 contacts

—

弯角系列  
Angled version

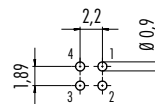

5 芯  
5 contacts

—

弯角系列  
Angled version

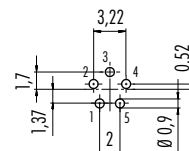

7 芯  
7 contacts

—

8 芯  
8 contacts

—

