

Power



RD24 Power

RD24 Power

Kabelsteckverbinder

- Schraubverriegelung RD24
- 4- (3+PE) – 7- (6+PE) polig
- Schutzart IP67 ¹⁾
- Löt-/Crimp-/Schraubklemmanschluss
- Am Kabel angespritzte Ausführungen
- Durchmesser 29 mm
- VDE-, SEV- und UL-Zulassung

Flanschsteckverbinder

- Schraubverriegelung RD24
- 4- (3+PE) – 7- (6+PE) polig
- Schutzart IP67 ¹⁾
- Löt-/Crimp-/Schraubklemmanschluss
- Flansch 38 x 29 mm
- VDE-, SEV- und UL-Zulassung

Cable Connectors

- Screw termination RD24
- 4 (3+PE) – 7 (6+PE) contacts
- Degree of protection IP67 ¹⁾
- Solder/crimp/screw clamp termination
- Moulded versions
- Diameter 29 mm
- VDE-, SEV- and UL-approval

Panel Mount Connectors

- Screw termination RD24
- 4 (3+PE) – 7 (6+PE) contacts
- Degree of protection IP67 ¹⁾
- Solder/crimp/screw clamp termination
- Panel mount connectors 38 x 29 mm
- VDE-, SEV- and UL-approval

¹⁾ Erläuterung der Schutzarten siehe technische Informationen. / ¹⁾ Explanation of protection standards see technical information.

电缆连接器，针，PG9
Male cable connector, PG 9

电缆连接器，针，PG9
Male cable connector, PG 9

图例 / Figure



压接接线方式请见第323页
Crimp contacts see page 323

压接接线方式请见第323页
Crimp contacts see page 323

尺寸图 / Drawing

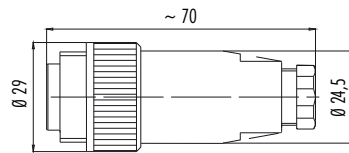
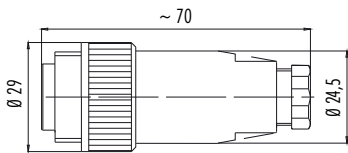

订货信息 / Order Data

芯数 Contacts	接线方式 Termination	电缆出口直径 Cable outlet	订货号 Ordering-No.
3+PE	螺钉接线 screw clamp	6-9,5 mm	99 0209 00 04
6+PE	焊接 solder	6-9,5 mm	99 0213 00 07
6+PE	螺钉接线 screw clamp	6-8 mm	99 0217 00 07
6+PE	压接 crimp	6-8 mm	99 0201 00 07

芯数 Contacts	接线方式 Termination	电缆出口直径 Cable outlet	订货号 Ordering-No.
3+PE	螺钉接线 screw clamp	6-9,5 mm	99 4221 00 04
6+PE	焊接 solder	6-9,5 mm	99 4225 00 07
6+PE	螺钉接线 screw clamp	6-8 mm	99 4217 00 07
6+PE	压接 crimp	6-8 mm	99 4201 00 07

技术参数 / Specifications

芯数	3+PE	6+PE	6+PE	6+PE	Number of contacts
锁紧方式	RD24螺母锁紧 / screw				Connector locking system
接线方式	螺钉接线 / screw clamp	焊接 / solder	螺钉接线 / screw clamp	压接 / crimp	Termination
导线截面	0,5 mm ² - 2,5 mm ² (AWG 20 - AWG 14)	max. 0,75 mm ² (max. AWG 20)	0,34 mm ² - 1,5 mm ² (AWG 22 - AWG 16)	0,14 mm ² - 1,5 mm ² (AWG 26 - AWG 16)	Wire gauge
电缆出口直径	6-8 mm, 6-9,5 mm				Cable outlet
防护等级	IP67 ¹⁾				Degree of protection
插拔周期	>500插拔周期 / > 500 mating cycles				Mechanical operation
最高工作温度	+ 100 °C				Upper temperature
最低工作温度	- 40 °C				Lower temperature
额定电压	400 V (600 V UL)	250 V		4000 V	Rated voltage
额定冲击电压	6000 V	4000 V			Rated impulse voltage
污染等级	3				Pollution degree
过电压等级	III				Overvoltage categorie
绝缘等级	III				Material group
额定电流 (40 °C)	16 A (12 A UL)	10 A (8 A UL)			Rated current (40 °C)
触点电阻	≤ 5 mΩ				Contact resistance
插针材料	CuZn (黄铜 / brass)			—	Material of contact
插针表面材料	Ag (银 / silver)				Contact plating
插头主体材料	PBT				Material of contact body
外壳材料	PBT				Material of housing

电缆连接器，针，PG11
Male cable connector, PG 11

电缆连接器，针，PG11
Male cable connector, PG 11

图例 / Figure



压接接线方式请见第323页
Crimp contacts see page 323

压接接线方式请见第323页
Crimp contacts see page 323

尺寸图 / Drawing

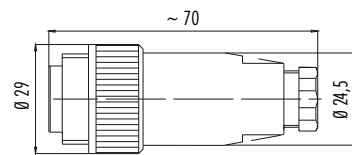
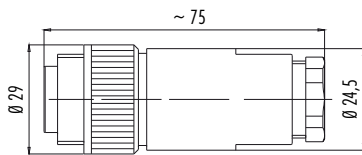

订货信息 / Order Data

芯数 Contacts	接线方式 Termination	电缆出口直径 Cable outlet	订货号 Ordering-No.
3+PE	螺钉接线 screw clamp	8-10 mm	99 0209 110 04
6+PE	焊接 solder	8-10 mm	99 0213 110 07
6+PE	螺钉接线 screw clamp	8-10 mm	99 0217 110 07
6+PE	压接 crimp	8-10 mm	99 0201 110 07

芯数 Contacts	接线方式 Termination	电缆出口直径 Cable outlet	订货号 Ordering-No.
3+PE	螺钉接线 screw clamp	8-10 mm	99 4221 110 04
6+PE	焊接 solder	8-10 mm	99 4225 110 07
6+PE	螺钉接线 screw clamp	8-10 mm	99 4217 110 07
6+PE	压接 crimp	8-10 mm	99 4201 110 07

技术参数 / Specifications

芯数	3+PE	6+PE	6+PE	6+PE	Number of contacts
锁紧方式	RD24螺母锁紧 / screw				Connector locking system
接线方式	螺钉接线 / screw clamp	焊接 / solder	螺钉接线 / screw clamp	压接 / crimp	Termination
导线截面	0,5 mm ² - 2,5 mm ² (AWG 20 - AWG 14)	max. 0,75 mm ² (max. AWG 20)	0,34 mm ² - 1,5 mm ² (AWG 22 - AWG 16)	0,14 mm ² - 1,5 mm ² (AWG 26 - AWG 16)	Wire gauge
电缆出口直径	8-10 mm				Cable outlet
防护等级	IP67				Degree of protection
插拔周期	>500插拔周期 / > 500 mating cycles				Mechanical operation
最高工作温度	+ 100 °C				Upper temperature
最低工作温度	- 40 °C				Lower temperature
额定电压	400 V (600 V UL)	250 V		4000 V	Rated voltage
额定冲击电压	6000 V	4000 V			Rated impulse voltage
污染等级	3				Pollution degree
过电压等级	III				Overvoltage categorie
绝缘等级	III				Material group
额定电流 (40 °C)	16 A (12 A UL)	10 A (8 A UL)			Rated current (40 °C)
触点电阻	≤ 5 mΩ				Contact resistance
插针材料	CuZn (黄铜 / brass)			—	Material of contact
插针表面材料	Ag (银 / silver)				Contact plating
插头主体材料	PBT				Material of contact body
外壳材料	PBT				Material of housing

电缆连接器，针，PG13.5
Male cable connector, PG 13,5

电缆连接器，针，PG13.5
Male cable connector, PG 13,5

图例 / Figure



压接接线方式请见第323页
Crimp contacts see page 323

压接接线方式请见第323页
Crimp contacts see page 323

尺寸图 / Drawing

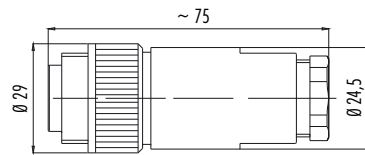
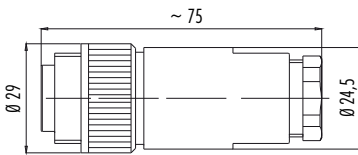

订货信息 / Order Data

芯数 Contacts	接线方式 Termination	电缆出口直径 Cable outlet	订货号 Ordering-No.
3+PE	螺钉接线 screw clamp	10–12 mm	99 0209 15 04
6+PE	焊接 solder	10–12 mm	99 0213 15 07
6+PE	螺钉接线 screw clamp	10–12 mm	99 0217 15 07
6+PE	压接 crimp	10–12 mm	99 0201 15 07

芯数 Contacts	接线方式 Termination	电缆出口直径 Cable outlet	订货号 Ordering-No.
3+PE	螺钉接线 screw clamp	10–12 mm	99 4221 14 04
6+PE	焊接 solder	10–12 mm	99 4225 14 07
6+PE	螺钉接线 screw clamp	10–12 mm	99 4217 14 07
6+PE	压接 crimp	10–12 mm	99 4201 14 07

技术参数 / Specifications

芯数	3+PE	6+PE	6+PE	6+PE	Number of contacts
锁紧方式	RD24螺母锁紧 / screw				Connector locking system
接线方式	螺钉接线 / screw clamp	焊接 / solder	螺钉接线 / screw clamp	压接 / crimp	Termination
导线截面	0,5 mm ² –2,5 mm ² (AWG 20–AWG 14)	max. 0,75 mm ² (max. AWG 20)	0,34 mm ² –1,5 mm ² (AWG 22–AWG 16)	0,14 mm ² –1,5 mm ² (AWG 26–AWG 16)	Wire gauge
电缆出口直径	10–12 mm				Cable outlet
防护等级	IP67				Degree of protection
插拔周期	>500插拔周期 / > 500 mating cycles				Mechanical operation
最高工作温度	+ 100 °C				Upper temperature
最低工作温度	– 40 °C				Lower temperature
额定电压	400 V (600 V UL)	250 V		4000 V	Rated voltage
额定冲击电压	6000 V	4000 V			Rated impulse voltage
污染等级	3				Pollution degree
过电压等级	III				Overvoltage categorie
绝缘等级	III				Material group
额定电流 (40 °C)	16 A (12 A UL)	10 A (8 A UL)			Rated current (40 °C)
触点电阻	≤ 5 mΩ				Contact resistance
插针材料	CuZn(黄铜 / brass)			—	Material of contact
插针表面材料	Ag(银 / silver)				Contact plating
插头主体材料	PBT				Material of contact body
外壳材料	PBT				Material of housing

电缆连接器，针，PG16
Male cable connector, PG 16

电缆连接器，针，PG16
Male cable connector, PG 16

图例 / Figure



压接接线方式请见第323页
Crimp contacts see page 323

压接接线方式请见第323页
Crimp contacts see page 323

尺寸图 / Drawing

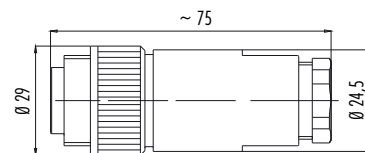
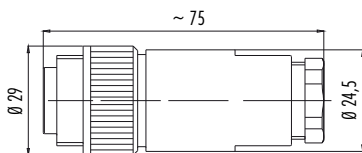

订货信息 / Order Data

芯数 Contacts	接线方式 Termination	电缆出口直径 Cable outlet	订货号 Ordering-No.
3+PE	螺钉接线 screw clamp	12–14 mm	99 0209 160 04
6+PE	焊接 solder	12–14 mm	99 0213 160 07
6+PE	螺钉接线 screw clamp	12–14 mm	99 0217 160 07
6+PE	压接 crimp	12–14 mm	99 0201 160 07

芯数 Contacts	接线方式 Termination	电缆出口直径 Cable outlet	订货号 Ordering-No.
3+PE	螺钉接线 screw clamp	12–14 mm	99 4221 160 04
6+PE	焊接 solder	12–14 mm	99 4225 160 07
6+PE	螺钉接线 screw clamp	12–14 mm	99 4217 160 07
6+PE	压接 crimp	12–14 mm	99 4201 160 07

技术参数 / Specifications

芯数	3+PE	6+PE	6+PE	6+PE	Number of contacts
锁紧方式	RD24螺母锁紧 / screw				Connector locking system
接线方式	螺钉接线 / screw clamp	焊接 / solder	螺钉接线 / screw clamp	压接 / crimp	Termination
导线截面	0,5 mm ² –2,5 mm ² (AWG 20–AWG 14)	max. 0,75 mm ² (max. AWG 20)	0,34 mm ² –1,5 mm ² (AWG 22–AWG 16)	0,14 mm ² –1,5 mm ² (AWG 26–AWG 16)	Wire gauge
电缆出口直径	12–14 mm				Cable outlet
防护等级	IP67				Degree of protection
插拔周期	>500插拔周期 / > 500 mating cycles				Mechanical operation
最高工作温度	+ 100 °C				Upper temperature
最低工作温度	– 40 °C				Lower temperature
额定电压	400 V (600 V UL)			250 V	Rated voltage
额定冲击电压	6000 V			4000 V	Rated impulse voltage
污染等级	3				Pollution degree
过电压等级	III				Overvoltage categorie
绝缘等级	III				Material group
额定电流 (40 °C)	16 A (12 A UL)			10 A (8 A UL)	Rated current (40 °C)
触点电阻	≤ 5 mΩ				Contact resistance
插针材料	CuZn(黄铜 / brass)			—	Material of contact
插针表面材料	Ag(银 / silver)				Contact plating
插头主体材料	PBT				Material of contact body
外壳材料	PBT				Material of housing

弯角电缆连接器，针，PG9
Male angled connector, PG 9

弯角电缆连接器，针，PG9
Male angled connector, PG 9

图例 / Figure



压接接线方式请见第323页
Crimp contacts see page 323

压接接线方式请见第323页
Crimp contacts see page 323

尺寸图 / Drawing

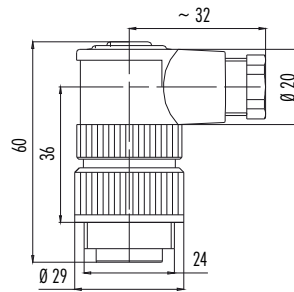
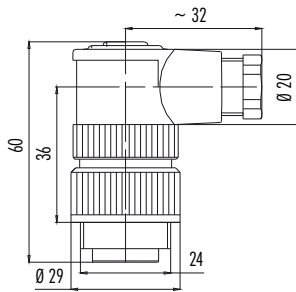

订货信息 / Order Data

芯数 Contacts	接线方式 Termination	电缆出口直径 Cable outlet	订货号 Ordering-No.
3+PE	螺钉接线 screw clamp	6-8 mm	99 0209 70 04
6+PE	焊接 solder	6-8 mm	99 0213 70 07
6+PE	螺钉接线 screw clamp	6-8 mm	99 0217 70 07
6+PE	压接 crimp	6-8 mm	99 0201 70 07

芯数 Contacts	接线方式 Termination	电缆出口直径 Cable outlet	订货号 Ordering-No.
3+PE	螺钉接线 screw clamp	6-8 mm	99 4221 70 04
6+PE	焊接 solder	6-8 mm	99 4225 70 07
6+PE	螺钉接线 screw clamp	6-8 mm	99 4217 70 07
6+PE	压接 crimp	6-8 mm	99 4201 70 07

技术参数 / Specifications

芯数	3+PE	6+PE	6+PE	6+PE	Number of contacts
锁紧方式	RD24螺母锁紧 / screw				Connector locking system
接线方式	螺钉接线 / screw clamp	焊接 / solder	螺钉接线 / screw clamp	压接 / crimp	Termination
导线截面	0,5 mm ² - 2,5 mm ² (AWG 20 - AWG 14)	max. 0,75 mm ² (max. AWG 20)	0,34 mm ² - 1,5 mm ² (AWG 22 - AWG 16)	0,14 mm ² - 1,5 mm ² (AWG 26 - AWG 16)	Wire gauge
电缆出口直径	6-8 mm				Cable outlet
防护等级	IP67 ¹⁾				Degree of protection
插拔周期	>500插拔周期 / > 500 mating cycles				Mechanical operation
最高工作温度	+ 100 °C				Upper temperature
最低工作温度	- 40 °C				Lower temperature
额定电压	400 V (600 V UL)	250 V			Rated voltage
额定冲击电压	6000 V	4000 V			Rated impulse voltage
污染等级	3				Pollution degree
过电压等级	III				Overvoltage categorie
绝缘等级	III				Material group
额定电流 (40 °C)	16 A (12 A UL)	10 A (8 A UL)			Rated current (40 °C)
触点电阻	≤ 5 mΩ				Contact resistance
插针材料	CuZn (黄铜 / brass)			—	Material of contact
插针表面材料	Ag (银 / silver)				Contact plating
插头主体材料	PBT				Material of contact body
外壳材料	PBT				Material of housing

弯角电缆连接器，针，PG11
Male angled connector, PG 11

弯角电缆连接器，针，PG11
Male angled connector, PG 11

图例 / Figure



压接接线方式请见第323页
Crimp contacts see page 323

压接接线方式请见第323页
Crimp contacts see page 323

尺寸图 / Drawing

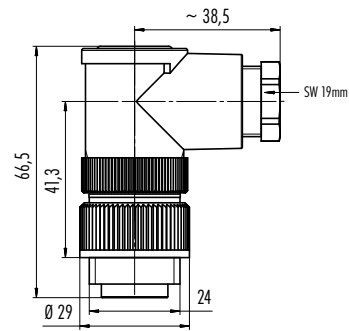
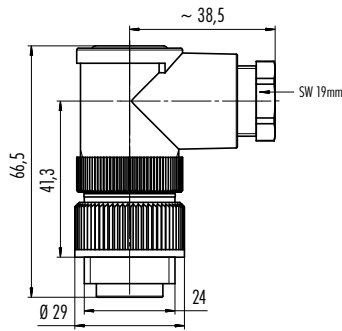

订货信息 / Order Data

芯数 Contacts	接线方式 Termination	电缆出口直径 Cable outlet	订货号 Ordering-No.
3+PE	螺钉接线 screw clamp	8-10 mm	99 0209 210 04
6+PE	焊接 solder	8-10 mm	99 0213 210 07
6+PE	螺钉接线 screw clamp	8-10 mm	99 0217 210 07
6+PE	压接 crimp	8-10 mm	99 0201 210 07

芯数 Contacts	接线方式 Termination	电缆出口直径 Cable outlet	订货号 Ordering-No.
3+PE	螺钉接线 screw clamp	8-10 mm	99 4221 210 04
6+PE	焊接 solder	8-10 mm	99 4225 210 07
6+PE	螺钉接线 screw clamp	8-10 mm	99 4217 210 07
6+PE	压接 crimp	8-10 mm	99 4201 210 07

技术参数 / Specifications

芯数	3+PE	6+PE	6+PE	6+PE	Number of contacts
锁紧方式	RD24螺母锁紧 / screw				Connector locking system
接线方式	螺钉接线 / screw clamp	焊接 / solder	螺钉接线 / screw clamp	压接 / crimp	Termination
导线截面	0,5 mm ² - 2,5 mm ² (AWG 20 - AWG 14)	max. 0,75 mm ² (max. AWG 20)	0,34 mm ² - 1,5 mm ² (AWG 22 - AWG 16)	0,14 mm ² - 1,5 mm ² (AWG 26 - AWG 16)	Wire gauge
电缆出口直径	8-10 mm				Cable outlet
防护等级	IP67				Degree of protection
插拔周期	>500插拔周期 / > 500 mating cycles				Mechanical operation
最高工作温度	+ 100 °C				Upper temperature
最低工作温度	- 40 °C				Lower temperature
额定电压	400 V (600 V UL)	250 V		4000 V	Rated voltage
额定冲击电压	6000 V	4000 V			Rated impulse voltage
污染等级	3				Pollution degree
过电压等级	III				Overvoltage categorie
绝缘等级	III				Material group
额定电流 (40 °C)	16 A (12 A UL)	10 A (8 A UL)			Rated current (40 °C)
触点电阻	≤ 5 mΩ				Contact resistance
插针材料	CuZn(黄铜 / brass)			—	Material of contact
插针表面材料	Ag(银 / silver)				Contact plating
插头主体材料	PBT				Material of contact body
外壳材料	PBT				Material of housing

弯角电缆连接器，针，PG13.5
Male angled connector, PG 13,5

弯角电缆连接器，针，PG13.5
Male angled connector, PG 13,5

图例 / Figure



压接接线方式请见第323页
Crimp contacts see page 323

压接接线方式请见第323页
Crimp contacts see page 323

尺寸图 / Drawing

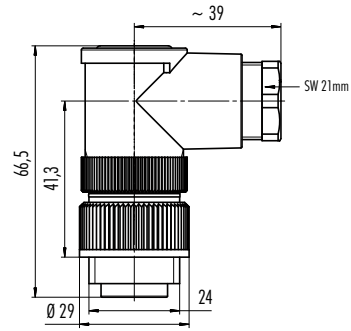
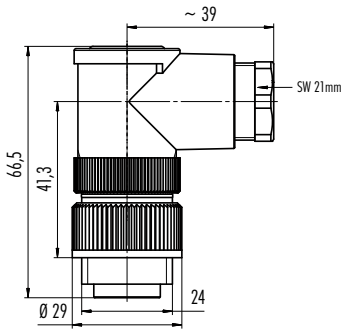

订货信息 / Order Data

芯数 Contacts	接线方式 Termination	电缆出口直径 Cable outlet	订货号 Ordering-No.
3+PE	螺钉接线 screw clamp	10–12 mm	99 0209 215 04
6+PE	焊接 solder	10–12 mm	99 0213 215 07
6+PE	螺钉接线 screw clamp	10–12 mm	99 0217 215 07
6+PE	压接 crimp	10–12 mm	99 0201 215 07

芯数 Contacts	接线方式 Termination	电缆出口直径 Cable outlet	订货号 Ordering-No.
3+PE	螺钉接线 screw clamp	10–12 mm	99 4221 215 04
6+PE	焊接 solder	10–12 mm	99 4225 215 07
6+PE	螺钉接线 screw clamp	10–12 mm	99 4217 215 07
6+PE	压接 crimp	10–12 mm	99 4201 215 07

技术参数 / Specifications

芯数	3+PE	6+PE	6+PE	6+PE	Number of contacts
锁紧方式	RD24螺母锁紧 / screw				Connector locking system
接线方式	螺钉接线 / screw clamp	焊接 / solder	螺钉接线 / screw clamp	压接 / crimp	Termination
导线截面	0,5 mm ² –2,5 mm ² (AWG 20–AWG 14)	max. 0,75 mm ² (max. AWG 20)	0,34 mm ² –1,5 mm ² (AWG 22–AWG 16)	0,14 mm ² –1,5 mm ² (AWG 26–AWG 16)	Wire gauge
电缆出口直径	10–12 mm				Cable outlet
防护等级	IP67				Degree of protection
插拔周期	>500插拔周期 / > 500 mating cycles				Mechanical operation
最高工作温度	+ 100 °C				Upper temperature
最低工作温度	– 40 °C				Lower temperature
额定电压	400 V (600 V UL)	250 V		4000 V	Rated voltage
额定冲击电压	6000 V	4000 V			Rated impulse voltage
污染等级	3				Pollution degree
过电压等级	III				Overvoltage categorie
绝缘等级	III				Material group
额定电流 (40 °C)	16 A (12 A UL)	10 A (8 A UL)			Rated current (40 °C)
触点电阻	≤ 5 mΩ				Contact resistance
插针材料	CuZn (黄铜 / brass)			—	Material of contact
插针表面材料	Ag (银 / silver)				Contact plating
插头主体材料	PBT				Material of contact body
外壳材料	PBT				Material of housing



12/P-01
Ser.-Nr.93092548

S.693
12A/600V
16A/400V

电缆连接器，孔，PG9
Female cable connector, PG 9

电缆连接器，孔，PG9
Female cable connector, PG 9

图例 / Figure



压接接线方式请见第323页
Crimp contacts see page 323

压接接线方式请见第323页
Crimp contacts see page 323

尺寸图 / Drawing

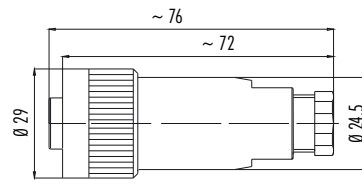
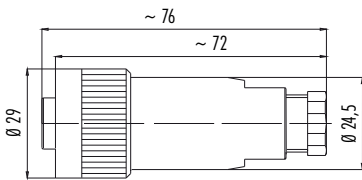

订货信息 / Order Data

芯数 Contacts	接线方式 Termination	电缆出口直径 Cable outlet	订货号 Ordering-No.
3+PE	螺钉接线 screw clamp	6-9,5 mm	99 0210 00 04
6+PE	焊接 solder	6-9,5 mm	99 0214 00 07
6+PE	螺钉接线 screw clamp	6-8 mm	99 0218 00 07
6+PE	压接 crimp	6-8 mm	99 0202 00 07

芯数 Contacts	接线方式 Termination	电缆出口直径 Cable outlet	订货号 Ordering-No.
3+PE	螺钉接线 screw clamp	6-9,5 mm	99 4222 00 04
6+PE	焊接 solder	6-9,5 mm	99 4226 00 07
6+PE	螺钉接线 screw clamp	6-8 mm	99 4218 00 07
6+PE	压接 crimp	6-8 mm	99 4202 00 07

技术参数 / Specifications

芯数	3+PE	6+PE	6+PE	6+PE	Number of contacts
锁紧方式	RD24螺母锁紧 / screw				Connector locking system
接线方式	螺钉接线 / screw clamp	焊接 / solder	螺钉接线 / screw clamp	压接 / crimp	Termination
导线截面	0,5 mm ² - 2,5 mm ² (AWG 20 - AWG 14)	max. 0,75 mm ² (max. AWG 20)	0,34 mm ² - 1,5 mm ² (AWG 22 - AWG 16)	0,14 mm ² - 1,5 mm ² (AWG 26 - AWG 16)	Wire gauge
电缆出口直径	6-8 mm, 6-9,5 mm				Cable outlet
防护等级	IP67 ¹⁾				Degree of protection
插拔周期	>500插拔周期 / > 500 mating cycles				Mechanical operation
最高工作温度	+ 100 °C				Upper temperature
最低工作温度	- 40 °C				Lower temperature
额定电压	400 V (600 V UL)	250 V			Rated voltage
额定冲击电压	6000 V	4000 V			Rated impulse voltage
污染等级	3				Pollution degree
过电压等级	III				Overvoltage categorie
绝缘等级	III				Material group
额定电流 (40 °C)	16 A (12 A UL)	10 A (8 A UL)			Rated current (40 °C)
触点电阻	≤ 5 mΩ				Contact resistance
插针材料	CuSn (青铜 / bronze)			—	Material of contact
插针表面材料	Ag (银 / silver)				Contact plating
插头主体材料	PBT				Material of contact body
外壳材料	PBT				Material of housing

电缆连接器，孔，PG11
Female cable connector, PG 11

电缆连接器，孔，PG11
Female cable connector, PG 11

图例 / Figure



压接接线方式请见第323页
Crimp contacts see page 323

压接接线方式请见第323页
Crimp contacts see page 323

尺寸图 / Drawing

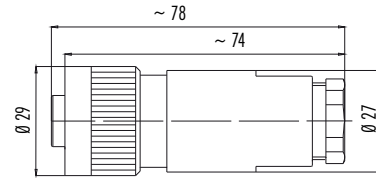
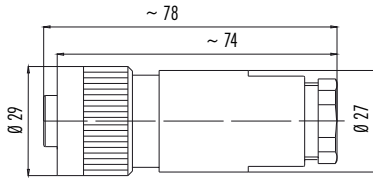

订货信息 / Order Data

芯数 Contacts	接线方式 Termination	电缆出口直径 Cable outlet	订货号 Ordering-No.
3+PE	螺钉接线 screw clamp	8-10 mm	99 0210 110 04
6+PE	焊接 solder	8-10 mm	99 0214 110 07
6+PE	螺钉接线 screw clamp	8-10 mm	99 0218 110 07
6+PE	压接 crimp	8-10 mm	99 0202 110 07

芯数 Contacts	接线方式 Termination	电缆出口直径 Cable outlet	订货号 Ordering-No.
3+PE	螺钉接线 screw clamp	8-10 mm	99 4222 110 04
6+PE	焊接 solder	8-10 mm	99 4226 110 07
6+PE	螺钉接线 screw clamp	8-10 mm	99 4218 110 07
6+PE	压接 crimp	8-10 mm	99 4202 110 07

技术参数 / Specifications

芯数	3+PE	6+PE	6+PE	6+PE	Number of contacts
锁紧方式	RD24螺母锁紧 / screw				Connector locking system
接线方式	螺钉接线 / screw clamp	焊接 / solder	螺钉接线 / screw clamp	压接 / crimp	Termination
导线截面	0,5 mm ² - 2,5 mm ² (AWG 20 - AWG 14)	max. 0,75 mm ² (max. AWG 20)	0,34 mm ² - 1,5 mm ² (AWG 22 - AWG 16)	0,14 mm ² - 1,5 mm ² (AWG 26 - AWG 16)	Wire gauge
电缆出口直径	8-10 mm				Cable outlet
防护等级	IP67				Degree of protection
插拔周期	>500插拔周期 / > 500 mating cycles				Mechanical operation
最高工作温度	+ 100 °C				Upper temperature
最低工作温度	- 40 °C				Lower temperature
额定电压	400 V (600 V UL)			250 V	Rated voltage
额定冲击电压	6000 V			4000 V	Rated impulse voltage
污染等级	3				Pollution degree
过电压等级	III				Overvoltage categorie
绝缘等级	III				Material group
额定电流 (40 °C)	16 A (12 A UL)			10 A (8 A UL)	Rated current (40 °C)
触点电阻	≤ 5 mΩ				Contact resistance
插针材料	CuSn (青铜 / bronze)			—	Material of contact
插针表面材料	Ag (银 / silver)				Contact plating
插头主体材料	PBT				Material of contact body
外壳材料	PBT				Material of housing

电缆连接器，孔，PG13.5
Female cable connector, PG 13,5

电缆连接器，孔，PG13.5
Female cable connector, PG 13,5

图例 / Figure



压接接线方式请见第323页
Crimp contacts see page 323

压接接线方式请见第323页
Crimp contacts see page 323

尺寸图 / Drawing

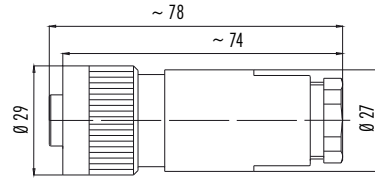
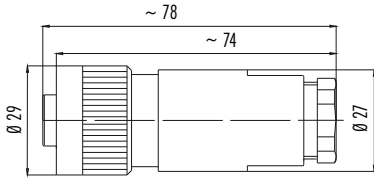

订货信息 / Order Data

芯数 Contacts	接线方式 Termination	电缆出口直径 Cable outlet	订货号 Ordering-No.
3+PE	螺钉接线 screw clamp	10–12 mm	99 0210 15 04
6+PE	焊接 solder	10–12 mm	99 0214 15 07
6+PE	螺钉接线 screw clamp	10–12 mm	99 0218 15 07
6+PE	压接 crimp	10–12 mm	99 0202 15 07

芯数 Contacts	接线方式 Termination	电缆出口直径 Cable outlet	订货号 Ordering-No.
3+PE	螺钉接线 screw clamp	10–12 mm	99 4222 14 04
6+PE	焊接 solder	10–12 mm	99 4226 14 07
6+PE	螺钉接线 screw clamp	10–12 mm	99 4218 14 07
6+PE	压接 crimp	10–12 mm	99 4202 14 07

技术参数 / Specifications

芯数	3+PE	6+PE	6+PE	6+PE	Number of contacts
锁紧方式	RD24螺母锁紧 / screw				Connector locking system
接线方式	螺钉接线 / screw clamp	焊接 / solder	螺钉接线 / screw clamp	压接 / crimp	Termination
导线截面	0,5 mm ² –2,5 mm ² (AWG 20–AWG 14)	max. 0,75 mm ² (max. AWG 20)	0,34 mm ² –1,5 mm ² (AWG 22–AWG 16)	0,14 mm ² –1,5 mm ² (AWG 26–AWG 16)	Wire gauge
电缆出口直径	10–12 mm				Cable outlet
防护等级	IP67				Degree of protection
插拔周期	>500插拔周期 / > 500 mating cycles				Mechanical operation
最高工作温度	+ 100 °C				Upper temperature
最低工作温度	– 40 °C				Lower temperature
额定电压	400 V (600 V UL)	250 V		4000 V	Rated voltage
额定冲击电压	6000 V	4000 V			Rated impulse voltage
污染等级	3				Pollution degree
过电压等级	III				Overvoltage categorie
绝缘等级	III				Material group
额定电流 (40 °C)	16 A (12 A UL)	10 A (8 A UL)			Rated current (40 °C)
触点电阻	≤ 5 mΩ				Contact resistance
插针材料	CuSn (青铜/bronze)			—	Material of contact
插针表面材料	Ag (银 / silver)				Contact plating
插头主体材料	PBT				Material of contact body
外壳材料	PBT				Material of housing

电缆连接器，孔，PG16
Female cable connector, PG 16

电缆连接器，孔，PG16
Female cable connector, PG 16

图例 / Figure



压接接线方式请见第323页
Crimp contacts see page 323

压接接线方式请见第323页
Crimp contacts see page 323

尺寸图 / Drawing

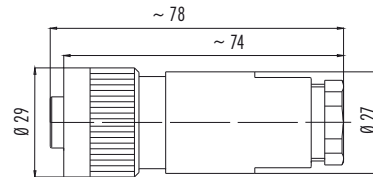
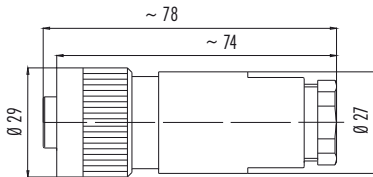

订货信息 / Order Data

芯数 Contacts	接线方式 Termination	电缆出口直径 Cable outlet	订货号 Ordering-No.
3+PE	螺钉接线 screw clamp	12-14 mm	99 0210 160 04
6+PE	焊接 solder	12-14 mm	99 0214 160 07
6+PE	螺钉接线 screw clamp	12-14 mm	99 0218 160 07
6+PE	压接 crimp	12-14 mm	99 0202 160 07

芯数 Contacts	接线方式 Termination	电缆出口直径 Cable outlet	订货号 Ordering-No.
3+PE	螺钉接线 screw clamp	12-14 mm	99 4222 160 04
6+PE	焊接 solder	12-14 mm	99 4226 160 07
6+PE	螺钉接线 screw clamp	12-14 mm	99 4218 160 07
6+PE	压接 crimp	12-14 mm	99 4202 160 07

技术参数 / Specifications

芯数	3+PE	6+PE	6+PE	6+PE	Number of contacts
锁紧方式	RD24螺母锁紧 / screw				Connector locking system
接线方式	螺钉接线 / screw clamp	焊接 / solder	螺钉接线 / screw clamp	压接 / crimp	Termination
导线截面	0,5 mm ² - 2,5 mm ² (AWG 20 - AWG 14)	max. 0,75 mm ² (max. AWG 20)	0,34 mm ² - 1,5 mm ² (AWG 22 - AWG 16)	0,14 mm ² - 1,5 mm ² (AWG 26 - AWG 16)	Wire gauge
电缆出口直径	12-14 mm				Cable outlet
防护等级	IP67				Degree of protection
插拔周期	>500插拔周期 / > 500 mating cycles				Mechanical operation
最高工作温度	+ 100 °C				Upper temperature
最低工作温度	- 40 °C				Lower temperature
额定电压	400 V (600 V UL)	250 V		4000 V	Rated voltage
额定冲击电压	6000 V	4000 V			Rated impulse voltage
污染等级	3				Pollution degree
过电压等级	III				Overvoltage categorie
绝缘等级	III				Material group
额定电流 (40 °C)	16 A (12 A UL)	10 A (8 A UL)			Rated current (40 °C)
触点电阻	≤ 5 mΩ				Contact resistance
插针材料	CuSn (青铜 / bronze)			—	Material of contact
插针表面材料	Ag (银 / silver)				Contact plating
插头主体材料	PBT				Material of contact body
外壳材料	PBT				Material of housing

弯角电缆连接器，孔，PG9
Female angled connector, PG 9

弯角电缆连接器，孔，PG9
Female angled connector, PG 9

图例 / Figure



压接接线方式请见第323页
Crimp contacts see page 323

压接接线方式请见第323页
Crimp contacts see page 323

尺寸图 / Drawing

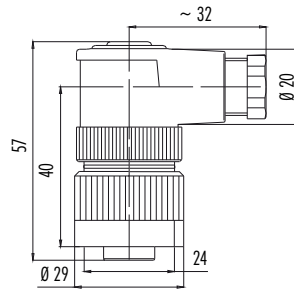
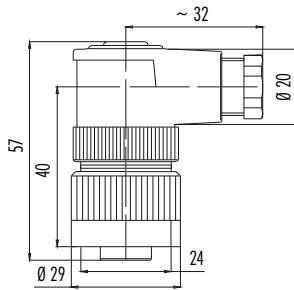

订货信息 / Order Data

芯数 Contacts	接线方式 Termination	电缆出口直径 Cable outlet	订货号 Ordering-No.
3+PE	螺钉接线 screw clamp	6-8 mm	99 0210 70 04
6+PE	焊接 solder	6-8 mm	99 0214 70 07
6+PE	螺钉接线 screw clamp	6-8 mm	99 0218 70 07
6+PE	压接 crimp	6-8 mm	99 0202 70 07

芯数 Contacts	接线方式 Termination	电缆出口直径 Cable outlet	订货号 Ordering-No.
3+PE	螺钉接线 screw clamp	6-8 mm	99 4222 70 04
6+PE	焊接 solder	6-8 mm	99 4226 70 07
6+PE	螺钉接线 screw clamp	6-8 mm	99 4218 70 07
6+PE	压接 crimp	6-8 mm	99 4202 70 07

技术参数 / Specifications

芯数	3+PE	6+PE	6+PE	6+PE	Number of contacts
锁紧方式	RD24螺母锁紧 / screw				Connector locking system
接线方式	螺钉接线 / screw clamp	焊接 / solder	螺钉接线 / screw clamp	压接 / crimp	Termination
导线截面	0,5 mm ² - 2,5 mm ² (AWG 20 - AWG 14)	max. 0,75 mm ² (max. AWG 20)	0,34 mm ² - 1,5 mm ² (AWG 22 - AWG 16)	0,14 mm ² - 1,5 mm ² (AWG 26 - AWG 16)	Wire gauge
电缆出口直径	6-8 mm				Cable outlet
防护等级	IP67 ¹⁾				Degree of protection
插拔周期	>500插拔周期 / > 500 mating cycles				Mechanical operation
最高工作温度	+ 100 °C				Upper temperature
最低工作温度	- 40 °C				Lower temperature
额定电压	400 V (600 V UL)	250 V		4000 V	Rated voltage
额定冲击电压	6000 V	4000 V			Rated impulse voltage
污染等级	3				Pollution degree
过电压等级	III				Overvoltage categorie
绝缘等级	III				Material group
额定电流 (40 °C)	16 A (12 A UL)	10 A (8 A UL)			Rated current (40 °C)
触点电阻	≤ 5 mΩ				Contact resistance
插针材料	CuSn(青铜 / bronze)			—	Material of contact
插针表面材料	Ag(银 / silver)				Contact plating
插头主体材料	PBT				Material of contact body
外壳材料	PBT				Material of housing

电源连接器 692.693 系列

Power 692 - 693 Series

RD24

弯角电缆连接器，孔，PG11
Female angled connector, PG 11

弯角电缆连接器，孔，PG11
Female angled connector, PG 11

图例 / Figure



压接接线方式请见第323页
Crimp contacts see page 323

压接接线方式请见第323页
Crimp contacts see page 323

尺寸图 / Drawing

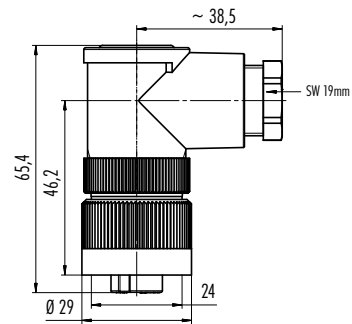
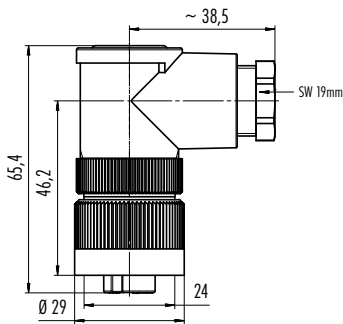

订货信息 / Order Data

芯数 Contacts	接线方式 Termination	电缆出口直径 Cable outlet	订货号 Ordering-No.
3+PE	螺钉接线 screw clamp	8-10 mm	99 0210 210 04
6+PE	焊接 solder	8-10 mm	99 0214 210 07
6+PE	螺钉接线 screw clamp	8-10 mm	99 0218 210 07
6+PE	压接 crimp	8-10 mm	99 0202 210 07

芯数 Contacts	接线方式 Termination	电缆出口直径 Cable outlet	订货号 Ordering-No.
3+PE	螺钉接线 screw clamp	8-10 mm	99 4222 210 04
6+PE	焊接 solder	8-10 mm	99 4226 210 07
6+PE	螺钉接线 screw clamp	8-10 mm	99 4218 210 07
6+PE	压接 crimp	8-10 mm	99 4202 210 07

技术参数 / Specifications

芯数	3+PE	6+PE	6+PE	6+PE	Number of contacts
锁紧方式	RD24螺母锁紧 / screw				Connector locking system
接线方式	螺钉接线 / screw clamp	焊接 / solder	螺钉接线 / screw clamp	压接 / crimp	Termination
导线截面	0,5 mm ² - 2,5 mm ² (AWG 20 - AWG 14)	max. 0,75 mm ² (max. AWG 20)	0,34 mm ² - 1,5 mm ² (AWG 22 - AWG 16)	0,14 mm ² - 1,5 mm ² (AWG 26 - AWG 16)	Wire gauge
电缆出口直径	8-10 mm				Cable outlet
防护等级	IP67				Degree of protection
插拔周期	>500插拔周期 / > 500 mating cycles				Mechanical operation
最高工作温度	+ 100 °C				Upper temperature
最低工作温度	- 40 °C				Lower temperature
额定电压	400 V (600 V UL)	250 V		4000 V	Rated voltage
额定冲击电压	6000 V	4000 V			Rated impulse voltage
污染等级	3				Pollution degree
过电压等级	III				Overvoltage categorie
绝缘等级	III				Material group
额定电流 (40 °C)	16 A (12 A UL)	10 A (8 A UL)			Rated current (40 °C)
触点电阻	≤ 5 mΩ				Contact resistance
插针材料	CuSn (青铜 / bronze)			—	Material of contact
插针表面材料	Ag (银 / silver)				Contact plating
插头主体材料	PBT				Material of contact body
外壳材料	PBT				Material of housing

692693

弯角电缆连接器，孔，PG13.5
Female angled connector, PG 13,5

弯角电缆连接器，孔，PG13.5
Female angled connector, PG 13,5

图例 / Figure



压接接线方式请见第323页
Crimp contacts see page 323

压接接线方式请见第323页
Crimp contacts see page 323

尺寸图 / Drawing

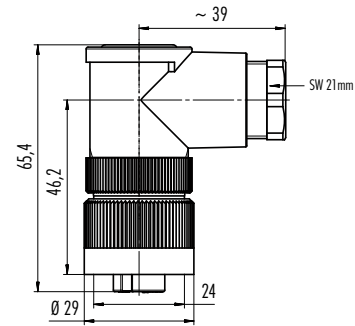
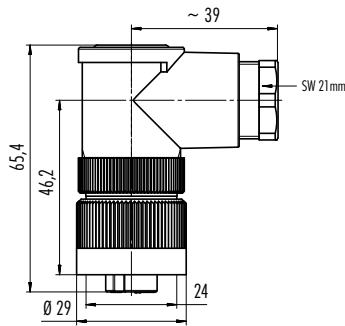

订货信息 / Order Data

芯数 Contacts	接线方式 Termination	电缆出口直径 Cable outlet	订货号 Ordering-No.
3+PE	螺钉接线 screw clamp	10–12 mm	99 0210 215 04
6+PE	焊接 solder	10–12 mm	99 0214 215 07
6+PE	螺钉接线 screw clamp	10–12 mm	99 0218 215 07
6+PE	压接 crimp	10–12 mm	99 0202 215 07

芯数 Contacts	接线方式 Termination	电缆出口直径 Cable outlet	订货号 Ordering-No.
3+PE	螺钉接线 screw clamp	10–12 mm	99 4222 215 04
6+PE	焊接 solder	10–12 mm	99 4226 215 07
6+PE	螺钉接线 screw clamp	10–12 mm	99 4218 215 07
6+PE	压接 crimp	10–12 mm	99 4202 215 07

技术参数 / Specifications

芯数	3+PE	6+PE	6+PE	6+PE	Number of contacts
锁紧方式	RD24螺母锁紧 / screw				Connector locking system
接线方式	螺钉接线 / screw clamp	焊接 / solder	螺钉接线 / screw clamp	压接 / crimp	Termination
导线截面	0,5 mm ² –2,5 mm ² (AWG 20–AWG 14)	max. 0,75 mm ² (max. AWG 20)	0,34 mm ² –1,5 mm ² (AWG 22–AWG 16)	0,14 mm ² –1,5 mm ² (AWG 26–AWG 16)	Wire gauge
电缆出口直径	10–12 mm				Cable outlet
防护等级	IP67				Degree of protection
插拔周期	>500插拔周期 / > 500 mating cycles				Mechanical operation
最高工作温度	+ 100 °C				Upper temperature
最低工作温度	– 40 °C				Lower temperature
额定电压	400 V (600 V UL)	250 V		4000 V	Rated voltage
额定冲击电压	6000 V	4000 V			Rated impulse voltage
污染等级	3				Pollution degree
过电压等级	III				Overvoltage categorie
绝缘等级	III				Material group
额定电流 (40 °C)	16 A (12 A UL)	10 A (8 A UL)			Rated current (40 °C)
触点电阻	≤ 5 mΩ				Contact resistance
插针材料	CuSn(青铜/bronze)			—	Material of contact
插针表面材料	Ag(银/ silver)				Contact plating
插头主体材料	PBT				Material of contact body
外壳材料	PBT				Material of housing

部件图

Component part drawing

电缆连接器
Cable connectors

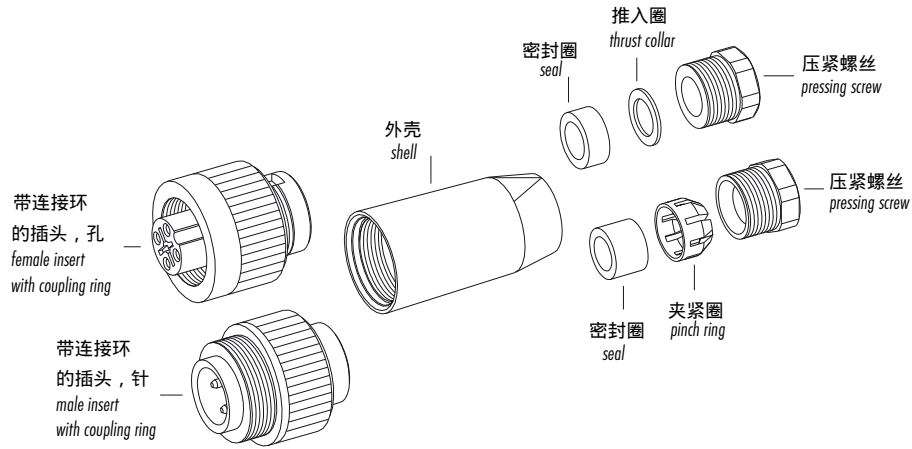

电缆连接器, 带电缆夹 PG9 UL, VDE, SEV 系列 螺纹锁紧 3+PE, 焊接
Cable connectors with cable clamp PG 9 version UL, VDE, SEV (screw 3+PE, solder)

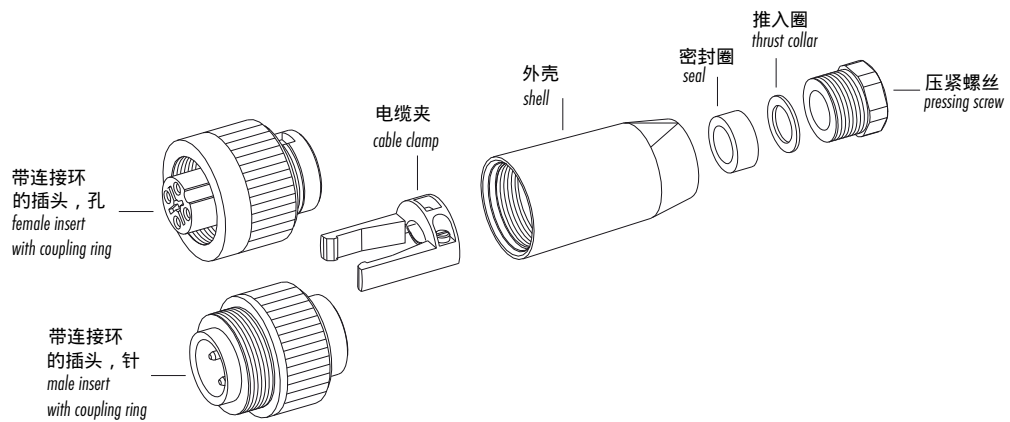

部件图

Component part drawing

电缆连接器，带夹紧圈 PG9 PG13.5 PG16 系列
Cable connectors with pinch ring PG11, PG 13,5, PG 16 version

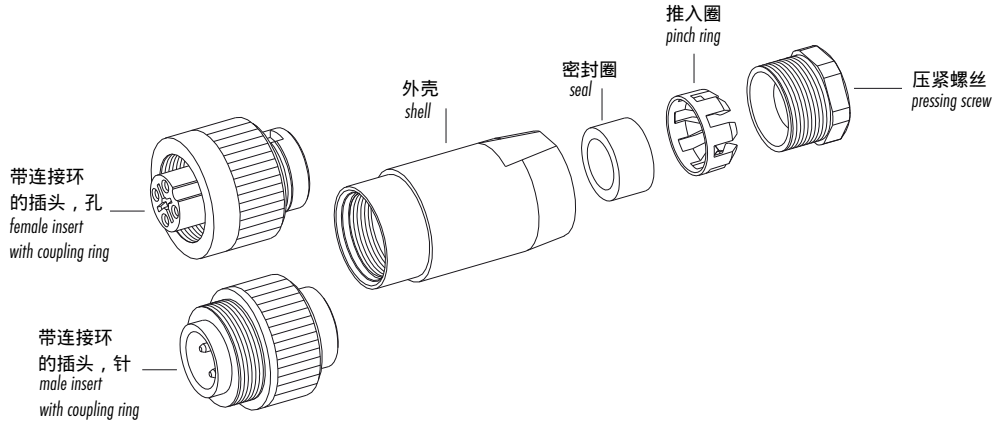

弯角连接器
Angled connectors

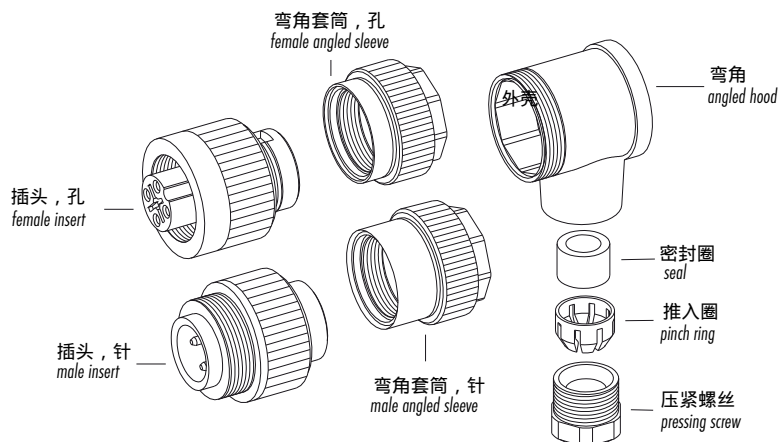

测定

Ratings

电流额曲线3+PE

Derating curve 3+PE

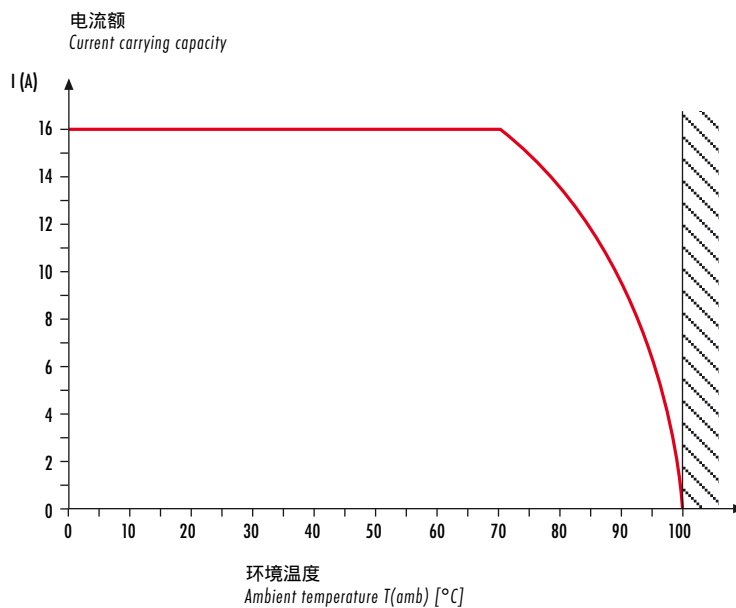

电流额曲线6+PE

Derating curve 6+PE

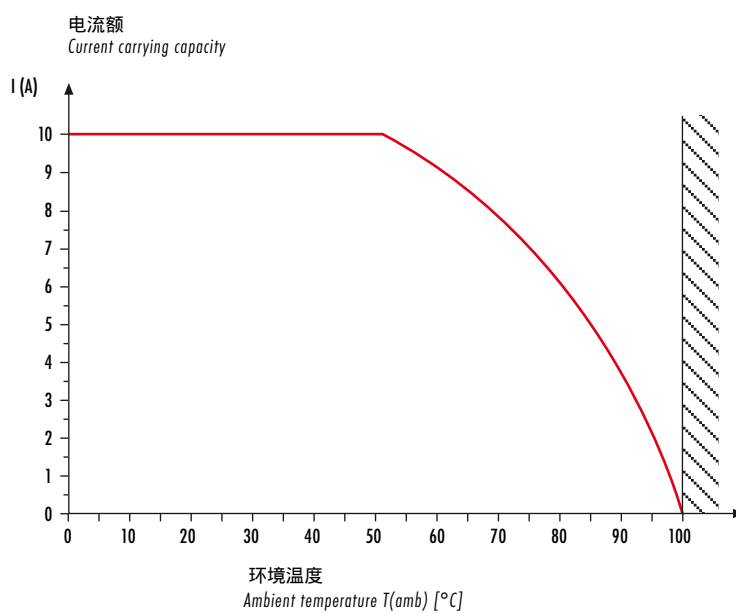

电缆连接器，针
Male cable connector

电缆连接器，针
Male angled connector

图例 / Figure



尺寸图 / Drawing

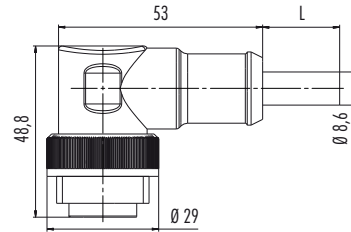
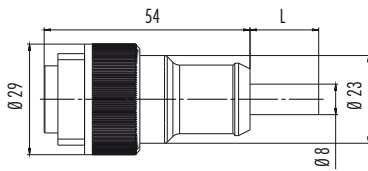

订货信息 / Order Data

芯数 Contacts	电缆护套 Cable jacket	电缆长度 Cable length	订货号 Ordering-No.
3+PE	PVC	2 m	79 0231 20 04
6+PE	PVC	2 m	79 0235 20 07

芯数 Contacts	电缆护套 Cable jacket	电缆长度 Cable length	订货号 Ordering-No.
3+PE	PVC	2 m	79 0233 20 04
6+PE	PVC	2 m	79 0237 20 07

技术参数 / Specifications

芯数	3+PE	6+PE	Number of contacts
锁紧方式	RD24螺母锁紧 / screw		Connector locking system
接线方式	压接，浇铸电缆 / crimp, moulded		Termination
导线截面	1,5 mm ² (AWG 16)	0,75 mm ² (AWG 20)	Wire gauge
电缆出口直径	—		Cable outlet
防护等级	IP67		Degree of protection
插拔周期	>500插拔周期 / > 500 mating cycles		Mechanical operation
最高工作温度	+ 80 °C		Upper temperature
最低工作温度	- 25 °C		Lower temperature
额定电压	400 V	250 V	Rated voltage
额定冲击电压	6000 V	4000 V	Rated impulse voltage
污染等级	3		Pollution degree
过电压等级	III		Overvoltage categorie
绝缘等级	III		Material group
额定电流 (40 °C)	16 A	8 A	Rated current (40 °C)
触点电阻	≤ 5 mΩ		Contact resistance
插针材料	CuZn(黄铜 / brass)		Material of contact
插针表面材料	Ag(银 / silver)		Contact plating
插头主体材料	PA 12		Material of contact body
外壳材料	PUR		Material of housing

电源连接器 692.693 系列

Power 692 - 693 Series

RD24

电缆连接器，孔
Female cable connector

电缆连接器，孔
Female angled connector

图例 / Figure



尺寸图 / Drawing

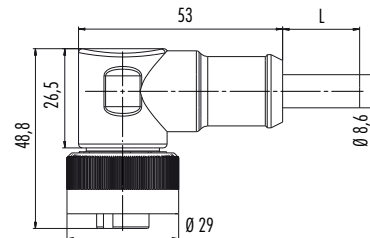
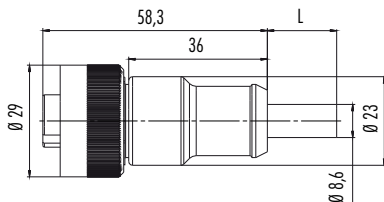

订货信息 / Order Data

芯数 Contacts	电缆护套 Cable jacket	电缆长度 Cable length	订货号 Ordering-No.
3+PE	PVC	2 m	79 0232 20 04
6+PE	PVC	2 m	79 0236 20 07

芯数 Contacts	电缆护套 Cable jacket	电缆长度 Cable length	订货号 Ordering-No.
3+PE	PVC	2 m	79 0234 20 04
6+PE	PVC	2 m	79 0238 20 07

技术参数 / Specifications

芯数	3+PE	6+PE	Number of contacts
锁紧方式	RD24螺母锁紧 / screw		Connector locking system
接线方式	压接，浇铸电缆 / crimp, moulded		Termination
导线截面	1,5 mm ² (AWG 16)	0,75 mm ² (AWG 20)	Wire gauge
电缆出口直径	—		Cable outlet
防护等级	IP67		Degree of protection
插拔周期	>500插拔周期 / > 500 mating cycles		Mechanical operation
最高工作温度	+ 80 °C		Upper temperature
最低工作温度	- 25 °C		Lower temperature
额定电压	400 V	250 V	Rated voltage
额定冲击电压	6000 V	4000 V	Rated impulse voltage
污染等级	3		Pollution degree
过电压等级	III		Overvoltage categorie
绝缘等级	III		Material group
额定电流 (40 °C)	16 A	8 A	Rated current (40 °C)
触点电阻	≤ 5 mΩ		Contact resistance
插针材料	CuZn (黄铜 / bronze)		Material of contact
插针表面材料	Ag (银 / silver)		Contact plating
插头主体材料	PA 12		Material of contact body
外壳材料	PUR		Material of housing

692693

电缆技术参数
Specifications

标准电缆
Standard cable

芯数	4	7	Number of contacts
导线截面mm	4 x 1,5 mm ² (AWG 16)	7 x 0,75 mm ² (AWG 20)	Wire gauge mm ² ¹⁾
电缆护套材料	PVC (schwarz/black)		Material jacket
导线绝缘层	PVC (schwarz, grün/gelb/black, green/yellow)		Insulation wire
导线规格 (mm)	28 x 0,25	24 x 0,20	Design of wire (mm)
电缆外壳 (mm)	8,6	9,7	Cable jacket (mm)
导线电阻	—		Resistance of wire
工作温度范围 (电缆运动)	- 5 °C /+ 80 °C		Temperature range (cable in move)
工作温度范围 (电缆静止)	- 20 °C /+ 80 °C		Temperature range (cable not in move)
弯曲半径 (电缆运动)	60 mm		Bending radius (cable in move)
弯曲半径 (电缆静止)	120 mm		Bending radius (cable not in move)
认证	UL, CSA		Approval



面板安装连接器，针，3+PE，螺钉接线

Male panel mount connector 3+PE, screw clamp termination

面板安装连接器，针，3+PE，螺钉接线

Male panel mount connector 3+PE, screw clamp termination

图例 / Figure



尺寸图 / Drawing

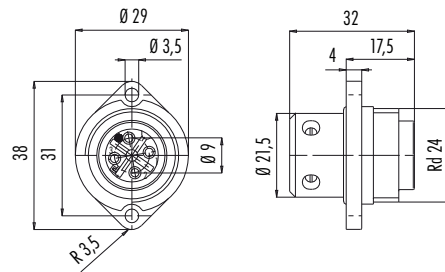
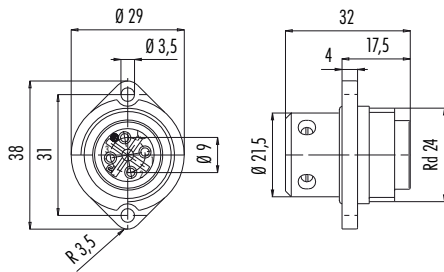

订货信息 / Order Data

芯数 Contacts	接线方式 Termination	订货号 Ordering-No.
3+PE	螺钉接线 screw clamp	09 0211 00 04

芯数 Contacts	接线方式 Termination	订货号 Ordering-No.
3+PE	螺钉接线 screw clamp	09 4223 00 04

技术参数 / Specifications

芯数	3+PE	Number of contacts
锁紧方式	RD24螺母锁紧 / screw	Connector locking system
接线方式	螺钉接线 / screw clamp	Termination
导线截面	0,5 mm ² – 2,5 mm ² (AWG 20 – AWG 14)	Wire gauge
电缆出口直径	—	Cable outlet
防护等级	IP67	Degree of protection
插拔周期	>500插拔周期 / > 500 mating cycles	Mechanical operation
最高工作温度	+ 100 °C	Upper temperature
最低工作温度	- 40 °C	Lower temperature
额定电压	400 V (600 V UL)	Rated voltage
额定冲击电压	6000 V	Rated impulse voltage
污染等级	3	Pollution degree
过电压等级	III	Overvoltage categorie
绝缘等级	III	Material group
额定电流 (40 °C)	16 A (12 A UL)	Rated current (40 °C)
触点电阻	≤ 5 mΩ	Contact resistance
插针材料	CuZn(黄铜) / brass	Material of contact
插针表面材料	Ag(银) / silver	Contact plating
插头主体材料	PBT	Material of contact body
外壳材料	PA	Material of housing

电源连接器 692.693系列

Power 692 - 693 Series

RD24

面板安装连接器，针，6+PE，焊接

Male panel mount connector 6+PE, solder termination

面板安装连接器，针，6+PE，焊接

Male panel mount connector 6+PE, solder termination

图例 / Figure



尺寸图 / Drawing

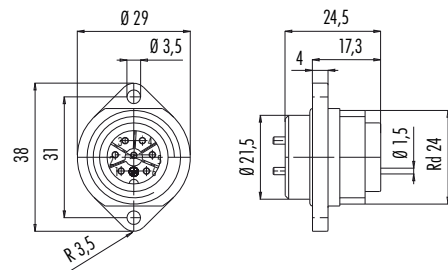
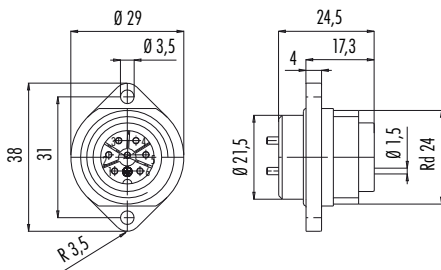

订货信息 / Order Data

芯数 Contacts	接线方式 Termination	订货号 Ordering-No.
6+PE	焊接 solder	09 0215 00 07

芯数 Contacts	接线方式 Termination	订货号 Ordering-No.
6+PE	焊接 solder	09 4227 00 07

技术参数 / Specifications

芯数	6+PE	Number of contacts
锁紧方式	RD24螺母锁紧 / screw	Connector locking system
接线方式	焊接 / solder	Termination
导线截面	max. 0,75 mm ² (max. AWG 20)	Wire gauge
电缆出口直径	—	Cable outlet
防护等级	IP67	Degree of protection
插拔周期	>500插拔周期 / > 500 mating cycles	Mechanical operation
最高工作温度	+ 100 °C	Upper temperature
最低工作温度	- 40 °C	Lower temperature
额定电压	250 V	Rated voltage
额定冲击电压	4000 V	Rated impulse voltage
污染等级	3	Pollution degree
过电压等级	III	Overvoltage categorie
绝缘等级	III	Material group
额定电流 (40 °C)	10 A (8 A UL)	Rated current (40 °C)
触点电阻	≤ 5 mΩ	Contact resistance
插针材料	CuZn(黄铜 / brass)	Material of contact
插针表面材料	Ag(银 / silver)	Contact plating
插头主体材料	PBT	Material of contact body
外壳材料	PA	Material of housing

692693

面板安装连接器，针，6+PE，螺钉接线

Male panel mount connector 6+PE, screw clamp termination

面板安装连接器，针，6+PE，螺钉接线

Male panel mount connector 6+PE, screw clamp termination

图例 / Figure



尺寸图 / Drawing

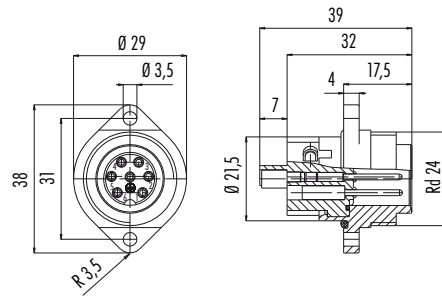
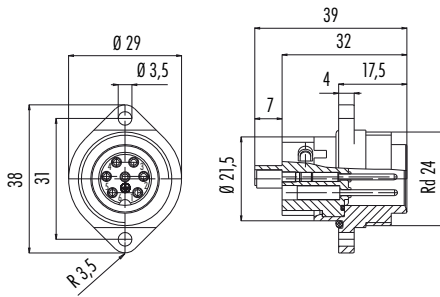

订货信息 / Order Data

芯数 Contacts	接线方式 Termination	订货号 Ordering-No.
6+PE	螺钉接线 screw clamp	09 0219 00 07

芯数 Contacts	接线方式 Termination	订货号 Ordering-No.
6+PE	螺钉接线 screw clamp	09 4219 00 07

技术参数 / Specifications

芯数	6+PE	Number of contacts
锁紧方式	RD24螺母锁紧 / screw	Connector locking system
接线方式	螺钉接线 / screw clamp	Termination
导线截面	0,34 mm ² – 1,5 mm ² (AWG 22 – AWG 16)	Wire gauge
电缆出口直径	—	Cable outlet
防护等级	IP67	Degree of protection
插拔周期	>500插拔周期 / > 500 mating cycles	Mechanical operation
最高工作温度	+ 100 °C	Upper temperature
最低工作温度	- 40 °C	Lower temperature
额定电压	250 V	Rated voltage
额定冲击电压	4000 V	Rated impulse voltage
污染等级	3	Pollution degree
过电压等级	III	Overvoltage categorie
绝缘等级	III	Material group
额定电流 (40 °C)	10 A (8 A UL)	Rated current (40 °C)
触点电阻	≤ 5 mΩ	Contact resistance
插针材料	CuZn (黄铜 / brass)	Material of contact
插针表面材料	Ag (银 / silver)	Contact plating
插头主体材料	PBT	Material of contact body
外壳材料	PA	Material of housing

面板安装连接器，针，6+PE，压接
Male panel mount connector 6+PE, crimp termination

面板安装连接器，针，6+PE，压接
Male panel mount connector 6+PE, crimp termination

图例 / Figure



压接接线方式请见第323页
Crimp contacts see page 323

压接接线方式请见第323页
Crimp contacts see page 323

尺寸图 / Drawing

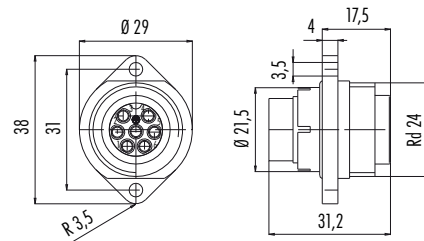
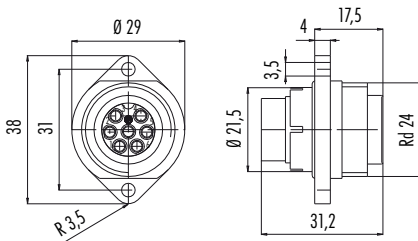

订货信息 / Order Data

芯数 Contacts	接线方式 Termination	订货号 Ordering-No.
6+PE	压接 crimp	09 0203 00 07

芯数 Contacts	接线方式 Termination	订货号 Ordering-No.
6+PE	压接 crimp	09 4203 00 07

技术参数 / Specifications

芯数	6+PE	Number of contacts
锁紧方式	RD24螺母锁紧 / screw	Connector locking system
接线方式	压接 / crimp	Termination
导线截面	0,14 mm ² –1,5 mm ² (AWG 26–AWG 16)	Wire gauge
电缆出口直径	—	Cable outlet
防护等级	IP67	Degree of protection
插拔周期	>500插拔周期 / > 500 mating cycles	Mechanical operation
最高工作温度	+ 100 °C	Upper temperature
最低工作温度	– 40 °C	Lower temperature
额定电压	250 V	Rated voltage
额定冲击电压	4000 V	Rated impulse voltage
污染等级	3	Pollution degree
过电压等级	III	Overvoltage categorie
绝缘等级	III	Material group
额定电流 (40 °C)	10 A (8 A UL)	Rated current (40 °C)
触点电阻	—	Contact resistance
插针材料	—	Material of contact
插针表面材料	—	Contact plating
插头主体材料	PBT	Material of contact body
外壳材料	—	Material of housing

面板安装连接器，孔，3+PE，螺钉接线

Female panel mount connector 3+PE, screw clamp termination

面板安装连接器，孔，3+PE，螺钉接线

Female panel mount connector 3+PE, screw clamp termination

图例 / Figure



尺寸图 / Drawing

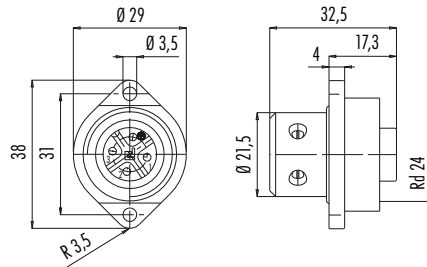
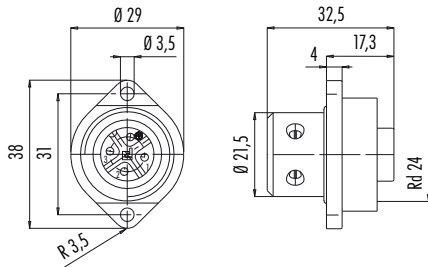

订货信息 / Order Data

芯数 Contacts	接线方式 Termination	订货号 Ordering-No.
3+PE	螺钉接线 screw clamp	09 0212 00 04

芯数 Contacts	接线方式 Termination	订货号 Ordering-No.
3+PE	螺钉接线 screw clamp	09 4224 00 04

技术参数 / Specifications

芯数	3+PE	Number of contacts
锁紧方式	RD24螺母锁紧 / screw	Connector locking system
接线方式	螺钉接线 / screw clamp	Termination
导线截面	0,5 mm ² – 2,5 mm ² (AWG 20 – AWG 14)	Wire gauge
电缆出口直径	—	Cable outlet
防护等级	IP67	Degree of protection
插拔周期	>500插拔周期 / > 500 mating cycles	Mechanical operation
最高工作温度	+ 100 °C	Upper temperature
最低工作温度	- 40 °C	Lower temperature
额定电压	400 V (600 V UL)	Rated voltage
额定冲击电压	6000 V	Rated impulse voltage
污染等级	3	Pollution degree
过电压等级	III	Overvoltage categorie
绝缘等级	III	Material group
额定电流 (40 °C)	16 A (12 A UL)	Rated current (40 °C)
触点电阻	≤ 3 mΩ	Contact resistance
插针材料	CuSn (青铜 / bronze)	Material of contact
插针表面材料	Ag (银 / silver)	Contact plating
插头主体材料	PBT	Material of contact body
外壳材料	PA	Material of housing

面板安装连接器，孔，6+PE，焊接

Female panel mount connector 6+PE, solder termination

面板安装连接器，孔，6+PE，焊接

Female panel mount connector 6+PE, solder termination

图例 / Figure



尺寸图 / Drawing

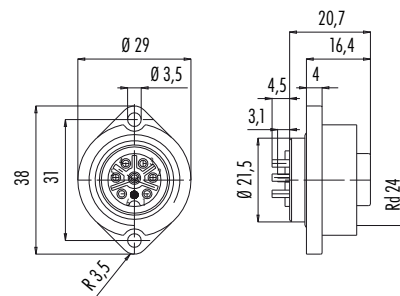
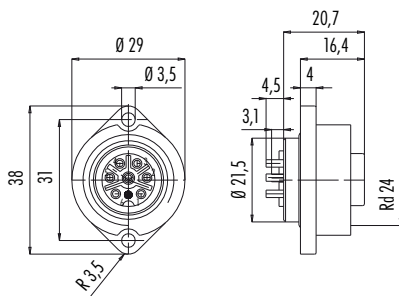

订货信息 / Order Data

芯数 Contacts	接线方式 Termination	订货号 Ordering-No.
6+PE	焊接 solder	09 0216 00 07

芯数 Contacts	接线方式 Termination	订货号 Ordering-No.
6+PE	焊接 solder	09 4228 00 07

技术参数 / Specifications

芯数	6+PE	Number of contacts
锁紧方式	RD24螺母锁紧 / screw	Connector locking system
接线方式	焊接 / solder	Termination
导线截面	max. 0,75 mm ² (max. AWG 20)	Wire gauge
电缆出口直径	—	Cable outlet
防护等级	IP67	Degree of protection
插拔周期	>500插拔周期 / > 500 mating cycles	Mechanical operation
最高工作温度	+ 100 °C	Upper temperature
最低工作温度	- 40 °C	Lower temperature
额定电压	250 V	Rated voltage
额定冲击电压	4000 V	Rated impulse voltage
污染等级	3	Pollution degree
过电压等级	III	Overvoltage categorie
绝缘等级	III	Material group
额定电流 (40 °C)	10 A (8 A UL)	Rated current (40 °C)
触点电阻	≤ 5 mΩ	Contact resistance
插针材料	CuSn (青铜 / bronze)	Material of contact
插针表面材料	Ag (银 / silver)	Contact plating
插头主体材料	PBT	Material of contact body
外壳材料	PA	Material of housing

面板安装连接器，孔，6+PE，螺钉接线

Female panel mount connector 6+PE, screw clamp termination

面板安装连接器，孔，6+PE，螺钉接线

Female panel mount connector 6+PE, screw clamp termination

图例 / Figure



尺寸图 / Drawing

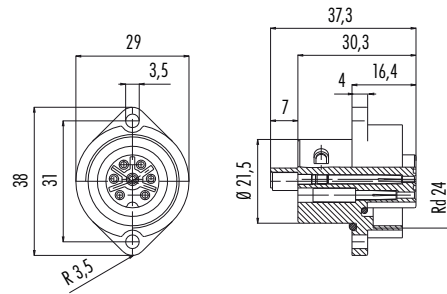
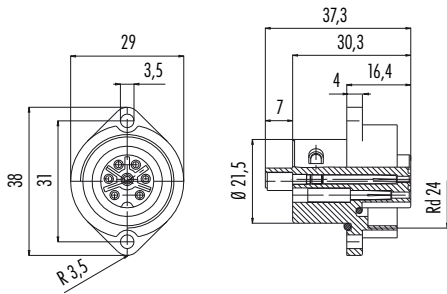

订货信息 / Order Data

芯数 Contacts	接线方式 Termination	订货号 Ordering-No.
6+PE	螺钉接线 screw clamp	09 0220 00 07

芯数 Contacts	接线方式 Termination	订货号 Ordering-No.
6+PE	螺钉接线 screw clamp	09 4220 00 07

技术参数 / Specifications

芯数	6+PE	Number of contacts
锁紧方式	RD24螺母锁紧 / screw	Connector locking system
接线方式	螺钉接线 / screw clamp	Termination
导线截面	0,34 mm ² – 1,5 mm ² (AWG 22 – AWG 16)	Wire gauge
电缆出口直径	—	Cable outlet
防护等级	IP67	Degree of protection
插拔周期	>500插拔周期 / > 500 mating cycles	Mechanical operation
最高工作温度	+ 100 °C	Upper temperature
最低工作温度	- 40 °C	Lower temperature
额定电压	250 V	Rated voltage
额定冲击电压	4000 V	Rated impulse voltage
污染等级	3	Pollution degree
过电压等级	III	Overvoltage categorie
绝缘等级	III	Material group
额定电流 (40 °C)	10 A (8 A UL)	Rated current (40 °C)
触点电阻	≤ 5 mΩ	Contact resistance
插针材料	CuSn (青铜 / bronze)	Material of contact
插针表面材料	Ag (银 / silver)	Contact plating
插头主体材料	PBT	Material of contact body
外壳材料	PA	Material of housing

面板安装连接器，孔，6+PE，压接

Female panel mount connector 6+PE, crimp termination

面板安装连接器，孔，6+PE，压接

Female panel mount connector 6+PE, crimp termination

图例 / Figure



压接接线方式请见第323页

Crimp contacts see page 323

压接接线方式请见第323页

Crimp contacts see page 323

尺寸图 / Drawing

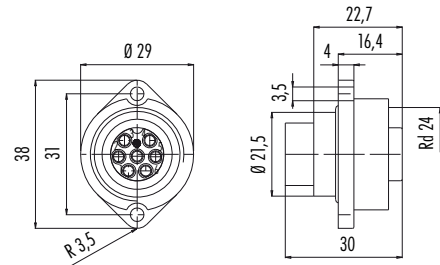
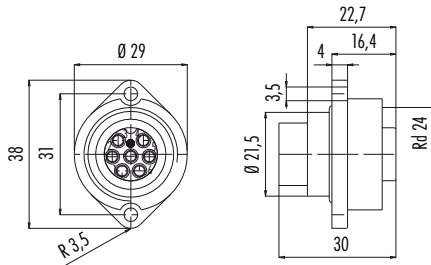

订货信息 / Order Data

芯数 Contacts	接线方式 Termination	订货号 Ordering-No.
6+PE	压接 crimp	09 0204 00 07

芯数 Contacts	接线方式 Termination	订货号 Ordering-No.
6+PE	压接 crimp	09 4204 00 07

技术参数 / Specifications

芯数	6+PE	Number of contacts
锁紧方式	RD24螺母锁紧 / screw	Connector locking system
接线方式	压接 / crimp	Termination
导线截面	0,14 mm ² –1,5 mm ² (AWG 26–AWG 16)	Wire gauge
电缆出口直径	—	Cable outlet
防护等级	IP67	Degree of protection
插拔周期	>500插拔周期 / > 500 mating cycles	Mechanical operation
最高工作温度	+ 100 °C	Upper temperature
最低工作温度	– 40 °C	Lower temperature
额定电压	250 V	Rated voltage
额定冲击电压	4000 V	Rated impulse voltage
污染等级	3	Pollution degree
过电压等级	III	Overvoltage categorie
绝缘等级	III	Material group
额定电流 (40 °C)	10 A (8 A UL)	Rated current (40 °C)
触点电阻	—	Contact resistance
插针材料	—	Material of contact
插针表面材料	—	Contact plating
插头主体材料	PBT	Material of contact body
外壳材料	—	Material of housing

针触点 (100 只为单位)

Male contact, PU 100 pieces

图例 / Figure



孔触点 (100 只为单位)

Male contact, PU 100 pieces



尺寸图 / Drawing

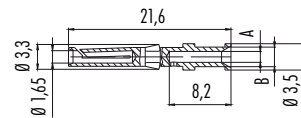
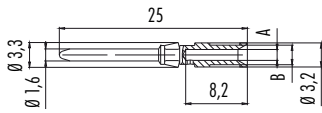

订货信息 / Order Data

A	B	电缆规格 For wire gauge	AWG AWG	订货号 Ordering-No.
0,9	2,6	0,14 mm ² – 0,34 mm ²	26–22	61 0891 139
1,1	2,6	0,5 mm ²	20	61 0892 139
1,45	2,6	0,75 mm ² – 1,0 mm ²	18	61 0893 139
1,8	3,0	1,5 mm ²	16	61 0894 139

A	B	电缆规格 For wire gauge	AWG AWG	订货号 Ordering-No.
0,9	2,6	0,14 mm ² – 0,34 mm ²	26–22	61 0896 139
1,1	2,6	0,5 mm ²	20	61 0897 139
1,45	2,6	0,75 mm ² – 1,0 mm ²	18	61 0898 139
1,8	3,0	1,5 mm ²	16	61 0899 139

针位图
Contact arrangements

插孔，针（接触面）
Male insert (mating side)

插孔，孔（接触面）
Female insert (mating side)

3+PE 芯
3+PE contacts

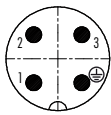

	X	Y
1	-3,18	-3,18
2	-3,18	3,18
3	3,18	3,18
PE	3,18	-3,18

1
2
3
⊕ 绿/黄 green/yellow

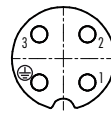

	X	Y
1	3,18	-3,18
2	3,18	3,18
3	-3,18	3,18
PE	-3,18	-3,18

1
2
3
⊕ 绿/黄 green/yellow

6+PE 芯
6+PE contacts

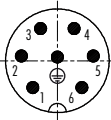

	X	Y
1	-3,25	-3,54
2	-4,76	0,63
3	-2,22	4,26
4	2,22	4,26
5	4,76	0,63
6	3,25	-3,54
PE	0,00	0,50

1
2
3
4
5
6
⊕ 绿/黄 green/yellow

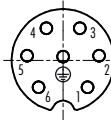

	X	Y
1	3,25	-3,54
2	4,76	0,63
3	2,22	4,26
4	-2,22	4,26
5	-4,76	0,63
6	-3,25	-3,54
PE	0,00	0,50

1
2
3
4
5
6
⊕ 绿/黄 green/yellow

安装截面
Panel cut out

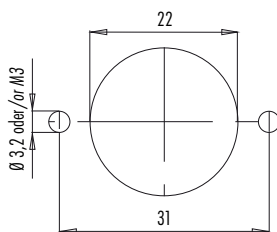

描述
针触点，信号/电源，100只为单位
4+3+PE 版本

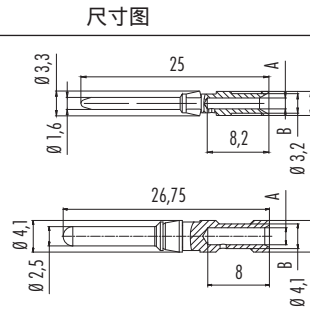

触点-Ø	A	B	电缆规格	AWG	订货号
1,6 mm	0,9	2,6	0,14-0,34 mm ²	26-22	61 0891 139
	1,1	2,6	0,5 mm ²	20	61 0892 139
	1,45	2,6	0,75-1,0 mm ²	18	61 0893 139
2,5 mm	1,8	3,0	1,5 mm ²	16	61 0894 139
	1,8	3,0	1,5 mm ²	16	61 0903 139
	2,2	3,2	2,5 mm ²	14	61 0902 139

NEW

孔触点，信号/电源，100只为单位
4+3+PE 版本

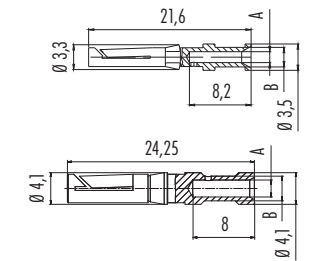

1,6 mm	0,9	2,6	0,14-0,34 mm ²	26-22	61 0896 139
	1,1	2,6	0,5 mm ²	20	61 0897 139
	1,45	2,6	0,75-1,0 mm ²	18	61 0898 139
2,5 mm	1,8	3,0	1,5 mm ²	16	61 0899 139
	1,8	3,0	1,5 mm ²	16	61 0901 139
	2,2	3,2	2,5 mm ²	14	61 0900 139

NEW

针触点，50只为单位
12芯 版本

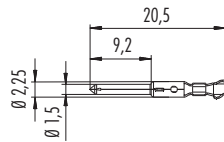

孔触点，50只为单位
12芯 版本

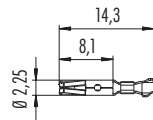

盘装（针）
12芯 版本

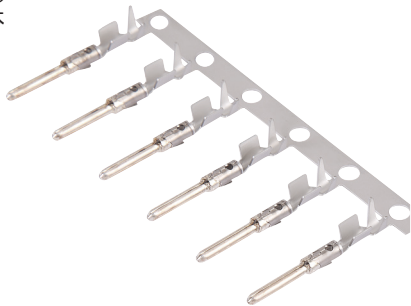

触点-Ø	绝缘-Ø	电缆规格	包装	只	订货号
1,5 mm	1,0-2,0 mm	0,14-0,25 mm ²	单独	50	61 0799 085 00
			盘装	200	65 0799 085 01
	1,6-2,1 mm	0,35-0,5 mm ²	单独	50	61 0795 085 00
			盘装	200	65 0795 085 01
	1,6-2,1 mm	0,75-1,0 mm ²	单独	50	61 0796 085 00
			盘装	200	65 0796 085 01
			盘装	2000	65 0796 085 02

NEW

盘装（孔）
12芯 版本

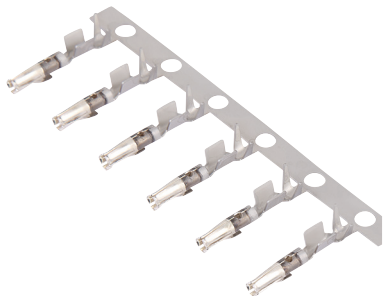

1,5 mm	1,0-2,0 mm	0,14-0,25 mm ²	单独	50	61 0800 085 00
			盘装	200	65 0800 085 01
	1,6-2,1 mm	0,35-0,5 mm ²	单独	50	61 0797 085 00
			盘装	200	65 0797 085 01
	1,6-2,1 mm	0,75-1,0 mm ²	单独	50	61 0798 085 00
			盘装	200	65 0798 085 01
			盘装	2000	65 0798 085 02

NEW

电缆

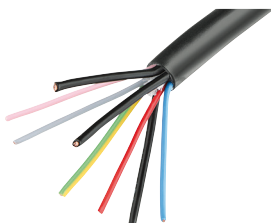

电缆规格	电缆长度	订货号
4 x 1,0 mm ² , 4 x 2,5 mm ²	100 m	08 3186 000 000

描述 尺寸图 订货号

电缆连接器保护罩，针 IP67

08 3107 000 000

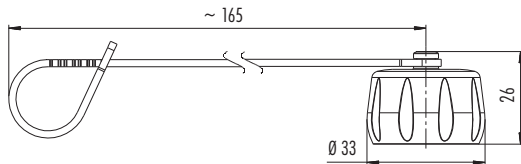

电缆连接器保护罩，孔 IP67

08 3108 000 000

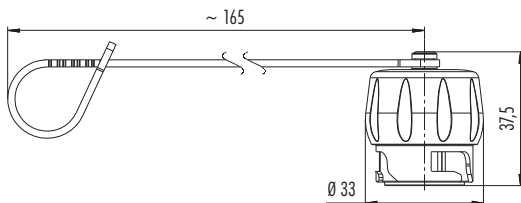

面板安装连接器保护罩，针 IP67

08 3109 000 000

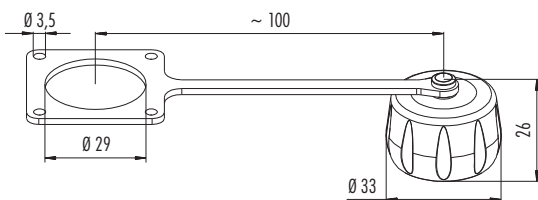

面板安装连接器保护罩，孔 IP67

08 3110 000 000

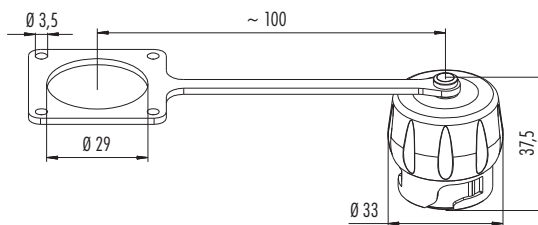

压接钳

单根插针压接钳

盘式插针压接钳

66 0003 001 旋转插针压接钳

66 0001 014 100 冲压插针压接钳

67 0001 014 100 盘式插针压接钳



拆解插针工具

单根插针拆解工具

66 0004 001 单根插针拆解工具

66 0011 001 电源插针拆解工具

07 0088 000 冲压插针拆解工具



密封组件, IP67

芯数 订货号

4 + 3 + PE 08 3111 000 000



NEW