

RF CHOKES - MOULDED

Dimensions in inches (mm)

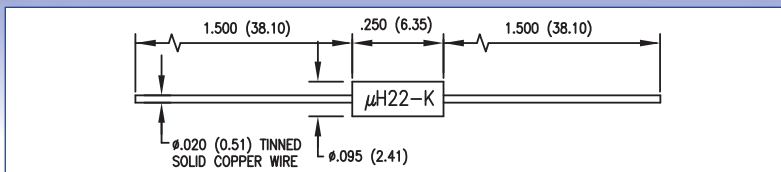
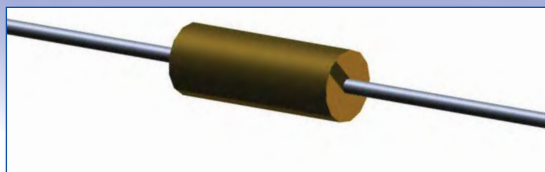

Inductance Tolerance Coded Dash Numbers			
-01	±5%	J	To Order
-02	±10%	K	Standard

Packaging Code	
-00	Loose
-36	Tape (500 Per Reel)

How to order code

55X - XXXX - XX - XX - XX

Basic Part No.
Inductance
Inductance Tolerance
Packaging

Basic Part No.	Body Marking Inductance & Tolerance	"Q" Min.	Test Frequency (MHz)	DCR Max. (Ω)	DC Max. (mA)	SRF Min. (MHz)	
551-5172	-01	22nH-K	33	30.0	0.0055	3000	900
	-02	27nH-K	33	30.0	0.0085	3000	900
	-03	33nH-K	33	30.0	0.0255	2800	900
	-04	39nH-K	33	30.0	0.0330	2500	900
	05	47nH-K	33	25.0	0.0380	2340	900
	-06	56nH-K	33	25.0	0.0480	2080	900
	-07	68nH-K	33	25.0	0.0550	1940	900
	-08	82nH-K	33	25.0	0.0650	1790	750
550-3399	-01	μH10-K	40	25.0	0.080	1350	625
	-02	μH12-K	40	25.0	0.090	1270	590
	-03	μH15-K	38	25.0	0.10	1200	550
	-04	μH18-K	35	25.0	0.12	1105	500
	-05	μH22-K	33	25.0	0.14	1025	470
	-06	μH27-K	33	25.0	0.16	960	400
	-07	μH33-K	30	25.0	0.22	815	380
	-08	μH39-K	30	25.0	0.30	700	350
	-09	μH47-K	30	25.0	0.35	650	310
	-10	μH56-K	30	25.0	0.50	545	280
	-11	μH68-K	28	25.0	0.60	495	250
	-12	μH82-K	28	25.0	0.85	415	230
	-13	1μH0-K	25	25.0	1.00	385	210
	-14	1μH2-K	25	7.9	0.18	590	140
	-15	1μH5-K	28	7.9	0.22	535	130
	-16	1μH8-K	30	7.9	0.30	455	115
	-17	2μH2-K	30	7.9	0.40	395	105
	-18	2μH7-K	37	7.9	0.55	355	92.0
	-19	3μH3-K	45	7.9	0.85	270	83.0
	-20	3μH9-K	45	7.9	1.0	250	73.0
	-21	4μH7-K	45	7.9	1.2	230	69.0
	-22	5μH6-K	50	7.9	1.8	185	60.0
	-23	6μH8-K	50	7.9	2.0	175	55.0
	-24	8μH2-K	55	7.9	2.7	155	50.0
	-25	10μH -K	55	7.9	3.7	130	46.0
	-26	12μH -K	45	2.5	2.7	155	37.0
	-27	15μH -K	40	2.5	2.8	150	32.0
	-28	18μH-K	50	2.5	3.1	145	28.0
	-29	22μH-K	50	2.5	3.3	140	23.0
	-30	27μH -K	50	2.5	3.5	135	18.0
	-31	33μH -K	45	2.5	3.4	130	20.0
	-32	39μH -K	45	2.5	3.6	125	19.0
	-33	47μH -K	45	2.5	4.5	110	17.0
	-34	56μH -K	45	2.5	5.7	100	15.0
	-35	68μH -K	50	2.5	6.7	92	13.0
	-36	82μH -K	50	2.5	7.3	88	12.0
	-37	mH10-K	50	2.5	8.0	84	11.0
	-38	mH12-K	30	0.79	13.0	66	10.0
	-39	mH15-K	30	0.79	15.0	61	9.0
	-40	mH18-K	30	0.79	17.0	57	8.5
	-41	mH22-K	30	0.79	21.0	52	7.5
	-42	mH27-K	30	0.79	25.0	47	6.8
	-43	mH33-K	30	0.79	28.0	45	6.0
	-44	mH39-K	30	0.79	35.0	40	5.5
	-45	mH47-K	30	0.79	42.0	36	5.1
	-46	mH56-K	30	0.79	46.0	35	4.2
	-47	mH68-K	30	0.79	60.0	30	3.4
	-48	mH82-K	30	0.79	65.0	29	3.2
	-49	1mH0-K	30	0.79	72.0	28	2.9

Temperature Range: 551-5172 -01 to -08 -55°C to +125°C For RoHS Compliant add suffix -LF to the part number
 550-3399 -01 to -14 -55°C to +125°C Conforms to BS9751 N001 Pattern A
 550-3399 -15 to -49 -55°C to +105°C