

Self-Clinching Flush Nuts

Series CFL

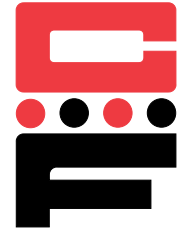

CFL flush nuts offer the advantage of being completely flush within the sheet while providing load-bearing threads in materials too ductile to tap. All dimensions are identical to industry standards.

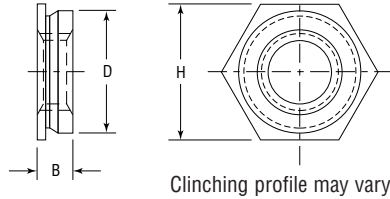

Series	Material	Finish
CFL	300 Series Stainless Steel	Passivated ASTM A967

Thread: Internal 2B, ANSI B1.1 (6H, ANSI/ASME B1.13M)
 Use in: Materials with Rockwell Hardness of B-70 or less.

Dimensions & Specifications

Thread Size	Part Number	D Max.	Min.		H Nom.	B Max.	Min.
INCH (in.)	#2-56	.171	.060	.172	.188	.060	.23
			.091				
	#4-40	.171	.060	.172	.188	.060	.23
			.091				
	#6-32	.212	.060	.213	.25	.060	.27
			.091				
	#8-32	.289	.060	.290	.312	.060	.28
			.091				
	#10-24	.311	.060	.312	.343	.060	.31
			.091				
	#10-32	.311	.060	.312	.343	.060	.31
			.091				
	1/4-20	.343	.125	.344	.375	.120	.34
			.156				
.187							
1/4-28	.343	.125	.344	.375	.120	.34	
		.156					
		.187					
METRIC (mm)	M2 x 0.4	4.35	1.53	4.37	4.8	1.53	6.0
			2.3				
	M2.5 x 4.5	4.35	1.53	4.37	4.8	1.53	6.0
			2.3				
	M3 x 0.5	4.35	1.53	4.37	4.8	1.53	6.0
			2.3				
	M3.5 x 0.6	5.35	1.53	5.4	6.4	1.53	6.5
			2.3				
	M4 x 0.7	7.35	1.53	7.37	7.9	1.53	7.2
			2.3				
	M5 x 0.8	7.9	1.53	7.92	8.7	1.53	8.0
			2.3				
	M6 x 1.0	8.72	3.18	8.74	9.5	3.05	8.8
			3.96				
4.75							

Continued on next page.



Self-Clinching Flush Nuts

Series CFL

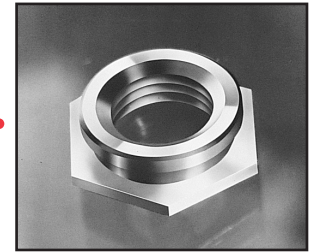

Continued from previous page.

Installation & Performance Data

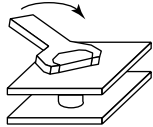
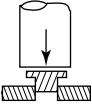
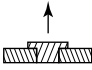
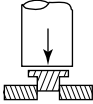
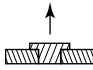
		Cold-rolled Steel		5052-H34 Aluminum		
Part Number	 Max. Screw torque (in.-lbs.)	 Installation Force (lbs.)	 Pushout (lbs.)	 Installation Force (lbs.)	 Pushout (lbs.)	
INCH (in.)	CFL256-1	1.5	3000	200	2000	200
	CFL256-2	1.5	3000	200	2000	200
	CFL440-1	2.5	3000	200	2000	200
	CFL440-2	2.5	3000	200	2000	200
	CFL632-1	3.5	3000	200	2000	200
	CFL632-2	3.5	3000	200	2000	200
	CFL832-1	5.25	4000	240	2000	240
	CFL832-2	5.25	4000	240	2000	240
	CFL1024-1	7.5	4000	240	4000	240
	CFL1024-2	7.5	4000	240	4000	240
	CFL1032-1	7.5	4000	240	4000	240
	CFL1032-2	7.5	4000	240	4000	240
	CFL420-3,4,5	36	4500	840	3500	640
	CFL428-3,4,5	36	4500	840	3500	640
Part Number	Max. Screw Torque (N•m)	Installation Force (kN)	Pushout (kN)	Installation Force (kN)	Pushout (kN)	
METRIC (mm)	CFLM2-1	.16	13.3	.890	8.9	.890
	CFLM2-2	.16	13.3	.890	8.9	.890
	CFLM2.5-1	.23	13.3	.890	8.9	.890
	CFLM2.5-2	.23	13.3	.890	8.9	.9
	CFLM3-1,2	.36	13.3	.890	8.9	.890
	CFLM3.5-1,2	.4	15	1.0	8.9	.9
	CFLM4-1,2	1	17.8	1.068	17.8	1.068
	CFLM5-1,2	1.3	17.8	1.068	17.8	1.068
	CFLM6-3,4,5	4.5	20	3.736	20	3.736