

$A = 2.54 * (\text{No of Spaces} - 1) \pm 0.13$   
 $B = A + 2.54 \pm 0.35 \pm 0.35$

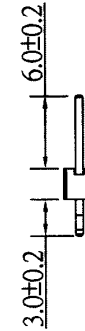

**SPECIFICATIONS**

Contact material: Brass  
 Insulator material: PBT  
 Contact plating: Selective gold or tin

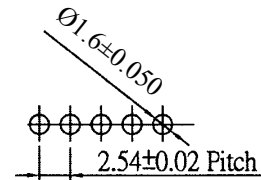

P.C.Board Layout

RoHS compliant

Rev.	Description	Date	Approved	Drawing	Name	Date
				Approved	Howard	08/10/99
				Checked	Lizzy	08/10/99
				Drawn	Tina	08/10/99
				0.0 ± 0.35	0.00 ± 0.20	Angles ± 3'
					UNIT: mm	
						<b>Central Components Manufacturing</b> 440 Lincoln Blvd., Middlesex, New Jersey 08846 Phone 732 469-5720 888 288-5152 Fax 732 469-1919
						Part No.: <b>APH-1-XX-SDA-XX-PFT</b> Description: Pin header, .100" pitch, single row, press fit pins, special plating options available