

YBLX-44 Breaking Limitator

1. General

Contacting types

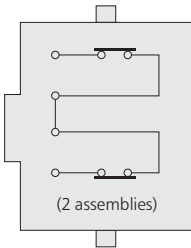

2. Type Designation

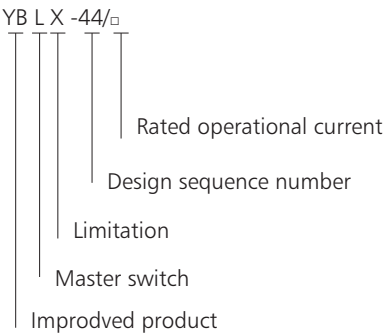

Protection degree	IP42
Rated operational voltage	AC 380V DC220V
Environmental temperature	-5℃～+40℃
Relative humidity	≤85%
Altitude	≤2000m
Application range	CD1, MD1 type of 0.5～10 ton normally apply on cable type electric block to realize limitation protection of lifting & falling movement, and can direct break the main circuit.

Model	Rated operational current	Max. Power of controllable motor	OT	Allowable OT	OP
YBLX-44/3	3A	1.5kW	≤8mm	≥1mm	≤15N
YBLX-44/10	10A	4.5kW	6～8mm	≤3mm	≤30N
YBLX-44/20	20A	7.5kW	8～10mm	≤3mm	≤50N
YBLX-44/40	40A	13kW	12～14mm	≤3mm	≤100N

YBLX-44/10

YBLX-44/20

YBLX-44/40

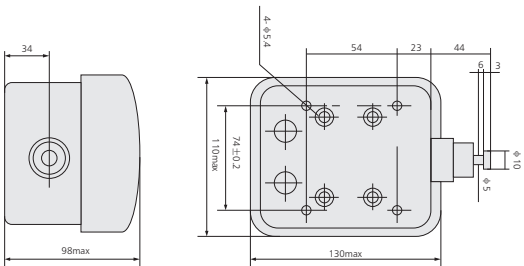

Travel Switches



YBLX-JW2、JBLW-JW2B Travel Switch

1. General

Contacting types

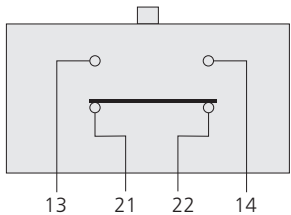

2. Type Designation

YB LX-JW 2 □ / 1 □ □ / □

3,5: number of component

Operating mode, refer to table below for definitions

1 NO contact

1 NC contact

A: special derivative code

Design sequence number

Micro-gap type

Travel switch

Improved product

Letter code	Operating mode
W1	Drive of roller
W2	Horizontally-driven type
L	Roller direct driven type
G	Roller & lever transmission type
Z	Combination type
H	Protection type
B	Simple protection type

Protection degree	IP52
Rated voltage	AC 220V DC220V
Rated current	AC 3A DC0.42A
Mechanical life	60X10 ⁴
(operations)	30X10 ⁴
Electric life(operations)	30X10 ⁴
Operating frequency	AC 40
(operations/minute)	DC 20
Altitude	≤2500m
Environmental temperature	-5℃~+40℃
Relative humidity	≤90%
Voltage withstand	Between electrified components and the earth (1890V)
	Between electrified components of the same polarity (1140V)
Application range	Between electrified components of the different polarity (2500V)
	Control travel of operating mechanism or change its direction & speed
Standard	IEC60947-5-1