



Ukrain



NH40S Changeover Switch

1. General

1.1 Application

Mainly used in the distributing and motor circuit which has high short-circuit current, and acted as main switch or master switch infrequently operated by hand, it is particularly suitable in the relative high class with drawable low voltage complete equipment. They provide safety isolation and protection against overcurrent for any low voltage electrical circuit.

1.2 Standard: IEC/EN 60947-3.

1.3 General characteristic

Full-enclosed structure

Unique rolling insert type contact system.

2. Changeover switch

2.1 Ordering information

Nh40 - □ / □ C S □

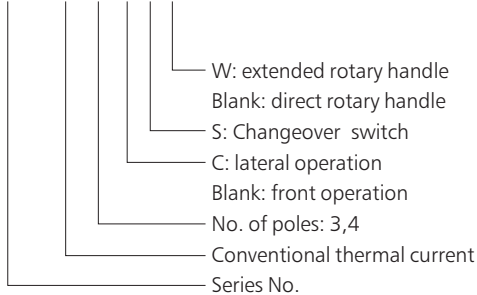

2.2 Property

Conventional thermal current		125	160	200	250	315	400	630
Rated current of fuse(A)		125	160	200	250	315	400	630
Rated insulation voltage(V)		800						
Rated current (A)	400V AC21	125	160	200	250	315	400	630
	690V AC21	125	160	160	200	315	400	500
	230V DC21	125	160	160	250	315	400	630
	440V DC21	125	160	160	200	315	400	500
Operation force (N)		40~60		65~100		75~120		

Conventional thermal current		1000	1250	1600	2000	2500	3150
Rated current of fuse(A)		1000	1250	2×800	2×1000	2×1250	
Rated insulation voltage(V)		800					
Rated current (A)	400V AC20	1000	1250	1600	2000	2500	3150
	690V AC20	1000	1250	1600	2000	2500	3150
	230V DC20	1000	1250	1600	2000	2500	3150
	440V DC20	1000	1250	1600	2000	2500	3150
Operation force (N)		200~300					

Mounting dimensions of NH40-125~1600/C and NH40-125~1600/CS

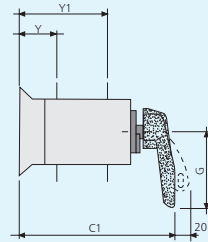
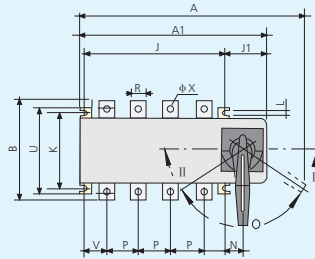

125A~1600A/CS
Lateral double-throw operation

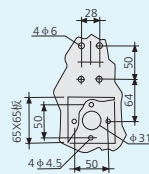

Gate hole

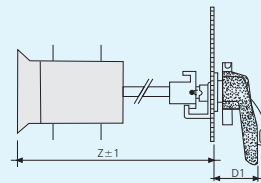

125A~1600A/CSW
Lateral double-throw operation outside the switchgear

Minimum length of extended connecting stick
125-630A: Z+27±1
1000-1600 A: Z+35±1

Mounting dimension of NH40 lateral operation and NH40 changeover switch disconnector

Specification	NH40-XX/C NH40-XX/CS Overall and mounting dimensions (mm)																	
	A	A1	B	C	C1	D1	J	K	L	N	P	R	U	V	X	Y	Y1	Z
125A/3	267	196	135	152	212	60	120	95	7	29.5	36	20	115	20	9	55	120	232
160A/3	267	196	135	152	212	60	120	95	7	29.5	36	20	115	20	9	55	120	232
125A/4	297	296	135	152	212	60	150	95	7	29.5	36	20	115	20	9	55	120	232
160A/4	297	296	135	152	212	60	150	95	7	29.5	36	20	115	20	9	55	120	232
200A/3	307	236	170	147	229	60	160	115	7	29.5	50	25	140	27	11	65	145	249
250A/3	307	236	170	147	229	60	160	115	7	29.5	50	25	140	27	11	65	145	249
200A/4	357	286	170	147	229	60	210	115	7	29.5	50	25	140	27	11	65	145	249
250A/4	357	286	170	147	229	60	210	115	7	29.5	50	25	140	27	11	65	145	249
315A/3	372	301	240	184	297	60	210	180	9	45	65	32	205	37.5	11	84	198	317
400A/3	372	301	240	184	297	60	210	180	9	45	65	32	205	37.5	11	84	198	317
630A/3	372	301	260	184	297	60	210	180	9	45	65	32	205	37.5	13	84	198	317
315A/4	432	361	240	184	297	60	270	180	9	45	65	32	205	37.5	11	84	198	317
400A/4	432	361	240	184	297	60	270	180	9	45	65	32	205	37.5	11	84	198	317
630A/4	432	361	260	184	297	60	270	180	9	45	65	32	205	37.5	13	84	198	317
1000A/3	621	472	310	230	374	81	353	220	11	51.5	120	60	250	60.5	13	108	253	374
1250A/3	621	472	360	230	374	81	353	220	11	51.5	120	80	250	60.5	13	108	253	374
1600A/3	621	472	360	230	374	81	353	220	11	51.5	120	80	250	60.5	13	108	253	374
1000A/4	741	592	310	230	374	81	473	220	11	51.5	120	60	250	60.5	13	108	253	374
1250A/4	741	592	360	230	374	81	473	220	11	51.5	120	80	250	60.5	13	108	253	374
1600A/4	741	592	360	230	374	81	473	220	11	51.5	120	80	250	60.5	13	108	253	374

Mounting dimensions of NH40-2000~3150/C and NH40-2000~3150/CS

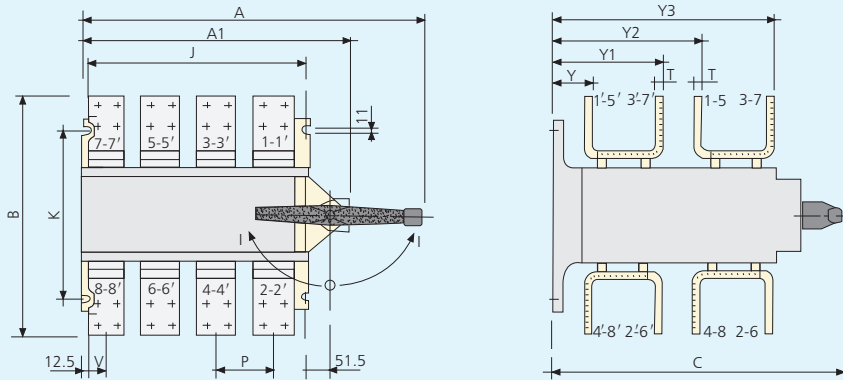

2000A~3150A/CS

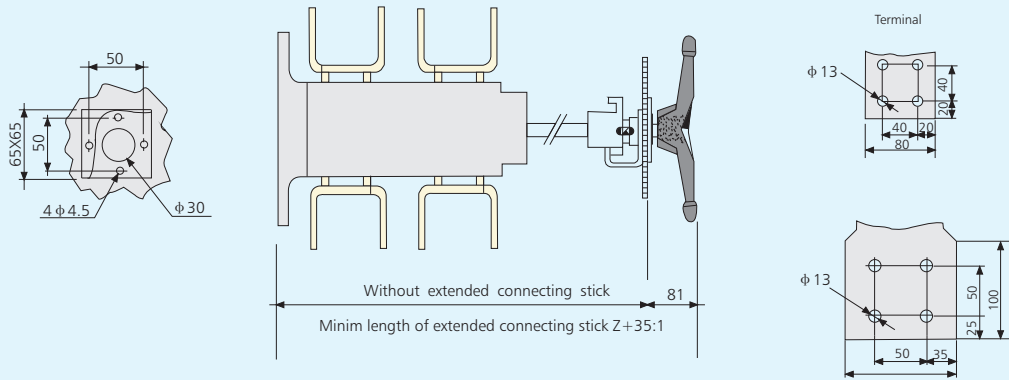

Mounting dimension of NH40 changeover switch disconnect

Specification	NH40-XX/C NH40-XX/CS Overall and mounting dimensions (mm)													
	A	A1	B	C	C1	J	K	P	V	Y	Y1	Y2	Y3	Z
2000A/3	576	472	450	603	374	353	220	120	60	80	230	420	465	603
2500A/3	576	472	450	603	374	353	220	120	60	80	230	420	465	603
3150A/3	576	472	450	603	374	353	220	120	60	80	230	420	465	603
2000A/4	696	592	510	603	374	473	220	120	60	80	230	420	465	603
2500A/4	696	592	510	603	374	473	220	120	60	80	230	420	465	603
3150A/4	696	592	510	603	374	473	220	120	60	80	230	420	465	603