

COMROD Mast Brackets

- * Brackets for different mast configuration.
- * Other types of mast interfaces are available on request
- * Two types of antenna connections are available , either VM or CEF connection

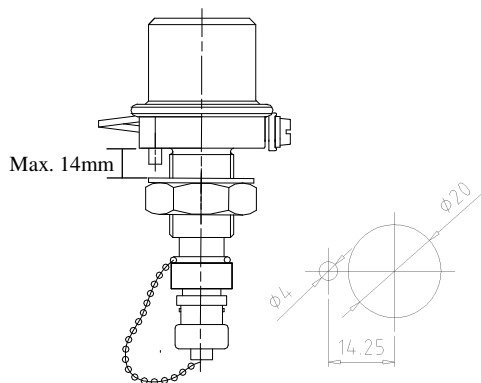

General Purpose bracket,
for mounting hole Ø20mm

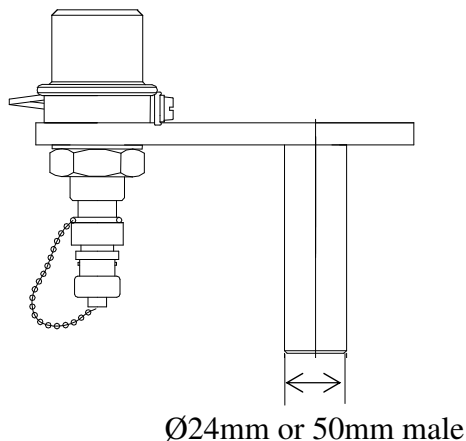

Ø24mm or 50mm male

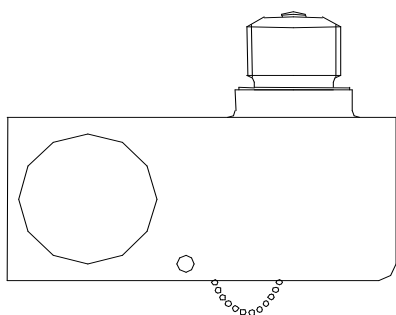

Bracket for AMX85 mast

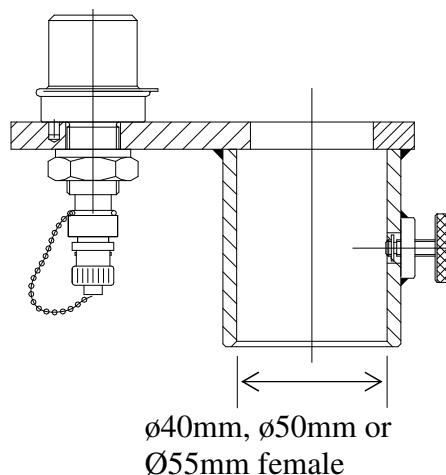

Ø40mm, Ø50mm or
Ø55mm female

Electrical specifications for VM connection:

Frequency range	0 - 450 MHz
Antenna connection, top	VM
Nominal impedance	50 ohm
Power rating	400W CW
Connector , bottom	BNC, others on requests



Picture of VM connection

Electrical specifications for CEF connection:

Frequency range	0 - 2 GHz
Antenna connection, top	CEF
Nominal impedance	50 ohm
Power rating	400W CW
Connector , bottom	BNC, others on requests



Picture of CEF connection