

## EJOT® aerated concrete screw FPS-E-8.0

To secure roofing membrane to aerated concrete substratures.

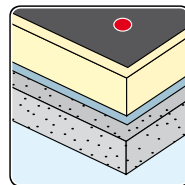
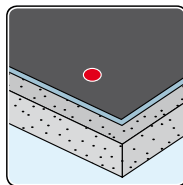

### Application area

- To secure roofing membrane to aerated concrete substratures.
- In combination with EJOT® stress plate
  - HTV 82/40 F
  - HTV 40 RU
  - EcoTek 50

### Properties

- A4 stainless steel
- approved for P3.3 aerated concrete onwards
- no pre-drilling

### Approval

ETA-07/0013

### Technical Data

Drive ..... hexalobular / TORX® T30  
 Installation depth ≥ ..... 60 mm

### Note

Pull-out tests have to be arranged with our service team for all renovation cases.



**EJOT® aerated concrete screw FPS-E-8.0**

Ø mm	Length mm	PU	Order description	Part number
8.0	80	250	FPS-E-8.0x80	5 580 080 300
8.0	100	250	FPS-E-8.0x100	5 580 100 300
8.0	120	250	FPS-E-8.0x120	5 580 120 300
8.0	160	100	FPS-E-8.0x160	5 580 160 300
8.0	200	100	FPS-E-8.0x200	5 580 200 300
8.0	240	150	FPS-E-8.0x240	5 580 240 300

**Compatibility acc. to ETA-07/0013**

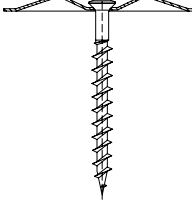
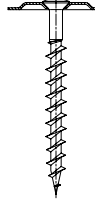
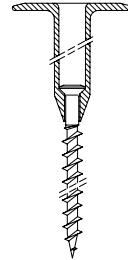
	HTK 50	HTK 2G	HTV 82/40 TK	HTV 82/40	HTV 82/40 F	HTV 40 RU	EcoTek 50
FPS-E-8.0							

**Characteristic values of the tensile strength**

No.	EJOT Fastening Systems		Surface									
	Screw	Stress plate	Sheet steel		Wood				Con- crete <sup>7)</sup>	Light- weight con- crete <sup>8)</sup>	Aerated con- crete <sup>9)</sup>	
			1)	2)	3)	4)	5)	6)				
			[kN]									
24	FBS-R-6.3xL	HTV 82/40 F									2.15 <sup>10)</sup>	
25	FBS-R-6.3xL	HTV 40 RU 6.5 mm									2.15 <sup>10)</sup>	
26	FBS-R-6.3xL	EcoTek 50									1.61 <sup>10)</sup>	

ETA-07/0013, Page 37

- 1) S280 GD – EN 10346; Thickness  $t_{min} = 0.63$  mm
- 2) S280 GD – EN 10346; Thickness  $t_{min} = 0.75$  mm
- 3) T&G boarding; EN 338/C24, Thickness  $\geq 25$  mm
- 4) Wood chipboard P4; EN 12369-1; Thickness  $\geq 19$  mm
- 5) Plywood; EN 12369-2; Thickness  $\geq 21$  mm
- 6) OSB/3; EN 12369-1; Thickness  $\geq 18$  mm

- 7) C 12/15 EN 206, effective installation depth  $\geq 30$  mm
- 8) LC 12/13 EN 206; effective installation depth  $\geq 30$  mm
- 9) P 3.3/5.0 EN 12602
- 10) Effective installation depth  $\geq 60$  mm
- 11) Effective installation depth  $\geq 65$  mm