

Revisions			
Rev	Description	Date	Approved

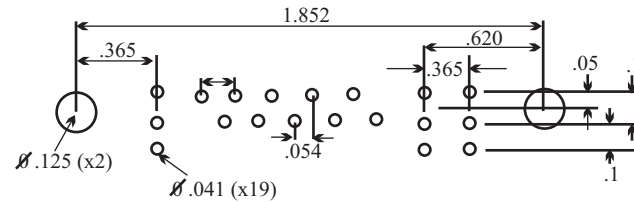

PCB Layout

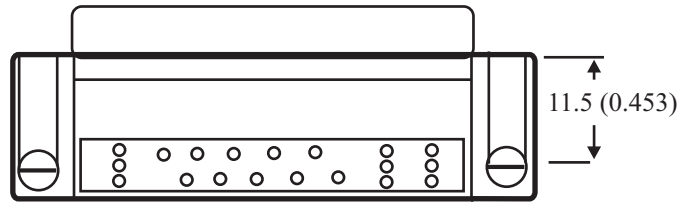
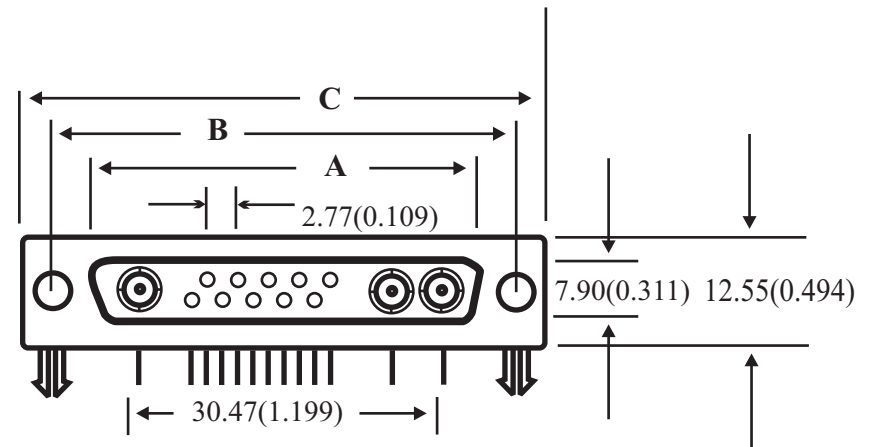
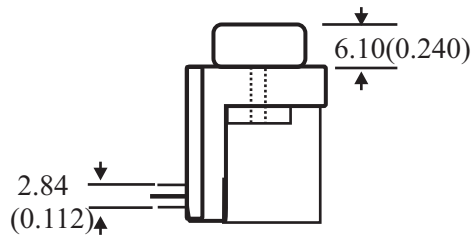

SPECIFICATIONS

Electrical

- Current Rating: 5 Amp
- Dielectric W/S: AC 1000 V min.
- Insulation Resist: 5k mohms min.
- Contact Resist: 15 mohms max (mated)
- Operating Temp: -55c to +105c

Mechanical

- Insulator: PBT and reinforced glass fiber (UL 94V-0)
- Contact: Phosphor Bronze

Finish

- Contact: Gold Flash over Nickel
- Shell: Steel, Tin or Zinc Plated

Description:

Combo D-Sub, Right Angle (0.494)

Approvals	Date
Drawn	
Checked	
Issued	

Phyco
1740-A Junction Ave.
San Jose, CA 95112

Drawing#
3260-XX-X
 (XX = Contact# i.e. 09,15,25,37) (X=Gender M/F)

Do not Scale Drawings