

2.00mm pitch Female Header  
 - THT - 6.35mm profile

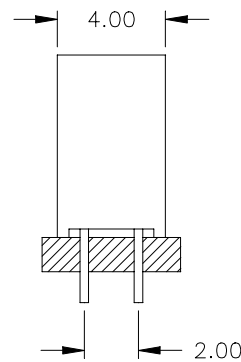
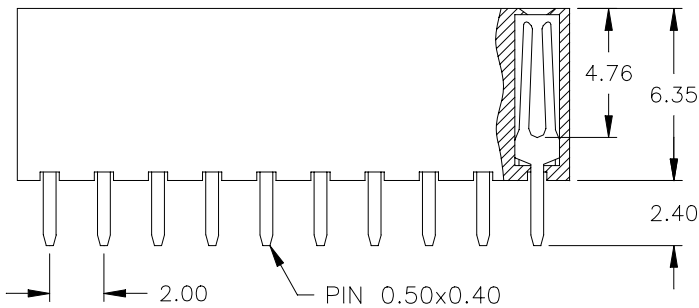
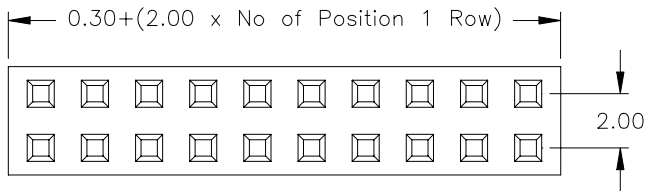
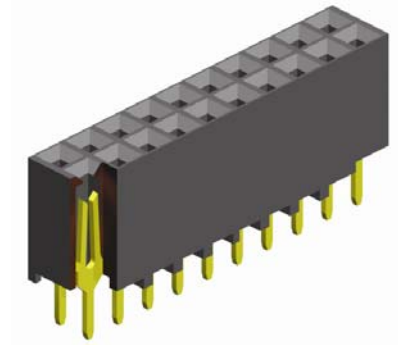

**APPLICATION AND FEATURES**

- For board-to-board connections
- Ideal solution for PC-104 Systems
- Accepts 0.50mm square pins
- Hi-rel fork contact design

**PCB Hole Layout**

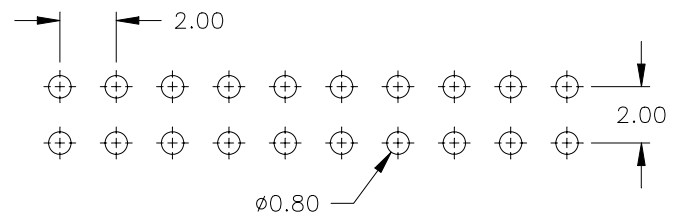

**SPECIFICATIONS**

Current rating	1 A	Operating temperature	- 40° to +105°C
Insulator resistance	5000 MΩ min.	Contact material	Copper Alloy (RoHS compliant)
Contact resistance	20 mΩ max.	Insulator material	LCP UL 94 V-0 (RoHS compliant)
Dielectric withstanding voltage	500 V AC		

How to order

BL 2 - xxx - SH635 - 55/2

<b>Nbr of contacts</b>
dual row = <b>004</b> to <b>080</b>

<b>Plating</b>
<b>55</b> = gold
Other platings on request