

2.00mm pitch

- SMT - Pin Header & Board Spacer

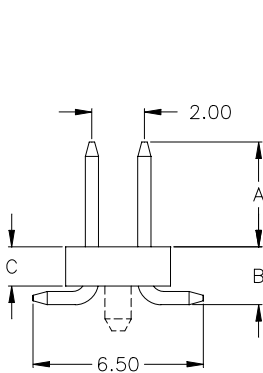

SS2 Type

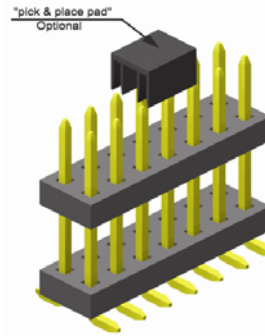
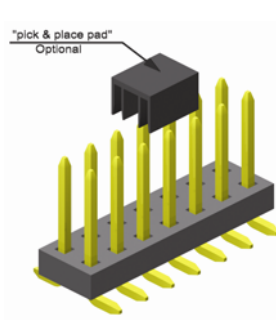
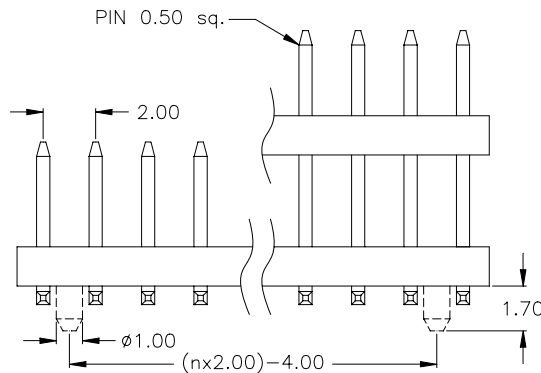

SP2 Type

**APPLICATION AND FEATURES**

- **Standard: tube packing, without “locating pegs” and “pick & place pad”**
- Designed for “board to board” spacing
- Variable terminal length available
- Mate with female header 2,00 mm x 2,00 mm pitch

**PCB Surface Mount Layout**

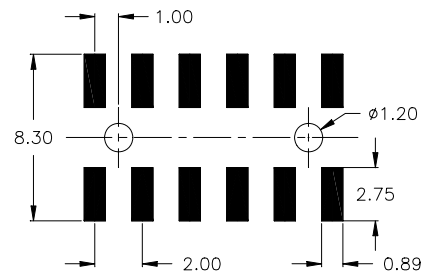

**SPECIFICATIONS**

Current rating	1 A
Insulator resistance	5000 MΩ min.
Contact resistance	20 mΩ max.
Dielectric withstanding voltage	500 V AC

Operating temperature	- 40°C to +105°C
Processing temperature	+250°C +0/-5°C
	SS2 Type = 250°C for 20 sec.
	SP2 Type = 250°C for 5 sec.
Contact material	(RoHS compliant) Copper alloy
Insulator material	(RoHS compliant) Nylon UL 94 V-0

**How to order**

**S X 2 - xxx - H xxx/x - 55 /2 X**

Type	Nbr of contacts	Terminal style				Plating	Packing and “pick & place pad” Option		
		Type	Code	DIM A	DIM B			DIM C	
S Low Profile	006	S	064/0	6.00mm	2.20mm	1.50mm	gold	without “locating pegs” A = tube packing and pick & place pad B = reel packing and pick & place pad	
			064/1	4.00mm	2.20mm	1.50mm			
			064/2	3.50mm	2.70mm	2.00mm			
			064/3	5.80mm	2.20mm	1.50mm			
			064/4	3.20mm	2.20mm	1.50mm			
			064/5	3.60mm	2.20mm	1.50mm			
P Board Spacer	to 050	P	065/0	6.00mm	6.00mm			other platings on request	with “locating pegs” (if DIM “C” = 1.50mm only) C = locating pegs and tube packing D = locating pegs; tube packing; pick & place pad E = locating pegs; reel packing; pick & place pad
			065/1	6.00mm	10.00mm				
			065/2	6.00mm	12.00mm				
			065/3	4.00mm	13.33mm				
			065/4	3.90mm	8.00mm				
			065/5	4.50mm	17.00mm				
			Other dimensions on request						