

1.27mm pitch Female Header

- SMT- side entry

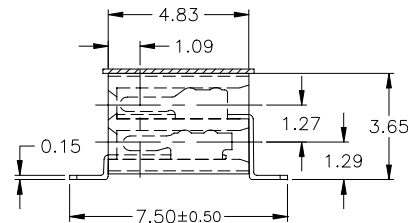
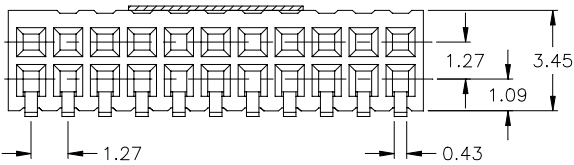
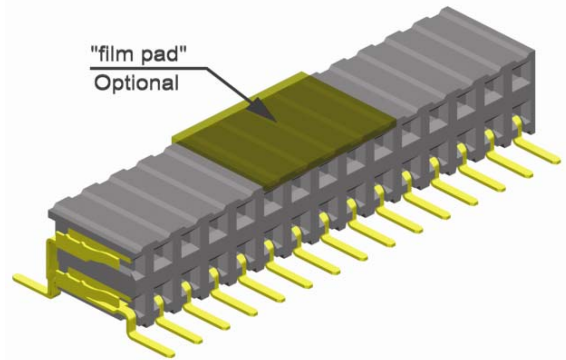
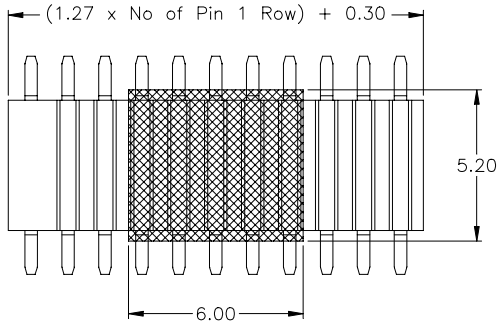

APPLICATION AND FEATURES

- **Standard: tube packing**
- Hi-rel dual beam contact assures reliable PC-Board connections
- Accepts 0.40 mm square pins; Pin Header 1,27 mm x 1,27 mm
- 3.65mm height above board
- Automatic assembly to PCB possible

PCB Surface Mount Layout

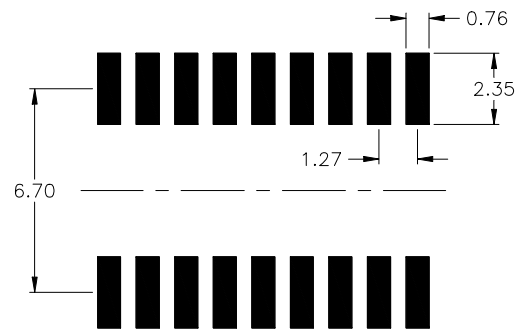

SPECIFICATIONS

Current rating	1 A
Insulator resistance	5000 MΩ min.
Contact resistance	20 mΩ max.
Dielectric withstanding	AC 500 V

Operating temperature	- 40°C to +105°C
Processing temperature	+250°C +0/-5°C for 10sec.
Contact material (RoHS compliant)	Phosphor Bronze
Insulator material (RoHS compliant)	Nylon UL 94 V-0

How to order

BS 2 - xxx - R 345 - 55 / 11 XX

Nbr of contacts
006 to 080

Plating
55 = gold
others on request

Packing and "pick & place tape" Option
AT = tube packing and pick & place tape
BT = reel packing and pick & place tape