

REV	DESCRIPTION	DATE	BY
A	NEW DRAWING	11/02/09	JAG

SKT3356

TOP

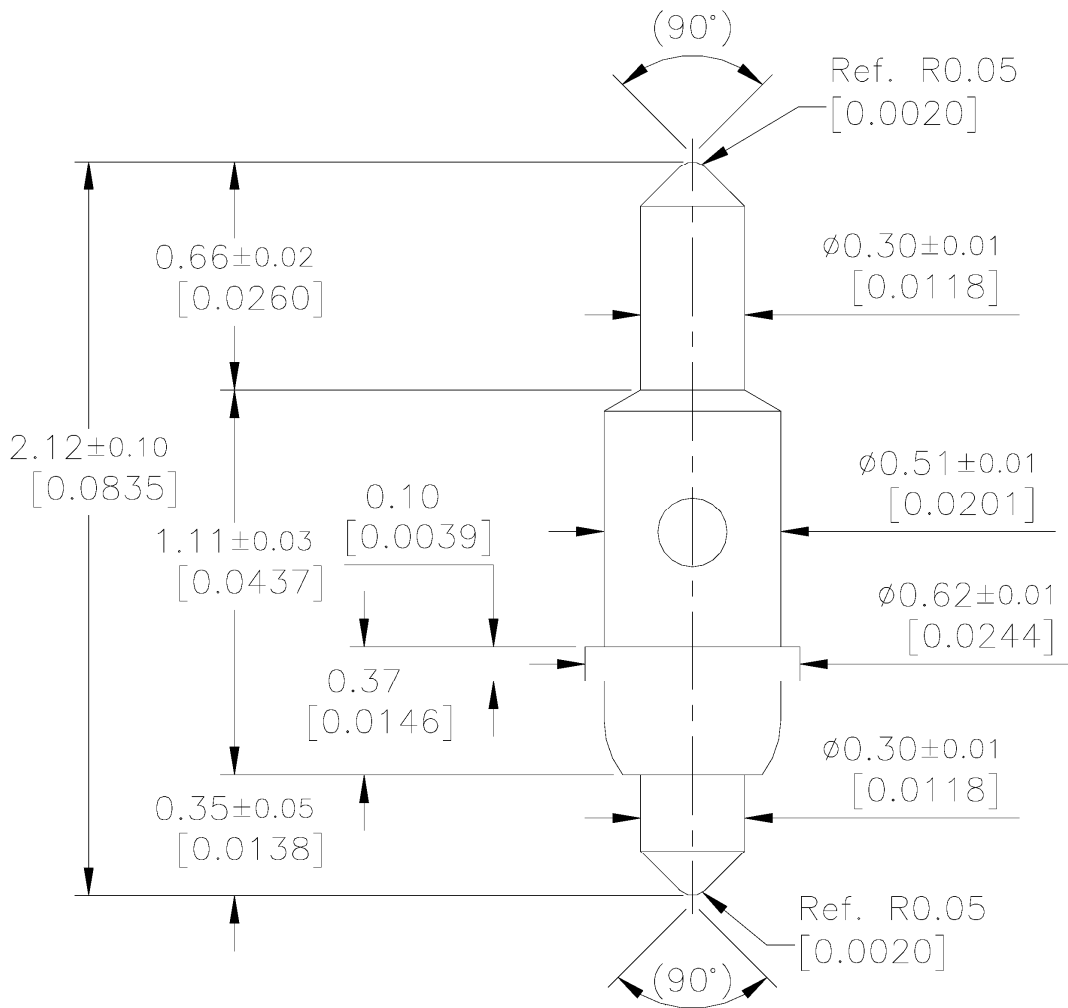

BOTTOM

Pointing accuracy : ± 0.06 mm

Spring force [±20%]

12.9g(0.455oz) at initial travel

30.0g(1.058oz) at 0.23mm(0.0091) recommended travel

36.0g(1.270oz) at 0.31mm(0.0122) full travel

Material & Finish

Barrel (Top)	Hardened Beryllium copper	/ Gold Plated
Plunger (Bottom)	Hardened Beryllium copper	/ Gold Plated
Spring	Music Wire	/ Gold Plated

NOTICE: Must be reflected in a socket design.

When this probe is set in a socket, it is very important to verify the actual working travel due to the difference of 0.08mm between the recommended and full travel. In case the actual working travel is over 0.23mm, the device, spring, plunger, and/or PCB pad will be damaged.

ALL DIMENSIONS ARE IN MILLIMETERS UNLESS OTHERWISE SPECIFIED



EMULATION TECHNOLOGY, INC.

VLSI and SMT ADAPTERS and ACCESSORIES

759 FLYNN ROAD
CAMARILLO, CA 93012

TEL: (805) 383-8480
FAX: (805) 383-8484

SHEET: 1 OF 1	DATE: 11/02/09	REVISION: A	ASSEMBLY DRAWING
CHECKED:	PREPARED BY: J. GELACIO	ITEM: POGO-PIN-2.12-1	
DO NOT SCALE DRAWING			DESCRIPTION: POGO-PIN-2.12-1

Unit : Millimeter[inch]