



Power a Safe and Green world
with ECU products



LED Driver

Plastic Case

Metal Case

Power Supply For High Bay Light

Mounted Power Supply

2016

 400-665-9997

About ECU



ECU Electronics Industrial Co. Ltd (ECU) has been committed to providing integrated professional power solutions since its establishment in 1992, focusing on research, manufacturing and marketing of power supply products. ECU has an outstanding partnership with many world's top 500 companies by virtue of its core power technology and creative professional team and enjoys a high profile and reputation in the industry. The products manufactured are exported worldwide, e.g. USA, Europe, Australia, etc.

ECU has two major research and development bases and has successively established an academician workstation and a postdoctoral workstation. Meanwhile, ECU has close cooperation with universities and scientific institutions, such as Nanjing University of Aeronautics & Astronautics and National Academy of Sciences. Moreover, ECU has standardized workshop, operation process and material management system and it also has a National Third Party Monitoring Laboratory. ECU has been devoting itself to switching power supply and LED driver products. The LED driver is widely applied indoors and outdoors and favored by the clients for its low ripples, high efficiency, and long life span. ECU will be committed to building a professional international brand and becoming an international leading supplier of power supply by adhering to its core values "Excellent, Creative, United".

Company Ability



R&D Capability
Rapid Response to
Customer Requirement



Quality Control
National Third Party
Monitoring Laboratory



Production guarantee

Ten Component Insertion Lines
Five SMT lines
Two AI lines



Qualification & Certification

1992-2006

- National High-tech Enterprise
- Integration Management System Certification

2007-2008

- China's Electronic Components Top 100
- Excellent Enterprise Technology Center
- Production-teaching-research Integration Model Enterprise

2009-2010

- Academician Workstation
- Integration of Informatization and Industrialization Model Enterprise
- Power Electronic Engineering Research Center

2011-2016

- Post-doctoral Workstation
- National Major New Product
- Giant Foster Enterprise
- Science and Technology Progress Award by CPSS
- National Technology Center

Contents

PLASTIC CASE

EPF Series	
30W / 35W / 40W	02
Non-flickering; No load power consumption <0.5W; Set up time <0.5s; Screw terminal; IP60; PFC function	
EPE(F) Series	
30W / 35W / 40W	03
Non-flickering; No load power consumption <0.5W; Set up time <0.5s; Lead type; IP60; PFC function	
EPT Series	
30W / 40W	04
Low profile: 20mm; Screw terminal; IP60; PFC function	
EPC Series	
20W / 35W / 42W	05
Screw terminal; IP60; PFC function	
EPC Series	
30W	06
Screw terminal; IP60; PFC function	
EPE Series	
25W / 35W	07
Lead type; IP60; PFC function	
ETD Series	
15W / 25W	08
Triac dimming; Screw terminal; IP60; PFC function	
EQP/ELP Series	
14W / 18W / 21W / 30W / 40W / 50W	09~10
Small size; Lead type; IP66; PFC function	
EQP(C) Series	
15W / 20W	11
No load power consumption <0.5W; Set up time <0.5s; IP66; PFC function	
ERP Series	
20W / 30W	12
Circular plastic case; IP66	

METAL CASE

EPH Series	
60W / 85W / 100W / 120W / 150W / 180W / 200W / 600W	13~17
CC/CV; 3 in 1 dimming; Timer dimming; Out voltage and current adjustable; Wide range DC output; IP65 or IP67; Non-flickering; PFC function	
EWE Series	
100W / 120W / 150W	18~19
Small size; Economical; No load power consumption <0.5W; 3 in 1 dimming; PFC function; Wide range DC output	
EWS Series	
150W	20
No load power consumption <0.5W; 1-10V dimming; Intelligent constant power	
EWP Series	
30W / 50W / 75W / 100W / 120W / 150W	21~24
Multi-output selectable; IP67; PFC function	
EDH Series	
30W / 60W / 100W	25
Used for solar street light; High efficiency; Wide range DC output; IP67	

POWER SUPPLY FOR HIGH BAY LIGHT

EOP Series	
100W / 150W	26~27
Circular Open-frame power; High efficiency; PFC function; 3 in 1 dimming; Used for High Bay light	

MOUNTED POWER SUPPLY

ESF Series	
75W / 100W / 150W / 200W	28
Built-in remote ON/OFF control; Suitable for LED sign panel; PFC function	
EEP Series	
60W / 80W / 100W	28
Suitable for LED sign panel; PFC function	
EPR Series	
15W / 25W / 35W / 50W / 75W / 100W / 150W	28
Suitable for LED sign panel	

Surge protective device ESPD	29
-------------------------------------	----

■ New announced product for sale



ISO14001 OHSAS18001

ISO9001 GJB9001

Welcome to contact us for more certification information.

Non-flickering 30W-40W

EPF-30 / EPF-35 / EPF-40 Series single output with PFC / low-ripple function

Features

- Universal input.
- Protections: Short circuit, OLP, OVP, OTP.
- Low ripple: Current ripple <5%, Voltage ripple <1%.
- No load power consumption <0.5W; Set up time <0.5s.
- Built-in active PFC function. PF≥0.95 for 100% load.
- Waterproof: IP60.
- Suitable for LED lighting and moving sign applications.
- UL1310 Class 2 (<60Vdc).
- Cooling by free air convection.
- 3 years warranty.



Specifications

Input Voltage 90Vac~277Vac
 Input Frequency 47Hz~63Hz
 Input Current 0.6A max
 Inrush Current 30A max (Cold start)
 Set Up Time 0.5s max at nominal line
 Constant Current Precision ± 5% max
 Dielectric Withstand I/P-O/P: 3750Vac, I/P-FG: 1875Vac
 Operating Temperature -35°C~+70°C
 Derating linearly from 100% load at 60°C to 80% load at 70°C
 Storage Temperature -40°C~+85°C
 Protections Short circuit, OLP, OVP, OTP
 Over Current Protections 95%~105% constant current, auto-recovery mode
 Safety Standard UL8750, UL1310 Class 2, EN61347-1, EN61347-2-13, UL1012
 EMC Standard EN55015, EN61000-3-2, 3, EN61000-4-2, 3, 4, 5, 6, 8, 11, EN61547
 Input / Output Terminal 2+2P block

Mechanical Drawing

Product weight: 0.2kg
 Product outline: 138mm × 44mm × 27.5mm

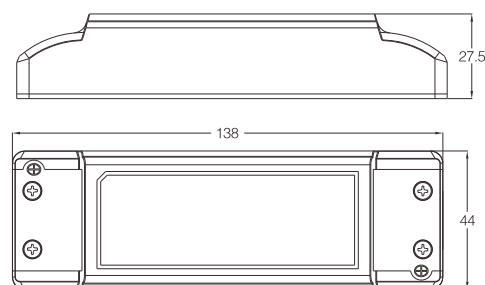

Model List

Model No.	Output voltage range (Vdc)	Output max current (A)	R&N (Max) (mV)	Eff.(%)	Max Watt (W)	PF (Typ.)
EPF-30-350mA	56~85	0.35	600	87	30	0.95
EPF-30-500mA	40~60	0.50	500	86.5	30	0.95
EPF-30-700mA	28~42	0.70	450	86	30	0.95
EPF-30-1.05A	18~28	1.05	300	86	30	0.95
EPF-30-1.4A	14~21	1.40	250	86	30	0.95
EPF-35-350mA	65~100	0.35	550	87	35	0.95
EPF-35-500mA	45~70	0.50	500	87	35	0.95
EPF-35-700mA	33~50	0.70	450	86	35	0.95
EPF-35-1.05A	21~33	1.05	350	86	35	0.95
EPF-35-1.4A	16~25	1.40	250	86	35	0.95
EPF-35-1.75A	13~20	1.75	250	86	35	0.95
EPF-40-500mA	48~80	0.50	500	87	40	0.95
EPF-40-700mA	36~56	0.70	450	87	40	0.95
EPF-40-1.05A	25~38	1.05	350	86.5	40	0.95
EPF-40-1.4A	20~30	1.40	300	86	40	0.95
EPF-40-1.75A	15~24	1.75	250	86	40	0.95

Non-flickering Lead Type 30W-40W



EPE(F)-30 / EPE(F)-35 / EPE(F)-40 Series single output with PFC / low-ripple function

Features

- Universal input.
- Protections: Short circuit, OLP, OVP, OTP.
- Built-in active PFC function. $PF \geq 0.92$ for 100% load.
- Low ripple: Current ripple $<5\%$, Voltage ripple $<1\%$.
- No load power consumption $<0.5W$; Set up time $<0.5s$.
- Waterproof: IP60.
- Suitable for LED lighting and moving sign applications.
- UL1310 Class 2 ($<60Vdc$).
- Cooling by free air convection.
- 3 years warranty.



Specifications

Input Voltage	90Vac~264Vac
Input Frequency	47Hz~63Hz
Input Current	0.6A max
Inrush Current	30A max (Cold start)
Set Up Time	0.5s max at nominal line
Constant Current Precision	$\pm 5\%$ max
Dielectric Withstand	I/P-O/P: 3750Vac, I/P-FG: 1875Vac
Operating Temperature	$-35^{\circ}C \sim +60^{\circ}C$
Derating linearly from 100% load at $50^{\circ}C$ to 80% load at $60^{\circ}C$	
Storage Temperature	$-40^{\circ}C \sim +85^{\circ}C$
Protections	Short circuit, OLP, OVP, OTP
Over Current Protections	95%~105% constant current, auto-recovery mode
Safety Standard	UL8750, UL1310 Class 2, EN61347-1, EN61347-2-13, UL1012
EMC Standard	EN55015, EN61000-3-2, 3, EN61000-4-2, 3, 4, 5, 6, 8, 11, EN61547
Input / Output Terminal	PVC line, $\Phi 6mm$, H03VV-F, $2 \times 0.75mm^2$, L105mm, line card, brown, blue, VDE PVC line, $\Phi 6mm$, H03VV-F, $2 \times 0.75mm^2$, L105mm, line card, red, black, VDE

Mechanical Drawing

Product weight: 0.2kg
Product outline: 145mm \times 46.8mm \times 31mm

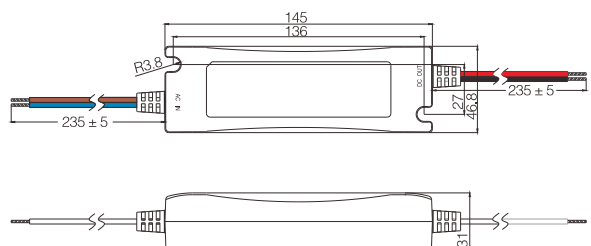

IECU | PLASTIC CASE

Model List

Model No.	Output voltage range (Vdc)	Output max current (A)	R&N (Max) (mV)	Eff.(%)	Max Watt (W)	PF (Typ.)
EPE(F)-30-350mA	56~85	0.35	600	87	30	0.95
EPE(F)-30-500mA	40~60	0.50	500	86	30	0.95
EPE(F)-30-700mA	28~42	0.70	450	86	30	0.95
EPE(F)-30-1.05A	18~28	1.05	300	86	30	0.95
EPE(F)-30-1.4A	14~21	1.40	250	86	30	0.95
EPE(F)-35-350mA	65~100	0.35	550	87	35	0.95
EPE(F)-35-500mA	45~70	0.50	500	87	35	0.95
EPE(F)-35-700mA	33~50	0.70	450	86	35	0.95
EPE(F)-35-1.05A	21~33	1.05	350	86	35	0.95
EPE(F)-35-1.4A	16~25	1.40	250	86	35	0.95
EPE(F)-35-1.75A	13~20	1.75	250	86	35	0.95
EPE(F)-40-500mA	48~80	0.50	500	87	40	0.95
EPE(F)-40-700mA	36~56	0.70	450	87	40	0.95
EPE(F)-40-1.05A	25~38	1.05	350	86	40	0.95
EPE(F)-40-1.4A	20~30	1.40	300	86	40	0.95
EPE(F)-40-1.75A	15~24	1.75	250	86	40	0.95

Non-flickering Ultra-thin 30W-40W

EPT-30 / EPT-40 Series Low-Ripple/Low no-load losses/Quick start-up/Ultra-thin/Single output with PFC function

Features

Universal input.
Protections: Short Circuit, OLP, OVP, OTP.
Built-in active PFC function. PF \geq 0.92 for 100% load.
No load power consumption <0.5W; Set up time <0.5s.
Waterproof: IP60.
Suitable for LED lighting and moving sign applications.
UL1310 Class 2 (<60Vdc).
Cooling by free air convection.
3 years warranty.

Specifications

Input Voltage 90Vac~277Vac
Input Frequency 47Hz~63Hz
Input Current 0.6A max
Inrush Current 30A max (Cold start)
Set Up Time 0.5s max at nominal line
Constant Current Precision $\pm 5\%$ max
Dielectric Withstand I/P-O/P: 3750Vac, I/P-FG: 1875Vac
Operating Temperature -35°C~+70°C
Derating linearly from 100% load at 60°C to 80% load at 70°C
Storage Temperature -40°C~+85°C
Protections Short circuit, OLP, OVP, OTP
Over Current Protections 95%~105% constant current, auto-recovery mode
Safety Standard UL8750, UL1310 Class 2, EN61347-1, EN61347-2-13, UL1012
EMC Standard EN55015, EN61000-3-2, 3, EN61000-4-2, 3, 4, 5, 6, 8, 11, EN61547
Input / Output Terminal 2 Poles screw terminal block

Mechanical Drawing

Product weight: 0.2kg
Product outline: 140mm \times 59.5mm \times 18.5mm

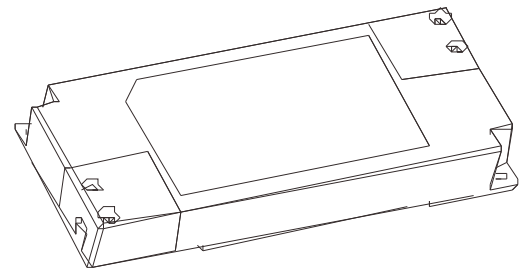
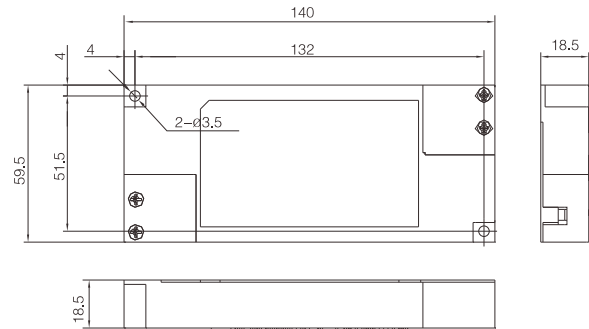

Model List

Model No.	Output voltage range (Vdc)	Output max current (A)	R&N (Max) (mV)	Eff.(%)	Max Watt (W)	PF (Typ.)
EPT-35-350mA	65~100	0.35	550	87	35	0.95
EPT-40-700mA	36~56	0.70	450	87	40	0.95
EPT-40-1.05A	25~38	1.05	350	86.5	40	0.95

ECU devotes to service our customers with power supplies and solutions of high efficiency and high reliability. If our catalog products cannot meet your requirements, please contact our sales for more information. ■

Screw Terminal 20W-42W



EPC-20 / EPC-35 / EPC-42 Series single output with PFC function

Features

- Universal input.
- Protections: Short circuit, OLP, OVP.
- Built-in active PFC function. $PF \geq 0.92$ for 100% load.
- Waterproof: IP60.
- Suitable for LED lighting and moving sign applications.
- UL1310 Class 2 (Except > 60Vdc).
- Cooling by free air convection.
- 3 years warranty.



Specifications

Input Voltage	90Vac~264Vac (42W: 180Vac~277Vac)
Input Frequency	47Hz~63Hz
Input Current	0.6A max
Inrush Current	30A max (Cold start)
Set Up Time	2s max at nominal line
Constant Current Precision	$\pm 5\%$ max
Dielectric Withstand	I/P-O/P: 3750Vac
Operating Temperature	$-35^{\circ}\text{C} \sim +70^{\circ}\text{C}$
Derating linearly from 100% load at 50°C to 80% load at 70°C	
Storage Temperature	$-40^{\circ}\text{C} \sim +85^{\circ}\text{C}$
Protections	Short circuit, OLP, OVP
Over Current Protections	95%~105% constant current, auto-recovery mode
Safety Standard	UL8750, UL1310 Class 2, EN61347-1, EN61347-2-13, UL1012, UL60950
EMC Standard	EN55015, EN61000-3-2, 3, EN61000-4-2, 3, 4, 5, 6, 8, 11, EN61547

Mechanical Drawing

EPC-20W	EPC-35W/42W
Product weight: 0.1kg	Product weight: 0.2kg
Product outline:	Product outline:
115mm × 45mm × 27.5mm	138mm × 44mm × 27.5mm

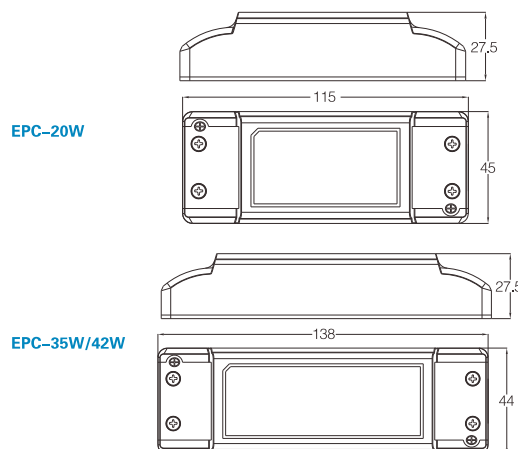

Model List

Model No.	Output voltage range (Vdc)	Output max current (A)	R&N (Max) (V)	Eff.(%)	Max Watt (W)	PF (Typ.)
EPC-20-350mA	42~60	0.35	4.0	88.4	21	0.92
EPC-20-450mA	33~48	0.45	3.5	88	21.6	0.92
EPC-20-700mA	21~30	0.70	2.0	87	21	0.92
EPC-20-1.05A	14~20	1.05	2.0	85	21	0.92
EPC-35-350mA	65~100	0.35	6.0	89	35	0.92
EPC-35-500mA	46~70	0.50	5.0	89	35	0.92
EPC-35-700mA	33~50	0.70	4.0	88	35	0.92
EPC-35-1.05A	21~33	1.05	3.0	87	35	0.92
EPC-35-1.4A	16~25	1.40	3.0	86	35	0.92
EPC-42-350mA	78~120	0.35	8.0	89	42	0.92
EPC-42-500mA	55~84	0.50	6.0	89	42	0.92
EPC-42-700mA	40~60	0.70	5.0	88	42	0.92
EPC-42-1.05A	26~40	1.05	4.0	87	42	0.92
EPC-42-1.4A	20~30	1.40	3.0	86	42	0.92

Screw Terminal Constant Voltage 30W

EPC-30 Series single output with PFC function / Low no-load consumption / Quick start-up

□ Features

Universal input.
Protections: Short circuit, OLP, OPP.
Built-in active PFC function, PF>0.95 for 100% load.
No load power consumption <0.5W; Set up time <0.5s.
Suitable for LED lighting and moving sign applications.
Cooling by free air convection.
3 years warranty.



□ Specifications

Input Voltage 90Vac~264Vac
Input Frequency 47Hz~63Hz
Input Current 0.6A max
Inrush Current 30A max (Cold start)
Set Up Time 0.5s max at nominal line
Constant Current Precision $\pm 5\%$ max
Dielectric Withstand I/P-O/P: 3750Vac
Operating Temperature $-35^{\circ}\text{C}\sim+70^{\circ}\text{C}$
Derating linearly from 100% load at 60°C to 80% load at 70°C
Storage Temperature $-40^{\circ}\text{C}\sim+85^{\circ}\text{C}$
Protections Short circuit, OLP, OVP
Over Current Protections 130%–150% constant current,
auto-recovery mode
Safety Standard UL8750, UL1310 Class 2, EN61347-1,
EN61347-2-13, UL1012, UL60950
EMC Standard EN55015, EN61000-3-2,3,
EN61000-4-2, 3, 4, 5, 6, 8, 11, EN61547

□ Mechanical Drawing

Product weight: 0.2kg
Product outline: 140mm × 45mm × 27.5mm

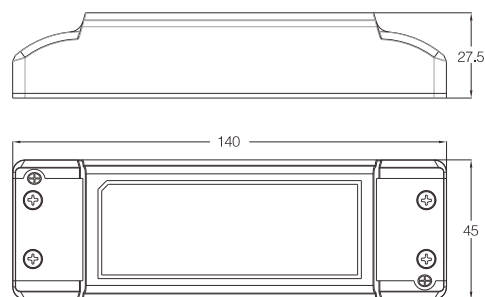

□ Model List

Model No.	Output voltage range (Vdc)	Output max current (A)	R&N (Max) (V)	Eff.(%)	Max Watt (W)	PF (Typ.)
EPC-30-12V	12	2.5	4.0	83	30	0.95
EPC-30-24V	24	1.25	4.0	90	30	0.95
EPC-30-36V	36	0.83	4.0	90	30	0.95
EPC-30-48V	48	0.625	4.0	90	30	0.95

ECU also offers customizing power supplies according to different industries specific demands. We welcome your communicate with our engineers to provide you with the most suitable solution.

Lead Type 25W-35W



EPE-25 / EPE-35 Series single output with PFC function

Features

- Universal input.
- Protections: Short circuit, OLP, OTP, OVP.
- Built-in active PFC function, PF>0.95 for 100% load.
- Waterproof: IP60.
- Suitable for LED lighting and moving sign applications.
- UL1310 Class 2 power unit (Except >60Vdc).
- Cooling by free air convection.
- 3 years warranty.



Specifications

- Input Voltage 90Vac ~ 277Vac
- Input Frequency 47Hz ~ 63Hz
- Input Current 0.6A max
- Inrush Current 20A max (Cold start)
- Set Up Time 2s max at nominal line
- Constant Current Precision $\pm 5\%$ max
- Dielectric Withstand I/P-O/P: 3750Vac, I/P-FG: 1875Vac
- Operating Temperature -35°C to $+70^{\circ}\text{C}$
- Derating linearly from 100% load at 60°C to 80% load at 70°C
- Storage Temperature -40°C to $+85^{\circ}\text{C}$
- Protections Short circuit, OLP, OVP, OTP
- Over Current Protections 95%–105% constant current, auto-recovery mode.
- Safety Standard UL8750, UL1310 Class 2, EN61347-1, EN61347-2-13, UL1012
- EMC Standard EN55015, EN61000-3-2, 3, EN61000-4-2, 3, 4, 5, 6, 8, 11, EN61547
- Standard output cable UL Rated, 18–16#AWG

Mechanical Drawing

- Product weight: 0.2kg
- Product outline: 145mm \times 46.8mm \times 31mm

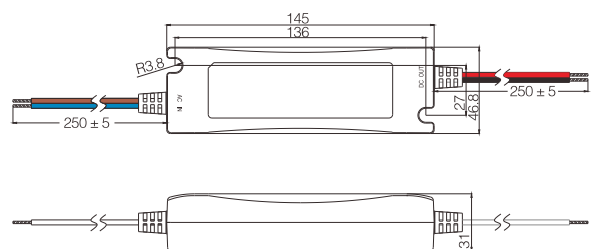

IECU | PLASTIC CASE

Model List

Model No.	Output voltage range (Vdc)	Output max current (A)	R&N (Max) (V)	Eff.(%)	Max Watt (W)	PF (Typ.)
EPE-25-350mA	48~72	0.35	5.0	87	25	0.95
EPE-25-500mA	33~51	0.50	3.0	86	25	0.95
EPE-25-700mA	24~36	0.70	3.0	85	25	0.95
EPE-25-1.05A	15~24	1.05	2.5	84	25	0.95
EPE-25-1.4A	11~18	1.40	2.5	84	25	0.95
EPE-35-350mA	65~100	0.35	6.0	89	35	0.95
EPE-35-500mA	48~72	0.50	5.0	89	36	0.95
EPE-35-700mA	33~51	0.70	4.0	87.5	35	0.95
EPE-35-1.05A	21~33	1.05	3.0	86.5	35	0.95
EPE-35-1.4A	15~24	1.40	2.0	85	34	0.95
EPE-35-1.75A	13~20	1.75	2.0	84	35	0.95

Triac Dimming 15W-25W

ETD-15 / ETD-25 Series single output with PFC and triac dimming function

Features

Input voltage: 115Vac (90~135Vac) or 230Vac (180~240Vac).
 Protections: Short circuit, OLP, OVP, OTP.
 Built-in active PFC function. PF \geq 0.92 for 100% load.
Triac dimming.
 Waterproof: IP60.
 Suitable for LED lighting and moving sign applications.
 UL1310 Class 2 (<60Vdc).
 Cooling by free air convection.
 3 years warranty.



Specifications

Input Voltage 115Vac (90~135Vac) or 230Vac (180~240Vac)
 Input Frequency 47Hz~63Hz
 Input Current 0.5A max
 Inrush Current 30A max, 230Vac (Cold start)
 Set Up Time 2s max at nominal line
 Constant Current Precision $\pm 5\%$ max
 Dielectric Withstand I/P-O/P: 3750Vac, I/P-FG: 1875Vac
 Operating Temperature $-35^{\circ}\text{C}\sim+60^{\circ}\text{C}$
 Derating linearly from 100% load at 60°C to 80% load at 70°C
 Storage Temperature $-40^{\circ}\text{C}\sim+85^{\circ}\text{C}$
 Protections Short circuit, OLP, OVP, OTP
 Over Current Protections 95%~110% constant current, auto-recovery mode.
 Safety Standard UL8750, UL1310 Class 2, EN61347-1, EN61347-2-13, UL1012
 EMC Standard EN55015, EN61000-3-2, 3, EN61000-4-2, 3, 4, 5, 6, 8, 11, EN61547
 Input / Output Terminal 2+2P block

Mechanical Drawing

Product weight: 0.2kg
 Product outline: 138mm \times 44mm \times 27.5mm

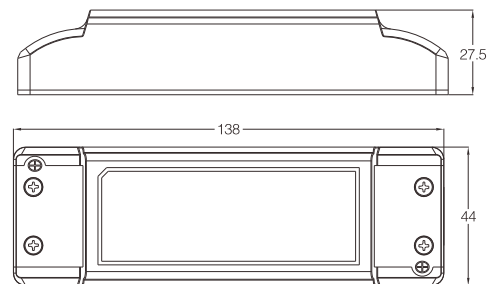

Model List

Model No.	Output voltage range (Vdc)	Output max current (A)	R&N (Max) (V)	Eff.(%)	Max Watt (W)
ETD-15-350mA	28~43	0.35	4.0	81	15
ETD-15-500mA	20~30	0.50	3.0	81	15
ETD-15-700mA	14~22	0.70	2.5	80.5	15
ETD-15-1.05A	9~14	1.05	2.2	80	15
ETD-15-1.4A	7~11	1.40	2.0	80	15
ETD-25-350mA	45~70	0.35	6.0	82	25
ETD-25-500mA	33~50	0.50	4.5	82	25
ETD-25-700mA	24~36	0.70	3.6	81	25
ETD-25-1.05A	16~24	1.05	2.4	80.5	25
ETD-25-1.4A	12~18	1.40	2.5	80	25

Small Size Constant Current 14W-21W



EQP / ELP-14 / 18 / 21 Series single output with PFC function

Features

- Universal input.
- Protections: Short circuit, OLP, OVP.
- Built-in active PFC function. PF>0.9 for 100% load.
- Waterproof: IP66.
- Suitable for LED lighting and moving sign applications.
- UL1310 Class 2 power unit.
- Cooling by free air convection.
- 3 years warranty.

Specifications

Input Voltage	90Vac ~ 264Vac
Input Frequency	47Hz ~ 63Hz
Input Current	0.4A max
Inrush Current	20A max (Cold start)
Set Up Time	2s max at nominal line
Constant Current Precision	± 5% max
Dielectric Withstand	I/P-O/P: 3750Vac, I/P-FG: 1875Vac
Operating Temperature	- 35°C to + 70°C
Derating linearly from 100% load at 60°C to 80% load at 70°C	
Storage Temperature	- 40°C to + 85°C
Protections	Short circuit, OLP, OVP
Over Current Protections	95%~105% constant current, auto-recovery mode.
Safety Standard	UL8750, UL1310 Class 2, EN61347-1, EN61347-2-13, UL1012; IP67
EMC Standard	EN55015, EN61000-3-2, 3, EN61000-4-2, 3, 4, 5, 6, 8, 11, EN61547
Standard output cable	UL Rated, 18-16#AWG

EQP



Mechanical Drawing

Product weight: 0.15kg
Product outline: 87mm × 43.6mm × 27.3mm

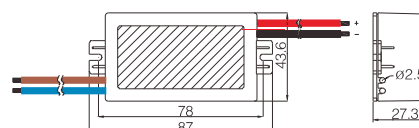

ELP



Mechanical Drawing

Product weight: 0.18kg
Product outline: 120mm × 36mm × 26mm

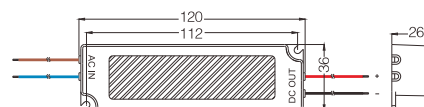

Model List

Model No.	Output voltage range (Vdc)	Output max current (mA)	R&N (Max) (V)	Eff.(%)	Max Watt (W)	PF (Typ.)
EQP/ELP-14-300mA	35~48	300	4.0	86	14	0.90
EQP/ELP-14-350mA	25~36	350	3.0	85	13	0.90
EQP/ELP-14-500mA	18~28	500	2.5	85	14	0.90
EQP/ELP-14-700mA	16~20	700	2.0	84	14	0.90
EQP/ELP-18-500mA	25~36	500	3.0	85	18	0.92
EQP/ELP-21-700mA	18~30	700	2.5	84	21	0.92

Lead Type Constant Current 30W-50W

ELP-30 / ELP-40 / ELP-50 Series single output with PFC function / Low no-load losses / Quick start-up

Features

- Universal input.
- Protections: Short circuit, OLP, OVP, OTP.
- Built-in active PFC function. $PF \geq 0.92$ for 100% load.
- No load power consumption <0.5W; Set up time <0.5s.**
- Waterproof: IP65.
- Suitable for LED lighting and moving sign applications.
- UL1310 Class 2 (<60Vdc).
- Cooling by free air convection.
- 3 years warranty.



Specifications

- Input Voltage 90Vac~264Vac
- Input Frequency 47Hz~63Hz
- Input Current 0.8A max
- Inrush Current 50A max, 230Vac (Cold start)
- Set Up Time 500ms max at nominal line
- Constant Current Precision $\pm 5\%$ max
- Dielectric Withstand I/P-O/P: 3750Vac
- Operating Temperature $-35^{\circ}\text{C} \sim +60^{\circ}\text{C}$
- Derating linearly from 100% load at 50°C to 80% load at 60°C
- Storage Temperature $-40^{\circ}\text{C} \sim +85^{\circ}\text{C}$
- Protections Short circuit, OLP, OVP
- Over Current Protections 95%~105% constant current, auto-recovery mode
- Safety Standard UL8750, UL1310 Class 2, EN61347-1, EN61347-2-13, UL1012, UL60950
- EMC Standard EN55015, IEC61000-3-2,3, EN61000-4-2, 3, 4, 5, 6, 8, 11, EN61547

Mechanical Drawing

- Product weight: 0.25kg
- Product outline: 168mm \times 42mm \times 33mm

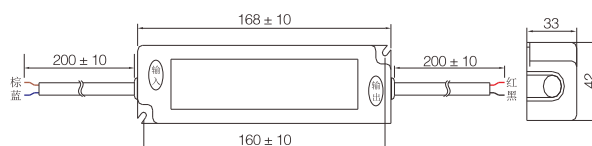

Model List

Model No.	Output voltage range (Vdc)	Output max current (A)	R&N (Max) (V)	Eff.(%)	Max Watt (W)	PF (Typ.)
ELP-30-350mA	63~90	0.35	7.0	88	30	0.92
ELP-30-500mA	36~60	0.50	5.5	88	30	0.92
ELP-30-700mA	30~48	0.70	4.0	87	30	0.92
ELP-30-1.05A	18~30	1.05	3.0	87	30	0.92
ELP-30-1.40A	15~24	1.40	2.5	86	30	0.92
ELP-30-1.75A	12~18	1.75	2.5	85	30	0.92
ELP-40-350mA	75~115	0.35	10.0	88	50	0.92
ELP-40-500mA	52~80	0.50	7.0	88	50	0.92
ELP-40-700mA	38~58	0.70	5.0	88	50	0.92
ELP-40-1.05A	26~38	1.05	4.0	87	50	0.92
ELP-40-1.4A	18~28	1.40	3.0	86	50	0.92
ELP-50-350mA	135~155	0.35	13.5	88	50	0.92
ELP-50-500mA	65~100	0.50	5.0	88	50	0.92
ELP-50-700mA	45~72	0.70	5.0	88	50	0.92
ELP-50-1.05A	30~48	1.05	4.0	87	50	0.92
ELP-50-1.4A	20~36	1.40	3.0	86	50	0.92
ELP-50-1.75A	18~30	1.75	3.0	86	52	0.92
ELP-50-2.1A	15~24	2.10	3.0	86	50	0.92
ELP-50-2.4A	13~20	2.40	3.0	85	50	0.92

Lead Type Constant Current 15W-20W

EQP(C)-15 / EQP(C)-20 Series single output with PFC function and accord with ErP standard

□ Features

Universal input.
 Protections: Short circuit, OLP, OVP.
 Built-in active PFC function. $PF \geq 0.92$ for 100% load.
No load power consumption <0.5W; Set up time <0.5s.
 Waterproof: IP66.
 Suitable for LED lighting and moving sign applications.
 UL1310 Class 2.
 Cooling by free air convection.
 3 years warranty.



□ Specifications

Input Voltage 90Vac~264Vac
 Input Frequency 47Hz~63Hz
 Input Current 0.4A max
 Inrush Current 30A max (Cold start)
 Set Up Time 500ms max at all line
 Constant Current Precision $\pm 5\%$ max
 No Load Dissipation 0.5W max at all line
 Dielectric Withstand I/P-O/P: 3750Vac
 Operating Temperature $-35^{\circ}\text{C} \sim +60^{\circ}\text{C}$
 Derating linearly from 100% load at 50°C to 80% load at 60°C
 Storage Temperature $-40^{\circ}\text{C} \sim +85^{\circ}\text{C}$
 Protections Short circuit, OLP, OVP
 Over Current Protections 95%–105% constant current,
 auto-recovery mode
 Safety Standard UL8750, UL1310 Class 2, EN61347-1,
 EN61347-2-13, UL1012, UL60950
 EMC Standard EN55015, IEC61000-3-2,3,
 EN61000-4-2, 3, 4, 5, 6, 8, 11, EN61547

□ Mechanical Drawing

Product weight: 0.2kg
 Product outline: 87mm × 42mm × 27.3mm

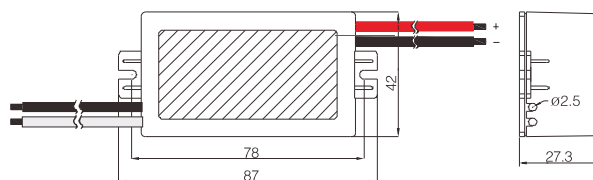

□ Model List

Model No.	Output voltage range (Vdc)	Output max current (A)	R&N (Max)	Eff.(%)	Max Watt (W)	PF (Typ.)
EQP(C)-15-350mA	27~42	0.35	4	85	15	0.92
EQP(C)-15-450mA	21~33	0.45	3	84	15	0.92
EQP(C)-15-700mA	14~21	0.70	2	83	15	0.92
EQP(C)-20-350mA	42~60	0.35	5	87	21	0.92
EQP(C)-20-450mA	33~48	0.45	4	86	21.6	0.92
EQP(C)-20-700mA	21~30	0.70	3	84	21.6	0.92

Circular Constant Current 20W-30W

ERP-20 / ERP-30 Series single output with PFC function

Features

- Universal input.
- Protections: Short circuit, OLP, OVP.
- Built-in active PFC function, $PF \geq 0.92$ for 100% load.
- Waterproof: IP66.
- Suitable for LED lighting and moving sign applications.
- UL1310 Class 2 (<60Vdc).
- Cooling by free air convection.
- 3 years warranty.



Specifications

Input Voltage	90Vac~264Vac
Input Frequency	47Hz~63Hz
Input Current	0.5A max
Inrush Current	30A max (Cold start)
Set Up Time	2s max at all line
Constant Current Precision	± 5% max
Dielectric Withstand	I/P-O/P: 3750Vac
Operating Temperature	-35°C~+70°C
Derating linearly from 100% load at 60°C to 80% load at 60°C	
Storage Temperature	-40°C~+85°C
Protections	Short circuit, OLP, OVP
Over Current Protections	95%~105% constant current, auto-recovery mode
Safety Standard	UL8750, UL1310 Class 2, EN61347-1, EN61347-2-13, UL1012, UL60950
EMC Standard	EN55015, IEC61000-3-2,3, EN61000-4-2, 3, 4, 5, 6, 8, 11, EN61547

Mechanical Drawing

Product weight: 0.2kg
Product outline: 79.8mm × 78mm × 25mm

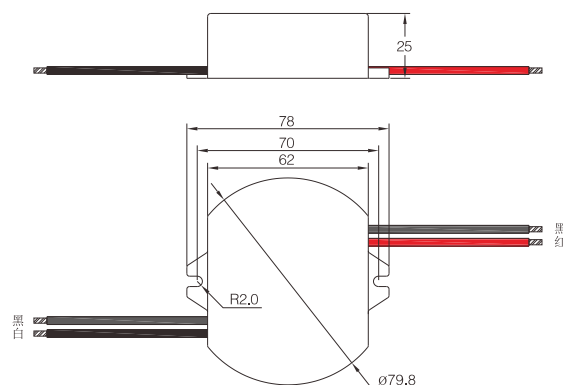

Model List

Model No.	Output voltage range (Vdc)	Output max current (A)	R&N (Max) (V)	Eff. (%)	Max Watt (W)	PF (Typ.)
ERP-20-350mA	37~57	0.35	5.0	85	20	0.92
ERP-20-700mA	18~28	0.7	3.0	84	20	0.92
ERP-30-350mA	56~86	0.35	8.0	85	30	0.92
ERP-30-700mA	27~42	0.7	4.0	85	30	0.92

From July, 2006 ECU upgraded its producing lines to be lead-free. You can use any of them with assurance that our power supplies are 100% ROHS compliant. ■

Intelligent High-power 60W-85W



EWH-60 / EWH-85 Series CC / CV / Output current and voltage adjustable / 3 in 1 dimming / Timer dimming

Features

- Wide range input voltage: 90Vac~305Vac.
- Protections: Short circuit, OLP, OTP, OVP.
- High Efficiency up to 90%.
- High reliability: 105°C capacitor.**
- Built-in active PFC function. PF \geq 0.95 for 100% load.
- Non-flickering: Current ripple <5%, Voltage ripple <1%.**
- Multi-function dimming selectable.**
- Wide range DC output.
- Suitable for LED lighting and moving sign applications.
- Waterproof: IP65 or IP67.
- Cooling by free air convection.
- 5 years warranty.

Specifications

Input Voltage	90Vac~305Vac
Input Frequency	47Hz~63Hz
Input Current	1.2A max
Inrush Current	70A max, 230Vac (Cold start)
Set Up Time	2s max at nominal line
Constant Current Precision	$\pm 5\%$ max
Dielectric Withstand	I/P-O/P: 3750Vac, I/P-FG: 1875Vac
Operating Temperature	-35°C~+70°C
Derating linearly from 100% load at 60°C to 80% load at 70°C	
Storage Temperature	-40°C~+85°C
Protections	Short circuit, OLP, OVP, OTP
Over Current Protections	95%~105% constant current, auto-recovery mode.
Safety Standard	UL8750, UL1310 Class 2, EN61347-1, EN61347-2-13, UL1012, UL60950
EMC Standard	EN55015, EN61000-3-2, 3, EN61000-4-2, 3, 4, 5, 6, 8, 11, EN61547
Standard output cable	UL Rated, 18-16#AWG

Model List

Model No.	Output voltage range (Vdc)	Output max current (A)	R&N (Max) (mV)	Eff.(%)	Max Watt (W)	PF (Typ.)
EWH□-60-350mA	110-170	0.35	700	90.0	59.5	0.95
EWH□-60-500mA	80-120	0.50	550	90.0	60	0.95
EWH□-60-700mA	52-90	0.70	450	90.0	63	0.95
EWH□-60-1.05A	40-60	1.05	400	90.0	63	0.95
EWH□-60-1.40A	30-45	1.40	350	89.5	63	0.95
EWH□-60-1.75A	20-36	1.75	300	89.5	63	0.95
EWH□-60-2.10A	18-30	2.10	250	88.5	63	0.95
EWH□-60-2.45A	15-24	2.45	250	88.5	58.8	0.95
EWH□-85-350mA	155-240	0.35	950	90.0	84	0.95
EWH□-85-500mA	110-170	0.50	700	90.5	85	0.95
EWH□-85-700mA	80-120	0.70	550	90.5	84	0.95
EWH□-85-1.05A	52-80	1.05	450	90.5	84	0.95
EWH□-85-1.40A	40-60	1.40	400	90.5	84	0.95
EWH□-85-1.75A	30-48	1.75	350	90.0	84	0.95
EWH□-85-2.80A	18-30	2.80	250	89.0	84	0.95
EWH□-85-3.50A	15-24	3.50	250	89.0	84	0.95

NOTE: □=(A) (D) (T) or blank

EWH: IP67; EWH(A): IP65, Output voltage and current adjustable

EWH(D): IP67, 3 in 1 dimming selectable (1-10Vdc, 100Hz-3kHz PWM signal or 10-100k Ω resistance); EWH(T): IP67, Timer dimming function



Mechanical Drawing

Product weight: 0.9kg

Product outline: 197mm × 68mm × 39mm

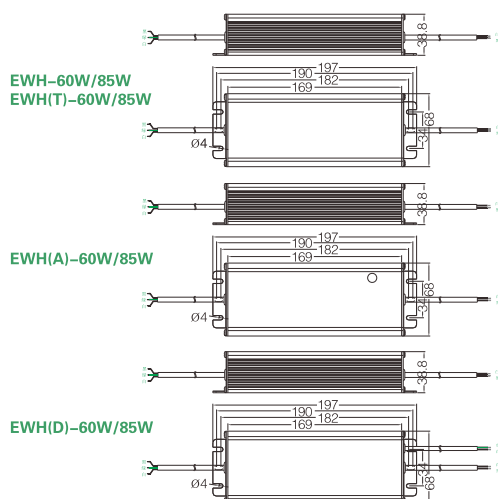

Intelligent High-power 100W-120W



EWH-100 / EWH-120 Series CC / CV / Output current adjustable / 3 in 1 dimming / Timer dimming

Features

- Wide range input voltage: 90Vac~305Vac.
- Protections: Short circuit, OLP, OTP, OVP.
- High Efficiency up to 94%.
- High reliability: 105°C capacitor.
- Built-in active PFC function. PF \geq 0.95 for 100% load.
- Non-flickering: Current ripple <5%, Voltage ripple <1%.
- Muti-function dimming selectable.
- Wide range DC output.
- Suitable for LED lighting and moving sign applications.
- Waterproof: IP65 or IP67.
- Cooling by free air convection.
- 5 years warranty.

Specifications

Input Voltage	90Vac~305Vac
Input Frequency	47Hz~63Hz
Input Current	2.2A max
Inrush Current	60A max, 230Vac (Cold start)
Set Up Time	2s max at nominal line
Constant Current Precision	$\pm 5\%$ max
Dielectric Withstand	I/P-O/P: 3750Vac, I/P-FG: 1875Vac
Operating Temperature	-40°C~+70°C
Derating linearly from 100% load at 60°C to 80% load at 70°C	
Storage Temperature	-40°C~+85°C
Protections	Short circuit, OLP, OVP, OTP
Over Current Protections	95%~105% constant current, auto-recovery mode.
Safety Standard	UL8750, UL1310 Class2, EN61347-1, EN61347-2-13, UL1012, UL60950
EMC Standard	EN55015, EN61000-3-2, 3, EN61000-4-2, 3, 4, 5, 6, 8, 11, EN61547
Standard output cable	UL Rated, 18-16#AWG

Model List

Model No.	Output voltage range (Vdc)	Output max current (A)	R&N (Max) (mV)	Eff.(%)	Max Watt (W)	PF (Typ.)
EWH□-100-350mA	185-285	0.35	600	92.0	100	0.95
EWH□-100-500mA	140-200	0.50	500	92.0	100	0.95
EWH□-100-700mA	135-155	0.70	400	92.0	100	0.95
EWH□-100-1.05A	70-100	1.05	400	92.0	100	0.95
EWH□-100-1.4A	46-72	1.40	500	92.5	100	0.95
EWH□-100-2.1A	32-48	2.10	400	93.0	100	0.95
EWH□-100-2.45A	26-40	2.45	350	93.0	100	0.95
EWH□-100-2.8A	24-36	2.80	300	92.5	100	0.95
EWH□-100-3.2A	20-30	3.20	300	92.5	100	0.95
EWH□-100-4.2A	15-24	4.20	250	92.5	100	0.95
EWH□-120-350mA	240-342	0.35	600	93.0	120	0.95
EWH□-120-500mA	165-240	0.50	600	93.0	120	0.95
EWH□-120-700mA	135-170	0.70	500	93.0	120	0.95
EWH□-120-1.05A	74-144	1.05	500	92.5	120	0.95
EWH□-120-1.4A	55-85	1.40	500	92.5	120	0.95
EWH□-120-2.2A	35-54	2.20	400	94.0	120	0.95
EWH□-120-2.5A	32-48	2.50	400	94.0	120	0.95
EWH□-120-3.0A	26-40	3.00	350	94.0	120	0.95
EWH□-120-4.0A	20-30	4.00	300	93.5	120	0.95
EWH□-120-5.0A	15-24	5.00	250	93.0	120	0.95

NOTE: □=(A) (D) (T) or blank

EWH: IP67; EWH(A): IP65, Output current adjustable

EWH(D): IP67, 3 in 1 dimming selectable (1-10Vdc, 100Hz-3kHz PWM signal or 10-100k Ω resistance); EWH(T): IP67, Timer dimming function



Mechanical Drawing

Product weight: 1.5kg

Product outline: 236mm x 68mm x 42mm

236mm x 68mm x 39mm (Only EWH(A)-100W/120W)

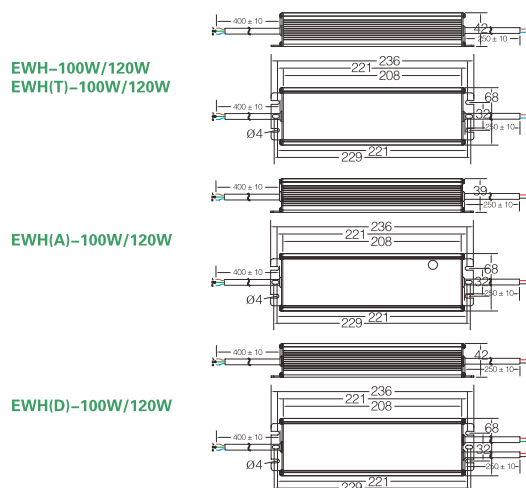

Intelligent High-power 150W



EWH-150 Series CC / CV / Output current adjustable / 3 in 1 dimming / Timer dimming

Features

Wide range input voltage: 90Vac~305Vac.
 Protections: Short circuit, OLP, OTP, OVP.
 High Efficiency up to 94%.
High reliability: 105°C capacitor.
 Built-in active PFC function. PF \geq 0.95 for 100% load.
Non-flickering: Current ripple <5%, Voltage ripple <1%.
Muti-function dimming selectable.
 Wide range DC output.
 Suitable for LED lighting and moving sign applications.
 Waterproof: IP65 or IP67.
 Cooling by free air convection.
 5 years warranty.



Specifications

Input Voltage 90Vac~305Vac
 Input Frequency 47Hz~63Hz
 Input Current 2.2A max
 Inrush Current 60A max, 230Vac (Cold start)
 Set Up Time 2s max at nominal line
 Constant Current Precision $\pm 5\%$ max
 Dielectric Withstand I/P-O/P: 3750Vac, I/P-FG: 1875Vac
 Operating Temperature -40°C~+70°C
 Derating linearly from 100% load at 60°C to 80% load at 70°C
 Storage Temperature -40°C~+85°C
 Protections Short circuit, OLP, OVP, OTP
 Over Current Protections 95%~105% constant current, auto-recovery mode.
 Safety Standard UL8750, UL1310 Class2, EN61347-1, EN61347-2-13, UL1012, UL60950
 EMC Standard EN55015, EN61000-3-2, 3, EN61000-4-2, 3, 4, 5, 6, 8, 11, EN61547
 Standard output cable UL Rated, 18-16#AWG

Mechanical Drawing

Product weight: 1.5kg
 Product outline: 236mm \times 68mm \times 42mm
 236mm \times 68mm \times 39mm (Only EWH(A)-150W)

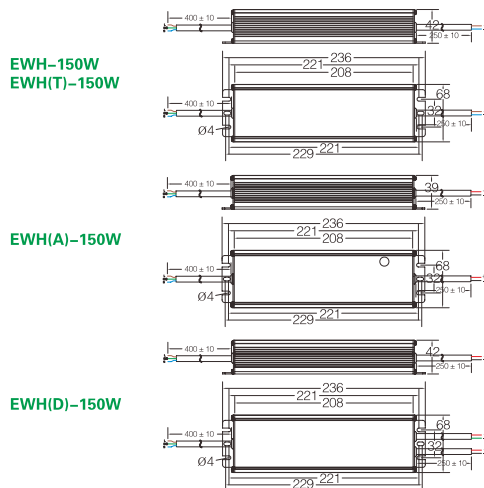

ECU | METAL CASE

Model List

Model No.	Output voltage range (Vdc)	Output max current (A)	R&N (Max) (mV)	Eff.(%)	Max Watt (W)	PF (Typ.)
EWH□-150-350mA	278-420	0.35	600	94.0	150	0.95
EWH□-150-500mA	195-300	0.50	600	94.0	150	0.95
EWH□-150-700mA	140-214	0.70	500	94.0	150	0.95
EWH□-150-1.05A	92-142	1.05	500	94.0	150	0.95
EWH□-150-1.4A	70-107	1.40	500	93.5	150	0.95
EWH□-150-2.8A	35-54	2.80	400	94.0	150	0.95
EWH□-150-3.2A	32-48	3.20	400	94.0	150	0.95
EWH□-150-3.75A	26-40	3.75	350	94.0	150	0.95
EWH□-150-4.2A	24-36	4.20	300	94.0	150	0.95
EWH□-150-5.0A	20-30	5.00	300	93.5	150	0.95
EWH□-150-6.25A	15-24	6.25	250	93.0	150	0.95

NOTE: □=(A) (D) (T) or blank

EWH: IP67

EWH(A): IP65, Output current adjustable

EWH(D): IP67, 3 in 1 dimming selectable (1-10Vdc, 100Hz-3kHz PWM signal or 10-100k Ω resistance)

EWH(T): IP67, Timer dimming function

Intelligent High-power 180W-200W



EWH-180 / EWH-200 Series CC / CV / Output current adjustable / 3 in 1 dimming / Timer dimming

Features

Wide range input voltage: 90Vac~305Vac.
 Protections: Short circuit, OLP, OTP, OVP.
 High Efficiency up to 94%.
High reliability: 105°C capacitor.
 Built-in active PFC function. PF \geq 0.95 for 100% load.
Non-flickering: Current ripple <5%, Voltage ripple <1%.
Muti-function dimming selectable.
 Wide range DC output.
 Suitable for LED lighting and moving sign applications.
 Waterproof: IP65 or IP67.
 Cooling by free air convection.
 5 years warranty.

Specifications

Input Voltage 90Vac~305Vac
 Input Frequency 47Hz~63Hz
 Input Current 2.7A max
 Inrush Current 60A max, 230Vac (Cold start)
 Set Up Time 2s max at nominal line
 Constant Current Precision $\pm 5\%$ max
 Dielectric Withstand I/P-O/P: 3750Vac, I/P-FG: 1875Vac
 Operating Temperature $-40^{\circ}\text{C}\sim+70^{\circ}\text{C}$
 Derating linearly from 100% load at 60°C to 80% load at 70°C
 Storage Temperature $-40^{\circ}\text{C}\sim+85^{\circ}\text{C}$
 Protections Short circuit, OLP, OVP, OTP
 Over Current Protections 95%~105% constant current, auto-recovery mode
 Safety Standard UL8750, UL1310 Class 2, EN61347-1, EN61347-2-13, UL1012, UL60950
 EMC Standard EN55015, EN61000-3-2,3, EN61000-4-2, 3, 4, 5, 6, 8, 11, EN61547
 Standard output cable.....UL Rated, 18-16#AWG

Model List

Model No.	Output voltage range (Vdc)	Output max current (A)	R&N (Max) (mV)	Eff.(%)	Max Watt (W)	PF (Typ.)
EWH□-180-500mA	235-360	0.50	600	93.5	180	0.95
EWH□-180-700mA	167-257	0.70	500	93.5	180	0.95
EWH□-180-1.05A	110-170	1.05	800	93.5	180	0.95
EWH□-180-1.4A	85-128	1.40	800	93.5	180	0.95
EWH□-180-1.75A	60-102	1.75	800	93.0	180	0.95
EWH□-180-3.3A	35-54	3.30	400	94.0	180	0.95
EWH□-180-3.75A	32-48	3.75	400	94.0	180	0.95
EWH□-180-4.5A	26-40	4.50	350	94.0	180	0.95
EWH□-180-5A	24-36	5.00	300	93.5	180	0.95
EWH□-180-6A	20-30	6.00	300	93.5	180	0.95
EWH□-200-500mA	265-400	0.50	600	93.5	200	0.95
EWH□-200-700mA	185-285	0.70	500	93.5	200	0.95
EWH□-200-1.05A	125-190	1.05	950	93.5	200	0.95
EWH□-200-1.4A	95-142	1.40	950	93.5	200	0.95
EWH□-200-1.75A	75-115	1.75	950	93.0	200	0.95
EWH□-200-2.45A	64-82	2.45	400	94.0	200	0.95
EWH□-200-4.2A	32-48	4.20	400	94.0	200	0.95
EWH□-200-5.0A	26-40	5.00	350	94.0	200	0.95
EWH□-200-5.5A	24-36	5.50	300	93.5	200	0.95
EWH□-200-6.7A	20-30	6.70	300	93.5	200	0.95
EWH□-200-8.3A	15-24	8.30	250	93.0	200	0.95

NOTE: □=(A) (D) (T) or blank

EWH: IP67; EWH(A): IP65, Output current adjustable

EWH(D): IP67, 3 in 1 dimming selectable (1-10Vdc, 100Hz-3kHz PWM signal or 10-100k Ω resistance); EWH(T): IP67, Timer dimming function



Mechanical Drawing

Product weight: 1.7kg

Product outline: 247mm x 68mm x 44mm

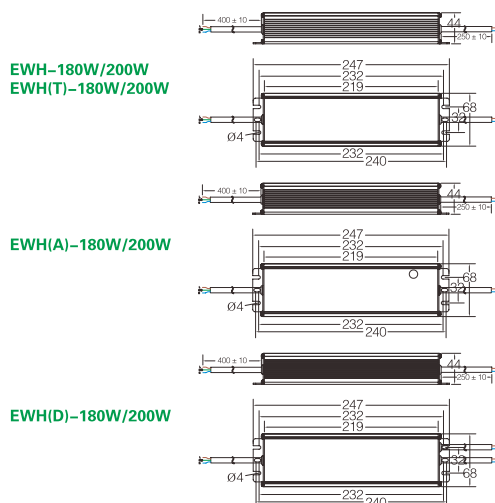

Intelligent High-power 600W

EWH-600 Series Output voltage and current adjustable / 3 in 1 dimming / Timer dimming

Features

Universal input.
 Protections: Short circuit, OLP, OTP, OVP.
 Built-in active PFC function, PF \geq 0.95 for 100% load.
 High efficiency up to 95%.
Muti-function selectable.
Output voltage and current adjustable.
 Waterproof: IP65 or IP67.
 UL8750 Class 2 power unit.
 Emote control function.
 Wide range DC output.
 Cooling by free air convection.
 Suitable for LED lighting and moving sign applications.
 5 years warranty.



Specifications

Input Voltage 90Vac~305Vac
 127Vdc~431Vdc
 Input Frequency 47Hz~63Hz
 Input Current 8A max
 Inrush Current 70A max, 230Vac (Cold start)
 Set Up Time 1s max at nominal line
 Constant Current Precision $\pm 5\%$ max
 Dielectric Withstand I/P-O/P: 3750Vac, I/P-FG: 1875Vac
 Operating Temperature -35°C~+70°C
 Derating linearly from 100% load at 60°C to 80% load at 70°C
 Storage Temperature -40°C~+85°C
 Protections Short circuit, OLP, OVP, OTP
 Over Current Protections 95%~105% constant current,
 auto-recovery mode
 Remote Function On/Off control:
 Possitive logic: High level +2~5V or open
 (PS-ON to 5Vsb-), power on;
 Low level 0~0.5V or short circuit
 (PS-ON to 5Vsb-), power off;
 Negative logic: Low level 0~0.5V or short circuit
 (PS-ON to 5Vsb-), power on;
 High level +2~5V or open
 (PS-ON to 5Vsb-), power off;
 5V Stand-By: +5V/0.5A; $\pm 5\%$ tolerance.
 Safety Standard UL8750, UL1310 Class 2, EN61347-1,
 EN61347-2-13, UL1012, UL60950
 EMC Standard EN55015, EN61000-3-2,3,
 EN61000-4-2, 3, 4, 5, 6, 8, 11, EN61547
 Standard output cable.....UL Rated, 14#AWG

Mechanical Drawing

Product weight:

Product outline: 289mm \times 144.7mm \times 65.6mm

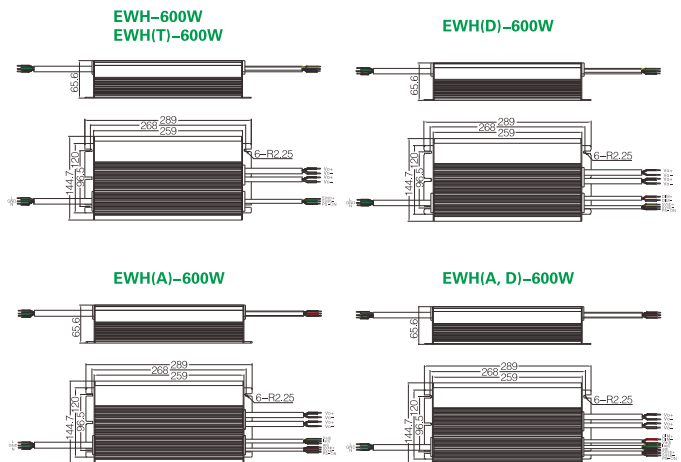

ECU | METAL CASE

型号列表

Model No.	Output voltage range (Vdc)	Output max current (A)	R&N (Max) (mV)	Eff.(%)	Max Watt (W)	PF (Typ.)
EWH□-600-11.2A	27~54	11.2	400	95	607.3	0.95
EWH□-600-12.5A	24~48	12.5	300	95	602.5	0.95
EWH□-600-16.7A	18~36	16.7	250	94.5	603.7	0.95
EWH□-600-20A	15~30	20.0	200	94.5	602.5	0.95
EWH□-600-25A	12~24	25.0	150	94	602.5	0.95

NOTE: □=(A), (D), (A, D), (T) or blank

EWH(A): IP67, Output Voltage and current adjustable (simple,smart,no potentiometer, no program by computer or other device, adjust the output voltage and current though short circuit 1 to other 2 of 3 external wires respectively)

EWH(D): IP67, Dimming selectable (0~10VDC, or 100Hz~3kHz PWM signal)

EWH(A, D): IP67, Output Voltage and current adjustable (simple,smart,no potentiometer, no program by computer or other device, adjust the output voltage and current though short circuit 1 to other 2 of 3 external wires respectively)
 Dimming selectable (0~10VDC,100Hz~3kHz PWM signal))

EWH(T): IP67, Timer dimming function

EWH: IP67, standard model

Economical Constant Current/Voltage 100W-200W

EWE-100 / EWE-120 Series single output with PFC function / Small size

Features

- Universal input.
- Protections: Short circuit, OLP, OTP, OVP.
- Built-in active PFC function. $PF \geq 0.95$ for 100% load.
- High efficiency up to 93%.
- Waterproof: IP67 or IP65.
- UL1310 Class 2 (<60Vdc).
- Muti-function dimming selectable.**
- Wide range DC output.
- Cooling by free air convection.
- Suitable for LED lighting and moving sign applications.
- 5 years warranty.



Specifications

Input Voltage	90Vac~264Vac
Input Frequency	47Hz~63Hz
Input Current	2.2A max
Inrush Current	70A max, 230Vac (Cold start)
Set Up Time	1s max at nominal line
Constant Current Precision	$\pm 3\%$ max
Dielectric Withstand	I/P-O/P: 3750Vac, I/P-FG: 1875Vac
Operating Temperature	$-35^{\circ}\text{C} \sim +70^{\circ}\text{C}$
Derating linearly from 100% load at 60°C to 80% load at 70°C	
Storage Temperature	$-40^{\circ}\text{C} \sim +85^{\circ}\text{C}$
Protections	Short circuit, OLP, OVP, OTP
Over Current Protections	95%~105% constant current, auto-recovery mode
Safety Standard	UL8750, UL1310 Class 2, EN61347-1, EN61347-2-13, UL1012, UL60950
EMC Standard	EN55015, EN61000-3-2,3, EN61000-4-2, 3, 4, 5, 6, 8, 11, EN61547
Standard output cable.....	UL Rated, 18-16#AWG

Mechanical Drawing

Product weight: 0.9kg
Product outline: 190mm x 68mm x 39mm

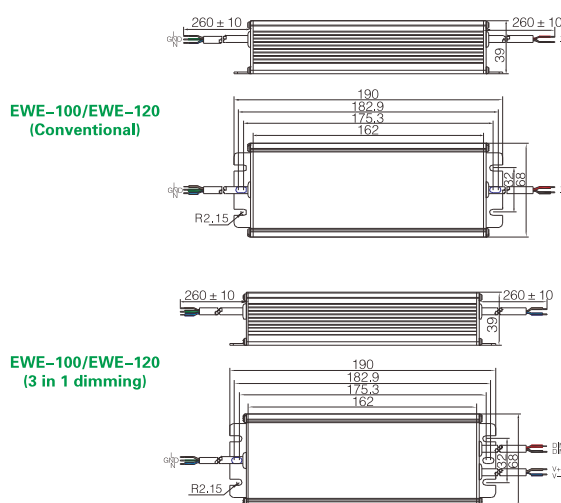

Model List

Model No.	Output voltage range (Vdc)	Output max current (A)	R&N (Max) (mV)	Eff.(%)	Max Watt (W)	PF (Typ.)
EWE□-100-700mA	80-145	0.7	350	93	101.5	0.95
EWE□-100-1.05A	55-96	1.05	350	93	100.8	0.95
EWE□-100-1.4A	40-72	1.4	300	93	100.8	0.95
EWE□-100-2.1A	28-48	2.1	300	92	100.8	0.95
EWE□-100-2.8A	20-36	2.8	200	90	100.8	0.95
EWE□-120-700mA	95-172	0.7	350	93	120.4	0.95
EWE□-120-1.05A	65-115	1.05	350	93	120.8	0.95
EWE□-120-1.4A	48-86	1.4	300	93	120.4	0.95
EWE□-120-2.1A	32-58	2.1	300	92	121.8	0.95
EWE□-120-2.8A	24-43	2.8	200	91	120.4	0.95

NOTE: □=(D) or blank
EWE(D): IP67, 3 in 1 dimming selectable (0-10Vdc, 100Hz-3kHz PWM signal or 10-100Ω resistance)
EWE: IP67

Economical Constant Current/Voltage 150W

EWE-150 Series single output with PFC function / Small size

Features

- Protections: Short circuit, OLP, OTP, OVP.
- Built-in active PFC function. $PF \geq 0.95$ for 100% load.
- High efficiency up to 93%.
- Waterproof: IP67 or IP65.
- UL1310 Class 2 (<60Vdc).
- Muti-function dimming selectable.**
- Wide range DC output.
- Cooling by free air convection.
- Suitable for LED lighting and moving sign applications.
- 5 years warranty.



Specifications

Input Voltage	176Vac~264Vac
Input Frequency	47Hz~63Hz
Input Current	1.2A max
Inrush Current	70A max, 230Vac (Cold start)
Set Up Time	1s max at nominal line
Constant Current Precision	$\pm 3\%$ max
Dielectric Withstand	I/P-O/P: 3750Vac, I/P-FG: 1875Vac
Operating Temperature	$-35^{\circ}\text{C} \sim +70^{\circ}\text{C}$
Derating linearly from 100% load at 60°C to 80% load at 70°C	
Storage Temperature	$-40^{\circ}\text{C} \sim +85^{\circ}\text{C}$
Protections	Short circuit, OLP, OVP, OTP
Over Current Protections	95%~105% constant current, auto-recovery mode
Safety Standard	UL8750, UL1310 Class 2, EN61347-1, EN61347-2-13, UL1012, UL60950
EMC Standard	EN55015, EN61000-3-2,3, EN61000-4-2, 3, 4, 5, 6, 8, 11, EN61547
Standard output cable.....	UL Rated, 18-16#AWG

Mechanical Drawing

Product weight: 0.9kg
Product outline: 190mm × 68mm × 42mm

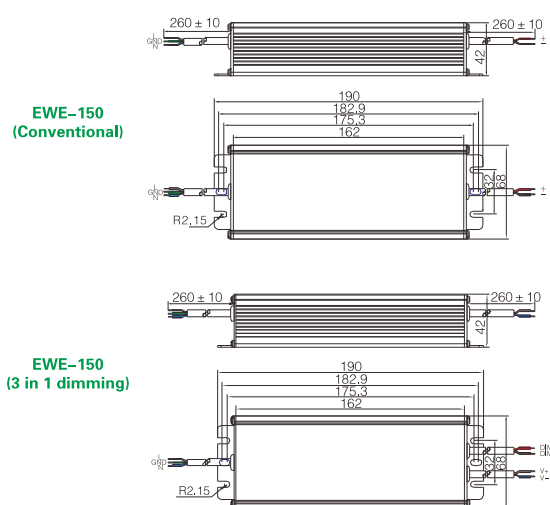

ECU | METAL CASE

型号列表

Model No.	Output voltage range (Vdc)	Output max current (A)	R&N (Max) (mV)	Eff.(%)	Max Watt (W)	PF (Typ.)
EWE□-150-700mA	120-214	0.7	350	93	150	0.95
EWE□-150-1.05A	80-143	1.05	350	93	150.1	0.95
EWE□-150-1.4A	60-108	1.4	300	93	151.2	0.95
EWE□-150-2.1A	40-72	2.1	300	93	151.2	0.95
EWE□-150-2.8A	32-54	2.8	250	93	151.2	0.95
EWE□-150-3.5A	26-43	3.5	200	92	150.5	0.95

NOTE: □=(D) or blank
EWE(D): IP67, 3 in 1 dimming selectable (0-10Vdc, 100H-3kHz PWM signal or 10-100Ω resistance)
EWE: IP67

Intelligent Constant Power 150W

EWS-150W Series single output with PFC and high efficiency

□ Features

- Wide range input voltage: 90Vac~305Vac.
- Protections: Short circuit, OLP, OTP, OVP.
- Built-in active PFC function. $PF \geq 0.95$ for 100% load.
- No load power consumption <0.5W.
- Multiple dimming functions (0~10V and so on).
- Constant output power with intelligent design.
- Output current can be automatically adjust between 0.7 to 1.4.
- Waterproof: IP67 or IP65.
- Suitable for LED lighting and moving sign applications.
- Cooling by free air convection.
- High efficiency up to 94%.
- Wide range DC output.
- 5 years warranty.



□ Specifications

- Input Voltage 90Vac~305Vac
- Input Frequency 47Hz~63Hz
- Input Current 2.2A max
- Inrush Current 60A max, 230Vac (Cold start)
- Set Up Time 500ms max
- Constant Current Precision $\pm 5\%$ max
- Dielectric Withstand I/P-O/P: 3750Vac, I/P-FG: 1875Vac
- Operating Temperature $-35^{\circ}\text{C} \sim +70^{\circ}\text{C}$
- Derating linearly from 100% load at 60°C to 80% load at 70°C
- Storage Temperature $-40^{\circ}\text{C} \sim +85^{\circ}\text{C}$
- Protections Short circuit, OLP, OVP, OTP
- Over Current Protections 95%~105% constant current, auto-recovery mode
- Safety Standard UL8750, EN61347-1, EN61347-2-13, UL1012, UL60950
- EMC Standard EN55015, EN61000-3-2,3, EN61000-4-2, 3, 4, 5, 6, 8, 11, EN61547
- Standard output cable UL rated, 18-14#AWG

□ Mechanical Drawing

- Product weight: 1.5kg
- Product outline: 236mm x 68mm x 42mm

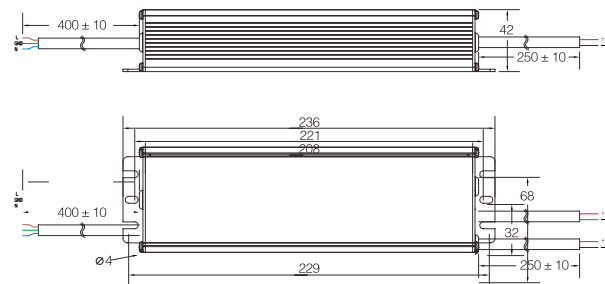

□ Model List

Model No.	Output voltage range (Vdc)	Output current range (mA)	R&N (Max) (mV)	Eff. (@700mA 214Vdc)	Constant Watt (W)	PF (Typ.)
EWS-150	90~214	700~1400	700	94.0	150	>0.95

NOTE:

The output current will automatically change in different conditions. Thus, the output power is 150 watts constantly in the output voltage range.

Enclosed Constant Current 30W-50W



EWP/D-30、EWP/D-50 Series single output with PFC and 3 in 1 dimming selectable

Features

- Universal input.
- Protections: Short circuit, OLP, OTP, OVP.
- Built-in active PFC function, $PF \geq 0.92$ for 100% load.
- Muti-function dimming selectable.
- Waterproof: IP67.
- Suitable for LED lighting and moving sign applications.
- UL1310 Class 2 power unit (Except >60Vdc).
- Cooling by free air convection.
- 3 years warranty.



Specifications

Input Voltage 90Vac~277Vac
 Input Frequency 47Hz~63Hz
 Input Current 0.9A max
 Inrush Current 30A max (Cold start)
 Set Up Time 2s max at nominal line
 Constant Current Precision $\pm 5\%$ max
 Dielectric Withstand I/P-O/P: 3750Vac, I/P-FG: 1875Vac
 Operating Temperature $-35^{\circ}\text{C} \sim +70^{\circ}\text{C}$
 Derating linearly from 100% load at 60°C to 80% load at 70°C
 Storage Temperature $-40^{\circ}\text{C} \sim +85^{\circ}\text{C}$
 Protections Short circuit, OLP, OVP, OTP
 Over Current Protections 95%–105% constant current, auto-recovery mode.
 Safety Standard UL8750, UL1310 Class2, EN61347-1, EN61347-2-13, UL1012, UL60950
 EMC Standard EN55015, EN61000-3-2, 3, EN61000-4-2, 3, 4, 5, 6, 8, 11, EN61547
 Standard output cable UL Rated, 18–16#AWG

Mechanical Drawing

EWP-30W/50W EWD-30W/50W
 Product weight: 0.4kg Product weight: 0.45kg
 Product outline: Product outline:
 163mmx44mmx31.75mm 174mmx44mmx31.75mm

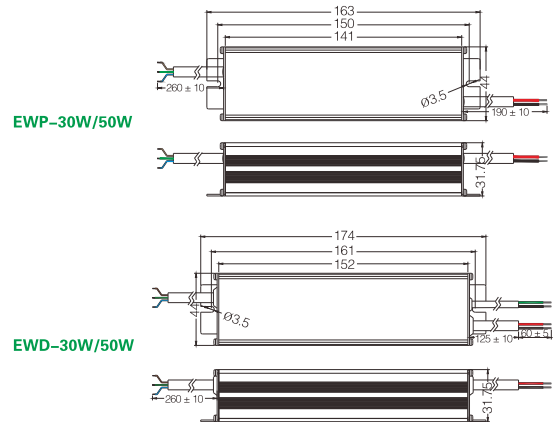

Model List

Model No.	Output voltage range (Vdc)	Output max current (A)	R&N (Max) (V)	Eff.(%)	Max Watt (W)	PF (Typ.)
EW□-30-350mA	63-90	0.35	5.0	89	31	0.93
EW□-30-500mA	36-60	0.50	4.5	89.5	30	0.93
EW□-30-700mA	30-48	0.70	3.5	87	34	0.93
EW□-30-1.05A	18-30	1.05	2.5	87	30	0.93
EW□-30-1.40A	15-24	1.40	2.5	86	34	0.93
EW□-30-1.75A	12-18	1.75	3.0	85	31	0.93
EW□-50-350mA	135-155	0.35	13.5	90	50	0.95
EW□-50-500mA	65-100	0.50	6.0	89	50	0.95
EW□-50-700mA	45-72	0.70	5.0	88.5	50	0.95
EW□-50-1.05A	30-48	1.05	4.0	88	50	0.95
EW□-50-1.4A	20-36	1.40	3.0	87.5	50	0.95
EW□-50-1.75A	18-30	1.75	2.5	87.5	52	0.95
EW□-50-2.1A	15-24	2.10	4.0	86.5	50	0.95
EW□-50-2.8A	12-18	2.80	3.5	84	50	0.95

NOTE: □=P or D
 EWP: IP67;
 EWD: IP67, Muti-function dimming selectable (1~10Vdc, 10V PWM or 10k~100kΩ resistance)

Enclosed Constant Current 30W-50W

EWP-30D / EWP-50T Series multi-output with PFC function

□ Features

- Universal input.
- Protections: Short circuit, OLP, OTP, OVP.
- Built-in active PFC function. PF>0.92 for 100% load.
- Muti-output selectable.**
- Waterproof: IP67.
- Suitable for LED lighting and moving sign applications.
- UL1310 Class 2 power unit (Except >60Vdc).
- Cooling by free air convection.
- 3 years warranty.



□ Specifications

- Input Voltage 90Vac ~ 277Vac
- Input Frequency 47Hz ~ 63Hz
- Input Current 0.9A max
- Inrush Current 30A max (Cold start)
- Set Up Time 2s max at nominal line
- Constant Current Precision $\pm 5\%$ max
- Dielectric Withstand I/P-O/P: 3750Vac, I/P-FG: 1875Vac
- Operating Temperature -35°C to $+70^{\circ}\text{C}$
- Derating linearly from 100% load at 60°C to 80% load at 70°C
- Storage Temperature -40°C to $+85^{\circ}\text{C}$
- Protections Short circuit, OLP, OTP, OVP
- Over Current Protections 95%–105% Constant current, auto-recovery mode.
- Safety Standard UL8750, UL1310 Class 2, EN61347-1, EN61347-2-13, UL1012, UL60950
- EMC Standard EN55015, EN61000-3-2, 3, EN61000-4-2, 3, 4, 5, 6, 8, 11, EN61547
- Standard output cable UL Rated, 18–16#AWG

□ Mechanical Drawing

- Product weight: 0.45kg
- Product outline: 180mm \times 44mm \times 31.75mm

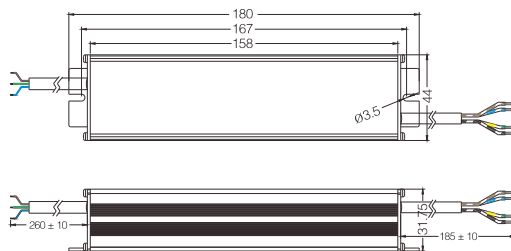

□ Model List

EWP-30D dual output series

Model No.	Output voltage range (Vdc)	Output max current (A)	R&N (Max) (V)	Eff.(%)	Max Watt (W)	PF (Typ.)
EWP-30D-200mA	48–72	0.20*2	4.0	86	29	0.92
EWP-30D-350mA	33–42	0.35*2	3.0	85	29	0.92
EWP-30D-500mA	20–30	0.50*2	3.0	84	30	0.92
EWP-30D-700mA	15–21	0.70*2	2.5	84	29	0.92
EWP-30D-900mA	13–18	0.90*2	2.5	83	32	0.92

EWP-50T triple output series

Model No.	Output voltage range (Vdc)	Output max current (A)	R&N (Max) (V)	Eff.(%)	Max Watt (W)	PF (Typ.)
EWP-50T-240mA	48–72	0.24*3	4.5	87	52	0.95
EWP-50T-350mA	33–48	0.35*3	4.0	85	50	0.95
EWP-50T-500mA	20–33	0.50*3	4.5	85	49	0.95
EWP-50T-700mA	15–24	0.70*3	4.0	84	50	0.95
EWP-50T-900mA	13–18	0.90*3	3.5	84	49	0.95

Enclosed Constant Current 75W-100W



EWP-75 / EWP/D-100 Series single output with PFC function

Features

- Universal input.
- Protections: Short circuit, OLP, OTP, OVP.
- Built-in active PFC function, PF>0.95 for 100% load.
- Waterproof: IP67.
- Suitable for LED lighting and moving sign applications.
- Cooling by free air convection.
- 3 years warranty.



Specifications

Input Voltage	90Vac ~ 277Vac
Input Frequency	47Hz ~ 63Hz
Input Current	1.5A max
Inrush Current	75W: 50A max (Cold start) 100W: 100A max (Cold start)
Set Up Time	2s max at nominal line
Constant Current Precision	± 5% max
Dielectric Withstand	I/P-O/P: 3750Vac, I/P-FG: 1875Vac
Operating Temperature	- 35°C to + 70°C
Derating linearly from 100% load at 60°C to 80% load at 70°C	
Storage Temperature	- 40°C to + 85°C
Protections	Short circuit, OTP, OLP, OVP
Over Current Protections	95%~105% Constant current Auto-recovery mode
Safety Standard	UL8750, EN61347-1, UL60950 EN61347-2-13, UL1012, IP67
EMC Standard	EN55015, EN61000-3-2, 3, EN61000-4-2, 3, 4, 5, 6, 8, 11, EN61547
Standard output cable	UL Rated, 18-14#AWG

Mechanical Drawing

EWP-75	EWP-100
Product weight: 1.0kg	Product weight: 1.0kg
Product outline:	Product outline:
168mm × 80mm × 45mm	167mm × 80mm × 42mm

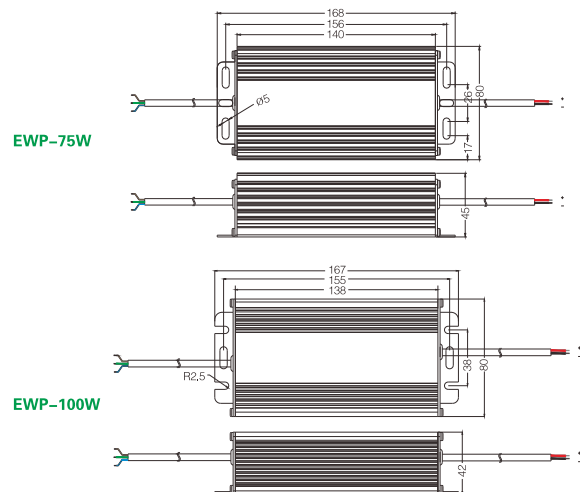

Model List

Model No.	Output voltage range (Vdc)	Output max current (A)	R&N (Max) (mV)	Eff.(%)	Max Watt (W)	PF (Typ.)
EWP-75-1.25A	40-60	1.25	300mV	90	75	0.95
EWP-75-1.60A	30-48	1.60	250mV	90	75	0.95
EWP-75-2.10A	20-36	2.10	250mV	90	75	0.95
EWP-75-3.15A	15-24	3.15	200mV	89	75	0.95
EWP-75-4.17A	12-18	4.17	200mV	88	75	0.95
EW□-100-700mA	135-155	0.70	13.5V	91	100	0.95
EW□-100-1.75A	35-54	1.75	4.0V	90	100	0.95
EW□-100-2.1A	32-48	2.10	4.0V	90	100	0.95
EW□-100-2.45A	26-40	2.45	3.5V	89	100	0.95
EW□-100-2.8A	24-36	2.80	3.0V	89	100	0.95
EW□-100-3.2A	20-30	3.20	3.0V	88	100	0.95
EW□-100-4.2A	15-24	4.20	2.5V	88	100	0.95

NOTE: □=P or D
EWP: IP67;
EWD: IP67, Multi-function dimming selectable (1~10Vdc, 10V PWM or 10k~100kΩ resistance)

Enclosed Constant Current/Voltage 120W-150W



EWP-120 / EWP-150 Series single output with PFC function

Features

- Universal input.
- Protections: Short circuit, OLP, OTP, OVP.
- Built-in active PFC function. PF>0.95 for 100% load.
- Waterproof: IP67.
- Suitable for LED lighting and moving sign applications.
- Cooling by free air convection.
- 3 years warranty.



Specifications

Input Voltage	90Vac ~ 277Vac
Input Frequency	47Hz ~ 63Hz
Input Current	2.2A max
Inrush Current	100A max (Cold start)
Set Up Time	2s max at nominal line
Constant Current Precision	± 5% max
Dielectric Withstand	I/P-O/P: 3750Vac, I/P-FG: 1875Vac
Operating Temperature	- 35°C to + 70°C
Derating Linearly from 100% load at 60°C to 80% load at 70°C	
Storage Temperature	- 40°C to + 85°C
Protections	Short circuit, OTP, OLP, OVP
Over Current Protections	95%~105% Constant current Auto-recovery mode
Safety Standard	UL8750, EN61347-1, UL60950 EN61347-2-13, UL1012
EMC Standard	EN55015, EN61000-3-2, 3, EN61000-4-2, 3, 4, 5, 6, 8, 11, EN61547
Standard output cable	UL Rated, 18-14#AWG

Mechanical Drawing

Product weight: 1.3kg
Product outline: 228mm × 80mm × 45mm

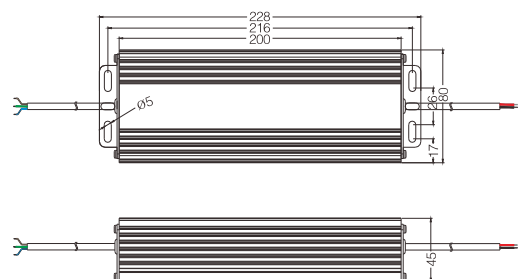

Model List

Model No.	Output voltage range (Vdc)	Output max current (A)	R&N (Max) (mV)	Eff.(%)	Max Watt (W)	PF (Typ.)
EWP-120-1.6A	64-82	1.6	480	92.5	120	0.95
EWP-120-2.2A	35-54	2.2	400	92.5	120	0.95
EWP-120-2.5A	32-48	2.5	400	92.5	120	0.95
EWP-120-3.0A	26-40	3.0	350	92	120	0.95
EWP-120-3.3A	24-36	3.3	350	92	120	0.95
EWP-120-4.0A	20-30	4.0	300	91	120	0.95
EWP-120-5.0A	15-24	5.0	250	91	120	0.95
EWP-150-2.8A	35-54	2.8	400	92.5	150	0.95
EWP-150-3.12A	32-48	3.12	400	92.5	150	0.95
EWP-150-3.57A	27-42	3.57	350	92	150	0.95
EWP-150-4.16A	24-36	4.16	350	92	150	0.95
EWP-150-5.0A	20-30	5.0	300	91	150	0.95
EWP-150-6.25A	15-24	6.25	250	91	150	0.95

Enclosed Constant Current 30W-100W

EDH-30 / EDH-60 / EDH-100 DC-DC Series single output with high efficiency

□ Features

Protections:

Input: Reverse polarity protection; Under-voltage protection
Output: Short circuit protection; Open circuit protection; Over-voltage protection; Over current protection

Waterproof: IP67.

Used for solar LED lighting and other DC-input applications.

Cooling by free air convection.

High efficiency up to 96.5%.

Several function selectable.

Wide range DC output.

5 years warranty.



□ Mechanical Drawing

Product weight: 0.35kg

Product outline: 118mm × 44mm × 31.5mm

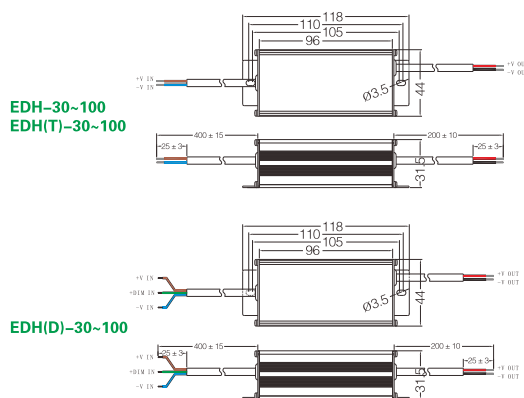

□ Specifications

Input Voltage 11Vac~30Vac

Inrush Current 20A max, 24Vdc (Cold start)

Set Up Time 200ms max at nominal line

Constant Current Precision ± 5% max

Operating Temperature -35°C~+70°C

Derating linearly from 100% load at 60°C to 80% load at 70°C

Storage Temperature -40°C~+85°C

Protections 95%~105% Constant current,
Auto-recovery mode

Standard output cable UL Rated, 18~16#AWG

□ Model List

Input Voltage: 11~14Vdc / 11~30Vdc

Model No.	Output voltage range (Vdc)	Output max current	R&N (Max) (mV)	Eff.(%)	Max Watt (W)
EDH□-30-500mA	42-60	500mA	200	94	30
EDH□-30-760mA	32-40	760mA	150	94.5	30.4
EDH□-60-1A	42-60	1.00A	350	91	60
EDH□-60-1.4A	32-43	1.40A	150	93	60.2
EDH□-60-1.75A	32-36	1.75A	250	94	63

NOTE: □=(D) (T) or blank

EW: IP67; EWH(D): IP67, Dimming selectable (100Hz~500Hz PWM or 100kΩ resistance); EWH(T): IP67, Timer dimming function.
After startup, The output current will down to the preset value at the preset time.

Input Voltage: 20~30Vdc

Model No.	Output voltage range (Vdc)	Output max current (A)	R&N (Max) (mV)	Eff.(%)	Max Watt (W)
EDH□-60-1.05A	42-60	1.05	250	96	63
EDH□-60-1.4A	32-43	1.40	200	96.5	60.2
EDH□-60-1.75A	32-36	1.75	200	96.5	63
EDH□-100-1.75A	40-60	1.75	400	95	105
EDH□-100-2.1A	33-48	2.10	350	96	100.8
EDH□-100-2.8A	32-36	2.80	200	96	100.8

NOTE: □=(D) (T) or blank

EW: IP67; EWH(D): IP67, Dimming selectable (100Hz~500Hz PWM or 100kΩ resistance); EWH(T): IP67, Timer dimming function.
After startup, The output current will down to the preset value at the preset time.

Constant Current For High Bay Light 100W

EOP-100W Series single output with PFC and high efficiency

□ Features

Universal input.
 Protections: Short circuit, OLP, OTP, OVP.
 Built-in active PFC function. PF \geq 0.95 for 100% load.
 Suitable for LED high bay lighting.
 Cooling by free air convection.
 High efficiency up to 93%.
 Multi-function selectable.
 Wide range DC output.
 5 years warranty.

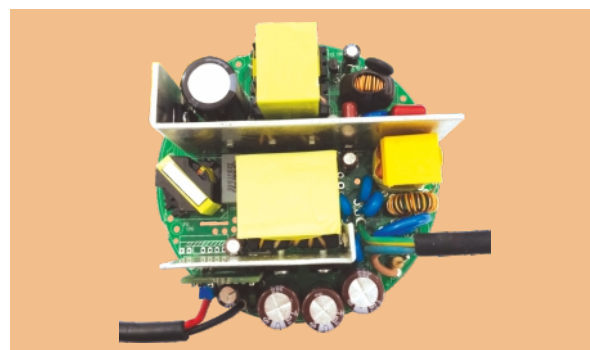

□ Specifications

Input Voltage 90Vac~305Vac
 Input Frequency 47Hz~63Hz
 Input Current 2.0A max
 Inrush Current 60A max, 230Vac (Cold start)
 Set Up Time 0.5s max at nominal line
 Constant Current Precision $\pm 3\%$ max
 Dielectric Withstand I/P-O/P: 3750Vac, I/P-FG: 1875Vac
 Operating Temperature $-35^{\circ}\text{C}\sim+70^{\circ}\text{C}$
 Derating linearly from 100% load at 60°C to 80% load at 70°C
 Storage Temperature $-40^{\circ}\text{C}\sim+85^{\circ}\text{C}$
 Protections Short circuit, OLP, OVP, OTP
 Over Current Protections 95%–105% constant current, auto-recovery mode
 Safety Standard UL8750, UL1310 Class 2, EN61347-1, EN61347-2-13, UL1012, UL60950
 EMC Standard EN55015, EN61000-3-2,3, EN61000-4-2, 3, 4, 5, 6, 8, 11, EN61547
 Standard output cable UL Rated, 18–16#AWG

□ Mechanical Drawing

Product weight: 0.5kg
 Product outline: $\Phi 106\text{mm} \times \text{H}40\text{mm}$

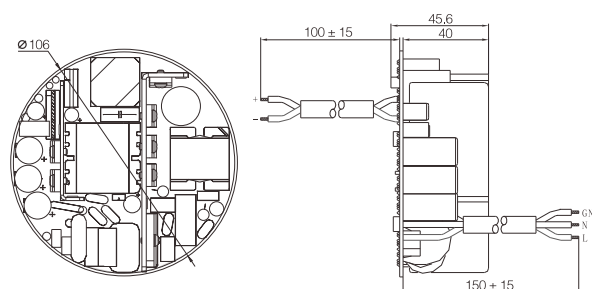

□ Model List

Model No.	Output voltage range (Vdc)	Output max range (A)	R&N (Max) (mV)	Eff.(%)	Max watt (W)	PF (Typ.)
EOP-100-700mA	80–143	0.7	300	92	100.1	0.95
EOP-100-1.4A	40–72	1.4	200	92	100.8	0.95
EOP-100-2.1A	30–48	2.1	200	92	100.8	0.95
EOP-100-2.8A	24–36	2.8	200	91	100.8	0.95

NOTE:

Dimming selectable 0–10Vdc, 100Hz–3kHz PWM signal or 10–100k Ω resistance.

Constant Current For High Bay Light 150W

EOP-150W Series single output with PFC and high efficiency

□ Features

Universal input.
Protections: Short circuit, OLP, OTP, OVP.
Built-in active PFC function. $PF \geq 0.95$ for 100% load.
Suitable for LED high bay lighting.
Cooling by free air convection.
High efficiency up to 93%.
Muti-function selectable.
Wide range DC output.
5 years warranty.

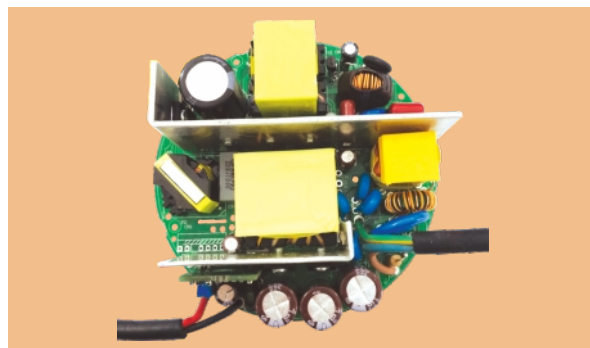

□ Specifications

Input Voltage 90Vac~305Vac
Input Frequency 47Hz~63Hz
Input Current 2.0A max
Inrush Current 60A max, 230Vac (Cold start)
Set Up Time 0.5s max at nominal line
Constant Current Precision $\pm 3\%$ max
Dielectric Withstand I/P-O/P: 3750Vac, I/P-FG: 1875Vac
Operating Temperature $-35^{\circ}\text{C} \sim +70^{\circ}\text{C}$
Derating linearly from 100% load at 60°C to 80% load at 70°C
Storage Temperature $-40^{\circ}\text{C} \sim +85^{\circ}\text{C}$
Protections Short circuit, OLP, OVP, OTP
Over Current Protections 95%~105% constant current, auto-recovery mode
Safety Standard UL8750, UL1310 Class 2, EN61347-1, EN61347-2-13, UL1012, UL60950
EMC Standard EN55015, EN61000-3-2,3, EN61000-4-2, 3, 4, 5, 6, 8, 11, EN61547
Standard output cable UL Rated, 18-16#AWG

□ Mechanical Drawing

Product weight: 0.5kg
Product outline: $\Phi 106\text{mm} \times \text{H}40\text{mm}$

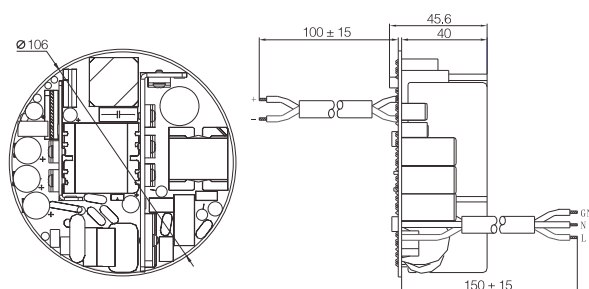

□ Model List

Model No.	Output voltage range (Vdc)	Output max range (A)	R&N (Max) (mV)	Eff.(%)	Max watt (W)	PF (Typ.)
EOP-150-700mA	120-214	0.7	350	93	150	0.95
EOP-150-1.4A	60-107	1.4	350	93	150	0.95
EOP-150-2.1A	40-72	2.1	300	93	151.2	0.95
EOP-150-2.8A	30-54	2.8	200	93	151.2	0.95
EOP-150-3.5A	24-43	3.5	200	93	150.5	0.95
EOP-150-4.2A	20-36	4.2	200	92	151.2	0.95

NOTE:

Dimming selectable 0-10Vdc, 100Hz-3kHz PWM signal or 10-100k Ω resistance.

Mounted Power Supply 75W-200W



ESF-75 / ESF-100 / ESF-150 / ESF-200 Series

Features

Universal AC input / full range
 PF >0.96@115Vac, >0.93@230Vac
 Built-in remote ON/OFF control
 No load power consumption ≤0.5W
 Power on indication
 Air cooling
 Protection: Overload / Over voltage / Short circuit /
 Over temperature
 100% full load burn-in test
 3 years warranty

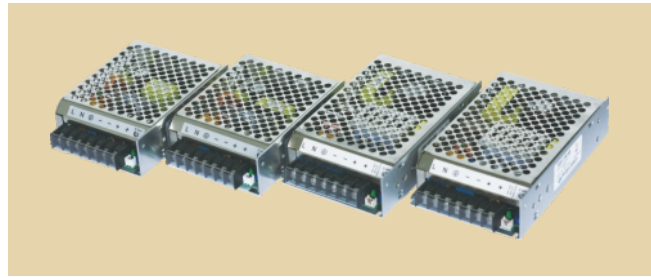

Model List

Model	Watt	Input	Output	Eff.%(Typ.)	Size
ESF-75	75W	90-264Vac	5V-48V, 15A-1.5A	90%	129 × 98 × 38mm
ESF-100	100W	90-264Vac	5V-48V, 17A-2.1A	90%	129 × 98 × 38mm
ESF-150	150W	90-264Vac	12V-48V, 12.5A-3.2A	92%	159 × 98 × 38mm
ESF-200	200W	90-264Vac	12V-48V, 16.7A-4.2A	92%	159 × 98 × 38mm

Mounted Power Supply 60W-100W

EEP-60 / EEP-80 / EEP-100 Series

Features

Universal AC input / full range
 PF >0.96@115Vac, >0.93@230Vac
 Power on indication
 Air cooling
 Protection: Overload / Over voltage / Short circuit /
 Over temperature
 Constant current and constant voltage output option
 100% full load burn-in test
 Suitable for led display, industry control
 2 years warranty



Model List

Model	Watt	Input	Output	Eff.%(Typ.)	Size
EEP-60	60W	90-264Vac	33V, 1.8A	89%	143 × 59 × 38mm
EEP-80	80W	90-264Vac	33V, 2.5A	89%	143 × 59 × 38mm
EEP-100	100W	90-264Vac	33V, 3.1A	89%	143 × 59 × 38mm

Mounted Power Supply 15W-150W



EPR-15 / EPR-25 / EPR-35 / EPR-50 / EPR-75 / EPR-100 / EPR-150 Series

Features

Universal AC input / full range
 Power on indication
 Protections: Overload / Over voltage / Short circuit
 Compact, high efficiency, high reliability.
 100% full load burn-in test
 2 years warranty

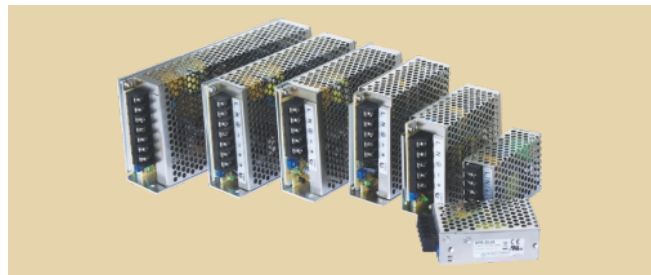

Model List

Model	Watt	Input	Output	Eff.%(Typ.)	Size
EPR-15	15W	88-264Vac, 124-370Vdc	5V-48V, 3A-0.32A	83%	78 × 51 × 28mm
EPR-25	25W	88-264Vac, 124-370Vdc	5V-48V, 5A-0.57A	83%	78 × 51 × 28mm
EPR-35	35W	88-264Vac, 124-370Vdc	5V-48V, 5A-0.8A	84%	99 × 81 × 36mm
EPR-50	50W	88-264Vac, 124-370Vdc	5V-48V, 8A-1.1A	86%	99 × 97 × 36mm
EPR-75	75W	88-264Vac, 124-370Vdc	5V-48V, 12A-1.6A	86%	129 × 98 × 38mm
EPR-100	100W	88-264Vac, 124-370Vdc	5V-48V, 14A-2.3A	84%	159 × 98 × 38mm
EPR-150	150W	88-132Vac, 176-264Vac, 249-370Vdc	5V-48V, 22A-3.3A	87%	199 × 98 × 41mm

Surge Protective Device ESPD Series

Specifications

Technical characteristics	Parameters
Model No.	ESPD
Application system	D level protection of Single-phase power supply
Operating voltage (Un)	100–277Vac 50/60Hz
Maximum continuous operating voltage (Uc)	305Vac
Voltage protection level	<950V
Nominal discharge current in (8/20uS)	10kA
Lightning withstand voltage	20kV
Maximum overcurrent	20A
Response speed (ta)	L–N ≤ 25nS N–PE ≤ 100nS L–PE ≤ 100nS
Rated power (Pw)	2kW
Protection level	IP65
Weight	0.2kg

Mechanical Drawing

Product outline:
61mm × 40mm × 36mm

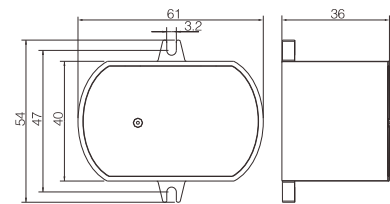

Input AC / Output AC Socket:

AC input:
3*1.00mm² *250mm 105°C
Rubber thread–60245
Brown: AC LINE;
Blue: AC NEUTRAL;
Olivine: GND
AC output:
3*1.00mm² *250mm 105°C
Rubber thread–60245
Brown: AC LINE;
Blue: AC NEUTRAL;
Olivine: GND



Certification





ECU ELECTRONICS INDUSTRIAL CO.,LTD.

Address: NO.88 Pihe Rd, 101 Building, Hefei, 232100,
Anhui, China

NO.41 TianZhi Rd, Huadian Building, Hefei, 230088,
Anhui, China

Tel: 86-400-665-9997、86-551-62731110

Fax: 86-551-68124419

E-mail: sales@ecu.com.cn

[Http://www.ecu.com.cn](http://www.ecu.com.cn)

Consulting hotline:

86-551-62731111

Call us for the latest product
information.



website