

Bulletin 400: Clamp Multiple Loop

FAA TSO-C171

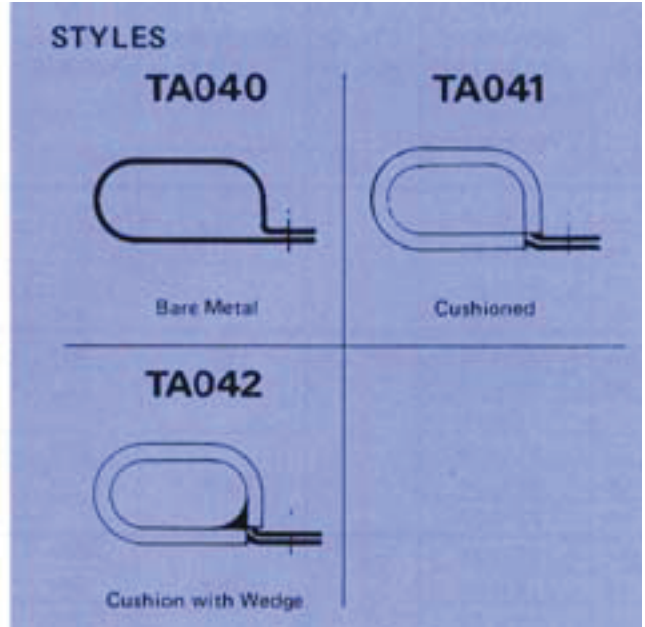

Part Numbering System

ex: TA04206SC0308CR = Multiple loop clamp for (3) three 1/2" diameter tubes with neoprene cushion, wedge and .173" diameter mounting hole. Made from 3/8" wide, .030 thick, 1010 steel, cadmium plated.

Breakdown:

Part number shown below is separated for clarity. When ordering, do not show spaces.

TA042 06 SC 03 08 CR

- TA042 = Basic Part Number
- 06 = Design Detail (See below)
- SC = Metal Identification (See Bulletin 120)
- 03 = Quantity of Wires or Tubes (Show as a minimum of 2 digits)
- 08 = Diameter of Wires or Tubes in 1/16" Increments (Show as a minimum of 2 digits)

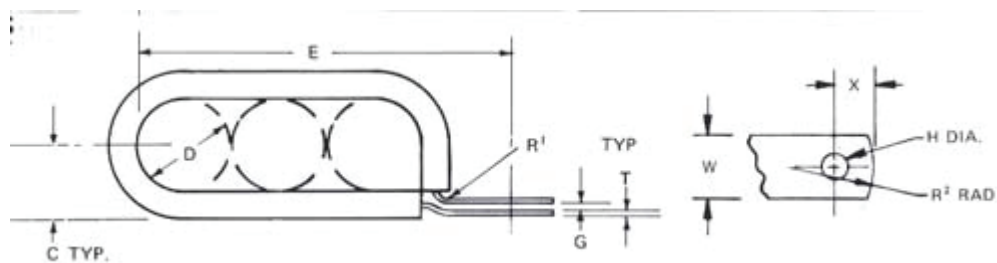

Diagram ID ▶	Nominal Dia. expressed in 1/16" increments	Strap Width	Mounting Hole	Metal Gauge	Mounting Dimension D x # of Tubes+	Clearance D/2+	Gap	Cut Off	Rad	
	D								W	H
Tolerances ▶		+/- .003	+/- .005	Per Spec.	+/- .015	Ref.	Ref.	+/- .010	+/- .015	+/- .015
Part Number										
TA04()01	01 to 20	1/4	.128	.020	.212	.110	1/16	.156	1/16	1/4
02	02 to 20	1/4	.128	.030	.224	.120	1/16	.156	1/16	1/4
03	01 to 20	1/4	.147	.020	.228	.110	1/16	.188	1/16	3/8
04	02 to 20	1/4	.147	.030	.240	.120	1/16	.188	1/16	3/8
TA04()05	01 to 20	3/8	.173	.020	.310	.130	1/16	.188	1/16	3/8
06	02 to 20	3/8	.173	.030	.322	.140	1/16	.188	1/16	3/8
07	21 to 32	3/8	.173	.030	.322	.140	1/8	.188	1/16	3/8
08	01 to 20	3/8	.204	.020	.310	.130	1/16	.188	1/16	3/8
09	02 to 20	3/8	.204	.030	.322	.140	1/16	.188	1/16	3/8
10	21 to 32	3/8	.204	.030	.322	.140	1/8	.188	1/16	3/8
TA04()11	02 to 24	1/2	.204	.030	.402	.170	1/16	.218	1/16	3/8
12	12 to 48	1/2	.204	.040	.460	.180	3/32	.218	1/16	3/8
13	17 to 64	1/2	.204	.050	.490	.190	3/32	.218	1/8	3/8
14	33 to 96	1/2	.204	.060	.534	.200	1/8	.218	1/8	3/8
15	02 to 24	1/2	.281	.030	.514	.170	1/16	.312	1/16	1/2
16	12 to 48	1/2	.281	.040	.524	.180	1/8	.312	1/8	1/2
17	17 to 64	1/2	.281	.050	.534	.190	1/8	.312	1/8	1/2
18	33 to 96	1/2	.281	.060	.544	.200	1/8	.312	1/8	1/2
TA04()19	02 to 16	5/8	.281	.030	.514	.170	1/16	.312	1/16	1/2
20	17 to 96	5/8	.281	.050	.534	.190	1/8	.312	7/64	1/2
21	02 to 16	5/8	.344	.030	.514	.170	1/16	.312	1/16	1/2
22	17 to 96	5/8	.344	.050	.534	.190	1/8	.312	7/64	1/2
23	02 to 16	5/8	.406	.030	.514	.170	1/16	.312	1/16	1/2
24	17 to 96	5/8	.406	.050	.534	.190	1/8	.312	7/64	1/2
TA04()25	02 to 10	3/4	.204	.030	.470	.170	1/16	.250	1/16	1/2
26	11 to 20	3/4	.204	.040	.480	.180	1/8	.250	1/16	1/2
27	21 to 64	3/4	.204	.050	.490	.190	1/8	.250	1/8	1/2
28	02 to 16	3/4	.281	.030	.514	.170	1/16	.312	1/16	1/2
29	17 to 96	3/4	.281	.050	.534	.190	1/8	.312	1/8	1/2
30	02 to 16	3/4	.344	.030	.514	.170	1/16	.312	1/16	1/2
31	17 to 96	3/4	.344	.050	.534	.190	1/8	.312	1/8	1/2
32	02 to 16	3/4	.406	.030	.514	.170	1/16	.312	1/16	1/2
33	17 to 96	3/4	.406	.050	.534	.190	1/8	.312	1/8	1/2
34	02 to 16	3/4	.531	.030	.623	.170	1/16	.375	1/16	5/8
35	17 to 96	3/4	.531	.050	.643	.190	1/8	.375	1/8	5/8
TA04()36	02 to 16	1	.531	.030	.623	.170	1/16	.375	1/16	5/8
37	17 to 96	1	.531	.050	.643	.190	1/8	.375	1/8	5/8

This document is the property of Kirkhill-TA and is conveyed with the express condition that it and the information contained in it are not to be used, disclosed or reproduced in whole or in part, for any purpose without the express written consent of Kirkhill-TA; and that no right is granted to disclose or so use any information contained in said document. These restrictions do not apply to vendor proprietary parts.