

STANDARD KEYSEATS	
Bore Range	Keyseat
inch	
3/8 - 7/16	None
1/2 - 9/16	1/8 X 1/16
5/8 - 7/8	3/16 X 3/32
15/16 - 1 1/4	1/4 X 1/8
1 5/16 - 1 3/8	5/16 X 5/32
1 7/16 - 1 3/4	3/8 X 3/16

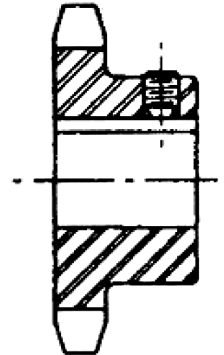

ISO 9001:2000	STYLE	TEETH	DIAMETER	BORE RANGE	LTB	WT. (APPROX.)	
Part Number	Bore	Quantity	Outside	Std.		lbs	
			inch				
35BS9	Bored to Size	9	1.260	3/8	3/4	0.10	
35BS10		10	1.380	3/8 - 5/8		0.11	
35BS11		11	1.500	3/8 - 3/4		0.15	
35BS12		12	1.630	1/2 - 3/4		0.18	
35BS13		13	1.750	1/2 - 3/4		0.20	
35BS14	Bored to Size	14	1.870	1/2 - 3/4	3/4	0.22	
35BS15		15	1.990	1/2 - 1		0.24	
35BS16		16	2.110			0.29	
35BS17		17	2.230			0.36	
35BS18		18	2.350			0.39	
35BS19	Bored to Size	19	2.470		1/2 - 1	3/4	0.44
35BS20		20	2.590	0.51			
35BS21		21	2.710	7/8			0.75
35BS22		22	2.830			0.78	
35BS23		23	2.950			0.78	
35BS24	Bored to Size	24	3.070	1/2 - 1	7/8	0.79	
35BS25		25	3.190			0.80	
35BS26		26	3.310			1/2 - 1 1/4	0.84
35BS27		27	3.430				0.88
35BS28		28	3.550				0.86

**HARDENED TOOTH SPROCKETS AVAILABLE UPON REQUEST**



STANDARD KEYSEATS	
Bore Range	Keyseat
inch	
3/8 - 7/16	None
1/2 - 9/16	1/8 X 1/16
5/8 - 7/8	3/16 X 3/32
15/16 - 1 1/4	1/4 X 1/8
1 5/16 - 1 3/8	5/16 X 5/32
1 7/16 - 1 3/4	3/8 X 3/16

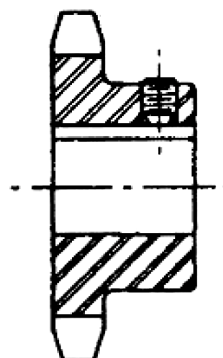

ISO 9001:2000	STYLE	TEETH	DIAMETER	BORE RANGE	LTB	WT. (APPROX.)
Part Number	Bore	Quantity	Outside	Std.		lbs
			inch			
35BS30	Bored to Size	30	3.790	1/2 - 1 1/4	7/8	0.96
35BS32		32	4.030		1.14	
35BS35		35	4.390		1.38	
35BS36		36	4.510		1.41	
35BS40		40	4.990		1.56	
35BS42	Bored to Size	42	5.230	1/2 - 1 1/4	1	1.64
35BS45		45	5.590			1.74
35BS48		48	5.950			1.86
35BS54		54	6.660			1.98
35BS60		60	7.380			2.34
35BS70	Bored to Size	70	8.580	1/2 - 1 1/4	1	3.14
35BS72		72	8.810			3.30
35BS80		80	9.770			3.94
35BS84		84	10.250			4.26
35BS96		96	11.680			5.22
35BS112		112	13.590			6.50

**STAINLESS STEEL, COUPLING, AND SPECIALTY SPROCKETS AVAILABLE UPON REQUEST**