



iCCMT-4060 (6 - 40 GHz)

Intelligent Computer Controlled Microwave Tuner

General

The Focus iCCMT-4060 Intelligent Computer Controlled Microwave Tuner has been designed for 4 to 60 GHz operation, making it an integral part of many load pull and noise setups. The iCCMT-4060 allows for full and accurate characterization of packaged and on-wafer transistors. Optional upgrades include a balancing kit for reliable on-wafer testing, performance-tuned slugs, patented prematch section and low-loss bend lines. The iCCMT-4060 makes use of Focus' proprietary TCP/IP capable iTuner technology with built-in microprocessor and command language, allowing tuning to any interpolated impedance within the tuning range with a typical accuracy of 40dB or better. As such, the iCCMT-4060 can be used with Focus' software or independently by using the Focus ActiveX control. iTuner allows for full customization and integration with popular software applications such as Agilent VEE and LabView.



Specifications

Frequency Range (GHz)	6 - 40
VSWR (min)	≥10:1
VSWR (typical)	12:1
Insertion Loss (dB)	1.0 ¹
Repeatability (min, dB)	- 40
Repeatability (typical, dB)	- 45

Step Size (carriage, μm)	3.18
Phase Resolution @ 6 GHz	0.060° /step
Phase Resolution @ 40 GHz	0.38° /step
Step Size (probe, μm)	1.5
Airline Width (mm)	2.2
Tuner Weight (lbs)	10.7
Shipping Weight (lbs)	30.0 ²
Size	See Dimensions

Model	Connector Type	Power Handling (W, CW) ³	Length A (in)
iCCMT-4060	2.9	10	8.05

Power Supply Specifications

Input (AC) 100-240V, 1.8A Output (DC) 12V, 5A

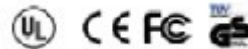

Dimensions

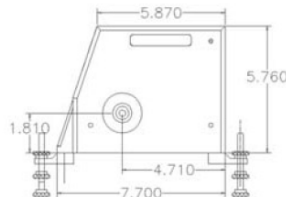
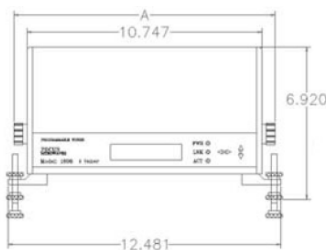

Typical VSWR

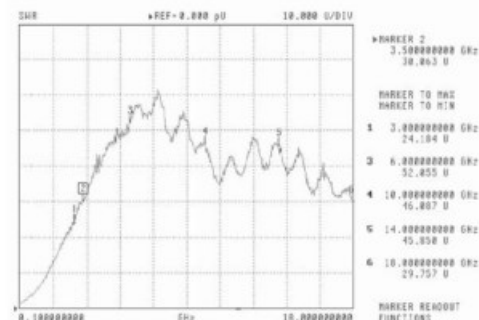

¹ Measured at 40 GHz, probe withdrawn
² Includes packaging and accessories
³ Measured at 10:1 VSWR



Automatic Measurement Systems

1603 St. Regis, Dollard-des-Ormeaux, Quebec, Canada H9B 3H7
T: (514) 684-4554 • F: (514) 684-8581 • W: www.focus-microwaves.com