

A. Electrical Specifications:

P/N	L(uH)	Tol.	Q Min.	TestFreq.(MHz)	SRF Min.(MHz)	DCR Max. (Ω)	Rated Current Max.(A)
CF252018-10N	0.010	M, K, J	15	100	2150	0.26	0.530
CF252018-12N	0.012	M, K, J	15	100	2050	0.27	0.500
CF252018-15N	0.015	M, K, J	15	100	2000	0.29	0.480
CF252018-18N	0.018	M, K, J	15	100	1850	0.31	0.450
CF252018-22N	0.022	M, K, J	15	100	1650	0.37	0.420
CF252018-27N	0.027	M, K, J	15	100	1550	0.40	0.410
CF252018-33N	0.033	M, K, J	20	100	1450	0.42	0.400
CF252018-39N	0.039	M, K, J	20	100	1350	0.45	0.380
CF252018-47N	0.047	M, K, J	20	100	1200	0.50	0.360
CF252018-56N	0.056	M, K, J	20	100	1100	0.60	0.340
CF252018-68N	0.068	M, K, J	20	100	1050	0.65	0.320
CF252018-82N	0.082	M, K, J	20	100	900	0.75	0.300
CF252018-R10	0.100	M, K, J	20	100	800	0.80	0.280
CF252018-R12	0.120	M, K, J	30	25.2	700	0.30	0.550
CF252018-R15	0.150	M, K, J	30	25.2	550	0.35	0.500
CF252018-R18	0.180	M, K, J	30	25.2	500	0.40	0.460
CF252018-R22	0.220	M, K, J	30	25.2	450	0.50	0.430
CF252018-R27	0.270	M, K, J	30	25.2	425	0.55	0.420
CF252018-R33	0.330	M, K, J	30	25.2	400	0.60	0.400
CF252018-R39	0.390	M, K, J	30	25.2	375	0.65	0.375
CF252018-R47	0.470	M, K, J	30	25.2	350	0.68	0.350
CF252018-R56	0.560	M, K, J	30	25.2	325	0.75	0.325
CF252018-R68	0.680	M, K, J	30	25.2	300	0.85	0.300
CF252018-R82	0.820	M, K, J	30	25.2	260	1.00	0.260
CF252018-1R0	1.000	K, J	30	7.96	245	1.10	0.245
CF252018-1R2	1.200	K, J	30	7.96	230	1.20	0.230
CF252018-1R5	1.500	K, J	30	7.96	182	1.30	0.220
CF252018-1R8	1.800	K, J	30	7.96	135	1.45	0.210
CF252018-2R2	2.200	K, J	30	7.96	105	1.55	0.200
CF252018-2R7	2.700	K, J	30	7.96	70	1.70	0.195
CF252018-3R3	3.300	K, J	30	7.96	55	1.90	0.185
CF252018-3R9	3.900	K, J	30	7.96	48	2.10	0.180
CF252018-4R7	4.700	K, J	30	7.96	43	2.30	0.175
CF252018-5R6	5.600	K, J	25	7.96	42	2.50	0.170
CF252018-6R8	6.800	K, J	25	7.96	39	2.70	0.165
CF252018-8R2	8.200	K, J	25	7.96	36	3.05	0.160
CF252018-100	10.00	K, J	25	2.52	33	3.50	0.155
CF252018-120	12.00	K, J	25	2.52	30	3.80	0.150
CF252018-150	15.00	K, J	25	2.52	26	4.40	0.140
CF252018-180	18.00	K, J	25	2.52	24	4.80	0.130
CF252018-220	22.00	K, J	25	2.52	22	5.50	0.125
CF252018-270	27.00	K, J	25	2.52	21	6.30	0.115
CF252018-330	33.00	K, J	25	2.52	20	7.10	0.110
CF252018-390	39.00	K, J	20	2.52	18	9.50	0.090
CF252018-470	47.00	K, J	20	2.52	17	11.10	0.080
CF252018-560	56.00	K, J	20	2.52	16	12.10	0.075
CF252018-680	68.00	K, J	20	2.52	15	16.60	0.070
CF252018-820	82.00	K, J	20	2.52	13	19.00	0.066
CF252018-101	100.0	K, J	15	0.796	12	21.00	0.060

B. Dimensions: mm (Inch)

Series	a	b	c	d	e	f	g	h
CF252018	2.8 (0.110)	2.0 (0.079)	1.8 (0.071)	0.4 (0.016)	1.4 (0.055)	1.5 (0.059)	1.0 (0.039)	1.5 (0.059)

Tol. ±0.3 (0.012) ±0.1 (0.004) ±0.1 (0.004) Typ. ±0.1 (0.004) Typ. Typ. Typ.

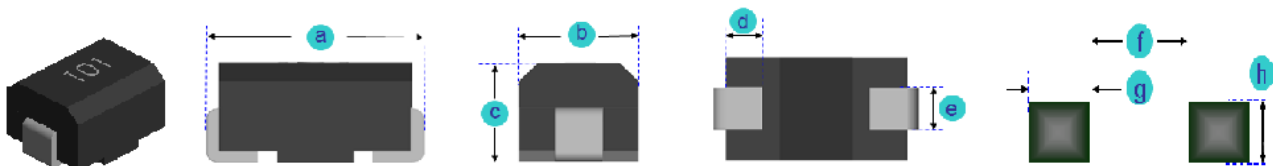

C. General Information:

1. CF252018 –xxx_, “CF252018” = P/N, “xxx” = Inductance, “_” = Tolerance.
2. Tolerance “_”: M = ± 20%, K = ± 10%, J = ± 5%
3. Small and lightweight surface mounting type
4. High Q at high frequency
5. High self-resonance frequency
6. 20°C Temperature Rise, Ambient temperature 80°C Max.
7. Rated Current: Current cause inductance drops within 10% from 0°C to 50°C
8. Resistance to solder heat: 260°C for 10 seconds.
9. Inductance & Q measured with HP4285A Impedance Analyzer
10. SRF measured with HP4291B or HP8753E Network Analyzer
11. DCR measured with the 16502 milliohm meter.
12. Operating temperature: -40°C to +85°C
13. Storage Temperature Range: -40°C to +85°C
14. Inductance and Current Range: From 0.010 uH (0.530 A) to 100 uH (0.060 A)
15. SRF: From 12 MHz to 2150 MHz
16. DCR: From 0.26 OHM to 21.0 OHM
17. MSL: Level 1.

D. Applications:

1. Game Consoles
2. Set Top Boxes
3. Cables Modems
4. Computers
5. Mobile Communication Devices (Cell Phones, Radios, etc.)

E. Characteristics Curve:

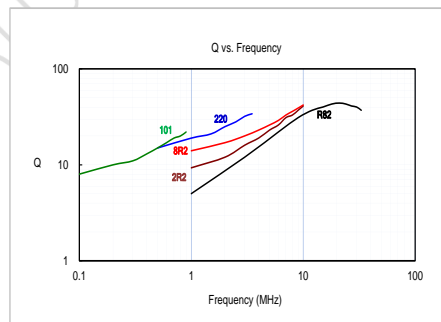
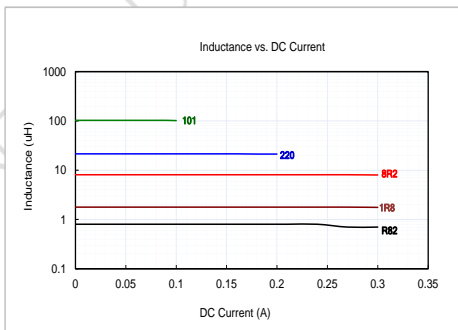

F. Supplementary Information:

1. Packaging Information

CARRIER TAPE REELS

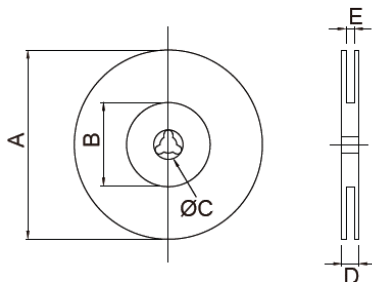

TAPE DIMENSIONS (mm)

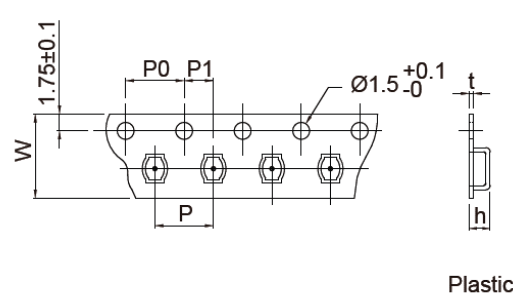



Series P/N	Reel dimensions (mm)					Tape dimensions (mm)						Parts per reel		Quantity per	
	A	B	C	D	E	W	P	P0	P1	h	t	7"	13"	Box	Carton
CF252018	180	50	13	12.5	8.5	8	4	4	2	2.10	0.30	2,000	---	10,000	60,000

2. RoHS Reflow Solder Profile

Typical RoHS Reflow Profile

