

A. Electrical Specifications:

P/N	L (nH)	Tol.	L Test Freq. (MHz)	Q Typ.	Q Test Freq. (MHz)	SRF Min. (MHz)	DCR Max. (mΩ)	I rms. Max. (A)	1 st Color	2 nd Color	3 rd Color
1812CP-82N_	82	K, J, G	50	70	50	800	60	1.500	Gray	Red	Black
1812CP-R10_	100	K, J, G	50	70	50	850	110	1.150	Brown	Black	Brown
1812CP-R15_	150	K, J, G	50	75	50	860	110	1.150	Brown	Green	Brown
1812CP-R18_	180	K, J, G	50	80	50	850	110	1.150	Brown	Gray	Brown
1812CP-R22_	220	K, J, G	50	80	50	700	105	0.940	Red	Red	Brown
1812CP-R27_	270	K, J, G	50	85	50	730	120	0.940	Red	Violet	Brown
1812CP-R33_	330	K, J, G	50	80	50	600	135	0.850	Orange	Orange	Brown
1812CP-R39_	390	K, J, G	50	80	50	600	140	0.850	Orange	White	Brown
1812CP-1R2_	1200	K, J, G	50	62	50	230	1200	0.480	Brown	Red	Red

B. Dimensions: mm (Inch)

Series	a	b	c	f	g	h
1812CP	4.95(0.195)	3.8 (0.150)	3.43 (0.135)	3.0 (0.118)	1.14 (0.045)	3.05 (0.120)
	Max.	Max.	Max.	Typ.	Typ.	Typ.

C. Color coding:

- Parts are marked with 3 color dots. The table at below shows the significance of each color.
- Dots 1 and 2 indicate the inductance in nano-Henries.
- Dot 3 indicates number of zeroes to be added.

0 = Black	5=Green
1 = Brown	6=Blue
2 = Red	7 = Violet
3 = Orange	8 = Gray
4 = Yellow	9 = White

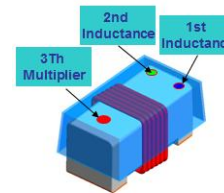

D. General Information:

- P/N: 1812CP-xxx_, “1812CP” = Size Type, “xxx” = Inductance, “_” = Tolerance.
- Tolerance “_”: K = ± 10%, J = ± 5%, G = ± 2%.
- Small and lightweight surface mounting type.
- High Q at high frequency & High self-resonance frequency.
- For 15°C Temperature Rise at 25°C ambient.
- Inductance & Q measured with HP4291B Impedance Analyzer.
- SRF measured using the HP8720D or HP8753E Network Analyzer.
- DCR measured using the 16502 milliohm meter.
- Operating temperature: -40°C to +125°C.
- This series has no color code due to the size is small.
- Inductance and Current Range: From 82 nH (1.5 A) to 1200 nH (0.480 A)
- SRF: From 230 MHz to 860 MHz
- MSL: Level 1.

E. Applications:

- Game Consoles
- Set Top Boxes
- Cables Modems
- Computers
- Mobile Communication Devices (Cell Phones, Radios, etc.)
- RF Filters

F. Characteristics Curve:

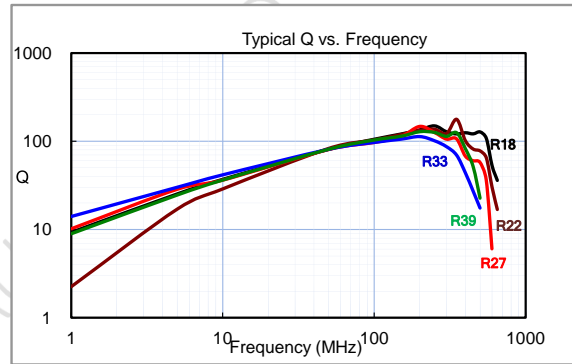
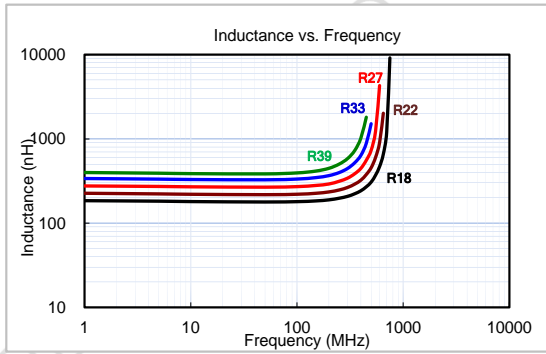

G. Supplementary Information:

1. Packaging Information

CARRIER TAPE REELS

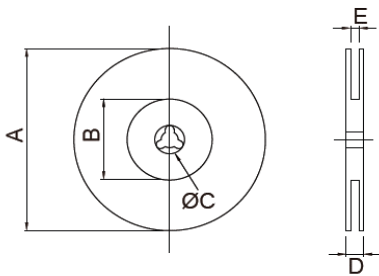

TAPE DIMENSIONS (mm)

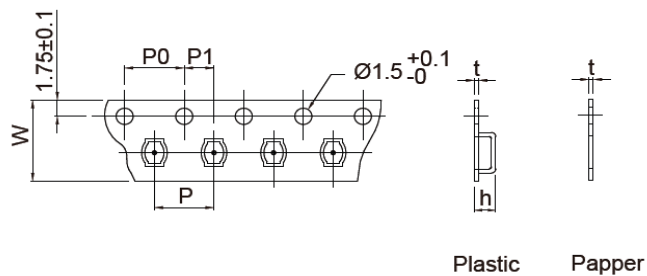

Series P/N	Reel dimensions (mm)					Tape dimensions (mm)						Parts per reel		Quantity per	
	A	B	C	D	E	W	P	P0	P1	h	t	7"	13"	Box	Carton
1812CP	178	21	13	14.4	8.5	12	8	4	2	3.60	0.35	600	---	3,000	180,000

2. RoHS Reflow Solder Profile

Typical RoHS Reflow Profile

