

A. Electrical Specifications:

P/N	L (nH)	Tol.	L Test Freq. (MHz)	Q Min.	Q Test Freq. (MHz)	SRF Min. (GHz)	DCR Max. (Ω)	I rms. Max. (A)	1 st Color	2 nd Color	3 rd Color
1008CP-5N6	5.6	K, J	50	50	1500	4.00	0.15	1.00	Green	Blue	Black
1008CP-10N	10	K, J	50	50	500	4.10	0.08	1.00	Brown	Black	Black
1008CP-12N	12	K, J	50	50	500	3.30	0.09	1.00	Brown	Red	Black
1008CP-15N	15	K, J	50	50	500	2.50	0.10	1.00	Brown	Green	Black
1008CP-18N	18	K, J, G	50	50	350	2.50	0.11	1.00	Brown	Gray	Black
1008CP-22N	22	K, J, G	50	55	350	2.40	0.12	1.00	Red	Red	Black
1008CP-24N	24	K, J, G	50	50	350	1.50	0.13	1.00	Red	Yellow	Black
1008CP-27N	27	K, J, G	50	55	350	1.60	0.13	1.00	Red	Violet	Black
1008CP-33N	33	K, J, G	50	60	350	1.60	0.14	1.00	Orange	Orange	Black
1008CP-36N	36	K, J, G	50	60	350	1.60	0.15	1.00	Orange	Blue	Black
1008CP-39N	39	K, J, G	50	60	350	1.50	0.15	1.00	Orange	White	Black
1008CP-47N	47	K, J, G	50	65	350	1.50	0.16	1.00	Yellow	Violet	Black
1008CP-56N	56	K, J, G	50	65	350	1.30	0.18	1.00	Green	Blue	Black
1008CP-62N	62	K, J, G	25	45	350	1.25	0.20	1.00	Blue	Red	Black
1008CP-68N	68	K, J, G	50	65	350	1.30	0.20	1.00	Blue	Gray	Black
1008CP-75N	75	K, J, G	50	60	350	1.10	0.21	1.00	Violet	Green	Black
1008CP-82N	82	K, J, G	50	60	350	1.00	0.22	1.00	Gray	Red	Black
1008CP-91N	91	K, J, G	50	50	350	1.00	0.45	1.00	White	Brown	Black
1008CP-R10	100	K, J, G	25	60	350	1.00	0.56	0.650	Brown	Black	Brown
1008CP-R12	120	K, J, G	25	60	350	0.950	0.63	0.650	Brown	Red	Brown
1008CP-R15	150	K, J, G	25	45	100	0.850	0.70	0.580	Brown	Green	Brown
1008CP-R18	180	K, J, G	25	45	100	0.750	0.77	0.620	Brown	Gray	Brown
1008CP-R20	200	K, J, G	25	50	100	0.750	0.81	0.500	Red	Black	Brown
1008CP-R22	220	K, J, G	25	45	100	0.700	0.84	0.500	Red	Red	Brown
1008CP-R24	240	K, J, G	25	50	100	0.600	0.84	0.500	Red	Yellow	Brown
1008CP-R27	270	K, J, G	25	45	100	0.600	0.91	0.500	Red	Violet	Brown
1008CP-R30	300	K, J, G	25	40	100	0.500	1.05	0.660	Orange	Black	Brown
1008CP-R33	330	K, J, G	25	45	100	0.570	1.05	0.450	Orange	Orange	Brown
1008CP-R36	360	K, J, G	25	40	100	0.500	1.05	0.660	Orange	Blue	Brown
1008CP-R39	390	K, J, G	25	45	100	0.500	1.12	0.470	Orange	White	Brown
1008CP-R43	430	K, J, G	25	45	100	0.425	1.19	0.600	Yellow	Orange	Brown
1008CP-R47	470	K, J, G	25	45	100	0.450	1.19	0.470	Yellow	Violet	Brown
1008CP-R56	560	K, J, G	25	45	100	0.415	1.33	0.400	Green	Blue	Brown
1008CP-R62	620	K, J, G	25	45	100	0.375	1.40	0.300	Blue	Red	Brown
1008CP-R68	680	K, J, G	25	45	100	0.375	1.47	0.400	Blue	Gray	Brown
1008CP-R75	750	K, J, G	25	45	100	0.360	1.54	0.360	Violet	Green	Brown
1008CP-R82	820	K, J, G	25	45	100	0.350	1.61	0.400	Gray	Red	Brown
1008CP-R91	910	K, J, G	25	35	50	0.320	1.68	0.380	White	Brown	Brown
1008CP-1R0	1000	K, J, G	25	35	50	0.290	1.75	0.370	Brown	Black	Red
1008CP-1R2	1200	K, J, G	7.9	35	50	0.250	2.00	0.310	Brown	Red	Red
1008CP-1R5	1500	K, J, G	7.9	28	50	0.200	2.30	0.330	Brown	Green	Red
1008CP-1R8	1800	K, J, G	7.9	28	50	0.160	2.60	0.300	Brown	Gray	Red
1008CP-2R0	2000	K, J, G	7.9	25	50	0.160	2.80	0.280	Red	Black	Red
1008CP-2R2	2200	K, J, G	7.9	28	50	0.160	2.80	0.280	Red	Red	Red
1008CP-2R7	2700	K, J, G	7.9	22	25	0.140	3.20	0.290	Red	Violet	Red
1008CP-3R3	3300	K, J, G	7.9	22	25	0.110	3.40	0.290	Orange	Orange	Red
1008CP-3R9	3900	K, J, G	7.9	20	25	0.100	3.60	0.260	Orange	White	Red
1008CP-4R7	4700	K, J, G	7.9	20	25	0.090	4.00	0.260	Yellow	Violet	Red
1008CP-5R6	5600	K, J	7.9	16	7.96	0.020	4.00	0.240	Green	Blue	Red
1008CP-6R8	6800	K, J	7.9	15	7.96	0.040	4.90	0.200	Blue	Gray	Red
1008CP-8R2	8200	K, J	7.9	15	7.96	0.025	6.00	0.170	Gray	Red	Red
1008CP-100	10000	K, J	2.52	15	7.96	0.020	9.00	0.150	Brown	Black	Orange
1008CP-120	12000	K, J	2.52	15	7.96	0.018	10.5	0.130	Brown	Red	Orange
1008CP-150	15000	K, J	2.52	15	7.96	0.015	11.5	0.120	Brown	Green	Orange

B. Dimensions: mm (Inch)

Series	a	b	c	d	e	f	g	h
1008CP	2.92(0.115)	2.79(0.110)	2.03(0.080)	0.51(0.020)	1.52(0.060)	1.27(0.050)	1.02(0.040)	2.54(0.100)
Tol.	Max.	Max.	Max.	Typ.	Typ.	Typ.	Typ.	Typ.

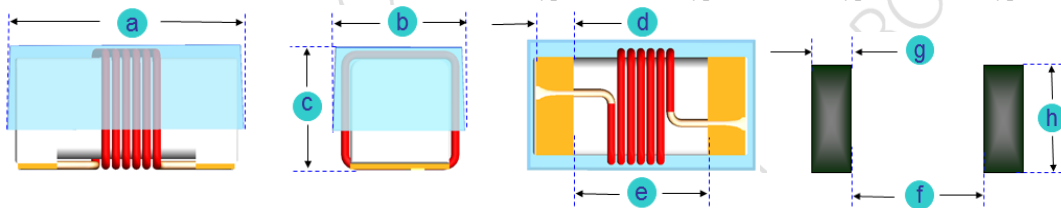

C. Color coding:

1. Parts are marked with 3 color dots. The table at below shows the significance of each color.
2. Dots 1 and 2 indicate the inductance in nano-Henries.
3. Dots 3 indicate number of zeroes to be added.

0 = Black	5 = Green
1 = Brown	6 = Blue
2 = Red	7 = Violet
3 = Orange	8 = Gray
4 = Yellow	9 = White

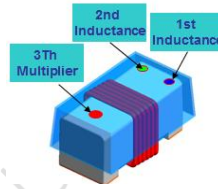

D. General Information:

1. P/N: 1008CP-xxx_, “1008CP” = Size Type, “CP” = Tinned pad, “xxx” = Inductance, “_” = Tolerance.
2. Tolerance “_”: K = ± 10%, J = ± 5%, G = ± 2%.
3. Small and lightweight surface mounting type.
4. High Q at high frequency & High self-resonance frequency.
5. For 15°C Temperature Rise at 25°C ambient.
6. Inductance & Q measured with HP4291B Impedance Analyzer.
7. SRF measured using the HP8720D or HP8753E Network Analyzer.
8. DCR measured using the 16502 milliohm meter.
9. Operating temperature: -40°C to +125°C.
10. This series has no color code due to the size is small.
11. Inductance and Current Range: From 10 nH (1.0A) to 4700 nH (0.260A)
12. SRF: From 0.09 GHz to 4.1 GHz
13. MSL: Level 1.

E. Applications:

1. Game Consoles
2. Set Top Boxes
3. Cables Modems
4. Computers
5. Mobile Communication Devices (Cell Phones, Radios, etc.)
6. RF Filters

F. Characteristics Curve:

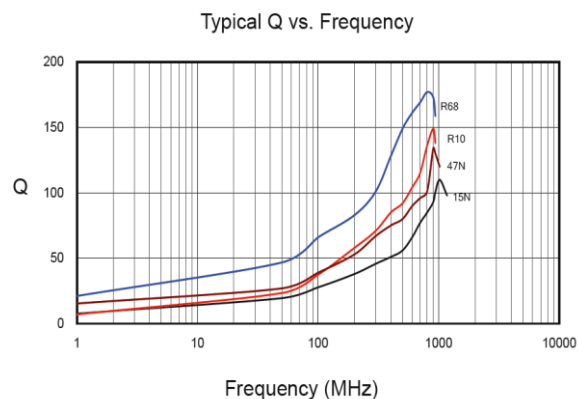
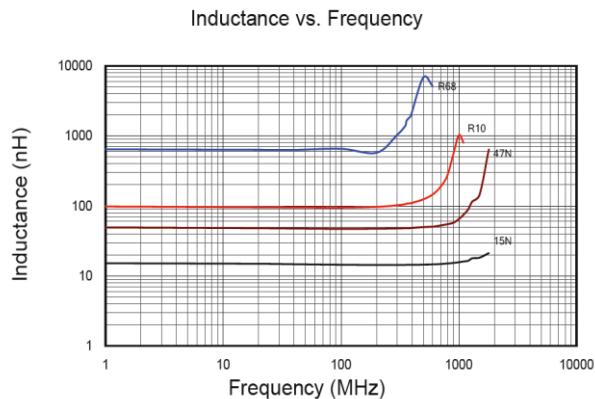

G. Supplementary Information:

1. Packaging Information

CARRIER TAPE REELS

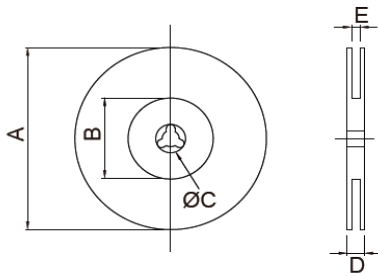

TAPE DIMENSIONS (mm)

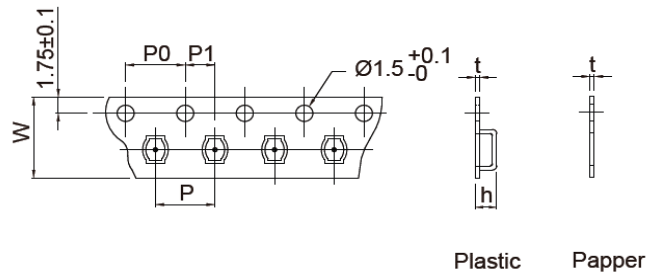

Plastic Paper

Series P/N	Reel dimensions (mm)					Tape dimensions (mm)						Parts per reel		Quantity per	
	A	B	C	D	E	W	P	P0	P1	h	t	7"	13"	Box	Carton
1008CP	180	75	13	12.5	8.5	8	4	4	2	2.30	0.25	2,000	---	10,000	60,000

2. RoHS Reflow Solder Profile

Typical RoHS Reflow Profile

