

## A. Electrical Specifications:

| P/N           | Inductance (nH) | Tolerance | Mark | Q (Min.) | Test Freq. |
|---------------|-----------------|-----------|------|----------|------------|
| OI0604DV-R15_ | 150             | K, J, H   | R15  | 80       | 40MHz      |
| OI0604DV-R18_ | 180             | K, J, H   | R18  | 80       | 40MHz      |
| OI0604DV-R27_ | 270             | K, J, H   | R27  | 80       | 40MHz      |
| OI0604DV-R33_ | 330             | K, J, H   | R33  | 80       | 40MHz      |

## B. Dimensions: mm (Inch)

| Series   | a              | b              | c              | d              | e              | f              |
|----------|----------------|----------------|----------------|----------------|----------------|----------------|
| OI0604DV | 6.0<br>(0.236) | 4.5<br>(0.177) | 6.5<br>(0.256) | 2.0<br>(0.079) | 0.7<br>(0.028) | 3.3<br>(0.130) |
| Tol.     | Max.           | Max.           | Max.           | Typ.           | Typ.           | Typ.           |

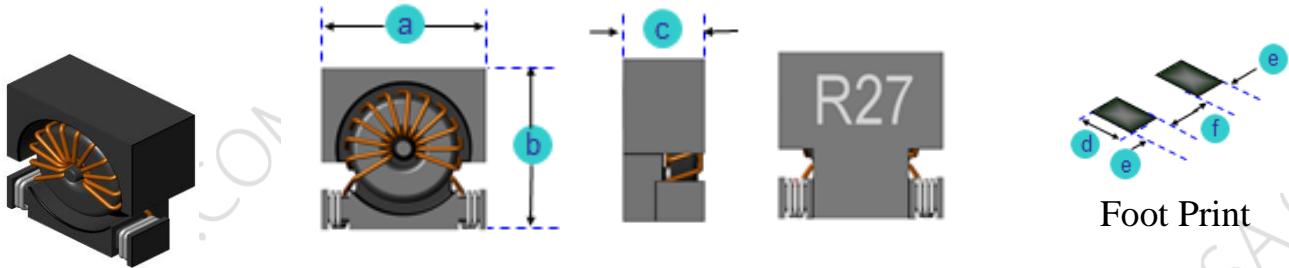

## C. General Information:

1. P/N: OI0604DV-xxx\_: "OI0604DV" = Series, "xxx" = Inductance, "\_" = Tolerance.
2. Tolerance "\_": K =  $\pm 10\%$ , J =  $\pm 5\%$ , H =  $\pm 3\%$ .
3. Operating Temp. : -25°C to +85°C.
4. Inductance measured using the HP4291B or HP4287A.
5. Q measured using the HP4291B or HP4287A.
6. Test Fixture: HP16193A.
7. MSL: Level 1

## D. Applications:

1. LC filters, for CATV diplex filters.

## E. Supplementary Information:

### 1. Packaging Information

CARRIER TAPE REELS

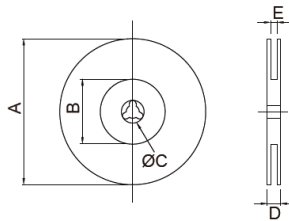

TAPE DIMENSIONS (mm)

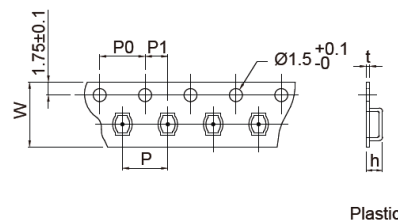

| Series<br>P/N | Reel dimensions (mm) |     |    |      |      | Tape dimensions (mm) |    |    |    |      |      | Parts per reel |     | Quantity per |        |
|---------------|----------------------|-----|----|------|------|----------------------|----|----|----|------|------|----------------|-----|--------------|--------|
|               | A                    | B   | C  | D    | E    | W                    | P  | P0 | P1 | h    | t    | 7"             | 13" | Box          | Carton |
| OI0604DV      | 340                  | 100 | 13 | 20.5 | 16.5 | 16                   | 12 | 4  | 2  | 6.50 | 0.40 | ---            | 700 | 1,400        | 4,200  |



2. RoHS Reflow Solder Profile

Typical RoHS Reflow Profile

