

### A. Electrical Specifications:

P/N	L (nH)	Tol.	L Test Freq. (MHz)	Q Min.	Q Test Freq. (MHz)	SRF Min. (GHz)	DCR (mΩ) Max.	I <sub>rms</sub> (A)	COLOR CODE
0805HQ-2N5_	2.5	J	250	80	1500	10.3	20	1.6	Black
0805HQ-5N6_	5.6	J	250	98	1500	6.10	35	1.6	Brown
0805HQ-6N2_	6.2	J	250	88	1000	4.75	35	1.6	Red
0805HQ-12N_	12	J, G	250	80	1000	3.00	45	1.6	Orange
0805HQ-16N_	16	J, G	250	72	500	2.95	60	1.5	Yellow
0805HQ-18N_	18	J, G	250	75	500	2.55	60	1.4	Green
0805HQ-20N_	20	J, G	250	70	500	2.05	55	1.4	Blue
0805HQ-27N_	27	J, G	250	75	500	2.00	70	1.3	Violet
0805HQ-30N_	30	J, G	250	65	500	1.95	95	1.2	Gray
0805HQ-39N_	39	J, G	250	65	500	1.60	110	1.1	White
0805HQ-48N_	48	J, G	200	65	500	1.40	95	1.2	Black
0805HQ-51N_	51	J, G	200	65	500	1.40	120	1.0	Brown

Note: 1. Termination: Tin plating is standard.

### B. Dimensions: mm (Inch)

Series	a	b	c	f	g	h
0805HQ	2.4 (0.0945)	1.65 (0.0650)	1.45 (0.0571)	0.76 (0.030)	1.02 (0.0402)	1.78(0.0701)
Tol.	MAX.	MAX.	MAX.	Typ.	Typ.	Typ.

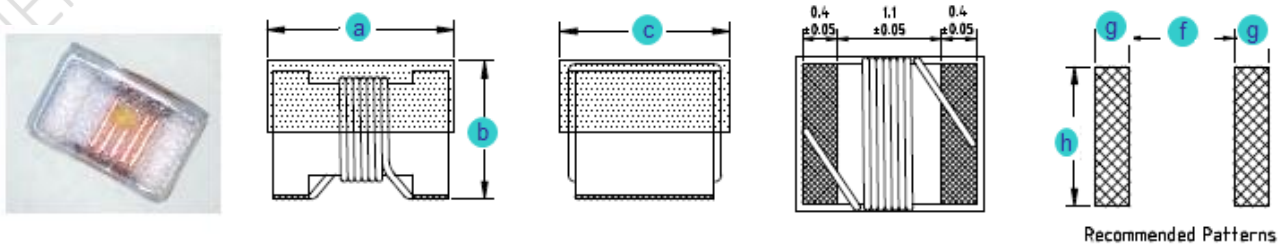

### C. General Information:

1. P/N: 0805HQ-xxx\_, “0805HQ” = Size Type, “xxx” = Inductance, “\_” = Tolerance.
2. Tolerance “\_”: J = ± 5%, G = ± 2%.
3. Small and lightweight surface mounting type.
4. High Q at high frequency & High self-resonance frequency.
5. For 15°C Temperature Rise at 25°C ambient.
6. Inductance & Q measured with 4287A with 16197A.
7. SRF measured using the HP8753E or HP4291B with 16193A/ENA5017C or equivalent.
8. DCR measured using the Agilent 4338B.
9. Operating temperature: -40°C to +125°C.
10. MSL: Level 1.

### D. Applications:

1. Game Consoles
2. Set Top Boxes
3. Cables Modems
4. Computers
5. Mobile Communication Devices (Cell Phones, Radios, etc.)
6. RF Filters

### E. Characteristics Curve:

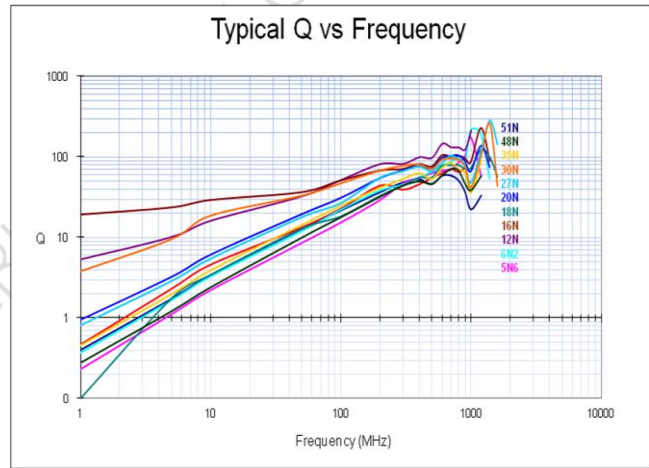
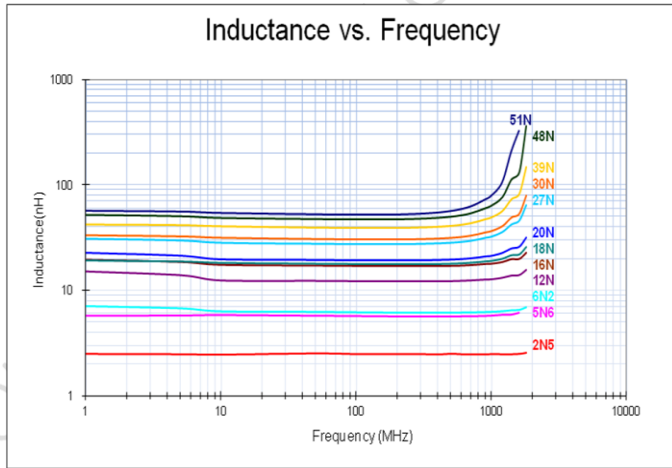

### F. Supplementary Information:

#### 1. Packaging Information

##### CARRIER TAPE REELS

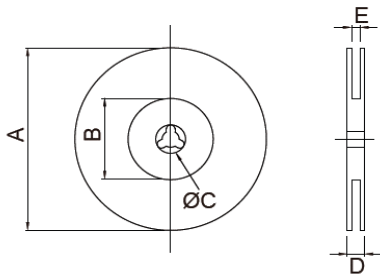

##### TAPE DIMENSIONS (mm)

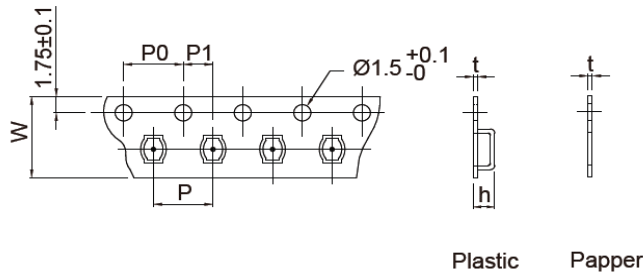

Series P/N	Reel dimensions (mm)					Tape dimensions (mm)						Parts per reel		Quantity per	
	A	B	C	D	E	W	P	P0	P1	h	t	7"	13"	Box	Carton
0805HQ	178	75	13	12.5	8.5	8	4	4	2	---	---	3,000	---	15,000	90,000

#### 2. RoHS Reflow Solder Profile

##### Typical RoHS Reflow Profile

