

NOSE ASSEMBLY DATA SHEET

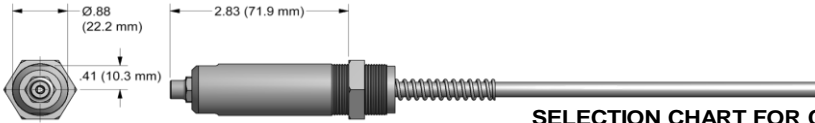

SELECTION CHART FOR COUNTERSUNK AND PROTRUDING HEAD RIVETS

RIVET	DIA.	NOSE ASSEMBLY	NOSE TIP	FOLLOWER
AVEX® (1624 PROTRUDING HEAD)	3/16	AV6-743-24SRV	10248-7	703433
AVEX® (1624 COUNTERSUNK HEAD)	3/16	6C-743-24SRV	10248-8	703433
AVSEAL®	10mm	ASM10-743-24SRV	10173	703433
BULB-TITE® (STRUCTURAL)	1/4	BT08-743-24SRV	10391	703433
KLAMPTITE® RIVET	3/16	6KT-743-24SRV	10263	703433
	1/4	8KT-743-24SRV	10262	703433
MILLIMETER SEAL PLUG	5mm	6N-743-24SRV	10204	703433
POP® OPEN END NAIL RIVET	5/32	5N-743-24SRV	10203	703433
	3/16	6N-743-24SRV	10204	703433
	1/4	8N-743-24SRV	10211	703433
POP® CLOSED END NAIL RIVET (ALUMINUM MANDREL)	5/32	5CEA-743-24SRV	13472	703433
	3/16	6CEA-743-24SRV	13473	703433
POP® CLOSED END NAIL RIVET (STEEL MANDREL)	5/32	5CES-743-24SRV	13476	703433
	3/16	6CES-743-24SRV	13477	703433
	1/4	8CES-743-24SRV	13469	703433
PLASTIC SPLIT	3/16	6P-743-24SRV	10167	703433
	1/4	8P-743-24SRV	10166	703433
T RIVET®	3/16	6T-743-24SRV	10209	703433
	1/4	8T-743-24SRV	10286	703433
TLR® RIVET	1/4	8TLR-743-24SRV	10246	703433

SELECTION CHART FOR PROTRUDING HEAD RIVETS ONLY

RIVET	DIA.	NOSE ASSEMBLY	NOSE TIP	FOLLOWER
N, Q & E, POP®, CLOSED END, AVEX®, MAGNA-LOK®, MAGNA-BULB, HEMLOK®, BULB-TITE® (NON-STRUCTURAL) & ULTRA-GRIP COMMERCIAL RIVETS (1)	3/16	MGL06-743-24SRV	10170	703433
	1/4	MGL08-743-24SRV	10205	703433

1. FOR HIGH PRODUCTION SERRATED STEM APPLICATIONS USE PH6 & PH8-734-20SRV.

POP® IS A REGISTERED TRADEMARK OF BLACK & DECKER CO. MAGNA-LOK® IS A REGISTERED TRADEMARK OF HUCK INTERNATIONAL INC. AVEX®, T RIVETS®, KLAMPTITE®, AVSEAL® & MONOBOLT® ARE REGISTERED TRADEMARKS OF AVDEL/CHERRY. TEXTRON BULB-TITE® IS A REGISTERED TRADEMARK OF GESIPA.

9/08 REV. 11/16

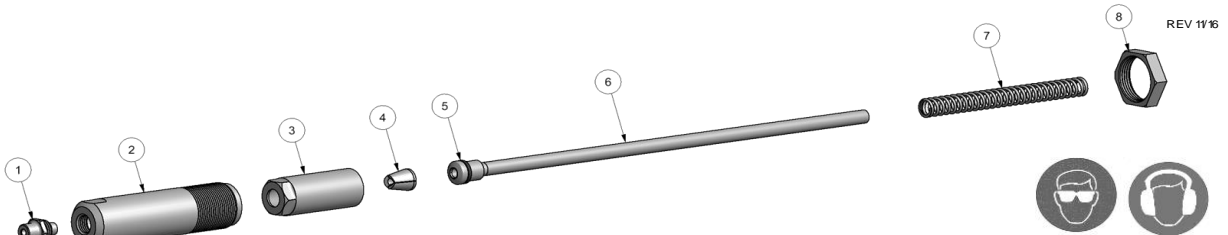

GAGE BILT
MADE in USA

44766 Centre Court Clinton Twp. MI 48038 USA
Ph: +1 (586) 226-1500 Fax: +1 (586) 226-1505
solutions@gagebilt.com / www.gagebilt.com

Type:		Fasteners:	Recommended Tool:
Self-Releasing		See Chart	GB743
Ref. No.	Qty.	Description	XX-743-24SRV
1	1	Nose Tip	See Chart
2	1	Anvil Holder	10951
3	1	Collet	20867
4	1	Jaw Set	30824
5	1	O'Ring	400777
6	1	Follower	703433
7	1	Spring	50626
8	1	Jam Nut	70820