

# NOSE ASSEMBLY DATA SHEET

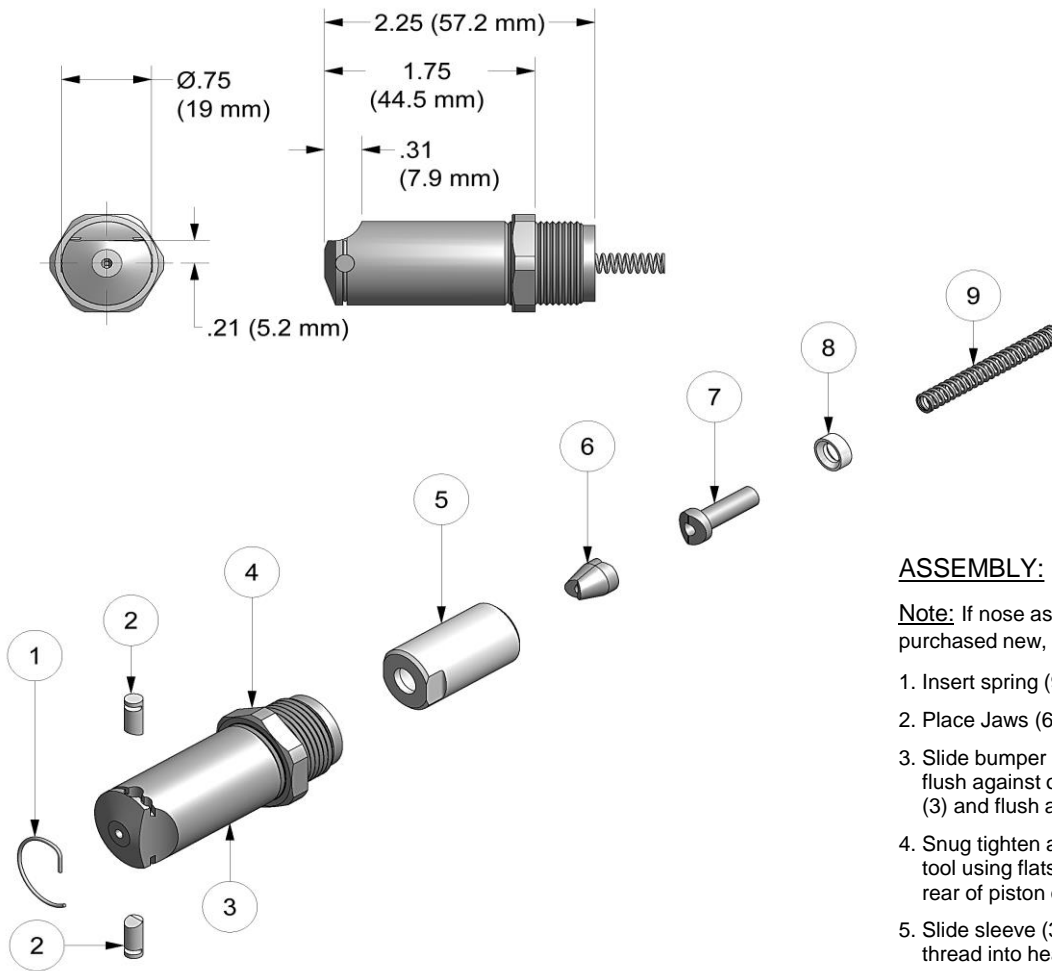

## ASSEMBLY:

**Note:** If nose Assy is assembled as it is when purchased new, follow steps 4-6 to attach to tool.

1. Insert spring (9) into piston i.d. of tool.
2. Place Jaws (6) into collet (5). (Note direction).
3. Slide bumper (8) onto follower (5) and slide flush against o.d. Insert follower (7) into collet (3) and flush against rear of jaw set (6).
4. Snug tighten assembled collet (5) to piston on tool using flats provided on collet (5) and hex in rear of piston on tool.
5. Slide sleeve (3) over assembled collet (3) and thread into head cylinder on tool.
6. Tighten jam nut (4) securely.

## DISASSEMBLY:

Reverse assembly instructions.

3/06 Rev. 9/16



# GAGE BILT

MADE in USA

44766 Centre Court Clinton Twp. MI 48038 USA  
 Ph: +1 (586) 226-1500 Fax: +1 (586) 226-1505  
[solutions@gagebilt.com](mailto:solutions@gagebilt.com) / [www.gagebilt.com](http://www.gagebilt.com)

Type:		Fastener:		Recommended Tool: GB704
Non Self-Releasing 3/32" Ø		NUT PLATE BACR15CC/CF/DA/DR		
Ref. No.	Qty.	Description	<b>3NP-704-17</b>	
1	1	Retaining Ring	70101	
2	2	Stem Stop	70102	
3	1	Sleeve	12213	
4	1	Jam Nut	70104	
5	1	Collet	70105	
6	1	Jaw Set (2 pcs.)	30513	
7	1	Follower	40506	
8	1	Bumper	70108	
9	1	Spring	70109	