

NOSE ASSEMBLY DATA SHEET

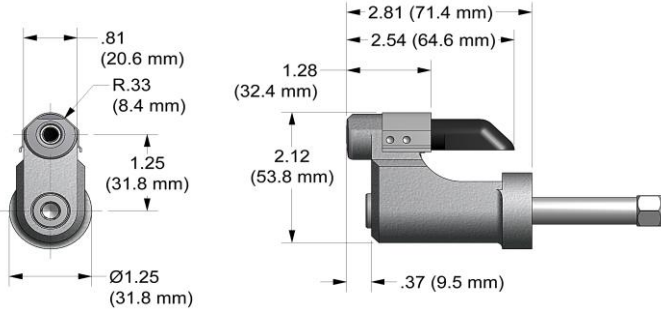

CAUTION:
Pintail may eject forcibly. USE DEFLECTOR TO PREVENT SEVERE PERSONAL INJURY. Cap (9) use for closed access applications only or when clearance is an issue!

NOTE:
Yellow logo designates nose assy's for lightweight GP® fasteners.

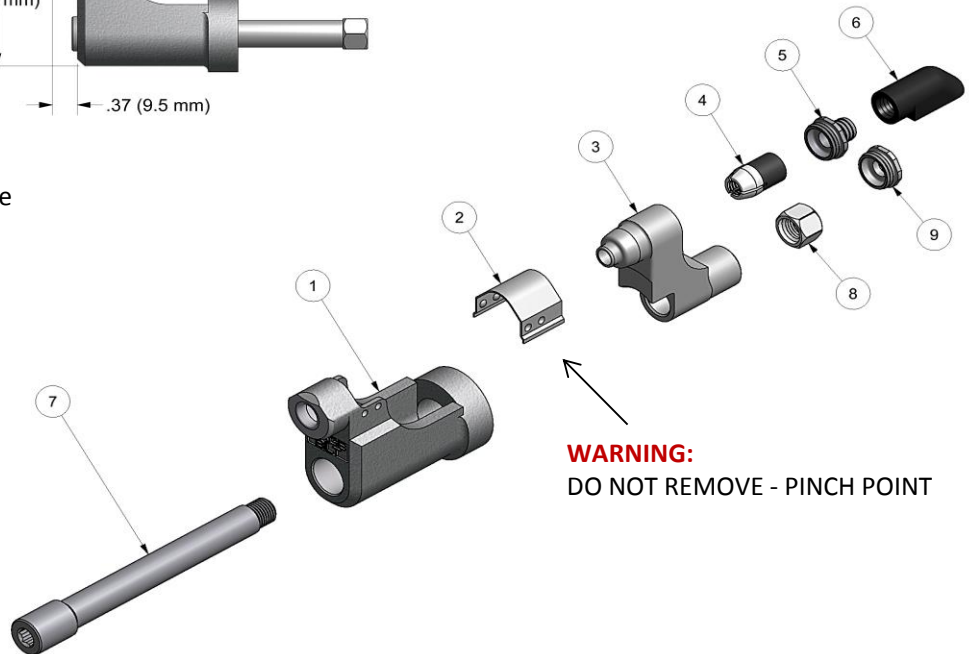

WARNING:
DO NOT REMOVE - PINCH POINT

ASSEMBLY INSTRUCTIONS:

Disconnect tool from power source. On front of GB204 Installation tool, remove screw and stop. With collet placed in anvil install on tool. Apply Vibra-TITE® part no. 405124 to threads on drawbar. Slide drawbar thru anvil and collet. Screw nut "counterbore in" on rear of drawbar. Connect tool to power source. Cycle the tool to rear position. While holding the actuator down, disconnect tool from power source. Using a 1/4" hex wrench and a 1/2" socket wrench, tighten nut on the drawbar. Replace screw and stop on tool.



*Use Adapter No. 751204.

**Use Adapter No. 353204.

REV 8/16

GAGE BILT
MADE in USA

44766 Centre Court Clinton Twp. MI 48038 USA
Ph: +1 (586) 226-1500 Fax: +1 (586) 226-1505
solutions@gagebilt.com / www.gagebilt.com

Type:		Fasteners:	Recommended Tool:
Non Self-Releasing 1/4" Ø		LGP® Lockbolt	GB204/GB204A
			Alternate Tools: **GB745 & *GB731
Ref. No.	Qty.	Description	LGP08-204D-300S
1	1	Anvil Assy (Inc. 61108 Rubber Guard)	18849
2	1	Guard	60426
3	1	Collet	28834
4	1	Super-Grip Jaw Assy	30875-S1
5	1	Barbed Retainer	70654
6	1	Deflector	61107
7	1	Drawbar	71116
8	1	Nut	71114
9	1	Cap	70655