

NOSE ASSEMBLY DATA SHEET

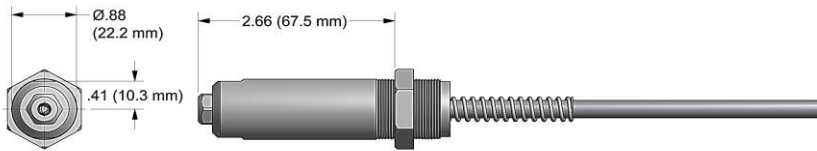

SELECTION CHART FOR COUNTERSUNK AND PROTRUDING HEAD RIVETS

RIVET	DIA.	NOSE ASSEMBLY	NOSE TIP
AVEX® (1624 PROTRUDING HEAD)	3/16	AV6-743-24V	10248-7
AVEX® (1624 COUNTERSUNK HEAD)	3/16	6C-743-24V	10248-8
AVSEAL®	10mm	ASM10-743-24V	10173
BULB-TITE® (STRUCTURAL)	3/16	BT06-743-24V	12282-1
	1/4	BT08-743-24V	10391
	9/32	BT09-743-24V	10289
KLAMP-TITE® (STRUCTURAL) RIVET	3/16	6KT-743-24V	10263
	1/4	8KT-743-24V	10262
MILLIMETER SEAL PLUG	4mm	5N-743-24V	10203
	5mm	6N-743-24V	10204
POP® OPEN END NAIL RIVET	5/32	5N-743-24V	10203
	3/16	6N-743-24V	10204
	1/4	8N-743-24V	10211
POP® CLOSED END NAIL RIVET (ALUMINUM MANDREL)	5/32	5CEA-743-24V	13472
	3/16	6CEA-743-24V	13473
POP® CLOSED END NAIL RIVET (STEEL MANDREL)	5/32	5CES-743-24V	13476
	3/16	6CES-743-24V	13477
	1/4	8CES-743-24V	13469
PLASTIC SPLIT	3/16	6P-743-24V	10167
	1/4	8P-743-24V	10166
T RIVET®	3/16	6T-743-24V	10209
	1/4	8T-743-24V	10286

SELECTION CHART FOR PROTRUDING HEAD RIVETS ONLY

RIVET	DIA.	NOSE ASSEMBLY	NOSE TIP
N, Q & E, POP®, CLOSED END, AVEX®, MAGNA-LOK®, MAGNA-BULB®, HEMLOK®, KLAMP-TITE®, BULB-TITE® (NON-STRUCTURAL) & ULTRA-GRIP® COMMERCIAL RIVETS (1)	3/16	MGL06-743-24V	10170
	1/4	MGL08-743-24V	10205

1. FOR HIGH PRODUCTION SERRATED STEM APPLICATIONS USE PH6 & PH8-734A-20V.

POP® AND ULTRA-GRIP® ARE REGISTERED TRADEMARKS OF EMHART TECHNOLOGIES. AVEX®, AVSEAL®, HEMLOK®, AND KLAMP-TITE® ARE REGISTERED TRADEMARKS OF AVDEL UK LIMITED. MAGNA-LOK® AND MAGNA-BULB® ARE REGISTERED TRADEMARKS OF ALCOA INC. T RIVET® IS A REGISTERED TRADEMARK OF CHERRY AEROSPACE FASTENERS. BULB-TITE® IS A REGISTERED TRADEMARK OF GESIPA FASTENERS USA, INC.

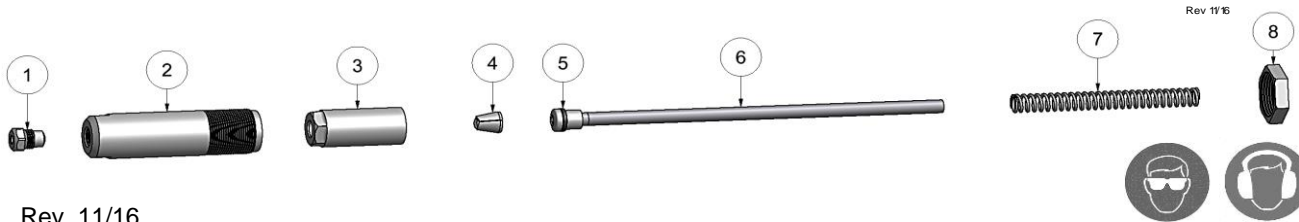

Rev. 11/16

GAGE BILT
MADE in USA

44766 Centre Court Clinton Twp. MI 48038 USA
Ph: +1 (586) 226-1500 Fax: +1 (586) 226-1505
solutions@gagebilt.com / www.gagebilt.com

Type:		Fasteners:		Recommended Tool:	
Self-Releasing		See Chart		GB743	
Ref. No.	Qty.	Description		XX-743-24V	
1	1	Nose Tip		See Chart	
2	1	Anvil Holder		10951	
3	1	Collet		20867	
4	1	Jaw Set		30824	
5	1	O'Ring		400777	
6	1	Follower		703401	
7	1	Spring		50626	
8	1	Jam Nut		70820	