

NOSE ASSEMBLY DATA SHEET

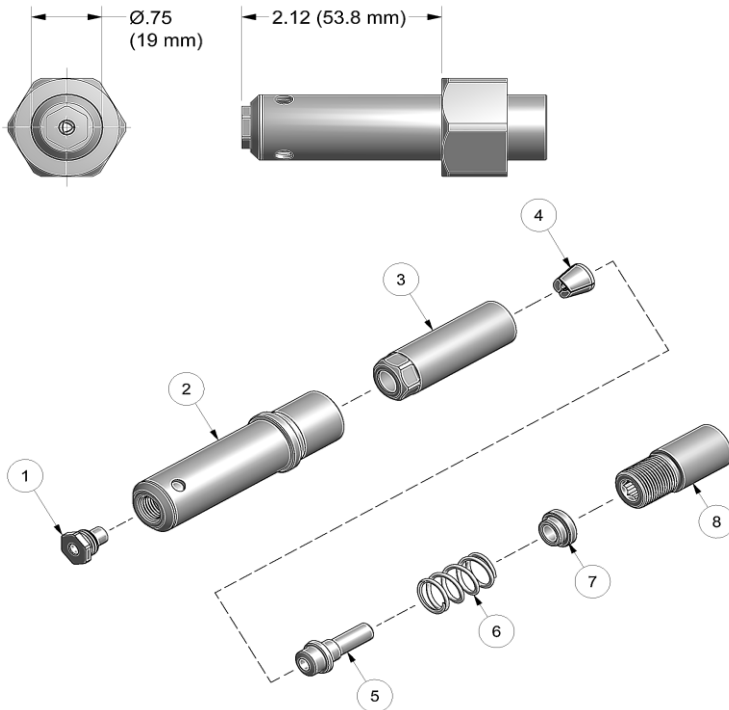

SELECTION CHART FOR COUNTERSUNK AND PROTRUDING HEAD RIVETS

| FASTENER | DIA. | NOSE ASSEMBLY | NOSE TIP |
|--|-------------|-------------------------|--------------------|
| N, Q & E, POP®, CLOSED END, AVEX®, MAGNA-LOK®, MAGNA-BULB®, HEMLOK®, BULB-TITE® (NON-STRUCTURAL) & ULTRA-GRIP® COMMERCIAL RIVETS | 3/16 1/4 | 6N-713-21 8CN-713-21 | 10204 10211-1 |
| PLASTIC SPLIT | 3/16 1/4 | 6P-713-21 8P-713-21 | 10167-1 10166-1 |
| T RIVET® | 3/16 1/4 | 6T-713-21 8T-713-21 | 10209 10286-2 |

POP® AND ULTRA-GRIP® ARE REGISTERED TRADEMARKS OF EMHART TECHNOLOGIES. AVEX® AND HEMLOK® ARE REGISTERED TRADEMARKS OF AVDEL UK LIMITED. MAGNA-LOK® AND MAGNA-BULB® ARE REGISTERED TRADEMARKS OF ALCOA INC. BULB-TITE® IS A REGISTERED TRADEMARK OF GESIPA FASTENERS USA, INC. T RIVET® IS A REGISTERED TRADEMARK OF CHERRY AEROSPACE FASTENERS.

7/14



11/04 Rev. 3/16

These noses are not recommended for stainless steel rivets

GAGE BILT
MADE in USA

44766 Centre Court Clinton Twp. MI 48038 USA
Ph: +1 (586) 226-1500 Fax: +1 (586) 226-1505
solutions@gagebilt.com / www.gagebilt.com

ASSEMBLY:

Note: If nose assy is assembled as it is when purchased new, follow steps 5-7 to attach to tool.

1. Place extension-collet (8) on a flat work surface hex side up.
2. Place cap (7) on extension-collet (8). Note direction from exploded view.
3. Place spring (6) on top of cap (7). Insert follower (5) thru spring (6) and into cap (7) and extension-collet (8). Place jaw set (4) on top of follower (5).
4. Slide collet (3) over assembled parts and thread collet (3) to extension-collet (8). Snug tighten assembled parts using 9/16" wrench on collet (3) and 1/4" hex key in rear on extension-collet (8)
5. Thread assembled collet (3) and extension-collet (8) onto piston assy on tool and snug with 9/16" wrench on collet (3) and hex key into rear of piston of tool.
6. Slide anvil holder assy (2) over assembled collet (3) and extension-collet (8).
7. Slide retaining nut from tool (retaining nut stop not used in this nose assembly) over anvil holder assy (2) and tighten.

DISASSEMBLY:

Reverse assembly instructions.

| Type: | | Fastener: | | Recommended Tool: GB722 | |
|----------------|------|-------------------|--|--|-----------|
| Self-Releasing | | See Chart | | Alternate Tools: GB713, GB752 & GB2480(A) | |
| Ref. No. | Qty. | Description | | | XX-713-21 |
| 1 | 1 | Nose Tip | | | See Chart |
| 2 | 1 | Anvil Holder Assy | | | 10942 |
| 3 | 1 | Collet | | | 20413 |
| 4 | 1 | Jaw Set | | | 30856 |
| 5 | 1 | Follower | | | 40889-2 |
| 6 | 1 | Spring | | | 50421 |
| 7 | 1 | Cap | | | 40810 |
| 8 | 1 | Extension-Collet | | | 70823 |