

# PEAR™ S5379i Pigtail

Small Form Factor  
In-Building Antenna

[698-960 / 1695-2700 / 5200-6000 MHz]



**Description:**

Omni directional antenna for in-building applications such as DAS. The antenna was especially designed for in-building multi-path environments.

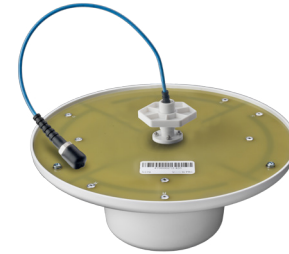

Electrical Specifications				
Frequency Band [MHz]	698-960	1695-2180	2180-2700	5200-6000
Input Connector Type	N-Type or 4.3-10 DIN or 4.1-9.5 DIN Connector (F) with cable (12"/30cm length)			
Polarization	Vertical			
Impedance	50 Ω			
VSWR / Return Loss	<1.7:1 / 11.8 dB	<1.7:1 / 11.8 dB	<1.5:1 / 14.0 dB	<2.0:1 / 9.5 dB
Max. Gain	2.4 dBi	3.1 dBi	4.0 dBi	6.1 dBi
Avg. Gain	1.4 dBi	2.7 dBi	3.4 dBi	4.8 dBi
Horizontal Beamwidth	Omni (360°)			
PIM @ 2x43 dBm	<-153 dBc for 4.3-10 DIN - <-150 dBc for N-Type or 4.1-9.5 DIN			
Input Power	25 W at ambient temperature of 77° F (25° C)			

Mechanical Specifications	
Operating Temperature	-40° to 158 °F (-40° to +70°C)
Environmental Conditions	Indoor
Antenna Weight	0.86 lbs (390g)
Antenna Dimensions (Diameter / Height)	8.0" / 3.2" (204 / 82 mm)
Flammability rating	UL 94-V0
RoHS	Compliant
Radome Color	RAL 9016 (white)*
Radome Material	PC/ABS
Pigtail Cable	Plenum Rated
Shipping Dimensions - 8 units	26.18" x 14.17" x 9.8" / 665 x 360 x 250 mm
Shipping Weight (Gross Weight) - 8 units	14.33 lbs (6.5 Kg)

\* Radome can be painted with recommended paint "Krylon fusion for plastic"

Release Date: 15. Dec. 2015; Revision: F; Patent Pending

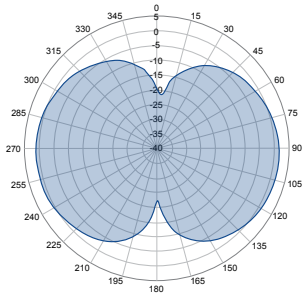

700 MHz

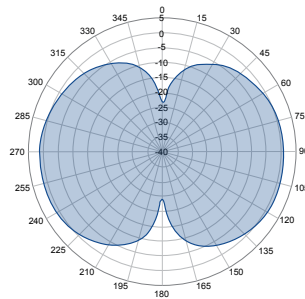

800 MHz

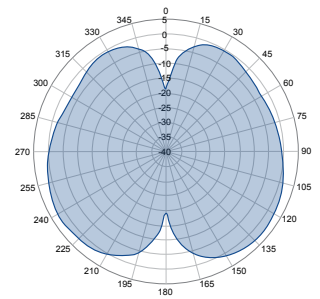

1750 MHz

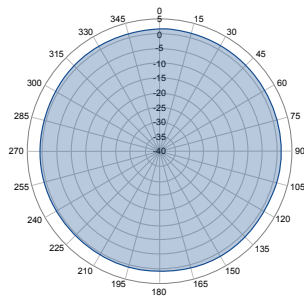

1870 MHz

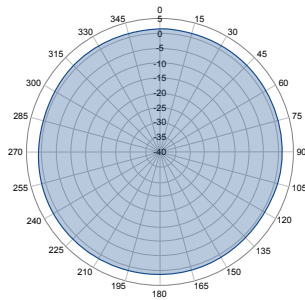

2170 MHz

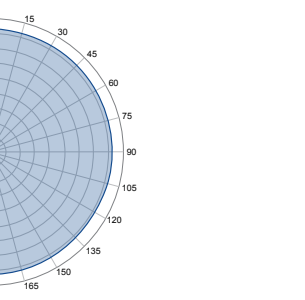

2620 MHz

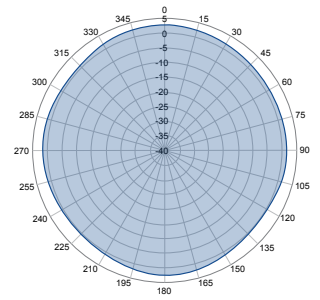

5500 MHz

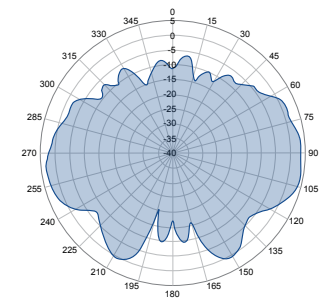
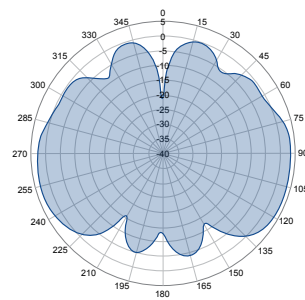
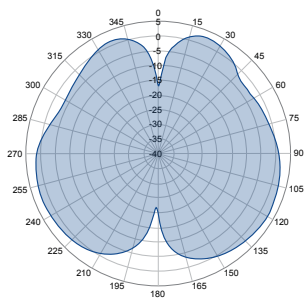
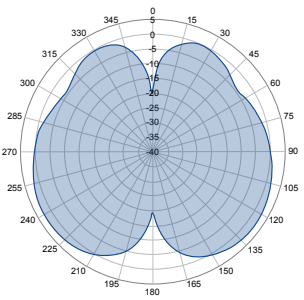

### Mounting Options

This antenna can be mounted using any of the following mounting brackets. Optional mounting brackets need to be ordered as a separate line item. See Ordering Options for details (see page 1).

#### Below Ceiling Installation (Standard)

Fasteners for below suspended ceiling mounting included with antenna. Maximum ceiling thickness 1.18" (30mm). Drill a hole with a 1.18" (30mm) diameter into suspended ceiling and secure the antenna with supplied plastic nut.

**Included with antenna**



#### Optional Hard Ceiling Mounting Bracket

The hard ceiling mounting bracket makes an antenna installation on suspended ceilings without a second access hole possible.

**P/N: 62-30-09**

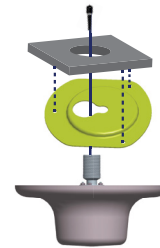

#### Optional Hard Ceiling Mounting Bracket

The hard ceiling mounting bracket makes an antenna installation on suspended ceilings without a second access hole possible. The hard ceiling mount doesn't add any additional height to the antenna height.

**P/N: 62-32-09**

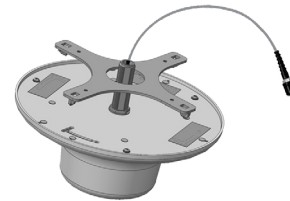

### Ordering & Antenna Options

Part Number	Connector	Description
02121270-05379U	N-Type (F)	PEAR™ S5379i
02125270-05379U	4.1-9.5 DIN (F)	PEAR™ S5379i
02130270-05379U	4.3-10 DIN (F)	PEAR™ S5379i
62-32-09		Hard Ceiling Mounting Bracket

Release Date: 15. Dec. 2015; Revision: F; Patent Pending