



### FEATURES

- > Compact design saves precious space while isolating 35kV
- > Flying leads provide versatile high voltage connections
- > Excellent for capacitive discharge and safety dump switch applications
- > Effectively bounce free operation

### PRODUCT SPECIFICATIONS

| Contact & Relay Ratings  | Units   | G61                  |
|--|---------|----------------------|
| <b>Contact Form</b>  |         | B                    |
| <b>Contact Arrangement</b>   |         | SPST-NC              |
| Contact Material (moveable/stationary)   |         | molybdenum /tungsten |
| Dielectric   |         | Inert Gas            |
| <b>Voltage, Test Max., Contacts &amp; to Base (15 µA Leakage Max., dc or 60Hz)</b> | kV Peak | 40                   |
| <b>Voltage, Operating Max., Contacts &amp; to Base (15 µA Leakage Max.)</b>        |         |                      |
| dc   | kV Peak | 35                   |
| 60 Hz RMS  | kV Peak | 30                   |
| <b>Current, Continuous Carry Max</b>   |         |                      |
| dc or 60 Hz  | Amps    | 10*                  |
| <b>Coil Hi-Pot (V RMS, 60 Hz)</b>  | V       | 500                  |
| <b>Resistance, Contact Max @ 1A, 28 Vdc</b>  | ohms    | 1.0                  |
| <b>Operate Time</b>  | ms      | 15                   |
| <b>Release Time</b>  | ms      | 15                   |
| <b>Life, Mechanical</b>  | cycles  | 1 million            |
| <b>Weight, Nominal</b>   | g (oz)  | 336 (12)             |
| <b>Vibration, Operating, Sine (55-500 Hz Peak)</b>                                 | G's     | 10                   |
| <b>Shock, Operating, 1/2 Sine 11ms (Peak)</b>                                      | G's     | 20                   |
| <b>Temperature Ambient Operating</b>   | °C      | -55 to +85           |

\*Consult factory for load switching applications.

### COIL RATINGS

| Nominal, Volts dc           | 12     | 26.5   | 115    |
|-----------------------------|--------|--------|--------|
| Pick-up, Volts dc, Max.     | 9      | 18     | 90     |
| Drop-Out, Volts dc          | .5 - 5 | 1 - 10 | 5 - 50 |
| Coil Resistance (Ohms ±10%) | 30     | 125    | 2000   |

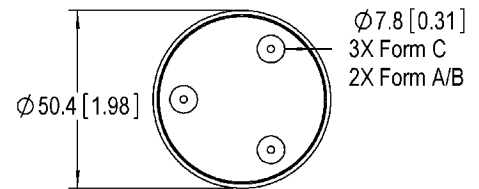
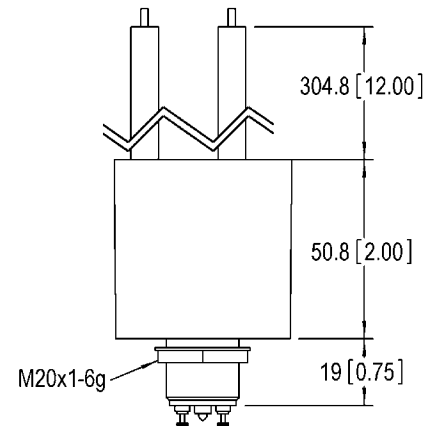

### PART NUMBER SYSTEM

| G61B                            | 7  | 4   | 1            |
|---------------------------------|--|---|--------------|
| <b>Coil Voltage</b>             | 7 = 12 Vdc, Turret Terminal<br>8 = 26.5 Vdc, Turret Terminal<br>9 = 115 Vdc, Turret Terminal |   |              |
| <b>High Voltage Connections</b> |  | 4 = Flying Leads, 12"<br>7 = Flying Leads, 72"<br>8 = Flying Leads, 36" |              |
| <b>Mounting</b>                 |  |   | 1 = Threaded |

Ratings listed are for 25°C, sea level conditions