



Solid Core CT for Branch Circuit Monitoring J3CT105-XXX-V or A

3&1 AC CT



- 3 Phase measuring current transformers.
- Ranges: 125 to 250A (333mV & 100mA Secondary)
- Cable aperture : 3 @ 21 x 25mm
- RJ12 socket for use with our EASYMODULAR multi channel meters
- Panel / DIN Rail Mounting

J3CT140-XXX-V or A



- 3 Phase measuring current transformers.
- Ranges: 250 to 630A (333mV & 100mA Secondary)
- Cable aperture : 3 @ 31x 36mm
- RJ12 socket for use with our EASYMODULAR multi channel meters
- Panel / DIN Rail Mounting

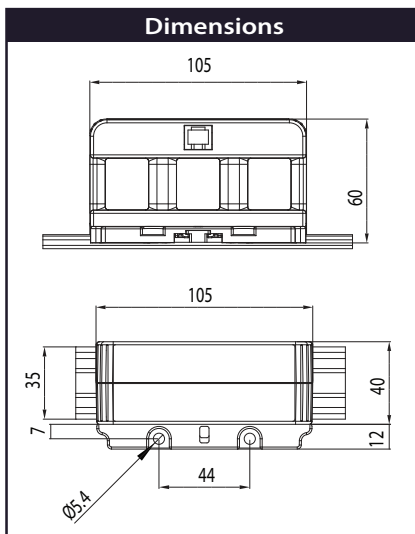

How to Order / Model Reference

eg **J3CT105-000/333mV**
J3CT105 **100mA**

Primary Current
 Select code from ratio table

Secondary Voltage **333 mV**

Secondary Current **100 mA**

Current Transformer Ratios

Primary Current (A)	Metering Burden(VA)			Code
	cl. 0.2S	cl. 0.5S	cl. 1	
125	0.033			125
150	0.033			150
160	0.033			160
200	0.033			200
250	0.033			250

333mV / 100mA Secondary

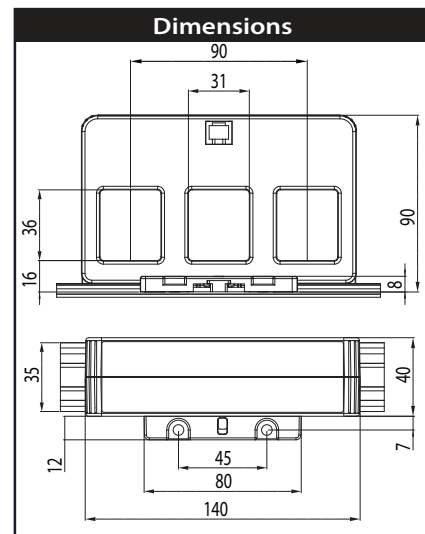

How to Order / Model Reference

eg **J3CT140-000/333mV**
J3CT140 **100mA**

Primary Current
 Select code from ratio table

Secondary Voltage **333 mV**

Secondary Current **100 mA**

Current Transformer Ratios

Primary Current (A)	Metering Burden(VA)			Code
	cl. 0.2S	cl. 0.5S	cl. 1	
250	0.033			250
300	0.033			300
400	0.033			400
500	0.033			500
600	0.033			600
630	0.033			630

333mV / 100mA Secondary