



200 ° below 2 s: Fast, hygienic temperature transmitter



Compact design with excellent response time and extended measuring range

- Measuring range of -50...200 °C, scalable via IO-Link 1.1
- Very fast response time:
T05 / T09 = < 0.5 s / < 2 s
- LED for visualisation of the operating status
- Versions with different hygienic process connections
- Different installation lengths from 25...150 mm



Analogue and IO-Link

The temperature transmitter has an analogue output with 4...20 mA. The parameters are set via the integrated IO-Link interface.

Fast and precise

The Pt1000 measuring element of class A achieves a high precision with the factory-internal calibration. The innovation besides the wide measuring range is the excellent response time. Therefore the sensor is suitable for all highly-precise and fast processes in hygienic environments.

Transparent and flexible

An LED clearly signals the readiness for operation. Compact design, integrated process connections and different probe lengths enable easy and flexible installation.



Dimensions

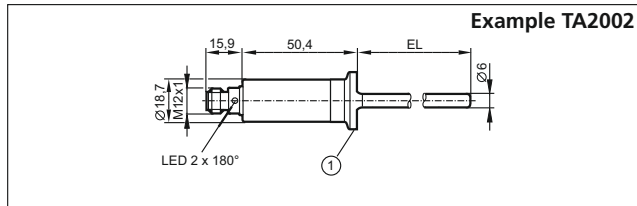



1) 3/4" Clamp

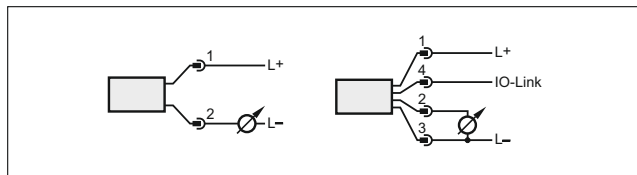



Wiring diagram



Accessories

Type	Description	Order no.
	IO-Link interface for parameter setting and analysis of units with DTM specification, current consumption from USB port: max. 500 mA	E30396
	Memory plug, parameter memory for IO-Link sensors	E30398
	LINERECORDER SENSOR, software for parameter setting and setting up IO-Link sensors	QA0001

Connection technology

Type	Description	Order no.
	Socket, M12, 2 m black, PUR cable	EVC001
	Socket, M12, 5 m black, PUR cable	EVC002
	Socket, M12, 2 m black, PUR cable	EVC004
	Socket, M12, 5 m black, PUR cable	EVC005

Installation length [mm]	Order no.
Process connection Clamp 3/4" Temperature range (scaled 4...20 mA) -50...200 °C	
25	TA2002
60	TA2012
Process connection Clamp 1.5" Temperature range (scaled 4...20 mA) -50...200 °C	
30	TA2802
50	TA2812
100	TA2832
150	TA2842
G 1/2 process connection with sealing cone Temperature range (scaled 4...20 mA) -50...200 °C	
30	TA2502
50	TA2512
100	TA2532
150	TA2542
Process connection ø 6 mm Temperature range (scaled 4...20 mA) -50...200 °C	
50	TA2212
100	TA2232
150	TA2242

Further technical data		
Operating voltage	[V DC]	18...32
Reverse polarity / overload protection		• / •
Measuring element		Pt1000, class A
Response dynamics T05 / T09		< 0.5 s / < 2 s
Protection		IP 67, IP 68, IP 69K / III
Measuring range	[°C]	-50...200
Accuracy	[K]	± 0.3 + (± 0.1 % MS)
Ambient temperature	[°C]	-25...80
IO-Link revision		1.1
Materials in contact with the medium		High-grade stainless steel (316L/1.4404)

ifm article no. 78001405 · We reserve the right to make technical alterations without prior notice. · 04.2015