

MT-25 User's Manual

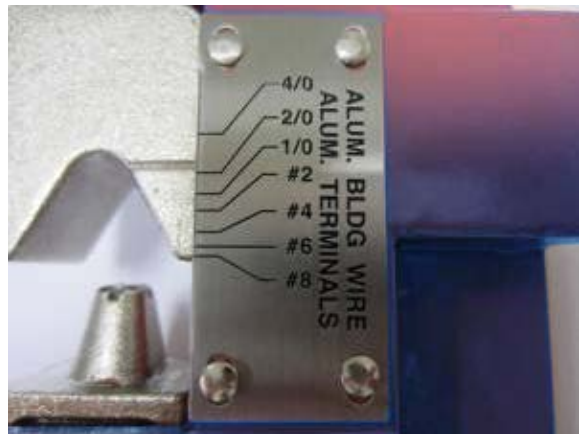

1. MT-25 is suitable for terminating insulated and non-insulated cable lugs from copper and aluminum.
 - A. Copper cable AWG 8~250MCM (10~120mm²)
 - B. Aluminum cable AWG 8 ~ 4/0 (10~120mm²)
2. Please use the golden plate on the left-hand side for size adjustment when crimping copper cable, use the silver plate on another side when crimping aluminum cable.

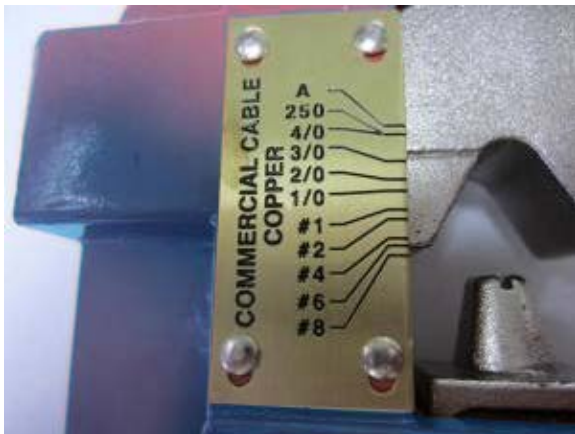

3. Due to different brands of terminals and cables, there will be slight size difference. For the first time use, please adjust the scale on V shape part to be between the size of terminal needs to be crimped and one size bigger. For example, if you'd like to crimp 3/0 terminal, please adjust the scale to be between 3/0 and 4/0 for the first time to find out the best position of crimping. The position of scale can be adjusted in anti-clockwise direction of the black knob on the top.



4. Open the moveable handle



5. Place the terminals and cable in position.



6. Press the handle. NOTE: please press the moveable handle to the end.



7. Open the handle and check if the terminal and cable crimped properly..



8. If the terminal was not crimped tightly enough, adjust the V shape part to be tighter by adjusting the black knob in clockwise direction until it can crimp the terminal properly. Then keep the position for next crimping job.



9. If the brand or size of terminal/ cable will be changed, please follow step 3 to 8 to avoid damaging the product.

NOTE: When crimping the terminal, if the moveable handle can not be press to the end with big pressure already, please check the position of scale is needed to be adjusted or not right away. The handle could be broken under overloaded pressure.

CAUTION: Do not use other tube or equipment to extend the handle for crimping in order not to damage the product.

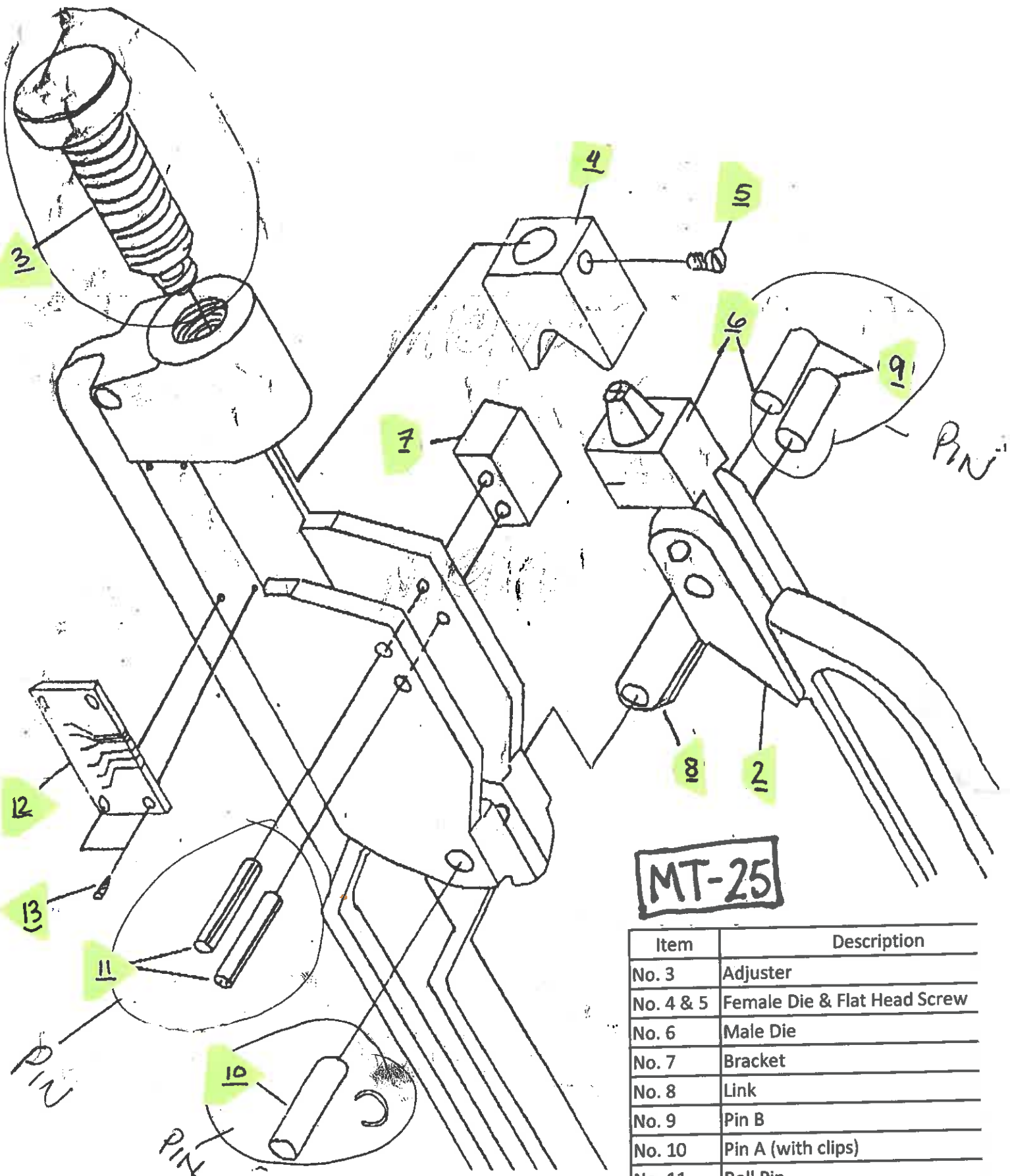

MT-25

Item	Description
No. 3	Adjuster
No. 4 & 5	Female Die & Flat Head Screw
No. 6	Male Die
No. 7	Bracket
No. 8	Link
No. 9	Pin B
No. 10	Pin A (with clips)
No. 11	Roll Pin
No. 12	Graduated Plate (2pcs/set)
No. 13	Rivet