

**w/out LOCATOR PEGS DIMENSION (mm)**

DIMENSION NUMBER	A	B	C	D
01	5.84	1.65	1.22	1.27
02	5.80	4.00	1.00	1.27
03	5.84	3.05	0.40	1.27

**w/ LOCATOR PEGS DIMENSION (mm)**

DIMENSION NUMBER	A	B	C	D
01	5.84	1.65	1.22	1.27
02	5.80	4.00	1.00	1.27
03	5.84	3.05	0.40	1.27

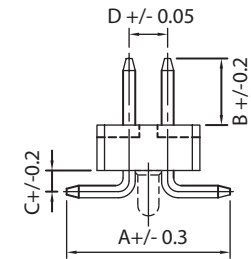
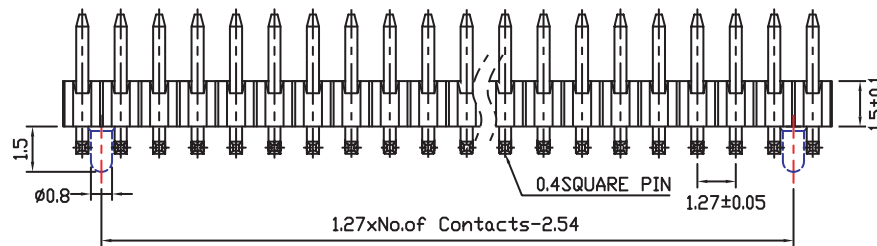
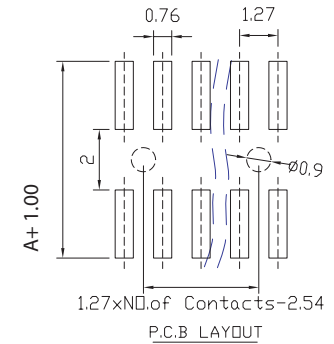
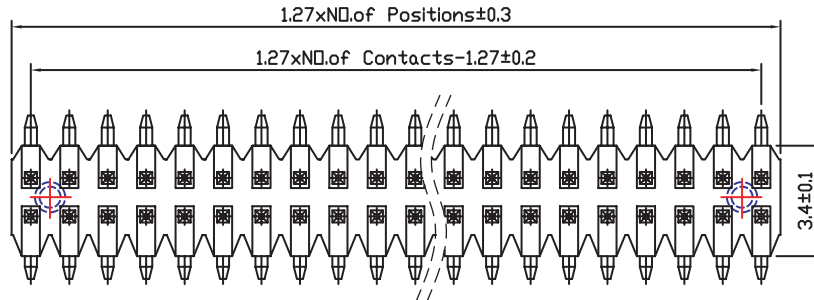

**ELECTRICAL:**

CURRENT RATING: 1 AMP  
 CONTACT RESISTANCE: 20 MilliOhms Max  
 INSULATOR RESISTANCE: 5000 MegaOhms  
 DIELECTRIC WITHSTANDING: AC 500V  
 OPERATING TEMPERATURE: -40° C TO +105° C  
 MAX PROCESSING TEMPERATURE: 230°C for 30-60 Seconds  
 (260°C for 10 Seconds)

**MATERIAL:**

INSULATOR: NYLON 6T & 30% GF (UL94V-0)  
 CONTACT MATERIAL: COPPER ALLOY  
 CONTACT PLATING: OPTIONAL GOLD OR TIN OVER NICKEL  
 (GOLD THICKNESS OPTIONAL)

**MECHANICAL:**

RETENTION FORCE: 750g MIN.

**HOW TO ORDER:**

**H** **E** **X** **4** - **X** **X** **5** **X** - **X** **X** **X** **X** - **Z**

**INSULATOR THICKNESS:**

3 - Insulator w/o Mtg. Peg  
 4 - Insulator w/ Mtg. Peg

**DIMENSION NUMBER:**

SEE DIMENSION TABLE ABOVE

**NUMBER OF CONTACTS:**

01 thru 98  
 A0=100

**PACKAGING:**

0 - Tray Package  
 1 - W/out CAP In Tube  
 2 - With CAP In Tube  
 3 - With CAP In Tube & Reel

**RoHS COMPLIANT**

**NUMBER OF ROWS/POST SIZE:**

4 - Double Row w/ .40 mm Post

**INSULATOR THICKNESS**

5 - 1.5 mm

**PLATING OVERALL:**

0 - FULL TIN  
 1 - FULL Au FLASH  
 2 - 10µ" Au  
 3 - 15µ" Au  
 4 - 30µ" Au

**SELECTIVE PLATING:**

5 - Au FLASH CONTACT AREA/TIN TAIL  
 6 - 10µ" Au CONTACT AREA/TIN TAIL  
 7 - 15µ" Au CONTACT AREA/TIN TAIL  
 8 - 30µ" Au CONTACT AREA/TIN TAIL

Rev		Apv.	Date
0	Issued	S.E.	10/1/97
A	Revised For RoHS Compliance	A.M.	09/30/05
B	Added Dimension 02 & 03	WHS	06/27/06

**SMP TECHNOLOGY, INC.**

SCALE: None

DRAWING No.

Pin Header, Surface Mount, 1.27mm Pitch; Double Row

TOL. DEC. .X +/- 0.35 .XX +/- 0.25 .XXX +/- ANGLE +/- UNIT: mm

SERIES: HEX4-XX5X-XXX-Z