

WITHOUT PCB
MTG PEG

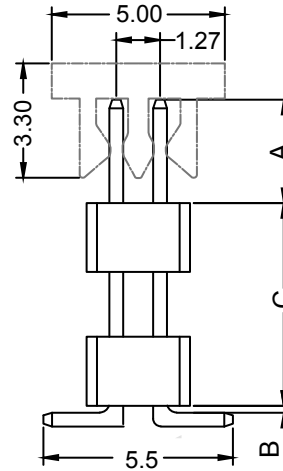

WITH PCB MTG.

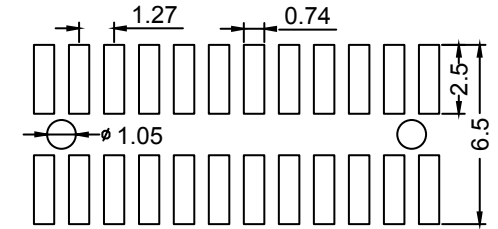
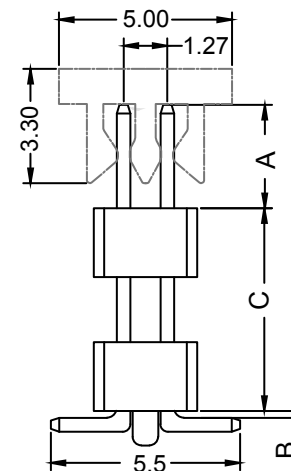

RECOMMENDED PCB LAYOUT

DIMENSION(mm)

DIMENSION NUMBER	A	B	C
90	3.00	1.05	7.50
91	1.91	0.20	5.69

* OTHER DIMENSIONS AVAILABLE

ELECTRICAL:

CURRENT RATING: 0.5A
 CONTACT RESISTANCE: < 30mΩ
 INSULATOR RESISTANCE: > 1000MΩ
 DIELECTRIC WITHSTANDING VOLTAGE: 1000V AC FOR 1 MIN.
 OPERATING TEMPERATURE: -55° C TO +105° C

MATERIAL:

INSULATOR: HIGH TEMPERATURE PLASTIC, UL94V-0
 CONTACT: COPPER ALLOY

HOW TO ORDER:

SERIES: H G 1 2 - X X X X - X X 0 X - Z

H DIMENSION INSULATOR HEIGHT:
 1 - 1.60 mm
 2 - 2.00 mm
 3 - 2.50 mm

PLATING OVERALL:
 0 - FULL TIN
 1 - FULL Au FLASH
 3 - 10u" Au
 4 - 15u" Au
 5 - 30u" Au

NUMBER OF CONTACTS:
 02 thru 100

SELECTIVE PLATING:
 6 - Au FLASH CONTACT AREA/TIN TAIL
 7 - 10u" Au CONTACT AREA/TIN TAIL
 8 - 15u" Au CONTACT AREA/TIN TAIL
 9 - 30u" Au CONTACT AREA/TIN TAIL

PACKAGING:
 0 - TRAY
 1 - TUBE W/ CAP
 3 - TUBE W/OUT CAP
 5 - BOX PACKAGING

RoHS COMPLIANT

NUMBER OF ROWS:
 2 - DOUBLE ROW

DIMENSION NUMBER:
 SEE DIMENSION NUMBER ABOVE

Rev	Drawn	Checked	Approved	Date
0 Issued	S.E.	S.M.	S.M.	10/01/97
A Revised for RoHS Compliance	B.S.	S.M.	S.M.	08/13/08

SMP TECHNOLOGY, INC.

PIN HEADER, 1.27mm PITCH, Double Row, Double Insulator, Surface Mount

TOL. DEC. .X +/- 0.35 .XX +/- 0.25 .XXX +/- ANGLE +/- UNIT: mm

SERIES: HG12-XXXX-XX0X-Z