

P.C.B LAYOUT

DIMENSION TABLE
1.0(H)mm
Insulator Thickness

	A	B
01	1.91	1.3
02	1.65	1.3
03	2.03	1.3
04	1.77	1.3

DIMENSION TABLE
1.5(H)mm
Insulator Thickness

	A	B
01	1.91	1.8
02	1.65	1.8
03	2.03	1.8
04	1.77	1.8

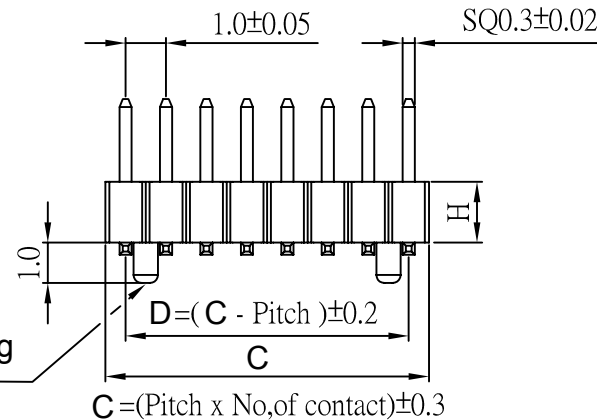
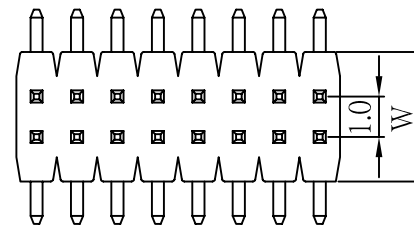

Mounting Peg
(2) Shown

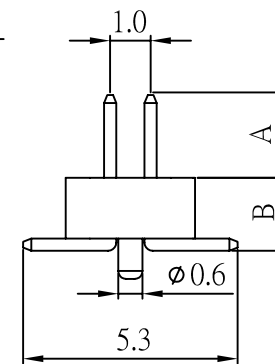

B = H + 0.30
TOLERANCE: +0.13;
-0.00
MEASURED AT
BEND RADIUS

HOW TO ORDER:

H **J** **4** **1** - **X** **X** **X** **X** - **X** **X** **X** **X** **Z**

NUMBER OF ROWS:
4 - DOUBLE ROW - 0.3mm SQ. POST, SMT

NUMBER OF CONTACTS:
02-100
A0 = 100

INSULATOR TYPE:
1 - SINGLE INSULATOR

INSULATOR THICKNESS:
1 - 1.0(H) X 3.2 (W)
2 - 1.5(H) X 3.2 (W)

SEE DIMENSION TABLE

PLATING OVERALL:
0 - FULL TIN
1 - FULL Au FLASH
3 - 10u" Au
4 - 15u" Au
5 - 30u" Au

SELECTIVE PLATING:
6 - Au FLASH CONTACT AREA/TIN TAIL
7 - 10u" Au CONTACT AREA/TIN TAIL
8 - 15u" Au CONTACT AREA/TIN TAIL
9 - 30u" Au CONTACT AREA/TIN TAIL

PACKAGING:
0 - TRAY
1 - TUBE W/ CAP
2 - TAPE & REEL W/ CAP
3 - TUBE W/OUT CAP
4 - TAPE & REEL W/OUT CAP

RoHS COMPLIANT

SPECIFICATIONS:

CURRENT RATING: 0.7A @ 80°C AMBIENT
 OPERATING TEMP RANGE: -65°C TO +125°C
 INSULATOR MATERIAL: NYLON-6T
 CONTACT MATERIAL: PHOSPHOR BRONZE
 MAX PROCESSING TEMP: 260°C FOR 10 SECONDS

Rev	Drawn	Checked	Approved	Date
0 Issued	WHS	S.M.	S.M.	08/10/06

SMP TECHNOLOGY, INC.

SCALE N/A

PIN HEADER, 1.00mm PITCH, Double Row, Surface Mount

TOL. DEC. .X +/- 0.2 .XX +/- .XXX +/- ANGLE +/- UNIT: mm

SERIES: H J 4 1 - X X X X - X X X X - Z