

Solderless terminals

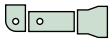

KNIFE DISCONNECT Vinyl-insulated

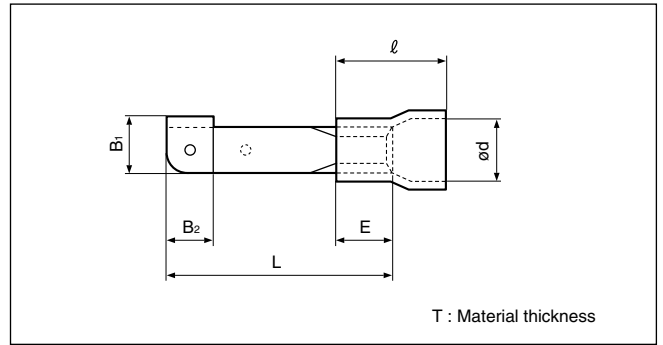
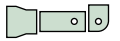

| Applicable Wire AWG#(mm ²) | Part No. | Standard | Dimensions mm (in.) | | | | | | | Color | Tool No. | | | | | | Qty/box | |
|---|----------|----------|---------------------|------------|----------------|----------------|-------------|------------|------------|--------|----------|----------|-----------|------|------|------|---------|-----------|
| | | | L | E | B ₁ | B ₂ | ℓ | ø d | T | | YNT-2216 | YNT-1614 | YNT-1210S | YA-1 | YA-2 | YA-4 | | BCT-0514L |
| 22 to 16*(0.25 to 1.65) | FV1.25-K | | 17.1 (.673) | 4.8 (.189) | 5.0 (.197) | 4.1 (.161) | 9.0 (.354) | 4.0 (.157) | 0.8 (.031) | Red | o | | | o | o | o | o | 1,000 |
| 16 to 14 (1.04 to 2.63) | FV2 -K | | 18.2 (.717) | 4.4 (.173) | 5.0 (.197) | 3.9 (.154) | 9.0 (.354) | 4.5 (.177) | 0.8 (.031) | Blue | | o | | o | o | o | o | 1,000 |
| 12 to 10 (2.63 to 6.64) | FV5.5 -K | | 23.3 (.917) | 6.2 (.244) | 7.1 (.280) | 5.6 (.220) | 13.5 (.531) | 6.8 (.268) | 1.0 (.039) | Yellow | | | o | | | o | o | 500 |

Note:1) *The crimping will be more secure if the total cross-sectional area of the wire is at least 0.5 mm².
 Examples: If the cross-sectional area of the wire is 0.3mm², fold the wire in two when crimping the terminal.
 If the cross-sectional area of the wire is 0.5mm², crimp the terminal onto the wire as it is.
 2) Delivery lead times may vary depending on the product. Contact JST for details.

Solderless terminals

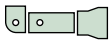

KNIFE DISCONNECT Vinyl-insulated with copper sleeve

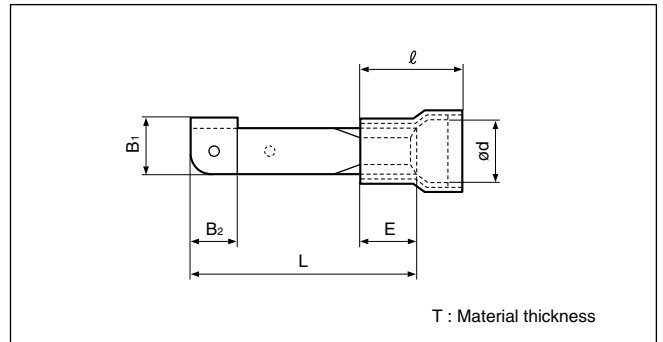
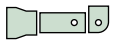

| Applicable Wire AWG#(mm ²) | Part No. | Standard | Dimensions mm (in.) | | | | | | | Color | Tool No. | | | | | | Qty/box | |
|---|-----------|----------|---------------------|------------|----------------|----------------|-------------|------------|------------|--------|----------|----------|-----------|------|------|------|---------|-----------|
| | | | L | E | B ₁ | B ₂ | ℓ | ø d | T | | YNT-2216 | YNT-1614 | YNT-1210S | YA-1 | YA-2 | YA-4 | | BCT-0514L |
| 22 to 16 (0.25 to 1.65) | FVD1.25-K | | 17.1 (.673) | 4.8 (.189) | 5.0 (.197) | 4.1 (.161) | 9.6 (.378) | 4.0 (.157) | 0.8 (.031) | Red | o | | | o | o | o | o | 1,000 |
| 16 to 14 (1.04 to 2.63) | FVD2 -K | | 18.2 (.717) | 4.4 (.173) | 5.0 (.197) | 3.9 (.154) | 9.6 (.378) | 4.7 (.185) | 0.8 (.031) | Blue | | o | | o | o | o | o | 1,000 |
| 12 to 10 (2.63 to 6.64) | FVD5.5 -K | | 23.3 (.917) | 6.2 (.244) | 7.1 (.280) | 5.6 (.220) | 14.0 (.551) | 6.5 (.256) | 1.0 (.039) | Yellow | | | o | | | o | o | 500 |

Note:1) Delivery lead times may vary depending on the product. Contact JST for details.